

CONSTRUCTION STAGING NOTES

- 1. CONTRACTOR SHALL COORDINATE ALL STAGING AREAS WITH THE FACILITY AND CONSTRUCTION MANAGER.
2. CONTRACTOR SHALL REPLACE ALL PAVEMENT DAMAGED BY CONSTRUCTION ACTIVITIES AT THE END OF CONSTRUCTION.
3. CONTRACTOR SHALL RESTORE ALL DISTURBED AREAS NOT TO BE PAVED TO THEIR ORIGINAL CONDITION AT THE END OF CONSTRUCTION.
4. CONTRACTOR SHALL PROVIDE BARRICADES, FENCING OR OTHER DEVICES TO KEEP UNAUTHORIZED PERSONNEL OUT OF PROJECT SITE.

TRAFFIC AND PEDESTRIAN CONTROL NOTES

- 1. CONTRACTOR TO COORDINATE WITH CAPITOL COMPLEX PRIOR TO CLOSING DOWN PARKING DURING CONSTRUCTION.
2. IT IS THE CONTRACTOR'S RESPONSIBILITY TO CONTROL TRAFFIC DURING CONSTRUCTION AND PROVIDE ADEQUATE TRAFFIC AND PEDESTRIAN CONTROL AND SIGNAGE.
3. CONTRACTOR TO INSTALL AND MAINTAIN CONSTRUCTION FENCE AROUND ALL AREAS OF ACTIVE CONSTRUCTION.
4. PEDESTRIAN ACCESS MUST BE MAINTAINED TO ALL BUILDINGS THROUGHOUT CONSTRUCTION.
5. CONTRACTOR TO COORDINATE CONSTRUCTION ACCESS, STAGING AND PARKING AREAS WITH FACILITY AND CONSTRUCTION MANAGER.

DEMOLITION NOTES

- 1. REMOVAL REQUIREMENTS SHOWN ON THE PLANS SHOULD BE CONSIDERED MINIMUM REMOVAL AND REPLACEMENT REQUIREMENTS.
2. CONTRACTOR SHALL REPLACE AT NO COST TO THE STATE ALL DAMAGED STREETS, DRIVES, SIDEWALKS, CURB AND GUTTER.
3. ALL LANDSCAPING, INCLUDING TREES, SHRUBS AND PERENNIALS NOT CALLED OUT TO BE REMOVED OR APPROVED FOR REMOVAL.
4. WHERE A SECTION OF PAVEMENT, CURB AND GUTTER OR SIDEWALK IS CUT OR OTHERWISE DAMAGED BY THE CONTRACTOR.
5. FIRE PROTECTION ACCESS AND FIRE HYDRANTS SHALL BE MAINTAINED THROUGHOUT THE PROJECT.
6. THE CONTRACTOR SHALL COORDINATE ANY DISRUPTION OF EXISTING UTILITIES SERVING THE FACILITY WITH THE FACILITY AND CONSTRUCTION MANAGER.

EXCAVATION NOTES

- 1. EXCAVATE TRENCH AND PROVIDE PIPE BEDDING AND BACKFILL MATERIAL PER IOWA SUDAS SPECIFICATIONS OR AS SHOWN ON THE DRAWINGS.
2. STRIP, STOCKPILE AND RESPREAD A MINIMUM OF 6" OF TOPSOIL IN ALL SODDING AREAS DISTURBED BY CONSTRUCTION.
3. CONTRACTOR IS RESPONSIBLE FOR ALL TRENCH AND FILL SETTLEMENT FOR THE PROJECT'S ONE YEAR WARRANTY PERIOD.

GRADING AND EROSION CONTROL NOTES

- 1. THE DISTURBED CONSTRUCTION AREA IS LESS THAN 1 ACRE. SO AN NPDES GENERAL PERMIT NO. 2 AND STORMWATER POLLUTION PREVENTION PLAN (SWPPP) ARE NOT REQUIRED.
2. BEST MANAGEMENT PRACTICES (BMPs) AND CONTROLS SHALL CONFORM TO FEDERAL, STATE OR LOCAL REQUIREMENTS, AS APPLICABLE.
3. ALL WASH WATER (CONCRETE TRUCKS, VEHICLE CLEANING, EQUIPMENT CLEANING, ETC.) SHALL BE DETAINED AND PROPERLY TREATED OR DISPOSED.
4. SUFFICIENT OIL AND GREASE ABSORBING MATERIALS SHALL BE MAINTAINED ON SITE OR READILY AVAILABLE TO CONTAIN AND CLEAN UP FUEL OR CHEMICAL SPILLS AND LEAKS.
5. DUST ON THE SITE SHALL BE CONTROLLED. THE USE OF MOTOR OILS AND OTHER PETROLEUM BASED OR TOXIC LIQUIDS FOR DUST SUPPRESSION OPERATIONS IS PROHIBITED.
6. RUBBISH, TRASH, GARBAGE, LITTER OR OTHER SUCH MATERIALS SHALL BE DEPOSITED INTO SEALED CONTAINERS.

- 7. ALL MATERIALS SPILLED, DROPPED, WASHED OR TRACKED FROM VEHICLES ONTO ROADWAYS OR INTO STORM DRAINS MUST BE REMOVED IMMEDIATELY.
8. CONTRACTORS OR SUBCONTRACTORS WILL BE RESPONSIBLE FOR REMOVING SEDIMENT THAT MAY HAVE COLLECTED IN THE STORM SEWER DRAINAGE SYSTEMS IN CONJUNCTION WITH THE STABILIZATION OF THE SITE.
9. SLOPES SHALL BE LEFT IN A ROUGHENED CONDITION DURING THE GRADING PHASE TO REDUCE RUNOFF VELOCITIES AND EROSION.
10. THE CONTRACTOR SHALL BE RESPONSIBLE FOR ADJUSTING THE EROSION CONTROL MEASURES (SILT FENCES, WATTLES, INLET PROTECTION, ETC.) TO PREVENT EROSION.
11. ALL STORM SEWER INTAKES THAT RECEIVE STORMWATER RUNOFF FROM DISTURBED AREAS SHALL BE PROVIDED WITH INLET PROTECTION.
12. CONTRACTOR SHALL BE RESPONSIBLE FOR INSTALLATION, PERIODIC CHECKING AND REINSTALLATION OF EROSION AND SEDIMENTATION CONTROL MEASURES ON A DAILY BASIS THROUGHOUT CONSTRUCTION.
13. CONTRACTOR SHALL COMPLY WITH ALL APPLICABLE IOWA DNR, US EPA AND LOCAL REGULATIONS DEALING WITH STORMWATER RUNOFF AND EROSION CONTROL.

UTILITY NOTES

- 1. IT IS THE CONTRACTOR'S RESPONSIBILITY TO VERIFY THE EXACT LOCATIONS AND DEPTHS OF ALL EXISTING PUBLIC AND PRIVATE UTILITIES AND WHETHER ADDITIONAL UTILITIES EXIST.
2. ALL HDPE PIPE SHALL BE DUAL-WALLED UNLESS OTHERWISE SPECIFIED AS PERFORATED.
3. ALL EXISTING PUBLIC AND PRIVATE UTILITY STRUCTURES SHALL BE ADJUSTED TO FINAL FINISH GRADES.
4. ALL HDPE BENDS AND CONNECTIONS SHALL BE MANUFACTURED CONNECTIONS.
5. CONTRACTOR TO MODIFY EXISTING INVERTS TO ACCOMMODATE NEW PIPE CONNECTIONS.
6. CONTRACTOR SHALL COORDINATE WITH ALL UTILITY COMPANIES FOR INSTALLATION REQUIREMENTS, SPECIFICATIONS, PERMITS AND FEES.
7. ALL EXISTING AND PROPOSED UTILITY CROSSINGS/CONFLICTS SHALL MEET OR EXCEED IOWA SUDAS HORIZONTAL AND VERTICAL SEPARATION REQUIREMENTS.
8. ALL UNDERGROUND LINES SHALL BE INSTALLED, INSPECTED AND APPROVED BEFORE BACKFILLING.
9. LENGTHS SHOWN ARE INSIDE EDGE TO INSIDE EDGE OF STRUCTURES.
10. ALL CONSTRUCTION SHALL BE IN ACCORDANCE WITH IOWA SUDAS STANDARD SPECIFICATIONS AND IOWA DOT SPECIFICATIONS, STANDARD ROAD PLANS AND ROAD DESIGN DETAILS.
11. ALL OPEN EXCAVATIONS SHALL BE PROTECTED WITH SAFETY FENCE, BARRIERS OR BARRICADES IN ACCORDANCE WITH OSHA.
12. CONTRACTOR TO IMPLEMENT TEMPORARY SHORING OR SUPPORT AT ALL UTILITY CROSSINGS AS REQUIRED BY CONTRACTOR'S MEANS AND METHODS.

PAVEMENT GENERAL NOTES

- 1. ALL PROPOSED PAVEMENT PATCHES ARE APPROXIMATE ONLY AND SHOULD BE CONSIDERED MINIMUM REMOVAL EXTENTS.
2. ALL SLOPES IN PAVEMENT SHALL BE UNIFORM TO AVOID PONDING. ANY PONDING ON PAVEMENT PATCHES, NEW PAVING OR ADJACENT PAVING WILL BE CONSIDERED UNACCEPTABLE AND SHALL BE REPLACED.
3. CONTRACTOR TO REMOVE ALL SIGNS WITHIN THE CONSTRUCTION LIMITS PRIOR TO THE START OF CONSTRUCTION AND REPLACE THEM ONCE CONSTRUCTION HAS CONCLUDED.
4. USE TYPE "A" COMPACTION PER IOWA DOT STANDARD SPECIFICATIONS ON SUBGRADE AND SUBBASE.

SPECIFICATIONS

THE MOST RECENT EDITION OF THE IOWA STATEWIDE URBAN DESIGN AND SPECIFICATIONS (SUDAS) SHALL APPLY TO ALL SITE WORK PERFORMED ON THIS PROJECT EXCEPT AS MODIFIED HEREIN.

A. CONCRETE PAVING
CONCRETE: MATERIALS AND MIXING FOR ALL CONCRETE WORK, UNLESS OTHERWISE SPECIFIED, SHALL CONFORM TO IOWA DOT SPECIFICATIONS FOR AIR-ENTRAINED TYPE C-4 MIX WITH TYPE I CEMENT.

FLY ASH (CONTRACTOR'S OPTION): ASTM C618, TYPE C, NOT TO EXCEED 15% OF CEMENTITIOUS MATERIAL.

COARSE AGGREGATE: DURABILITY SHALL BE CLASS III, 3/4" MAX.

COMPRESSIVE STRENGTH: 2800 PSI @ 7 DAYS AND 4000 PSI @ 28 DAYS
SLUMP: 3" ± 1" or 8" MAXIMUM WITH SUPER PLASTICIZER OR AS APPROVED BY GEOTECHNICAL ENGINEER
AIR CONTENT: 7.0% ± 1.0% OR AS APPROVED BY GEOTECHNICAL ENGINEER
WATER/CEMENT RATIO: NOT TO EXCEED 0.53
FINISH: HEAVY BROOM FINISH

TESTING: ONE SET OF TEST CYLINDERS REQUIRED FOR EACH 100 CY, OR PORTION THEREOF, OF CONCRETE POURED PER WORK LOCATION. CONCRETE TESTING TO BE DONE AND PAID FOR BY OWNER.

SURFACE CURING: CONTRACTOR SHALL APPLY WHITE PIGMENT LIQUID CURING COMPOUND IN A FINE SPRAY TO FORM CONTINUOUS UNIFORM FILM AFTER FINISHING AND SURFACE MOISTURE HAS DISAPPEARED OR WITHIN 30 MINUTES AFTER FORMS ARE REMOVED.

SUBMIT CONCRETE MIX DESIGN FOR APPROVAL.

COLD WEATHER CONCRETE: WHEN THE ATMOSPHERIC AIR TEMPERATURE MAY BE EXPECTED TO DROP BELOW 40°F AT THE TIME CONCRETE IS DELIVERED TO THE WORK SITE, DURING PLACEMENT OR AT ANY TIME DURING CURING PERIOD, CONCRETE SHALL BE MIXED, PLACED AND PROTECTED IN ACCORDANCE WITH ACI STANDARD 306, "RECOMMENDED PRACTICE FOR COLD WEATHER CONCRETING." IT IS THE OWNER'S PREFERENCE TO AVOID COLD WEATHER CONCRETE AND PROVIDE TEMPORARY GRANULAR SURFACING FOR SIDEWALK AND PAVING AS REQUIRED.

B. EXPANSION JOINT FILLER
CLOSED CELL POLYETHYLENE WITH STRIP-OFF CAP FOR SEALANT.

C. JOINT SEALANT
PAVING JOINTS SHALL BE SEALED PER IOWA DOT SPECIFICATIONS. BACKER ROD SHALL NOT BE USED FOR JOINT SEALING.

D. PAVEMENT JOINTING
PROVIDE IDOT TYPE 'C' JOINTS FOR JOINTS IN PARKING LOT. PROVIDE JOINTS AT A MAXIMUM SPACING OF 12 FEET FOR PAVING OR SQUARE PANELS FOR SIDEWALKS.

PROVIDE IDOT TYPE 'RD' OR JOINTS TO TIE INTO EXISTING PAVING.

PROVIDE IDOT TYPE 'DW' JOINTS FOR END OF DAY PAVING.

SAW CUTTING TO BE COMPLETED A MAXIMUM OF 24 HOURS FROM CONCRETE PLACEMENT. RANDOM CRACKING CAUSED BY DELAYED SAW CUTTING MAY REQUIRE REMOVAL AND REPLACEMENT.

CONTRACTOR TO PROVIDE OWNER'S REPRESENTATIVE WITH A POURING SEQUENCE AND JOINTING PLAN FOR APPROVAL PRIOR TO PAVING.

E. GRANULAR SUBBASE
CRUSHED STONE GRANULAR SUBBASE MATERIAL SHALL BE PROVIDED AND PLACED ACCORDING TO IOWA DOT SPECIFICATIONS.

F. TRENCH EXCAVATION AND BACKFILL
BEDDING AND BACKFILL MATERIAL: SHALL COMPLY WITH IOWA SUDAS SECTION 3010.

BACKFILL COMPACTION REQUIREMENTS:

- 1. AREAS UNDER AND WITHIN FIVE (5) FEET OF PAVEMENT, SIDEWALKS, GRANULAR SURFACING OR OTHER SURFACE IMPROVEMENTS SHALL BE COMPACTED TO 95% OF MAXIMUM STANDARD PROCTOR DENSITY.
2. AREAS UNDER LANDSCAPING AND LAWN AREAS SHALL BE COMPACTED TO 90% OF MAXIMUM STANDARD PROCTOR DENSITY.
COMPACTION TESTING SHALL BE COMPLETED ON A FREQUENCY OF ONE TEST PER 100 LINEAR FEET AT APPROXIMATELY EVERY OTHER 8' LIFT OR AT ALTERNATIVE LOCATIONS AND FREQUENCIES AS RECOMMENDED BY TESTING AGENCY.
COMPACTION TESTING TO BE DONE BY AN INDEPENDENT TESTING LABORATORY AND PAID FOR BY OWNER. CONTRACTOR SHALL COORDINATE AND SCHEDULE ALL REQUIRED TESTING AND GEOTECHNICAL WORK WITH CONSTRUCTION MANAGER.

CONTRACTOR IS RESPONSIBLE FOR ALL DEWATERING AS REQUIRED. DEWATERING SHALL BE INCIDENTAL TO THE PIPE INSTALLATION

G. TOPSOIL
STRIP, STOCKPILE AND RESPREAD EXISTING TOPSOIL IN ALL AREAS TO BE SODDED. THE DEPTH OF TOPSOIL SHALL BE A MINIMUM OF 6" AFTER NATURAL SETTLEMENT AND SHALL CONFORM SMOOTHLY TO THE ADJACENT LINES, GRADES AND ELEVATIONS. PROVIDE ADDITIONAL TOPSOIL IF EXISTING TOPSOIL IS NOT PROPERLY HANDLED AND PROTECTED.

H. SITE RESTORATION
SODDING: ALL DISTURBED AREAS ON THE SITE NOT TO BE PAVED OR LANDSCAPED SHALL RECEIVE SOD. SOD MATERIALS AND INSTALLATION SHALL MEET SUDAS SPECIFICATIONS. CONTRACTOR IS RESPONSIBLE FOR PREPARING SOD, APPLYING SOD AND WATERING THE SOD THE FIRST WEEK POST SOD PLACEMENT. OWNER WILL ASSUME RESPONSIBILITY OF WATERING AFTER ONE WEEK.

I. GEOTECHNICAL

CONTRACTOR SHALL REVIEW AND FOLLOW THE RECOMMENDATIONS OF THE GEOTECHNICAL REPORT FOR THE PROJECT.

1. IN AREAS UNDER AND WITHIN FIVE (5) FEET OF PROPOSED PAVING AND SIDEWALKS, THE CONTRACTOR SHALL REMOVE THE TOP 6 INCHES OF EXISTING FILL MATERIAL AND THEN SCARIFY, MOISTURE CONDITION AND COMPACT THE TOP 6 INCHES OF THE EXISTING FILL MATERIAL SUBGRADE PER THE REQUIREMENTS OF THIS SECTION.

2. AFTER STRIPPING AND EXCAVATING TO THE PROPOSED SUBGRADE LEVEL, THE PROPOSED PAVEMENT AREAS SHALL BE PROOFROLLED WITH A LOADED TANDEM AXLE DUMP TRUCK OR SIMILAR HEAVY RUBBER Tired VEHICLE.

3. FILL MATERIAL SHALL BE PLACED IN MAXIMUM COMPACTED LIFTS OF 3 INCHES FOR HAND COMPACTION EQUIPMENT AND 6 INCHES FOR RIDING COMPACTION EQUIPMENT. LEAN CLAY MATERIAL SHALL BE COMPACTED TO 95% OF MAXIMUM STANDARD PROCTOR DENSITY AND GRANULAR BASE MATERIAL SHALL BE COMPACTED TO 98% OF MAXIMUM STANDARD PROCTOR DENSITY.

4. COMPACTION TESTING OR PROOFROLLING SHALL BE COMPLETED ON A FREQUENCY OF ONE TEST PER 100 LINEAR FEET AT APPROXIMATELY EVERY OTHER 6' LIFT OR AT ALTERNATIVE LOCATIONS AND FREQUENCIES AS RECOMMENDED BY TESTING AGENCY. COMPACTION TESTING TO BE DONE BY AN INDEPENDENT TESTING LABORATORY AND PAID FOR BY OWNER. CONTRACTOR SHALL COORDINATE AND SCHEDULE ALL REQUIRED TESTING AND GEOTECHNICAL WORK WITH CONSTRUCTION MANAGER.

J. SIDEWALK RAMPS

ALL SIDEWALK RAMPS SHALL BE INSTALLED ACCORDING TO THE SIDEWALK RAMP DETAILS IN THESE DRAWINGS AND IN FULL COMPLIANCE WITH PROPOSED ACCESSIBILITY GUIDELINES FOR PEDESTRIAN FACILITIES IN THE PUBLIC RIGHT-OF-WAY (ALSO KNOWN AS PROWAG) AND THE AMERICANS WITH DISABILITIES ACT ACCESSIBILITY GUIDELINES.

CONTRACTOR IS RESPONSIBLE FOR ALL COMPLIANCE WITH CROSS SLOPE AND GRADE REQUIREMENTS FOR ALL EXISTING RAMPS WHICH ARE REQUIRED TO BE REMOVED AND REPLACED AS PART OF THE PROPOSED IMPROVEMENTS. ADJUSTMENTS TO EXISTING RAMPS SHOULD BE ANTICIPATED TO BRING ALL DISTURBED RAMPS INTO COMPLIANCE INCLUDING THE REMOVAL OF SOME ADDITIONAL PAVING TO ACCOMMODATE REQUIRED SIDEWALK GRADES. IF THE CONSTRUCTION CANNOT BE COMPLETED ACCORDING TO THE SPECIFIED LIMITS THE CONTRACTOR SHALL CONTACT THE ENGINEER PRIOR TO CONCRETE PLACEMENT TO REVIEW PROPOSED ADJUSTMENTS.

DETECTABLE WARNINGS/TRUNCATED DOMES: USE MANUFACTURED DETECTABLE WARNING PANELS WITH A NON-SLIP SURFACE AND RAISED TRUNCATED DOMES MEETING PROWAG DIMENSION AND PLACEMENT REQUIREMENTS. DETECTABLE WARNING PANELS SHALL BE CAST IRON.

K. PAINT STRIPING
STRIPES PARKING LOT PER IOWA DOT SPECIFICATIONS SECTION 2527. USE DURABLE PAINT PAVEMENT MARKINGS PER IOWA DOT SECTION 2527.02.D.2.C

L. LANDSCAPING MULCH

PROVIDE AND INSTALL HARDWOOD OR SOFTWOOD MULCH COMPLYING WITH IOWA DOT SPECIFICATION SECTION 9030 FOR ALL LANDSCAPE AREAS DISTURBED BY CONSTRUCTION. MULCH THICKNESS TO BE A MINIMUM OF 4"

M. LANDSCAPING

RESTORE ALL DISTURBED LANDSCAPED AREAS TO THEIR ORIGINAL CONDITION. FURNISH, PREPARE AND INSTALL PLANTER MATERIAL PER SUDAS SECTION 9030

N. WEED BARRIER

PROVIDE A COMMERCIAL GRADE WEED BARRIER FABRIC THAT ALLOWS WATER, AIR AND NUTRIENTS TO PASS THROUGH

DAS CC LOT 21 REPAIRS PHASE 3 (ORAN PAPE)

Table with 5 columns: DRAWN BY, APPROVED BY, ISSUED FOR, ISSUE DATE, PROJECT NUMBER. Values include BDD, CRB, CONSTRUCTION, 2025-03-07, 2240015870.

GENERAL NOTES

C001

SHIVE-HATTERY ARCHITECTURE + ENGINEERING

800.798.0313 | SHIVE-HATTERY.COM

IOWA DEPARTMENT OF ADMINISTRATIVE SERVICES 9437.00 215 E 7TH ST., DES MOINES, IA 50319

A

B



C

D

E

F

LEGEND

GENERAL SITE	
PLAN MARK	DESCRIPTION
	PCC PAVING REMOVAL
	BRICK REMOVAL

CD02

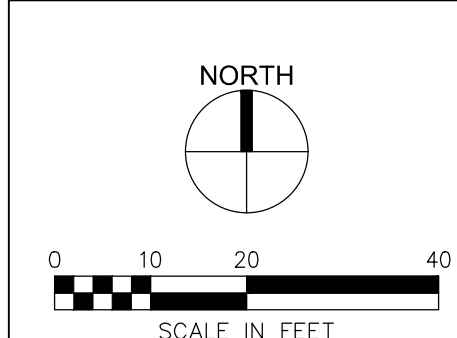
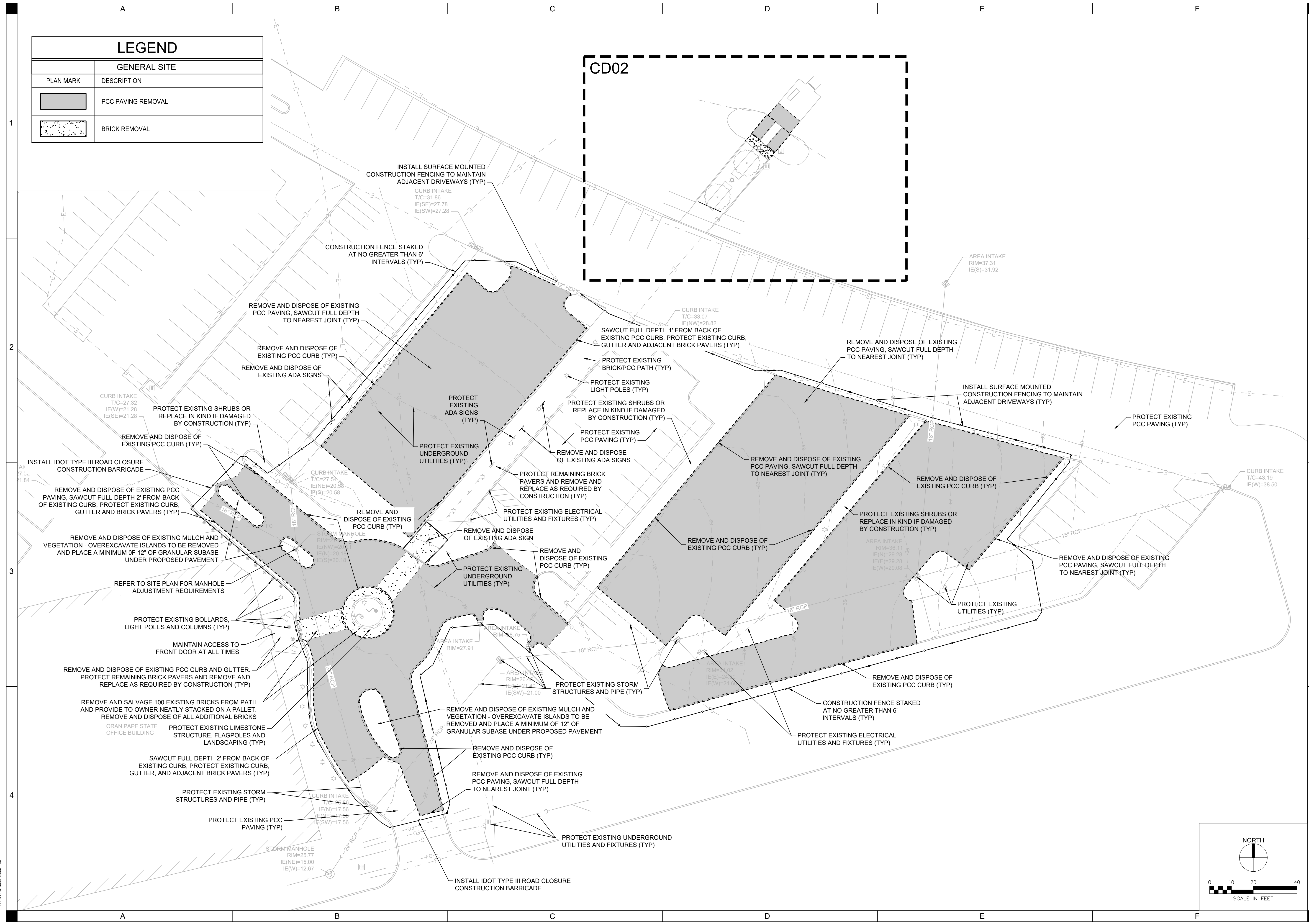

DAS CC LOT 21 REPAIRS PHASE 3 (ORAN PAPE)

BDD	CRB	CONSTRUCTION	2025-03-07	2240015870	I
DRAWN BY	APPROVED BY	ISSUED FOR	ISSUE DATE	PROJECT NUMBER	FIELD BOOK

EXISTING CONDITIONS AND DEMOLITION PLAN

CD01

P:\Projects\2025\20250307\20250307\CD01\EXISTING CONDITIONS AND DEMOLITION PLAN.dwg
 Plotted: 3/7/2025 9:02:31 AM

A

B

C



D

E

F

LEGEND

GENERAL SITE

PLAN MARK	DESCRIPTION
	PCC PAVING REMOVAL
	BRICK REMOVAL

1

2

3

4

A

B

C

D

E

F

P:\Projects\2025\20250315\20250315\DWG\Demolition\CD02.dwg
Printed: 3/20/25 9:02:57 AM

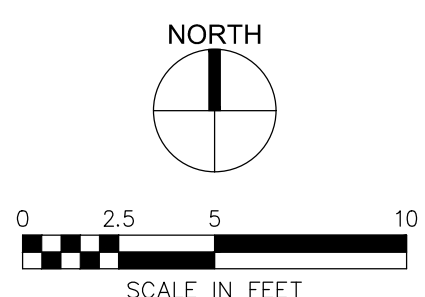
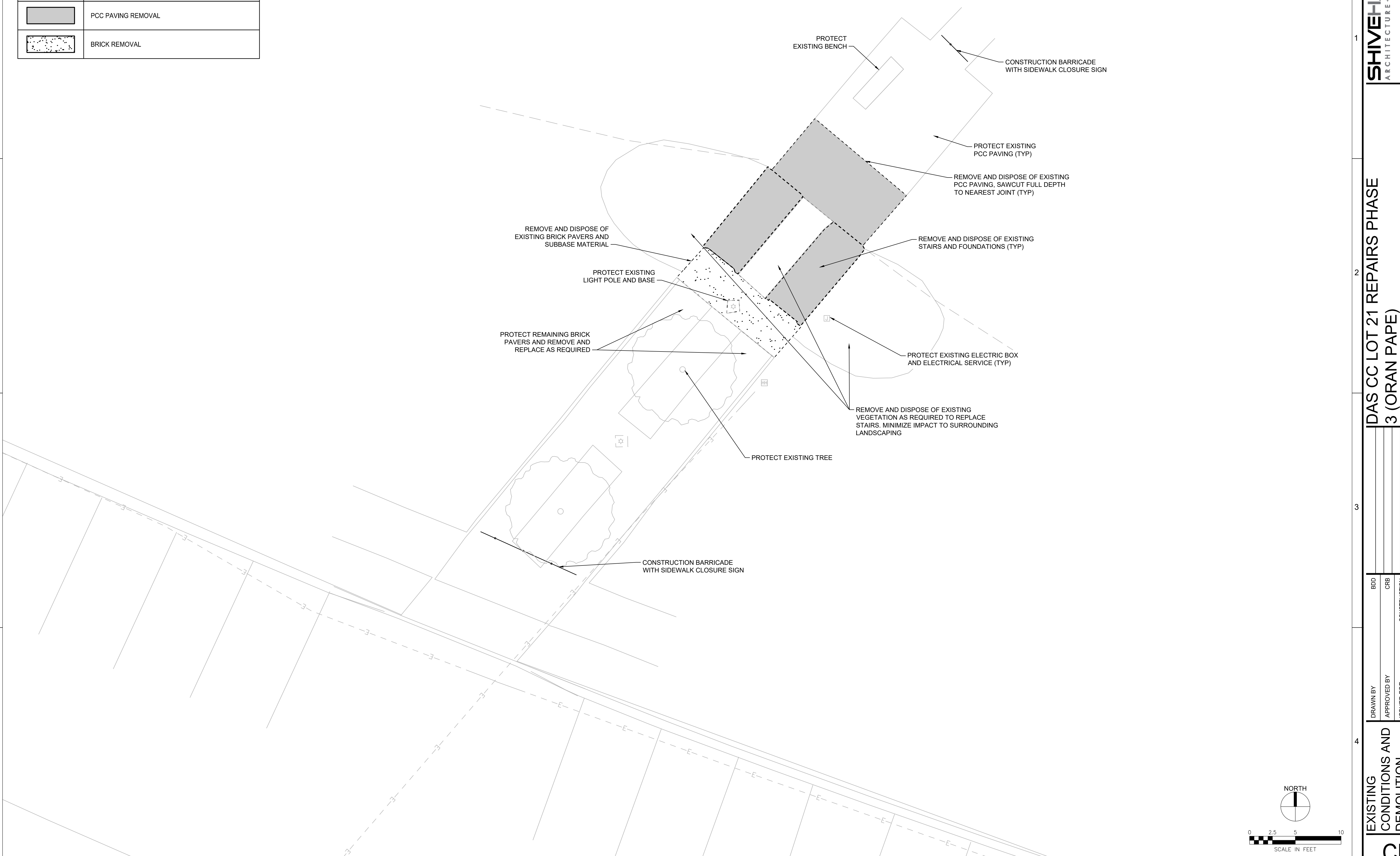

**DAS CC LOT 21 REPAIRS PHASE
3 (ORAN PAPE)**

IOWA DEPARTMENT OF ADMINISTRATIVE SERVICES
9437.00
215 E 7TH ST., DES MOINES, IA 50319

DRAWN BY	BDD
APPROVED BY	CRB
ISSUED FOR	CONSTRUCTION
ISSUE DATE	2025-03-07
PROJECT NUMBER	2240015870
FIELD BOOK	-

**EXISTING
CONDITIONS AND
DEMOLITION
PLAN**

CD02

LEGEND

GENERAL SITE	
PLAN MARK	DESCRIPTION
	6" PCC PAVING
	5" SIDEWALK PAVING
	SOD
	MULCH

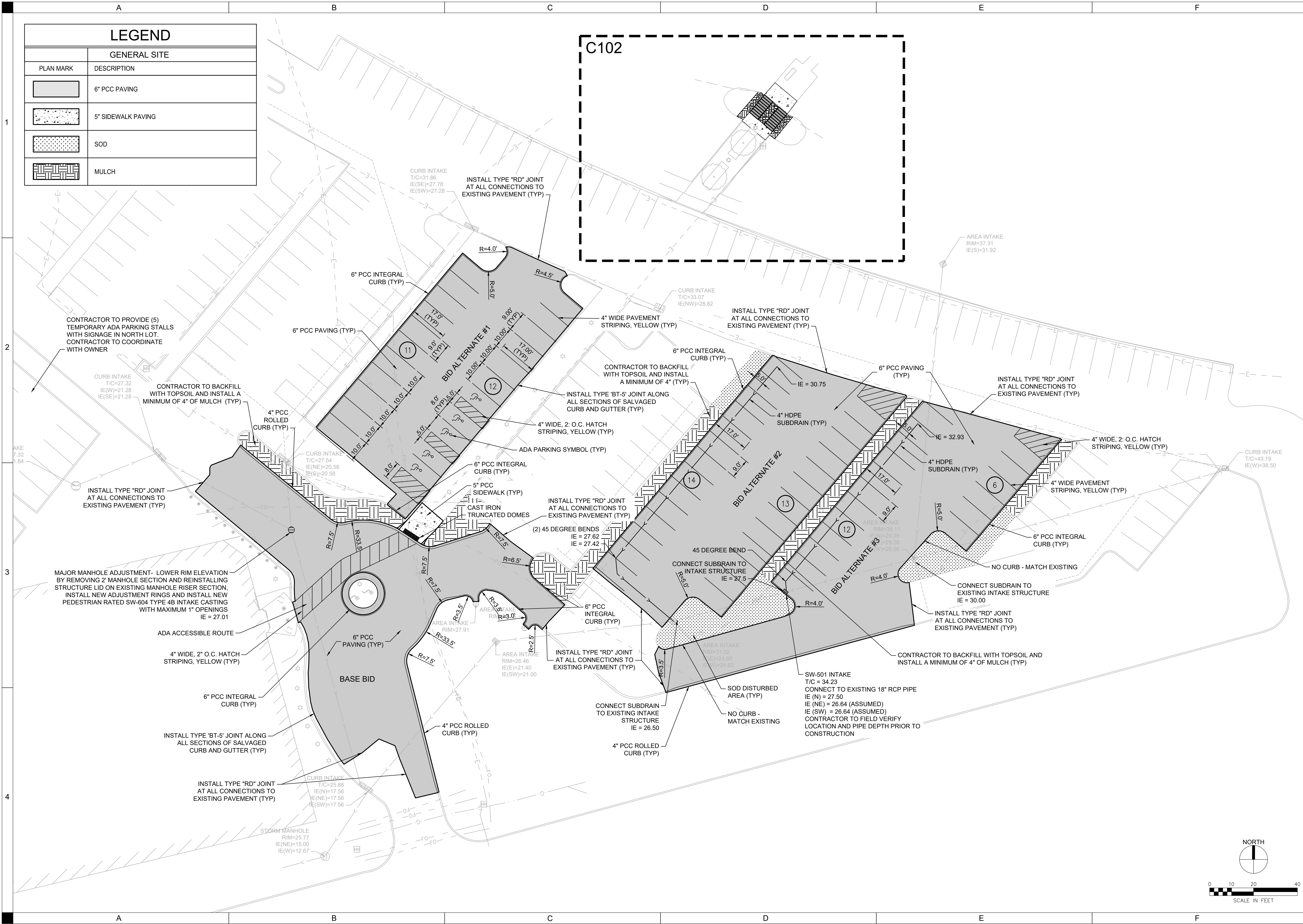

DAS CC LOT 21 REPAIRS PHASE 3 (ORAN PAEP)

DRAWN BY	BDD
APPROVED BY	CRB
ISSUED FOR	CONSTRUCTION
ISSUE DATE	2025-03-07
PROJECT NUMBER	2240015870
FIELD BOOK	1

SITE AND UTILITY PLAN

C101

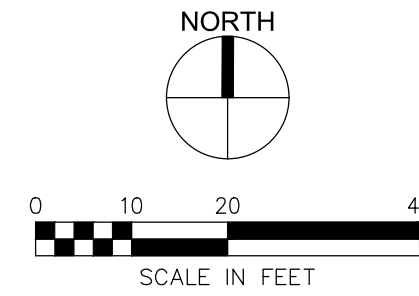

P:\Projects\2025\250315\25031506\msh\dwg\Grading\Grading_Plan.dwg
Printed: 3/20/25 9:41:52 AM

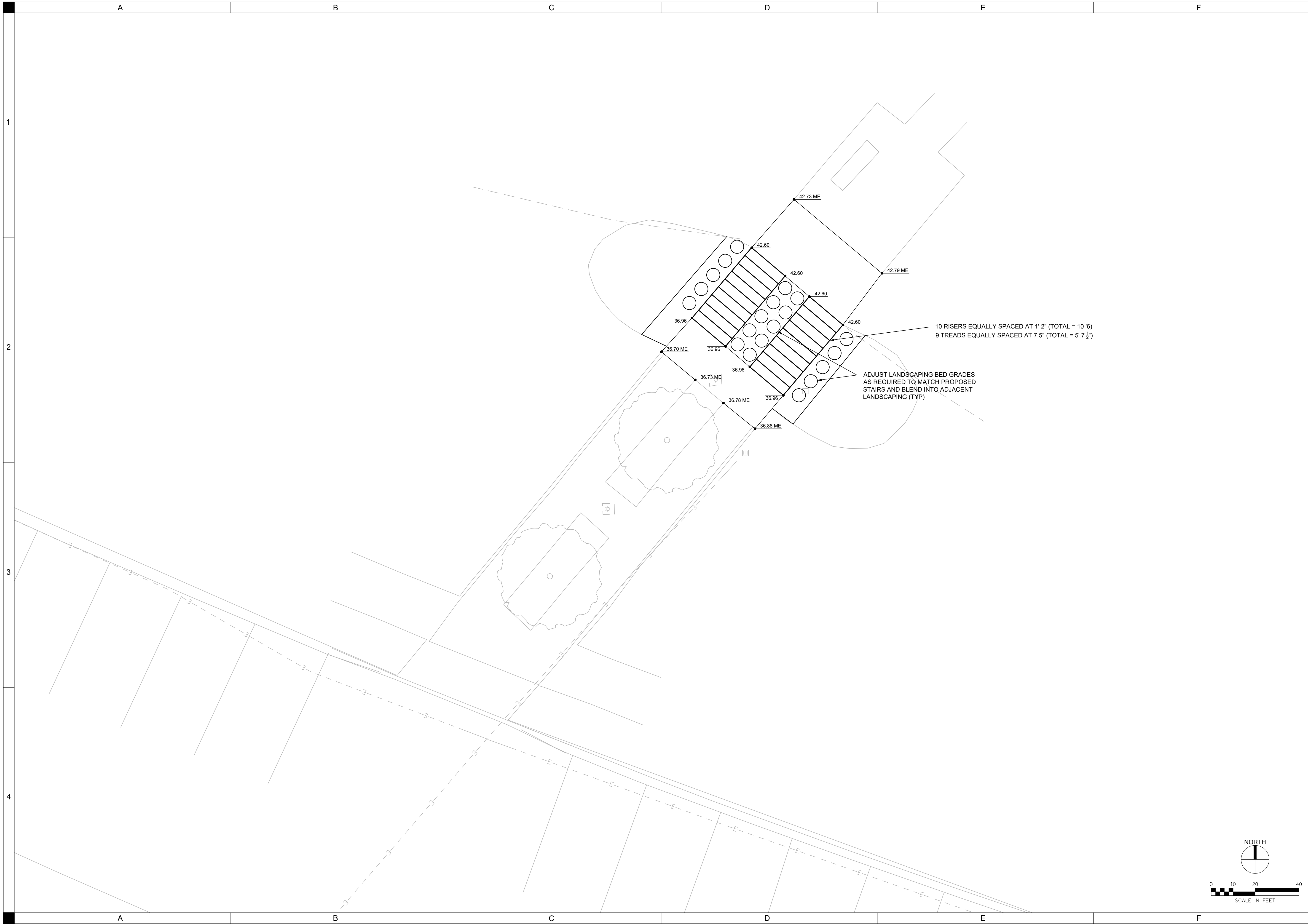

**DAS CC LOT 21 REPAIRS PHASE
3 (ORAN PAPE)**

IOWA DEPARTMENT OF ADMINISTRATIVE SERVICES
9437.00
215 E 7TH ST., DES MOINES, IA 50319

DRAWN BY	BDD
APPROVED BY	CRB
ISSUED FOR	CONSTRUCTION
ISSUE DATE	2025-03-07
PROJECT NUMBER	2240015870
FIELD BOOK	--

GRADING PLAN

C202

A

B

C

D

E

F

1

2

3

4

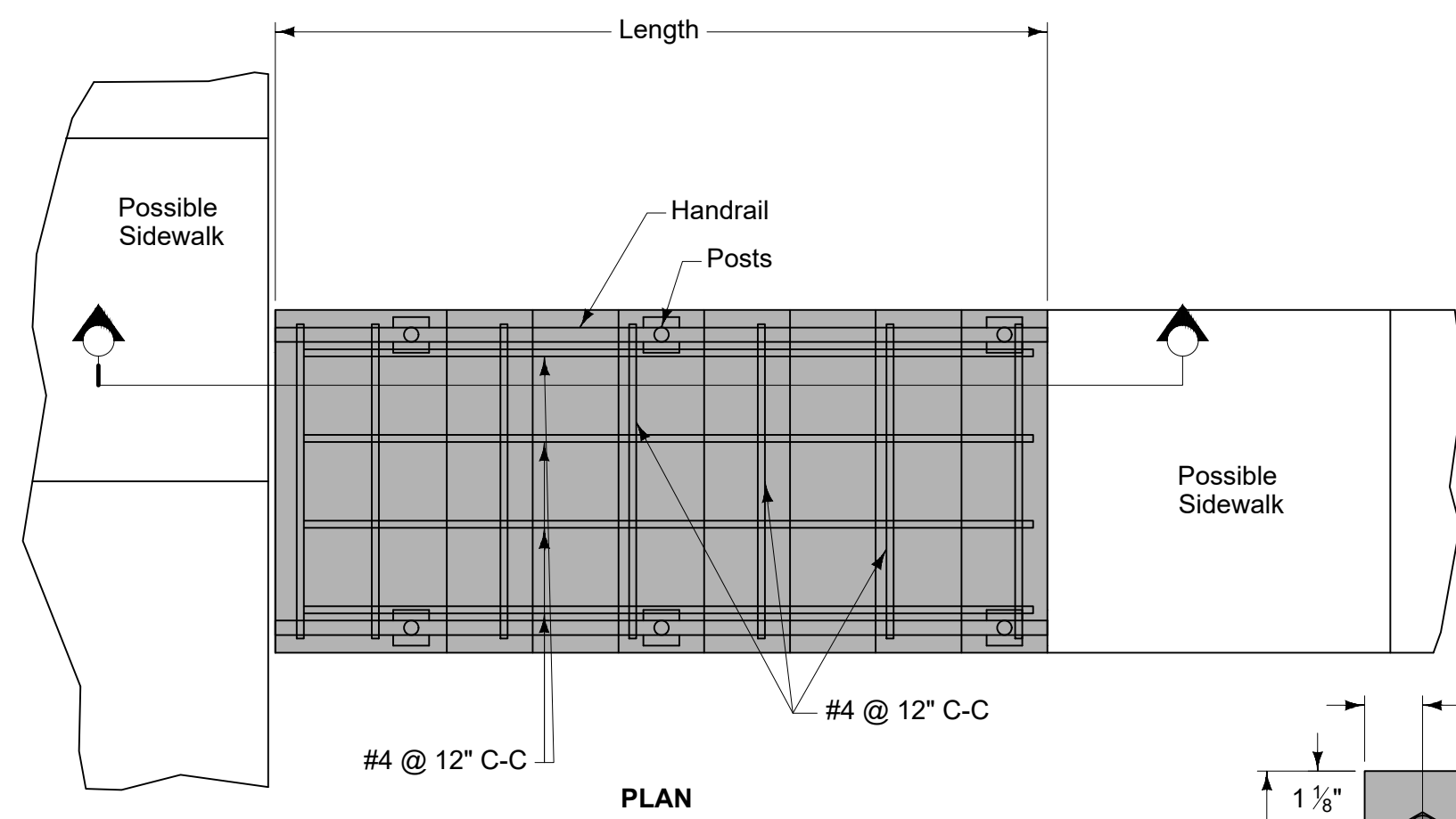

PLAN

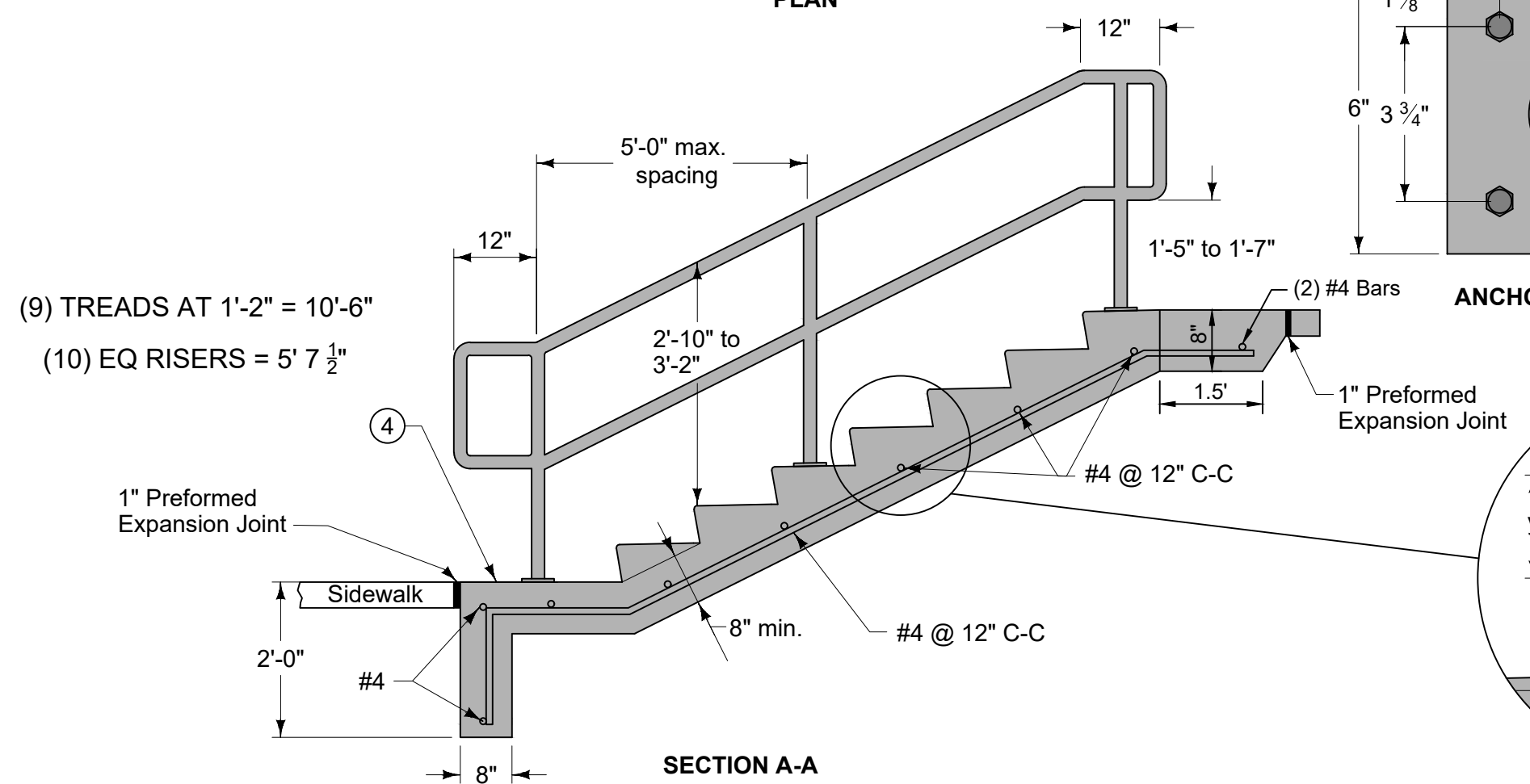

SECTION A-A

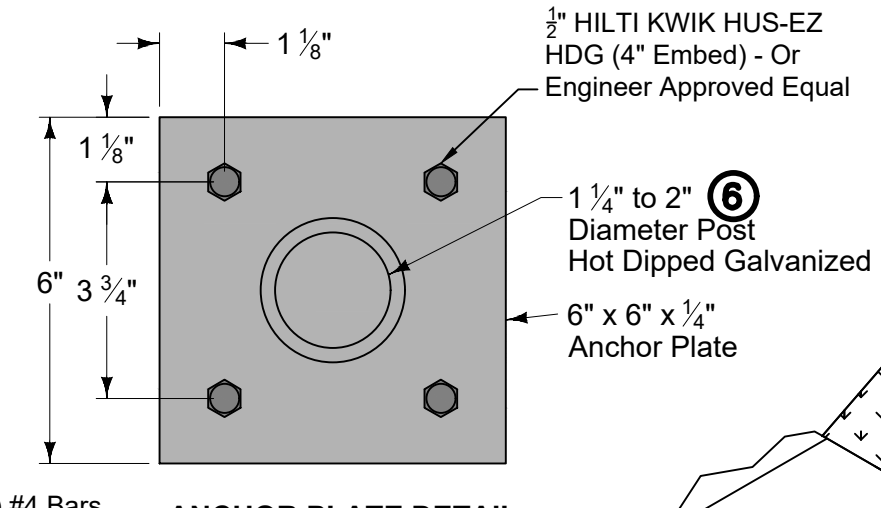

ANCHOR PLATE DETAIL

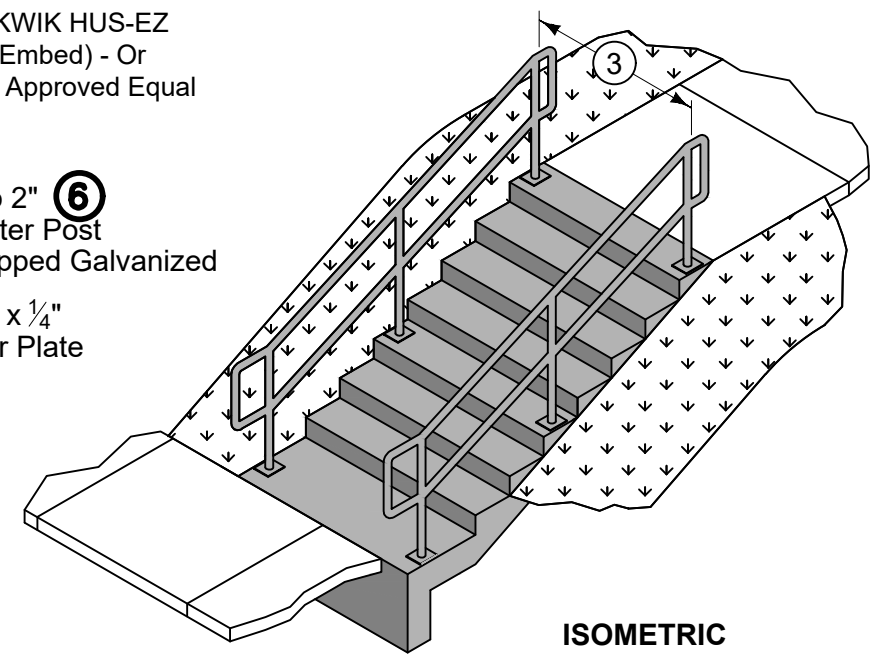

ISOMETRIC

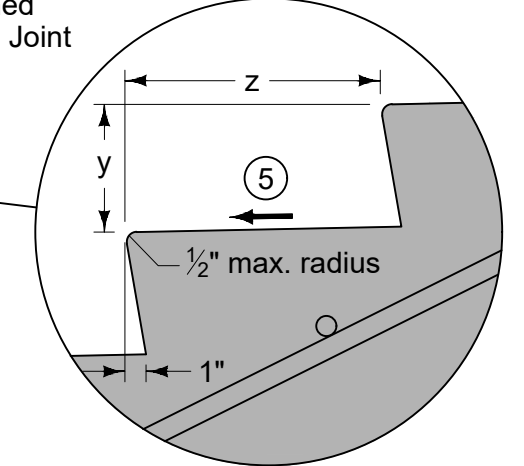

NOTE: SIMILAR TO SUDAS 9080.101

- Provide a minimum of 2 inches of cover for all reinforcing.
- Ensure all risers are an equal height and all treads are an equal depth within a flight of stairs.
- 1 Minimum riser height is 4 inches. Maximum riser height is 7 inches.
 - 2 Minimum tread depth is 11 inches.
 - 3 5' centered on stairs
 - 4 Construct cross slope of landing to match adjacent sidewalk.
 - 5 Slope tread 1% minimum to 2% maximum in any direction.
 - 6 Weld post to anchor plate with 1/4 inch weld. Grind weld to provide smooth surface, free of burrs.

C4 PCC STAIRS NOT TO SCALE

A

B

C

D

E

F

P:\Projects\20250307\20250307\DWG\CONSTRUCTION DETAILS.dwg
Printed: 3/7/2025 9:05:18 AM

DAS CC LOT 21 REPAIRS PHASE 3 (ORAN PAPE)

IOWA DEPARTMENT OF ADMINISTRATIVE SERVICES
9437.00
215 E 7TH ST., DES MOINES, IA 50319

BDD	CRB	CONSTRUCTION	2025-03-07	2240015870	I
DRAWN BY	APPROVED BY	ISSUED FOR	ISSUE DATE	PROJECT NUMBER	FIELD BOOK

CONSTRUCTION DETAILS

C502