



C:\Users\Zach Gunsolley\Desktop\25-04-83-03 Prairie Rose Accessibility Improvements\25-04-83-03 Plans.dwg

Plot Date: 5/1/2026 11:00 AM



Drawn by: ZG	
Revision	Date

C:\Users\Zach Gunsolley\Desktop\25-04-83-03 Prairie Rose Accessibility Improvements\25-04-83-03 Plans.dwg

Plot Date: 5/1/2026 11:00 AM

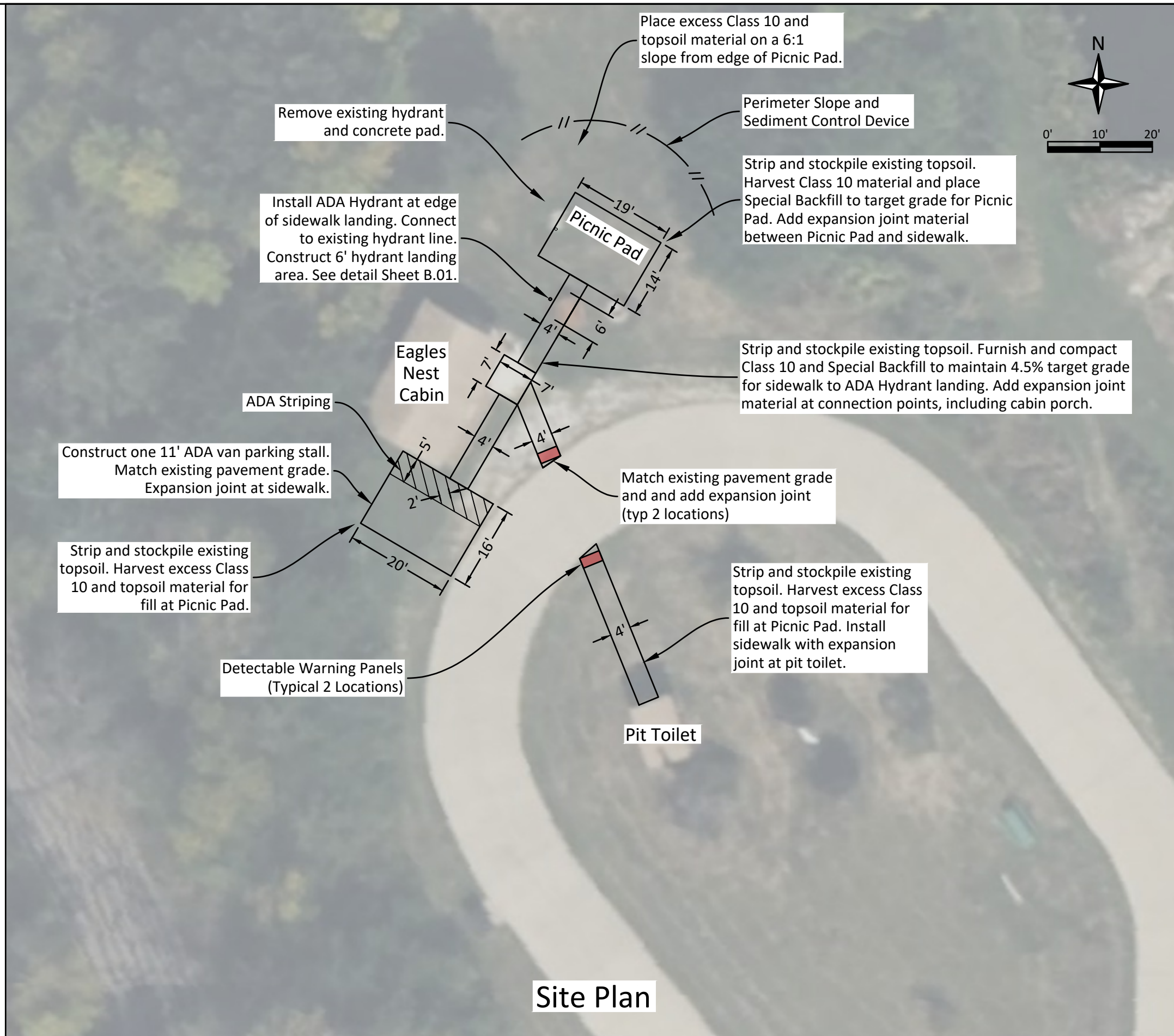

### Site Plan



Drawn by: ZG	
Revision	Date

C:\Users\Zach Gunsolley\Desktop\25-04-83-03 Prairie Rose Accessibility Improvements\25-04-83-03 Plans.dwg  
Plot Date: 5/1/2026 11:00 AM

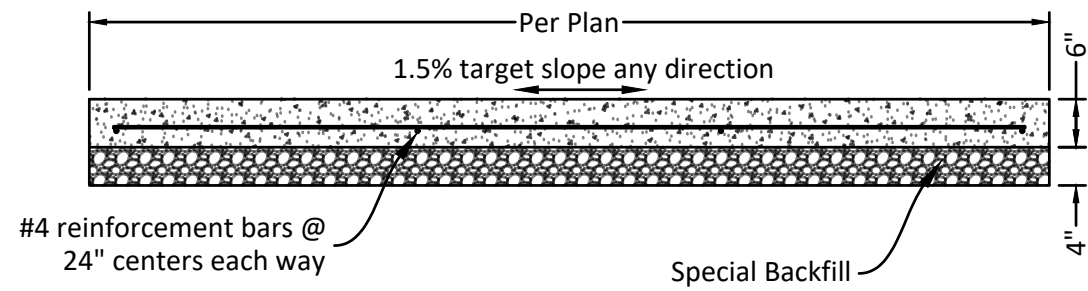

### Parking Stall

Not to Scale

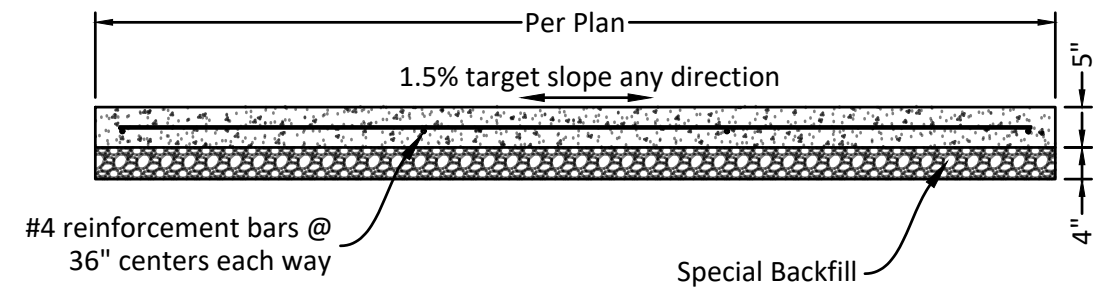

### Picnic Pad

Not to Scale

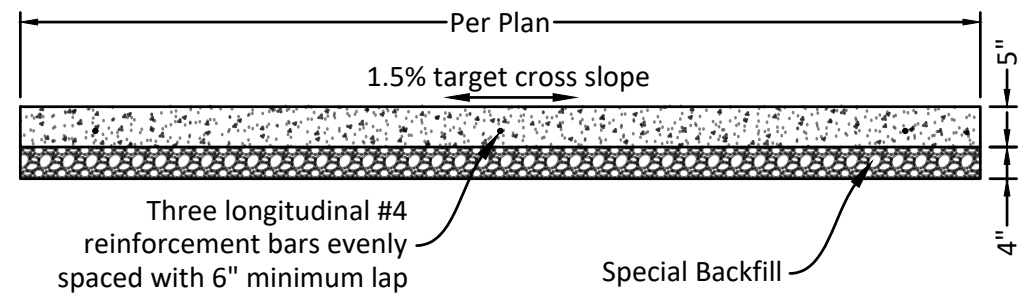

### Sidewalk/Hydrant Landing Detail

Not to Scale

C:\Users\Zach Gunsolley\Desktop\25-04-83-03 Prairie Rose Accessibility Improvements\25-04-83-03 Plans.dwg

Plot Date: 5/1/2026 11:00 AM

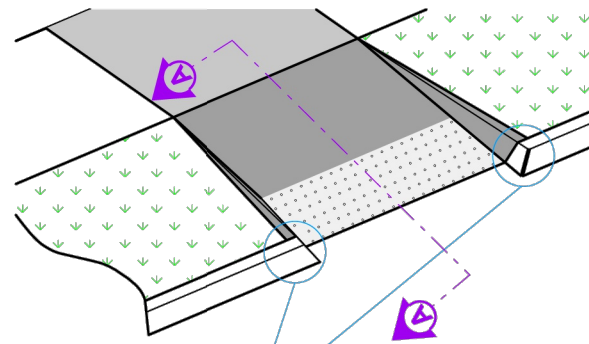

See Detail 'A'

**CURB RAMP PERPENDICULAR TO CURB**

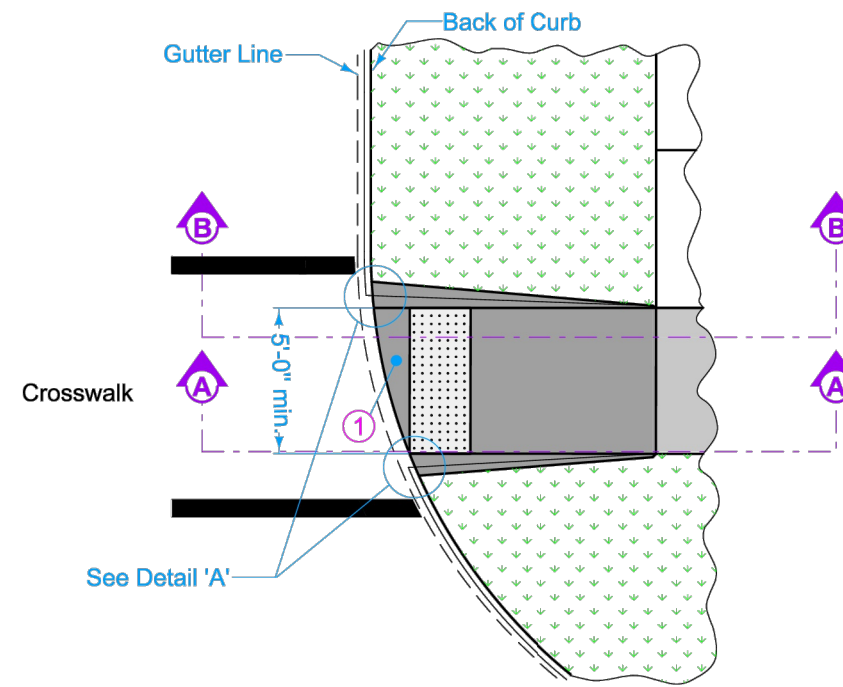

See Detail 'A'

**CURB RAMP NOT PERPENDICULAR TO CURB**

- ① Unless curb ramp is aligned perpendicular to the street radius, provide an area of special shaping at the bottom of the ramp. This area allows the grade break at the bottom of the ramp to be perpendicular to the ramp and provides a smooth transition to gutterline for wheelchair access.
- ② Use vertical curb adjacent to ramp unless flares are specified in the project plans. Install Detectable Warnings so that no gap is left between warning panel and base of curb.

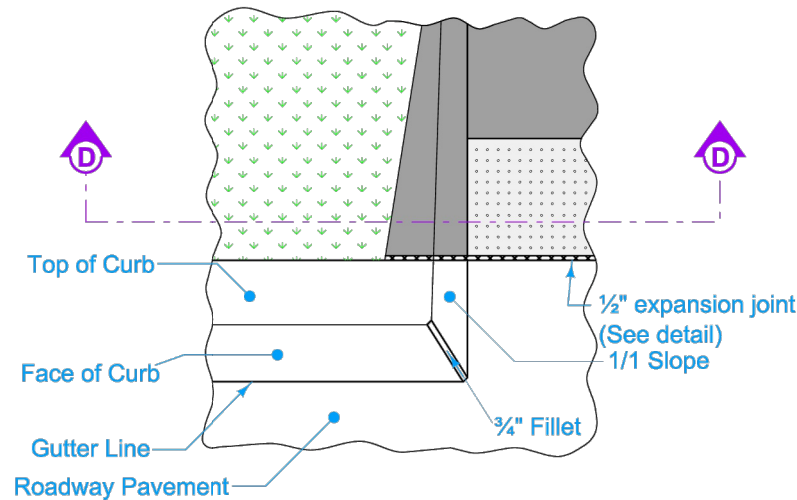

**DETAIL 'A'**

LEGEND	
	Ramp
	Landing
	Detectable Warnings
	Vegetation

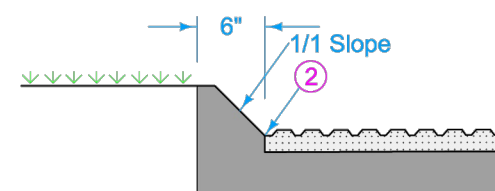

**SECTION D-D**

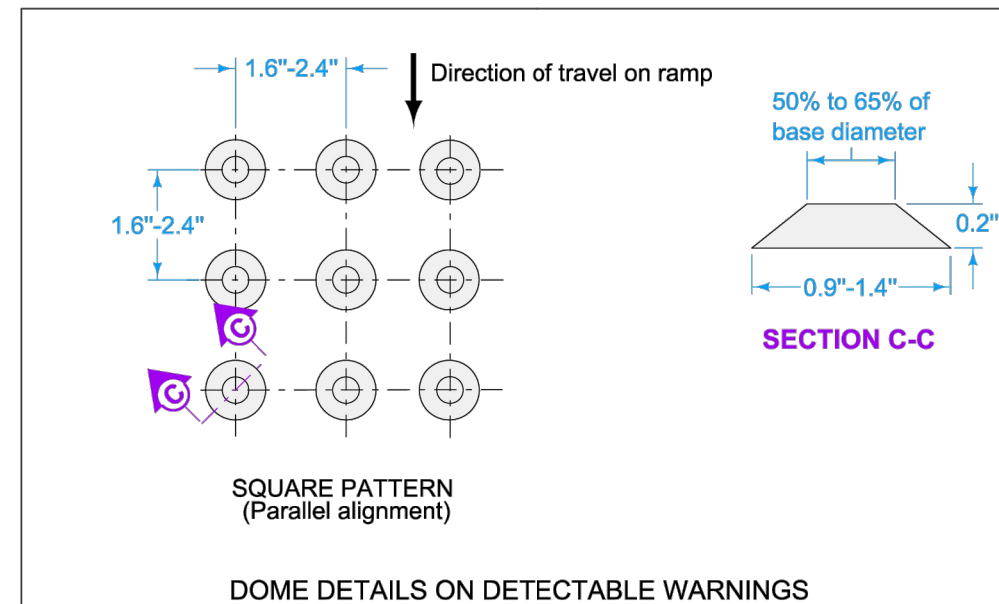

**SQUARE PATTERN (Parallel alignment)**

**DOMES ON DETECTABLE WARNINGS**

Possible Contract Items:  
 Detectable Warnings  
 Sidewalk, P.C. Concrete, 6 in.  
 Sidewalk, P.C. Concrete, 4 in.  
 Removal of Sidewalk

Possible Tabulation:  
 113-1

<b>IOWA DOT</b>	REVISION	
	7	04-15-25
<b>STANDARD ROAD PLAN</b>		<b>MI-220</b>
		SHEET 1 of 3
REVISIONS: Changed 'E' joint to 1/2" expansion joint, added expansion joint detail Changed curb end to 1/1 slope.		
 APPROVED BY DESIGN METHODS ENGINEER		

**DETECTABLE WARNINGS AND PEDESTRIAN RAMP**



Drawn by: ZG
Revision
Date

Plot Date: 5/1/2026 11:00 AM C:\Users\Zach Gunsolley\Desktop\25-04-83-03 Prairie Rose Accessibility Improvements\25-04-83-03 Plans.dwg

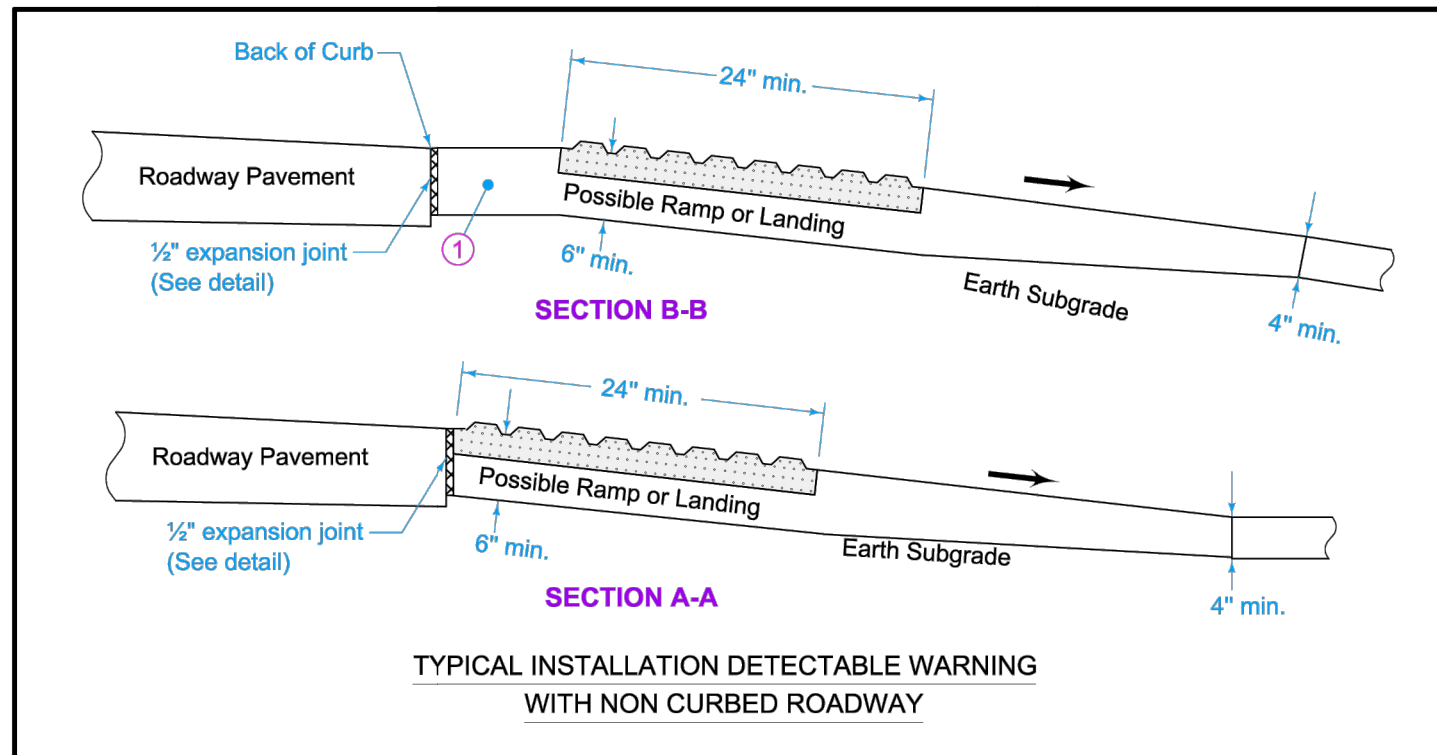

TYPICAL INSTALLATION DETECTABLE WARNING WITH NON CURBED ROADWAY

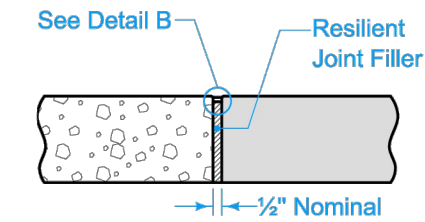

1/2" EXPANSION JOINT DETAIL

- ① Unless curb ramp is aligned perpendicular to the street radius, provide an area of special shaping at the bottom of the ramp. This area allows the grade break at the bottom of the ramp to be perpendicular to the ramp and provides a smooth transition to gutterline for wheelchair access.
- ④ Edge with 1/4 inch tool for length of joint indicated if formed; edging not required when cut with diamond blade saw.

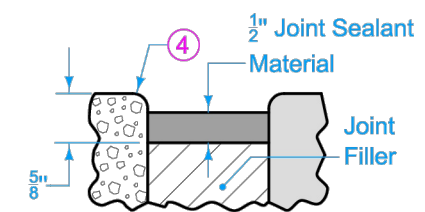

DETAIL B

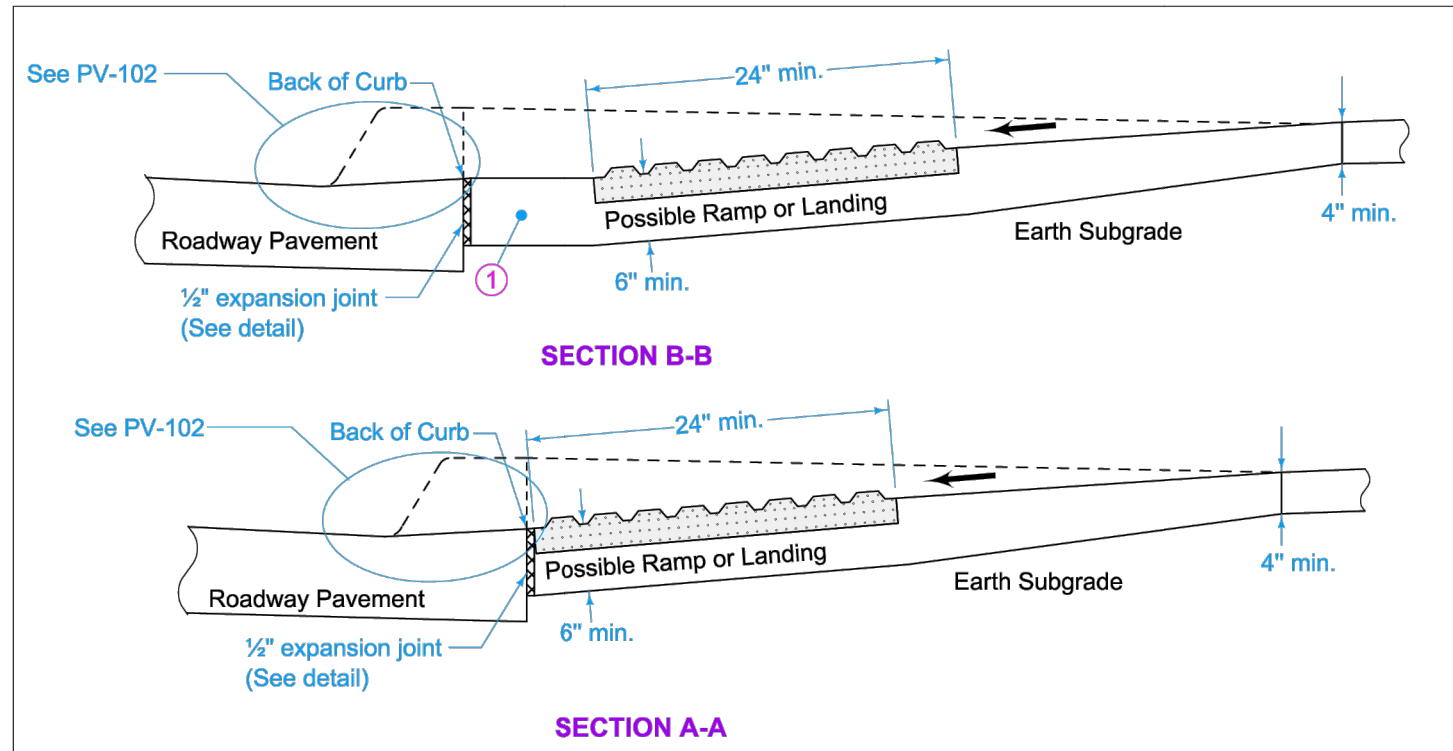

TYPICAL INSTALLATION DETECTABLE WARNING WITH CURBED ROADWAY

LEGEND	
	Ramp
	Landing
	Detectable Warnings
	Vegetation

 <b>STANDARD ROAD PLAN</b>	REVISION	
	7	04-15-25
<b>MI-220</b>		SHEET 2 of 3
<small>REVISIONS: Changed 'E' joint to 1/2" expansion joint, added expansion joint detail                  Changed curb end to 1/1 slope.</small>		
 <small>APPROVED BY DESIGN METHODS ENGINEER</small>		
DETECTABLE WARNINGS AND PEDESTRIAN RAMP		



Drawn by: ZG
Revision
Date

Plot Date: 5/1/2026 11:00 AM C:\Users\Zach Gunsoley\Desktop\25-04-83-03 Prairie Rose Accessibility Improvements\25-04-83-03 Plans.dwg

## Estimated Quantities

Item	Description	Quantity	Unit
1	2102-0425070 Special Backfill	26	Tons
2	2102-2710070 Excavation, Cl 10, Roadway and Borrow	20	CY
3	2105-8425015 Topsoil, Strip, Salvage and Spread	16	CY
4	2312-8260051 Granular Surfacing	13	Tons
5	2511-7526005 Sidewalk, Reinforced PCC, 5 In.	43	SY
6	2511-7526010 Picnic Pad, Reinforced PCC, 5 In.	30	SY
7	2511-7528101 Detectable Warnings	16	SF
8	2515-2475006 Parking Stall, Reinforced PCC, 6 In.	36	SY
9	2526-8285000 Construction Survey	1	LS
10	2527-9263209 ADA Striping	1	LS
11	2533-4980005 Mobilization	1	LS
12	2554-0211001 ADA Hydrant and Service Connection	1	LS
13	2601-2634105 Mulching, Bonded Fiber Matrix	0.05	Acre
14	2601-2636044 Seeding and Fertilizing (Urban)	0.05	Acre
15	2602-0000309 Perimeter & Slope Sediment Control	50	LF

## Estimate Reference Information

1. See referenced IDOT specification and Sheet B.01. In fill areas, place and compact after Class 10 placement.
2. See referenced IDOT specification. Place and compact in fill areas below special backfill and topsoil.
3. See referenced IDOT specification. Place in areas after Class 10 placement.
4. See referenced IDOT specification. Place on granular-surfaced parking areas disturbed by construction.
- 5,6. See referenced IDOT specification and Sheet A.03 and B.01. Class C mix, Class 2 durability coarse aggregate.
7. See referenced IDOT specification, Sheet A.03, B.02 and B.03.
8. See referenced IDOT specification and Sheet A.03 and B.01. Class C mix, Class 2 durability coarse aggregate.
9. See referenced IDOT specification. This item includes all necessary survey and staking to complete work in accordance with the Contract Documents and 2010 ADA Standards. Non-compliant work shall be removed and replaced at the sole expense of the contractor. Noteworthy ADA requirements:
  - A. 2% maximum cross slope on sidewalks.
  - B. 5% maximum running slope on sidewalks.
  - C. 2% maximum slope in any direction on parking stalls, landing areas, access aisles.
10. See referenced IDOT specification and Sheet A.03.
11. See referenced IDOT specification.
12. See referenced IDOT specification and Sheet A.03. Furnish and install Woodford S4H, 5 Ft bury, per manufacturer's recommendations. Includes all labor, equipment, and materials necessary for this work and removal of existing hydrant and concrete pad, connection to existing hydrant service line, disinfection, and flushing.
- 13-14. See referenced IDOT specification.
15. See referenced IDOT specification and Sheet A.03.

## General Information

1. Verify actual locations and elevations with DNR Engineer.
2. All work shall conform to and be performed in accordance with all applicable codes and ordinances.
3. The contractor shall visit the site and inspect the project area and thoroughly familiarize themselves with the actual job conditions prior to bidding and the start of work. Failure to visit the project site shall not relieve the contractor from performing the work in accordance to the plans, specification, special provisions and contract.
4. The contractor shall verify, at the site, all dimensions and conditions shown on the plans and shall notify the DNR Engineer of any discrepancies, omissions, and/or conflicts prior to proceeding with the work.
5. It shall be the contractor's responsibility to provide waste areas or disposal sites for excess material (excavated material or broken concrete) which is not desirable to be incorporated into the work involved on this project. No payment for overhaul will be allowed for material hauled to these sites. No material shall be placed within the right-of-way, unless specifically stated in the plans or approved by the DNR Engineer.
6. The contractor shall not disturb desirable grass areas and desirable trees outside the construction limits. The contractor will not be permitted to park or service vehicles and equipment or use these areas for storage of materials. Storage, parking and service areas will be subject to the approval of the DNR Engineer.
7. Where utilities and fixtures are shown as Existing on the plans or encountered within the construction area, it shall be the responsibility of the contractor to notify the DNR Engineer of those utilities prior to the beginning of any construction. The contractor shall be afforded access to these facilities for necessary modification of services. Underground facilities, structures and utilities have been plotted from available surveys and records and therefore their locations must be considered approximate only. It is possible there may be others, the existence of which is presently not known or shown. It is the contractor's responsibility to determine their existence and exact location and to avoid damage thereto. No claims for additional compensation will be allowed to the contractor for any interference or delay caused by such work.
8. The contractor shall shape graded area to maintain surface drainage. All elevations are to finish grade.
9. The contractor is expected to have materials, equipment, and labor available on a daily basis to install and maintain erosion control features on the project. This may involve seeding, silt fence, rock ditch checks, silt basins or silt dikes.
10. The Iowa DOT Standard Specifications for Highway and Bridge Construction, Series 2023, plus General Supplemental Specifications and Supplemental Specifications effective at the time of letting, shall apply to this project. The item's description includes applicable IDOT specification sections.
11. Work Restrictions: Work cannot begin until September 28, 2026. This includes mobilization.



Drawn by: ZG	
Revision	Date