

IOWA DEPARTMENT OF ADMINISTRATIVE SERVICES

CONSTRUCTION PLANS FOR

9450.00 MOUNT PLEASANT CORRECTIONAL FACILITY

NORTH PARKING LOT REPLACEMENT

MOUNT PLEASANT, IA

APRIL, 2025

GOVERNING SPECIFICATIONS

THE 2025 EDITION OF THE "IOWA STATEWIDE URBAN SPECIFICATIONS FOR PUBLIC IMPROVEMENTS".

MUTCD 2009 AS ADOPTED BY IOWA DEPARTMENT OF TRANSPORTATION.

ALL APPLICABLE FEDERAL, STATE, AND LOCAL LAWS AND ORDINANCES WILL BE COMPLIED WITHIN THE CONSTRUCTION OF THIS PROJECT.



NOTE: EXISTING UTILITY INFORMATION SHOWN ON THIS PLAN HAS BEEN PROVIDED BY THE UTILITY OWNER. THE CONTRACTOR SHALL FIELD VERIFY EXACT LOCATIONS PRIOR TO COMMENCING CONSTRUCTION AS REQUIRED BY STATE LAW. NOTIFY IOWA ONE CALL 1-800-292-8989 OR 811

THE SUBSURFACE UTILITY INFORMATION IN THIS PLAN IS UTILITY QUALITY LEVEL D UNLESS OTHERWISE NOTED. THIS UTILITY LEVEL WAS DETERMINED ACCORDING TO THE GUIDELINES OF CI/ASCE 38-02, ENTITLED "STANDARD GUIDELINES FOR THE COLLECTION AND DEPICTION OF EXISTING SUBSURFACE UTILITY DATA."

PROJECT LOCATION

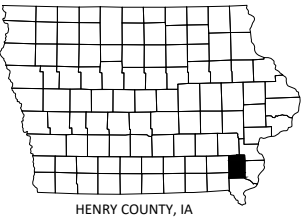

MAP OF THE CITY OF MOUNT PLEASANT HENRY COUNTY, IA

SHEET INDEX			
SHEET NUMBER	SHEET TITLE	REVISION	ISSUE DATE
A.01	TITLE SHEET	0	04/15/2025
A.02	LEGEND SHEET	0	04/15/2025
B.01	TYPICAL SECTION AND DETAILS	0	04/15/2025
B.02	TYPICAL DETAILS	0	04/15/2025
C.01	ESTIMATE REFERENCE NOTES	0	04/15/2025
C.02	GENERAL NOTES	0	04/15/2025
D.01	PLAN LAYOUT	0	04/15/2025
D.02	JOINTING AND ELEVATIONS	0	04/15/2025
F.01	REMOVALS	0	04/15/2025
G.01	CONTROL POINTS & ALIGNMENT DATA	0	04/15/2025
J.01	STAGING	0	04/15/2025
M.01	SUBDRAIN PLAN AND PROFILE	0	04/15/2025
M.02	SUBDRAIN PLAN AND PROFILE	0	04/15/2025
N.01	PAVEMENT MARKINGS & SIGNAGE	0	04/15/2025
R.01	EROSION CONTROL PLAN	0	04/15/2025
S.01	ADA RAMP	0	04/15/2025

I HEREBY CERTIFY THAT THIS ENGINEERING DOCUMENT WAS PREPARED BY ME OR UNDER MY DIRECT PERSONAL SUPERVISION AND THAT I AM A DULY LICENSED PROFESSIONAL ENGINEER UNDER THE LAWS OF THE STATE OF IOWA.

FORREST A. MARTINSON

LIC. NO. P28860 DATE: 04/15/2025

MY LICENSE RENEWAL DATE IS 12/31/2025

PAGES OR SHEETS COVERED BY THIS SEAL:

ALL SHEETS

© Bolton & Menk, Inc. 2025. All Rights Reserved. 14747 PM



430 E GRAND AVENUE, SUITE 101
DES MOINES, IA 50309
Phone: (515) 259-9190
Email: DesMoines@bolton-menk.com
www.bolton-menk.com

DESIGNED	REV	DESCRIPTION	DATE
FAM	0	100% CD - FOR BID	04/15/2025
DRAWN			
TJN			
CHECKED			
FAM			
CLIENT PROJ. NO.			
9450.000			

IOWA DEPARTMENT OF ADMINISTRATIVE SERVICES

MOUNT PLEASANT CORRECTIONAL FACILITY - NORTH PARKING LOT REPLACEMENT

TITLE SHEET

SHEET

A.01

THIS SHEET SET IS INTENDED TO BE PLOTTED IN COLOR

© Bolton & Menk, Inc. 2025. All Rights Reserved.
PL:\ADMIN\511\1024\38674607\CD\138674A01.dwg 4/15/2025 1:47:48 PM

EXISTING TOPOGRAPHIC SYMBOLS

	ACCESS GRATE		REGULATION STATION GAS
	AIR CONDITION UNIT		SATELLITE DISH
	ANTENNA		SIGN TRAFFIC
	AUTO SPRINKLER CONNECTION		SIGNAL CONTROL CABINET
	BARRICADE PERMANENT		SOIL BORING
	BASKETBALL POST		SIREN
	BENCH		TELEPHONE BOOTH
	BIRD FEEDER		TILE INLET
	BOLLARD		TILE OUTLET
	BUSH		TILE RISER
	CATCH BASIN RECTANGULAR CASTING		TRANSFORMER-ELECTRIC
	CATCH BASIN CIRCULAR CASTING		TREE-CONIFEROUS
	CURB STOP		TREE-DEAD
	CLEAN OUT		TREE-DECIDUOUS
	CULVERT END		TREE STUMP
	DRINKING FOUNTAIN		TRAFFIC ARM BARRIER
	DOWN SPOUT		TRAFFIC SIGNAL
	ELECTRIC CAR CHARGE STATION		TRASH CAN
	FILL PIPE		UTILITY MARKER
	FIRE HYDRANT		VALVE
	FLAG POLE		VALVE POST INDICATOR
	FLARED END / APRON		VALVE VAULT
	FUEL PUMP		VAULT
	GRILL		VENT PIPE
	GUY WIRE ANCHOR		WATER SPIGOT
	HANDHOLE		WELL
	HANDICAP SPACE		WETLAND DELINEATED MARKER
	IRRIGATION SPRINKLER HEAD		WETLAND
	IRRIGATION VALVE BOX		WET WELL
	LIFT STATION CONTROL PANEL		YARD HYDRANT
	LIFT STATION		
	LIGHT POLE		
	MAILBOX		
	MANHOLE-COMMUNICATION		
	MANHOLE-ELECTRIC		
	MANHOLE-GAS		
	MANHOLE-HEAT		
	MANHOLE-RECLAIMED WATER		
	MANHOLE-SANITARY SEWER		
	MANHOLE-STORM SEWER		
	MANHOLE-UTILITY		
	MANHOLE-WATER		
	METER		
	DRIVE-THRU MICROPHONE		
	PARKING METER		
	PAVEMENT MARKING		
	PEDESTAL-COMMUNICATION		
	PEDESTAL-ELECTRIC		
	PEDESTRIAN PUSH BUTTON		
	PICNIC TABLE		
	POLE-UTILITY		
	POST		
	RAILROAD SIGNAL POLE		

PROPOSED TOPOGRAPHIC SYMBOLS

	CLEANOUT
	MANHOLE
	LIFT STATION
	STORM SEWER CIRCULAR CASTING
	STORM SEWER RECTANGULAR CASTING
	STORM SEWER FLARED END / APRON
	STORM SEWER OUTLET STRUCTURE
	STORM SEWER OVERFLOW STRUCTURE
	CURB BOX
	FIRE HYDRANT
	WATER VALVE
	WATER REDUCER
	WATER BEND
	WATER TEE
	WATER CROSS
	WATER SLEEVE
	WATER CAP / PLUG
	RIP RAP
	DRAINAGE FLOW
	TRAFFIC SIGNS
	LIGHT POLE

SURVEY SYMBOLS

	BENCHMARK LOCATION		CAST IRON MONUMENT
	CONTROL POINT		STONE MONUMENT
	MONUMENT FOUND		

EXISTING TOPOGRAPHIC LINES

	RETAINING WALL
	FENCE
	FENCE-DECORATIVE
	GUARD RAIL
	TREE LINE
	BUSH LINE

SURVEY LINES

	CONTROLLED ACCESS
	BOUNDARY
	CENTERLINE
	EXISTING EASEMENT LINE
	PROPOSED EASEMENT LINE
	EXISTING LOT LINE
	PROPOSED LOT LINE
	EXISTING RIGHT-OF-WAY
	PROPOSED RIGHT-OF-WAY
	SETBACK LINE
	SECTION LINE
	QUARTER LINE
	SIXTEENTH LINE
	TEMPORARY EASEMENT

EXISTING UTILITY LINES

	FORCEMAIN
	SANITARY SEWER
	SANITARY SERVICE
	STORM SEWER
	STORM SEWER DRAIN TILE
	WATERMAIN
	WATER SERVICE
	RECLAIMED WATER

PROPOSED UTILITY LINES

	FORCEMAIN
	SANITARY SEWER
	SANITARY SERVICE
	STORM SEWER
	STORM SEWER DRAIN TILE
	WATERMAIN
	WATER SERVICE
	PIPE CASING
	TRENCHLESS PIPE (PLAN VIEW)
	TRENCHLESS PIPE (PROFILE VIEW)

GRADING INFORMATION

	EXISTING CONTOUR MINOR
	EXISTING CONTOUR MAJOR
	PROPOSED CONTOUR MINOR
	PROPOSED CONTOUR MAJOR
	PROPOSED GRADING LIMITS / SLOPE LIMITS
	PROJECT LIMITS
	PROPOSED SPOT ELEVATION
	RISE:RUN (SLOPE)

EXISTING PRIVATE UTILITY LINES

NOTE:
EXISTING UTILITY INFORMATION SHOWN ON THIS PLAN HAS BEEN PROVIDED BY THE UTILITY OWNER. THE CONTRACTOR SHALL FIELD VERIFY EXACT LOCATIONS PRIOR TO COMMENCING CONSTRUCTION AS REQUIRED BY STATE LAW. NOTIFY IOWA ONE CALL - 1-800-292-8989

THE SUBSURFACE UTILITY INFORMATION IN THIS PLAN IS UTILITY QUALITY LEVEL D UNLESS OTHERWISE NOTED. THIS UTILITY LEVEL WAS DETERMINED ACCORDING TO THE GUIDELINES OF CI/ASCE 38-02, ENTITLED "STANDARD GUIDELINE FOR INVESTIGATING AND DOCUMENTING EXISTING UTILITIES".

	UNDERGROUND FIBER OPTIC
	UNDERGROUND ELECTRIC
	UNDERGROUND GAS
	UNDERGROUND COMMUNICATION
	OVERHEAD ELECTRIC
	OVERHEAD COMMUNICATION
	OVERHEAD UTILITY

UTILITIES IDENTIFIED WITH A QUALITY LEVEL OTHER THAN D:

LINE TYPES FOLLOW THE FORMAT: UTILITY TYPE - QUALITY LEVEL
EXAMPLE: G-A G-A UNDERGROUND GAS, QUALITY LEVEL A
UTILITY QUALITY LEVEL (A,B,C,D) DEFINITIONS CAN BE FOUND IN CI/ASCE 38-22.

UTILITY QUALITY LEVELS:

LEVEL D - INFORMATION COMES SOLELY FROM EXISTING UTILITY RECORDS.

LEVEL C - SURVEYING ABOVE GROUND UTILITY FACILITIES, SUCH AS MANHOLES, VALVE BOXES, ETC; AND CORRELATING THIS INFORMATION WITH EXISTING UTILITY RECORDS.

LEVEL B - THE USE OF SURFACE GEOPHYSICAL TECHNIQUES TO DETERMINE THE EXISTENCE AND HORIZONTAL POSITION OF UNDERGROUND UTILITIES.

LEVEL A - THE USE OF NONDESTRUCTIVE DIGGING EQUIPMENT AT HORIZONTAL AND VERTICAL POSITION OF UNDERGROUND UTILITIES, AS WELL AS THE TYPE, SIZE, CONDITION, MATERIAL, AND OTHER CHARACTERISTICS.

ABBREVIATIONS

A	ALGEBRAIC DIFFERENCE	GV	GATE VALVE	SAN	SANITARY SEWER
ADJ	ADJUST	HDPE	HIGH DENSITY POLYETHYLENE	SCH	SCHEDULE
ALT	ALTERNATE	HH	HANDHOLE	SERV	SERVICE
B-B	BACK TO BACK	HMA	HOT MIX ASPHALT	SHLD	SHOULDER
BLDG	BUILDING	HP	HIGH POINT	STA	STATION
BMP	BEST MANAGEMENT PRACTICE	HWL	HIGH WATER LEVEL	STD	STANDARD
BR	BEGIN RADIUS	HYD	HYDRANT	STM	STORM SEWER
BV	BUTTERFLY VALVE	I	INVERT	TC	TOP OF CURB
CB	CATCH BASIN	K	CURVE COEFFICIENT	TE	TEMPORARY EASEMENT
C&G	CURB AND GUTTER	L	LENGTH	TEMP	TEMPORARY
CIP	CAST IRON PIPE	LO	LOWEST OPENING	TNH	TOP NUT HYDRANT
CIPP	CURED-IN-PLACE PIPE	LP	LOW POINT	TP	TOP OF PIPE
CL	CENTER LINE	LT	LEFT	TYP	TYPICAL
CL	CLASS	MH	MANHOLE	VCP	VITRIFIED CLAY PIPE
CMP	CORRUGATED METAL PIPE	MIN	MINIMUM	VERT	VERTICAL
C.O.	CHANGE ORDER	MR	MID RADIUS	VPC	VERTICAL POINT OF CURVE
COMM	COMMUNICATION	NIC	NOT IN CONTRACT	VPI	VERTICAL POINT OF INTERSECTION
CSP	CORRUGATED STEEL PIPE	NMC	NON-METALLIC CONDUIT	VPT	VERTICAL POINT OF TANGENT
CLVT	CULVERT	NTS	NOT TO SCALE	WM	WATERMAIN
DIA	DIAMETER	NWL	NORMAL WATER LEVEL	WS	WATER SERVICE
DIP	DUCTILE IRON PIPE	OHW	ORDINARY HIGH WATER LEVEL		
DWY	DRIVEWAY	PC	POINT OF CURVE		
E	EXTERNAL CURVE DISTANCE	PCC	PORTLAND CEMENT CONCRETE	AC	ACRES
ESMT	EASEMENT	PE	PERMANENT EASEMENT	CF	CUBIC FEET
ELEC	ELECTRIC	PED	PEDESTRIAN, PEDESTAL	CV	COMPACTED VOLUME
ELEV/EL	ELEVATION	PERF	PERFORATED PIPE	CY	CUBIC YARD
EOF	EMERGENCY OVERFLOW	PERM	PERMANENT	EA	EACH
ER	END RADIUS	PI	POINT OF INTERSECTION	EV	EXCAVATED VOLUME
EX	EXISTING	PL	PROPERTY LINE	LB	POUND
FES	FLARED END SECTION	PRC	POINT OF REVERSE CURVE	LF	LINEAR FEET
F-F	FACE TO FACE	PT	POINT OF TANGENT	LS	LUMP SUM
FF	FINISHED FLOOR	PVC	POLYVINYL CHLORIDE PIPE	LV	LOOSE VOLUME
F&I	FURNISH AND INSTALL	PVMT	PAVEMENT	SF	SQUARE FEET
FM	FORCEMAIN	R	RADIUS	SV	STOCKPILE VOLUME
FO	FIBER OPTIC	RCP	REINFORCED CONCRETE PIPE	SY	SQUARE YARD
F.O.	FIELD ORDER	RET	RETAINING		
GRAN	GRANULAR	R/W	RIGHT-OF-WAY		
GRAV	GRAVEL	RSC	RIGID STEEL CONDUIT		
GU	GUTTER	RT	RIGHT		



430 E GRAND AVENUE, SUITE 101
DES MOINES, IA 50309
Phone: (515) 259-9190
Email: DesMoines@bolton-menk.com
www.bolton-menk.com

DESIGNED	REV	DESCRIPTION	DATE
FAM	0	100% CD - FOR BID	04/15/2025
DRAWN			
TJN			
CHECKED			
FAM			
CLIENT PROJ. NO.			
9450.000			

IOWA DEPARTMENT OF ADMINISTRATIVE SERVICES

MOUNT PLEASANT CORRECTIONAL FACILITY - NORTH PARKING LOT REPLACEMENT

LEGEND SHEET

SHEET

A.02

THIS SHEET SET IS INTENDED TO BE PLOTTED IN COLOR

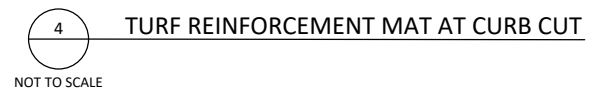
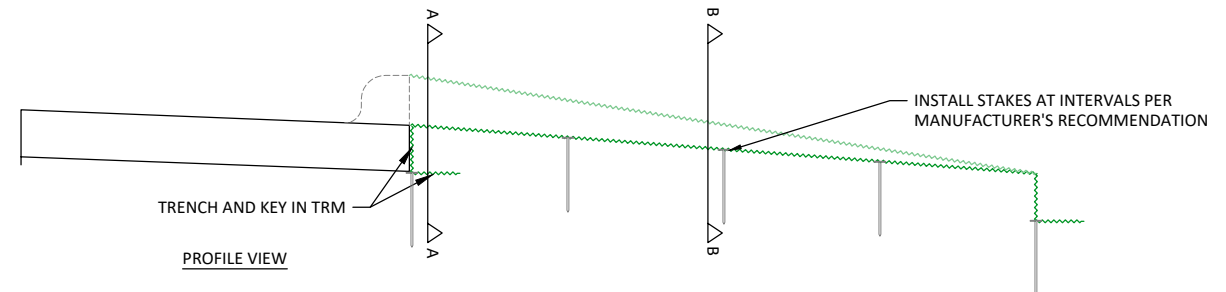
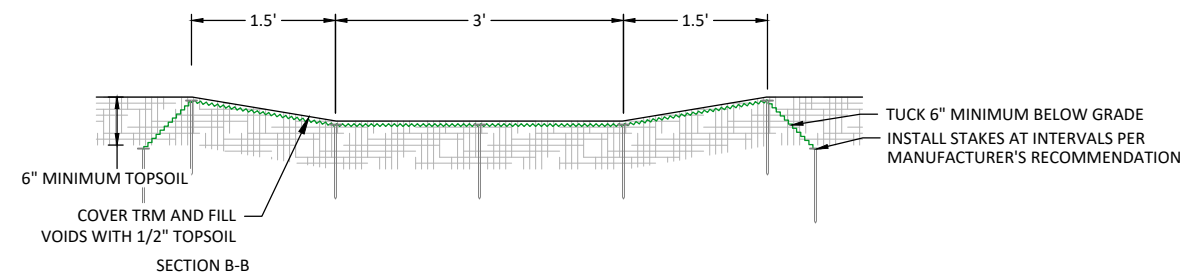
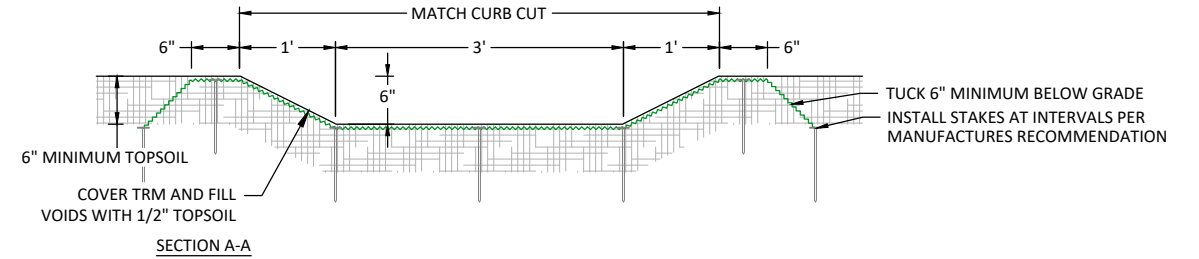
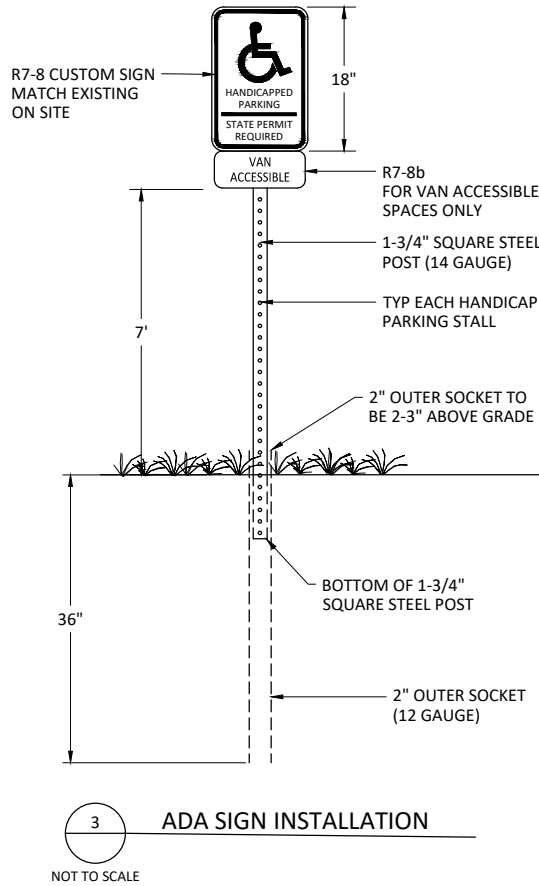
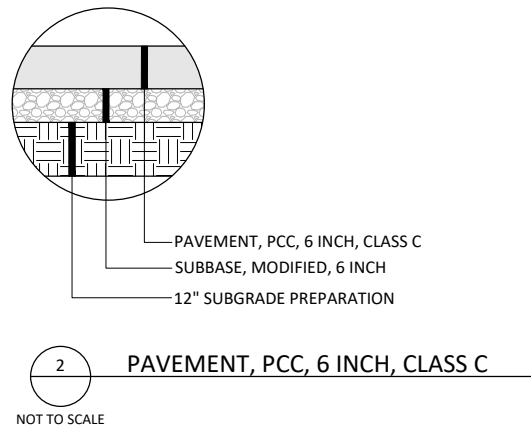
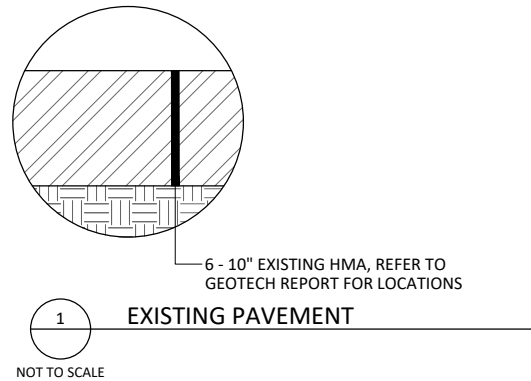

NOTES:
1. SUBDRAIN SHALL BE PERFORATED/SLOTTED, DUAL WALL, SMOOTH INTERIOR WITH PERFORATIONS/SLOTS FACING DOWN.

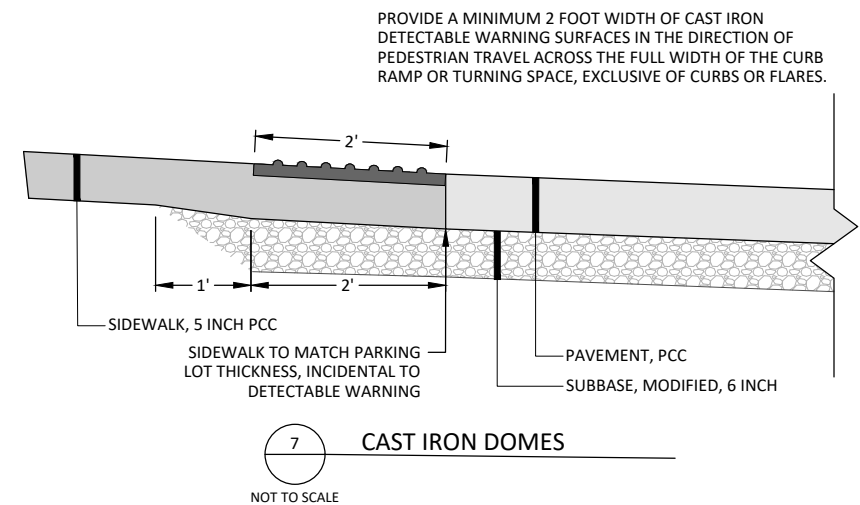
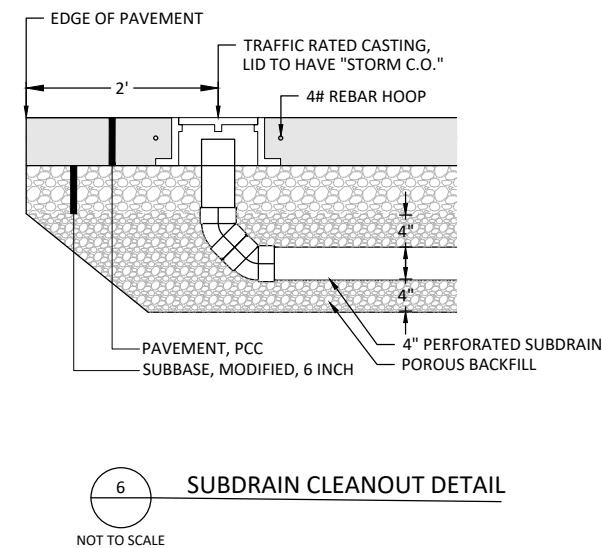
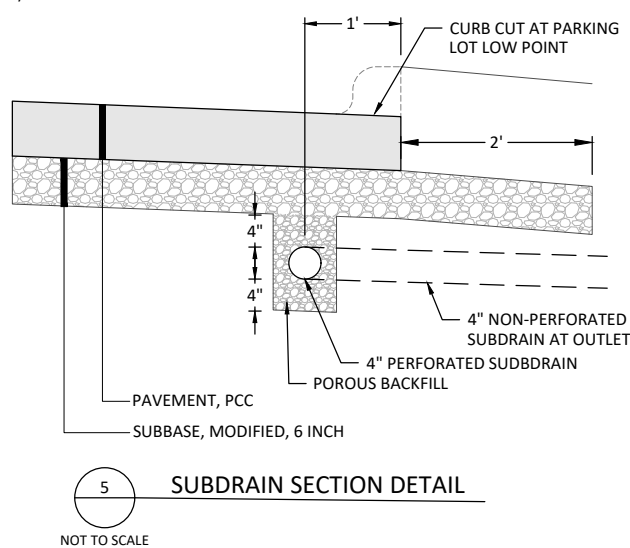

© Bolton & Menk, Inc. 2025. All Rights Reserved.
A:\UADADMIN\3114\2024\38674807\CD\138674807.dwg 4/15/2025 1:47:22 PM

THIS SHEET SET IS INTENDED TO BE PLOTTED IN COLOR

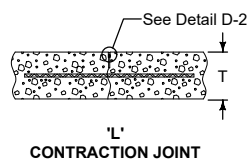
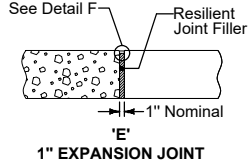
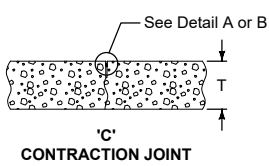
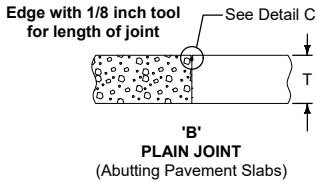

Ⓣ	Joint	Bars	Bar Length and Spacing
< 8"	'L-1'	#4	36" Long at 30" Centers

'L-1' interchangeable with 'BT-1' subject to pouring sequence

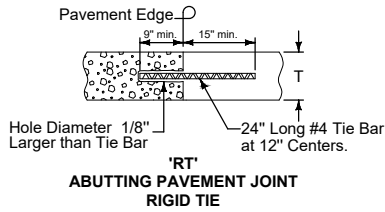

- NOTES:
- JOINT DETAILS SHOWN ARE PROJECT SPECIFIC SUDAS DETAILS AS REFERRED TO ON SHEET D.02
 - CHANGES IN CONSTRUCTION ACTIVITIES MAY REQUIRE THE IMPLEMENTATION OF OTHER JOINT DETAILS.
 - REFER TO 7010.101 (PV-101) FOR FULL LIST OF SUDAS JOINT DETAILS
 - REFER TO 7010.102 (PV-102) FOR FULL LIST OF SUDAS CURB DETAILS

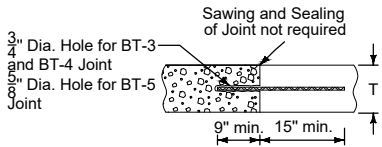

Ⓣ	Joint	Bars	Bar Length and Spacing
< 8"	'BT-5'	#4	24" Long at 30" Centers

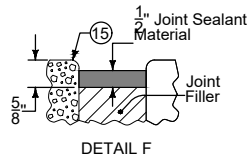
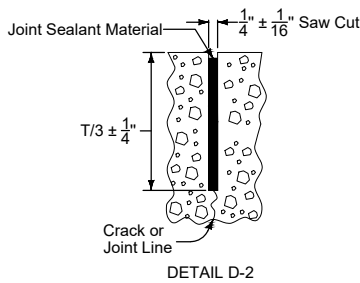
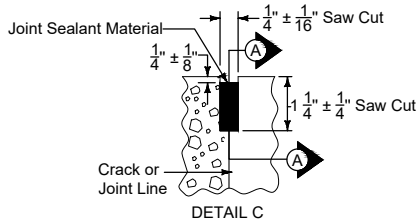
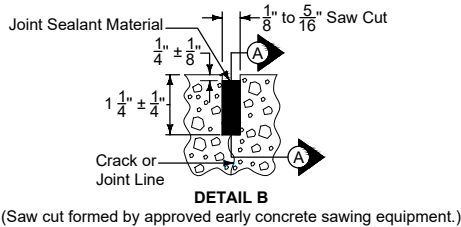
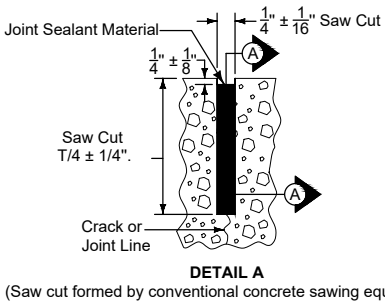
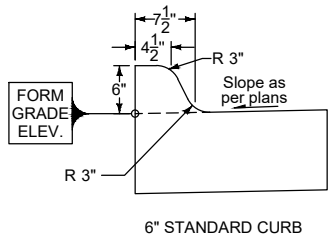
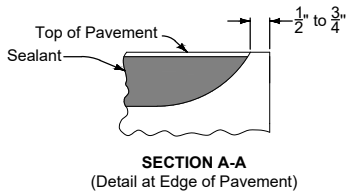
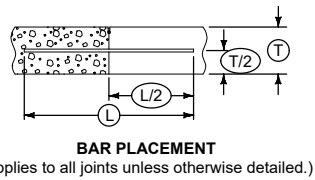
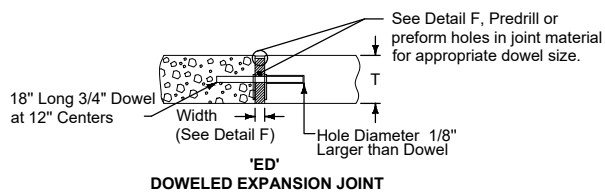
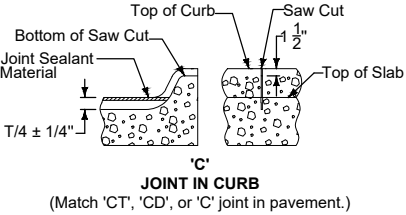

© Bolton & Menk, Inc. 2025. All Rights Reserved
P:\ADMIN\5114\2024\3867400\CD\CD13867400.dwg 4/15/2025 1:47:33 PM



430 E GRAND AVENUE, SUITE 101
DES MOINES, IA 50309
Phone: (515) 259-9190
Email: DesMoines@bolton-menk.com
www.bolton-menk.com

DESIGNED	REV	DESCRIPTION	DATE
FAM	0	100% CD - FOR BID	04/15/2025
DRAWN			
TJN			
CHECKED			
FAM			
CLIENT PROJ. NO.			
9450.000			

IOWA DEPARTMENT OF ADMINISTRATIVE SERVICES
MOUNT PLEASANT CORRECTIONAL FACILITY - NORTH PARKING LOT REPLACEMENT
TYPICAL DETAILS

SHEET

B.02

THIS SHEET SET IS INTENDED TO BE PLOTTED IN COLOR

ESTIMATED PROJECT QUANTITIES - BASE BID					
ITEM NO.	ITEM CODE	ITEM	UNIT	QUANTITY	AS-BUILT QTY.
1	2010-D-1	TOPSOIL, ON-SITE	CY	160	
2	2010-E	EXCAVATION, CLASS 10, ON-SITE	CY	154	
3	2010-E	EXCAVATION, CLASS 10, WASTE	CY	71	
4	2010-G	SUBGRADE PREPARATION	SY	2170	
5	2010-J	SUBBASE, MODIFIED, 6 INCHES	SY	2170	
6	4040-A	SUBDRAIN, 4 INCH	LF	310	
7	4040-C-1	SUBDRAIN CLEANOUT	EA	2	
8	4040-D-1	SUBDRAIN OUTLETS AND CONNECTIONS, DAYLIGHT, 4 INCH	EA	2	
9	7010-A	PAVEMENT, PCC, 6 INCH, C4	SY	2020	
10	7030-A-1	REMOVAL OF SIDEWALK	SY	17	
11	7030-E	SIDEWALK, PCC, 5 INCH	SY	17	
12	7030-G	DETECTABLE WARNING	SF	10	
13	7040-H	PAVEMENT REMOVAL	SY	2110	
14	8020-B	PAINTED PAVEMENT MARKINGS, SOLVENT/WATERBORNE	STA	13.5	
15	8020-G	PAINTED SYMBOLS AND LEGENDS, WATERBORNE OR SOLVENT	EA	2	
16	8040-A	TRAFFIC SIGNS, REGULATORY, 12X18	EA	2	
17	8040-A	TRAFFIC SIGNS, REGULATORY, 18X9	EA	2	
18	8040-D	PERFORATED SQUARE STEEL TUBE POSTS	LF	20	
19	8040-G	PERFORATED SQUARE STEEL TUBE POSTS ANCHORS, BREAK-AWAY	EA	2	
20	8040-999-X	SALAVAGE AND REINSTALL SIGN	EA	1	
21	9010-B	HYDRAULIC SEEDING, SEEDING, FERTILIZING, AND MULCHING, TYPE 1 - PERMANENT LAWN	AC	0.2	
22	9040-F-1	WATTLE, STRAW, 9 INCH	LF	1500	
23	9040-F-2	WATTLE, REMOVAL	LF	1500	
24	9040-R	TURF REINFORCEMENT MATS, 5.F	SF	250	
25	11010-A	CONSTRUCTION SURVEY	LS	1	
26	11020-A	MOBILIZATION	LS	1	

ESTIMATE REFERENCE INFORMATION		
ITEM NO.	ITEM CODE	DESCRIPTION
1	2010-D-1	<u>TOPSOIL, ON-SITE</u> RAW CUT = 150 CY, RAW FILL = 162 CY
2	2010-E	<u>EXCAVATION, CLASS 10, ON-SITE</u> THIS ITEM SHALL INCLUDE THE REMOVAL OF EXISTING SOIL, HAULING, DISPOSAL/EXPORT AND RE-GRADING AS PER PLAN TO FACILITATE ALL PROPOSED SECTIONS. ALL BORROW SHALL BE PROVIDED BY THE CONTRACTOR. RAW CUT = 154 CY, RAW FILL = 64 CY, ADJUSTED FILL (1.30 FACTOR) = 83 CY RAW EARTHWORK QUANTITIES ARE FOR INFORMATIONAL PURPOSES ONLY ARE A COMPARISON OF EXISTING CONDITIONS AND PROPOSED CONDITIONS AND MAY INCLUDE MATERIALS AND OPERATIONS PAID FOR UNDER OTHER BID ITEMS E.G. PAVEMENT REMOVAL, STORM SEWER TRENCHED, PCC PAVEMENT, SUBBASE, TOPSOIL, COMPOST AMENDMENT, ETC. MEASUREMENT WILL NOT BE MADE AND QUANTITY PAID WILL BE ON A PERCENT OF ITEM COMPLETE.
3	2010-E	<u>EXCAVATION, CLASS 10, WASTE</u> SEE ITEM 2 FOR CUT AND FILL. EXCESS OR UNSUITABLE EXCAVATED MATERIAL WILL BECOME PROPERTY OF THE CONTRACTOR AND WILL BE HAULED OFF-SITE. MPCF HAS FIRST RIGHT OF REFUSAL OF SUITABLE FILL MATERIALS, STOCKPILED ON SITE AT NO ADDITIONAL COSTS TO MPCF. ONE PROOF ROLL FOLLOWING PAVEMENT REMOVALS, PRIOR TO SUBGRADE PREPARATION, TO IDENTIFY UNSUITABLE SUBGRADE SHALL BE INCIDENTAL TO THIS ITEM. PROOF ROLL OF EXISTING SUBGRADE IMMEDIATELY FOLLOWING REMOVAL OF PAVEMENT TO BE SCHEDULED AND COORDINATED WITH ENGINEER. ENGINEER WILL ASSIST IN IDENTIFYING LIMITS OF MATERIAL TO BE REMOVED AND HAULED OFF SITE AS EXCAVATION, CLASS 10, WASTE.
4	2010-G	<u>SUBGRADE PREPARATION</u> SUBGRADE SHALL BE PROOF ROLLED PRIOR TO PLACEMENT OF SUBBASE. PROOF ROLL SHALL BE PROVIDED BY THE CONTRACTOR, INCIDENTAL TO THIS ITEM.
5	2010-J	<u>SUBBASE, MODIFIED, 6 INCHES</u> THIS ITEM INCLUDES, BUT IS NOT LIMITED TO, COMPACTION OF SUBGRADE, FURNISHING, PLACING, COMPACTING, AND TRIMMING TO THE PROPER GRADE. THIS ITEM SHALL BE USED FOR REPLACEMENT OF UNSUITABLE FILL AFTER SUBGRADE PREP WITH APPROVAL OF ENGINEER.
6	4040-A	<u>SUBDRAIN, 4 INCH</u> REFER TO DETAIL 5, B.01. SEE M-SHEETS FOR PERFORATED AND NON-PERFORATED PIPE SECTIONS.
7	4040-C-1	<u>SUBDRAIN CLEANOUT</u> REFER TO DETAIL 6, B.01

8	4040-D-1	<u>SUBDRAIN OUTLETS AND CONNECTIONS, DAYLIGHT, 4 INCH</u>
9	7010-A	<u>PAVEMENT, PCC, 6 INCH, C4</u> CONCRETE SHALL BE A C-4 MIX WITH A MINIMUM COMPRESSIVE STRENGTH OF 4,000 PSI AT 28 DAYS. SLAG IS NOT ALLOWED. CURB AND GUTTER SECTION IS INCLUDE IN THE AREA OF THIS ITEM AND SHALL BE INCIDENTAL TO PAVEMENT CONSTRUCTION. REINFORCEMENT SHALL BE EPOXY COATED. 6 INCH MODIFIED SUBBASE SHALL BE PLACED UNDER THE PAVEMENT AND IS PAID FOR UNDER A SEPARATE BID ITEM. NO ADDITIONAL PAYMENT FOR COLD WEATHER PAVING OPERATIONS. FINAL TRIMMING OF SUBGRADE OR SUBBASE, INTEGRAL CURB, BARS AND REINFORCEMENT, JOINTS AND SEALING, SURFACE CURING AND PAVEMENT PROTECTION, SAFETY FENCING, CONCRETE FOR RIGID HEADERS, AND BOXOUTS FOR FIXTURES SHALL BE INDICENTAL TO THIS ITEM. SEAL JOINTS AS REQUIRED BY SUDAS FIGURE 7010.101. TESTING SERVICES WILL BE PAID FOR BY OWNER. CONTRACTOR TO ASSIST WITH SCHEDULING OF TESTING. CONTRACTOR RESPONSIBLE FOR RESCHEDULED OR ADDITIONAL TESTING SERVICES DUE TO FAILED TEST RESULTS.
10	7030-A-1	<u>REMOVAL OF SIDEWALK</u> FULL DEPTH SAW CUTS ALONG THE REMOVAL LIMITS ARE INCIDENTAL TO THIS ITEM. THE CONTRACTOR SHALL BE RESPONSIBLE FOR ADDITIONAL REMOVAL, EARTHWORK, SUBGRADE PREPARATION, MODIFIED SUBBASE AND PAVING EXPENSES DUE TO DAMAGED EDGES. ADDITIONAL REMOVAL TO BE DETERMINED BY ENGINEER. PAYMENT SHALL BE MADE FOR THE AREA OF PAVEMENT REMOVED REGARDLESS OF THICKNESS.
11	7030-E	<u>SIDEWALK, PCC, 5 INCH</u> CONCRETE WILL BE C MIX WITH A MINIMUM COMPRESSIVE STRENGTH OF 4,000 PSI AT 28 DAYS. SLAG IS NOT ALLOWED. COMPACTION OF SUBGRADE IS INCIDENTAL TO THIS ITEM. NO EXTRA PAYMENT FOR COLD WEATHER PAVING.
12	7030-G	<u>DETECTABLE WARNING</u> DETECTABLE WARNINGS SHALL BE CAST IRON AND MEET CURRENT PROWAG STANDARDS.
13	7040-H	<u>PAVEMENT REMOVAL</u> IMMEDIATELY FOLLOWING PAVEMENT REMOVAL, A PROOF SHALL BE COMPLTED. REFER TO GEOTECHNICAL REPORT FOR EXISTING PAVEMENT THICKNESSES. CONTRACTORS OPTION: IF THE CONTRACTOR CHOOSES TO MILL HMA SECTION OF PAVEMENT, MPCF WILL ACCEPT MATERIALS TO BE STOCKPILED ON SITE AT NO ADDITIONAL COSTS TO MPCF.
14	8020-B	<u>PAINTED PAVEMENT MARKINGS, SOLVENT/WATERBORNE</u>
15	8020-G	<u>PAINTED SYMBOLS AND LEGENDS, WATERBORNE OR SOLVENT</u>
16	8040-A	<u>TRAFFIC SIGNS, REGULATORY, 12X18</u> MATCH EXISTING SIGNS. SEE B SHEETS FOR IMAGE OF EXISTING SIGN TO MATCH.
17	8040-A	<u>TRAFFIC SIGNS, REGULATORY, 18X9</u>
18	8040-D	<u>PERFORATED SQUARE STEEL TUBE POSTS</u>
19	8040-G	<u>PERFORATED SQUARE STEEL TUBE POSTS ANCHORS, BREAK-AWAY</u>
20	8040-999-X	<u>SALAVAGE AND REINSTALL SIGN</u> SALVAGE AND REINSTALL "NO PARKING" SIGN AS SHOWN ON F.01 AND N.01
21	9010-B	<u>HYDRAULIC SEEDING, SEEDING, FERTILIZING, AND MULCHING, TYPE 1 - PERMANENT LAWN</u> SEED ALL AREAS DISTURBED BY CONSTRUCTION AS INDICATED ON PLANS. ROCK PICKING, FINISH GRADING, SEED BED PREP AND RESEEDING ARE CONSIDERED INCIDENTAL TO THIS ITEM. SEED AND FERTILIZER SHALL BE APPLIED PRIOR TO MULCHING. THE SEEDING RATE SHALL BE AT LEAST 260 LBS/ACRE. APPLY A 6-24-24, NITROGEN, PHOSPHATE, POTASH, COMMERCIAL FERTILIZER OR EQUIVALENT AT THE RATE OF 300 LBS PER ACRE. APPLY MULCHING PER MANUFACTERS RECOMMENDATIONS.
22	9040-F-1	<u>WATTLE, STRAW, 9 INCH</u>
23	9040-F-2	<u>WATTLE, REMOVAL</u>
24	9040-R	<u>TURF REINFORCEMENT MATS, 5.F</u>
25	11010-A	<u>CONSTRUCTION SURVEY</u>
26	11020-A	<u>MOBILIZATION</u> TRAFFIC CONTROL SIGNS, BARRIERS, AND FENCING REQUIRED TO SECURE THE SITE SHALL BE INCIDENTAL TO THIS ITEM.

© Bolton & Menk, Inc. 2025. All Rights Reserved
A:\ADMIN\31-1012041-38674007400\CD\13867400.dwg 4/15/2025 1:47:58 PM



430 E GRAND AVENUE, SUITE 101
DES MOINES, IA 50309
Phone: (515) 259-9190
Email: DesMoines@bolton-menk.com
www.bolton-menk.com

DESIGNED	REV	DESCRIPTION	DATE
FAM	0	100% CD - FOR BID	04/15/2025
DRAWN			
TJN			
CHECKED			
FAM			
CLIENT PROJ. NO.			
9450.000			

IOWA DEPARTMENT OF ADMINISTRATIVE SERVICES		SHEET C.
MOUNT PLEASANT CORRECTIONAL FACILITY - NORTH PARKING LOT REPLACEMENT		
ESTIMATE REFERENCE NOTES		

C.01

THIS SHEET SET IS INTENDED TO BE PLOTTED IN COLOR

GENERAL NOTES

STANDARD CONSTRUCTION NOTES:

- ALL IMPROVEMENTS SHALL BE IN ACCORDANCE WITH 2025 EDITION OF THE IOWA STATEWIDE URBAN DESIGN AND SPECIFICATIONS (SUDAS) AND SHALL COMPLY WITH ALL APPLICABLE FEDERAL, STATE AND LOCAL LAWS AND ORDINANCES. THE CONTRACTOR SHALL HAVE A COMPLETE SET OF THE CURRENT SUDAS STANDARD SPECIFICATIONS ON SITE DURING ALL CONSTRUCTION ACTIVITIES.
- ANY DEFECTIVE WORK CONDEMNED BY THE ENGINEER SHALL BE REMOVED AND REPLACED AT THE CONTRACTOR'S EXPENSE IN ACCORDANCE WITH SUDAS SECTION 1050, 1.08 'REMOVAL OF DEFECTIVE WORK' OF THE STANDARDS SPECIFICATIONS. FAILURE TO REMOVE DEFECTIVE WORK MAY RESULT IN SUSPENSION OF OPERATIONS AND/OR WITHHOLDING OF PAYMENTS UNTIL DEFECTIVE WORK HAS BEEN REMOVED AND REPLACED.
- THE CONTRACTOR SHALL PRESERVE ALL SURVEY CONTROL, LINE AND GRADE STAKES IN ACCORDANCE WITH SUDAS SECTION 1050, 1.10 'LINE AND GRADE STAKES' OF THE STANDARD SPECIFICATIONS.
- PRIOR TO MOBILIZING OFF OF THE JOB SITE, THE CONTRACTOR SHALL NOTIFY THE ENGINEER TO REQUEST A FINAL INSPECTION IN ACCORDANCE WITH SUDAS SECTION 1050, 1.14 'FINAL INSPECTION AND ACCEPTANCE' OF THE STANDARD SPECIFICATIONS.
- THE CONTRACTOR IS RESPONSIBLE FOR SITE SAFETY AND COMPLYING WITH ALL CURRENT AND FUTURE FEDERAL AND STATE OSHA REQUIREMENTS IN ACCORDANCE WITH SUDAS SECTION 1070, 2.02 'CONVENIENCE AND SAFETY' OF THE STANDARD SPECIFICATIONS.
- WORK SHALL BE COMPLETED IN THE LIMITS OF CONSTRUCTION IN ACCORDANCE WITH SUDAS SECTION 1070, 2.04 'PROJECT AREA FOR THE WORK' OF THE STANDARD SPECIFICATIONS.
- IN ACCORDANCE WITH SUDAS SECTION 1070, 2.08 'PROTECTION OF PROPERTY' OF THE STANDARD SPECIFICATIONS, THE CONTRACTOR SHALL CONTINUOUSLY MAINTAIN ADEQUATE PROTECTION OF ALL ITS WORK FROM DAMAGE AND SHALL PROTECT THE JURISDICTION'S PROPERTY AND ADJACENT PRIVATE PROPERTY FROM INJURY OR LOSS ARISING IN CONNECTION WITH THE WORK. THE CONTRACTOR SHALL REPAIR OR RESTORE ANY SUCH DAMAGE, INJURY, OR LOSS TO JURISDICTION PROPERTY OR ADJACENT PROPERTY. THE CONTRACTOR SHALL PROTECT TREES AND OTHER PROPERTY NOT MARKED FOR REMOVAL.
- THE CONTRACTOR IS RESPONSIBLE FOR MAINTAINING SITE CLEANLINESS. UPON REQUEST BY THE ENGINEER, THE CONTRACTOR SHALL, AT ITS EXPENSE, CLEANUP AND REMOVE ALL REFUSE AND UNUSED MATERIALS OF ANY KIND RESULTING FROM THE WORK INCLUDING CLEANING AND SWEEPING OF ADJACENT STREETS. UPON FAILURE DO SO WITHIN ONE WORKING DAY AFTER SUCH REQUEST BY THE ENGINEER, THE WORK MAY BE DONE BY THE JURISDICTION AND THE COST THEREOF CHARGED TO THE CONTRACTOR AND DEDUCTED FROM ITS FINAL PAYMENT IN ACCORDANCE WITH SUDAS SECTION 1070, 2.15 'FINISHING AND CLEANUP REQUIREMENTS' OF THE STANDARD SPECIFICATIONS.
- EQUIPMENT MAINTENANCE AREAS MUST BE LIMITED TO A DEFINED AREA OF THE SITE. ALL RUNOFF CONTAINING ANY HAZARDOUS MATERIALS MUST BE PROPERLY COLLECTED AND DISPOSED OF. NO ENGINE DEGREASING SHALL BE ALLOWED ON SITE.
- THE CONTRACTOR'S ATTENTION IS DIRECTED TO THE REQUIREMENTS INCLUDED IN THE SPECIFICATIONS IN REGARD TO POSITIVE DUST CONTROL DURING ALL OPERATIONS TO INCLUDE REMOVAL, CLEANUP, ETC.
- THE CONTRACTOR SHALL SUBMIT TO THE ENGINEER FOR APPROVAL A PROGRESS SCHEDULE THAT WILL ENSURE THE COMPLETION OF THE PROJECT WITHIN THE TIME SPECIFIED. IF IT APPEARS THE RATE OF PROGRESS IS SUCH THAT THE CONTRACT WILL NOT BE COMPLETED WITHIN THE TIME ALLOWED, OR IF THE WORK IS NOT BEING EXECUTED IN A SATISFACTORY AND WORKMANLIKE MANNER, THE ENGINEER MAY ORDER THE CONTRACTOR TO TAKE SUCH STEPS AS NECESSARY TO COMPLETE THE WORK AS SPECIFIED IN THE CONTRACT IN ACCORDANCE WITH SUDAS SECTION 1080, 1.03 'WORK PROGRESS AND SCHEDULE' OF THE STANDARD SPECIFICATIONS.
- ANY WORK REQUIRED TO COMPLETE THE SCOPE OF THIS PROJECT BUT NOT SPECIFICALLY CALLED OUT, SHALL BE CONSIDERED INCIDENTAL TO THE PROJECT. NO ADDITIONAL COMPENSATION SHALL BE ALLOWED FOR THE COMPLETION OF THIS WORK.
- MAINTAIN POSITIVE DRAINAGE ON THE SITE THROUGHOUT THE PROJECT DURATION.
- ALL SLOPES IN PAVEMENT SHALL BE UNIFORM TO AVOID PONDING. ANY PONDING ON NEW PAVEMENT OR ADJACENT SURFACES WILL BE CONSIDERED UNACCEPTABLE AND SHALL BE REPLACED. IT IS THE CONTRACTORS RESPONSIBILITY TO IDENTIFY AREAS OF POTENTIAL PONDING EVEN IF GRADES ARE SHOWN ON THE DRAWINGS.
- ALL OPEN EXCAVATIONS SHALL BE PROTECTED.
- CONTRACTOR SHALL PROPERLY SECURE PROJECT SITE AT THE END OF EACH DAY.
- IN ORDER TO AVOID ANY UNNECESSARY SURFACE BREAKS OR PREMATURE SPALLING, THE CONTRACTOR IS CAUTIONED TO EXERCISE EXTREME CARE WHEN PERFORMING ANY OF THE NECESSARY SAW CUTTING OPERATIONS FOR THE PROPOSED PAVEMENT REMOVAL. ADJACENT PAVEMENT THAT IS CHIPPED OR DAMAGED DUE TO SAW OPERATIONS SHALL BE REPLACED AT THE CONTRACTOR'S COST IN ACCORDANCE WITH THE PROJECT SPECIFICATION DETAILS FOR STREET EXCAVATION AND PAVEMENT REPLACEMENT. ALL SAW CUTS ADJACENT TO EXISTING PAVEMENT SHALL BE FULL DEPTH.
- THE CONTRACTOR SHALL TAKE ALL PRECAUTIONS NOT TO DAMAGE ADJACENT PAVEMENT, SIDEWALKS, DRIVES, MEDIANS, CURBS, STRUCTURES AND OTHER AREAS NOT DESIGNATED AS PART OF THE WORK AREA. THE CONTRACTOR SHALL REPAIR ANY DAMAGE TO AREAS NOT DESIGNATED AS PART OF THE WORK AT NO COST TO THE OWNER.
- CONTRACTOR TO INSTALL AND MAINTAIN ORANGE CONSTRUCTION FENCE AROUND ALL AREAS OF ACTIVE CONSTRUCTION AS REQUIRED FOR PUBLIC SAFETY, INCIDENTAL TO MOBILIZATION.
- USE ALL AVAILABLE MEANS TO MINIMIZE THE AMOUNT OF SOIL EROSION CAUSED BY THE WORK OF THE PROJECT. THIS INCLUDES RESPONSIBILITY FOR MAINTENANCE OF ALL SOIL EROSION CONTROL DEVICES INDICATED. REPAIRS TO SOIL EROSION CONTROL DEVICES SHALL BE COMPLETED WITHIN 2 DAYS FROM NOTIFICATION.
- REMOVAL REQUIREMENTS SHOWN ON THE PLANS SHOULD BE CONSIDERED MINIMUM REMOVAL AND REPLACEMENT REQUIREMENTS. CONTRACTORS SHALL ADJUST REMOVAL LIMITS AND DIMENSIONS AS REQUIRED BY CONSTRUCTION MEANS AND METHODS AND ACTUAL SITE CONDITIONS. CONTRACTORS SHOULD FACTOR ADDITIONAL ANTICIPATED REMOVAL AND REPLACEMENT REQUIREMENTS INTO THEIR BIDS AS ADDITIONAL COMPENSATION REQUESTS FOR ADJUSTED OR EXPANDED REMOVAL LIMITS WILL NOT BE APPROVED.
- WHERE A SECTION OF PAVEMENT, CURB AND GUTTER, OR SIDEWALK IS CUT OR OTHERWISE DAMAGED BY THE CONTRACTOR, THE ENTIRE SECTION SHALL BE REMOVED AND REPLACED. PAVEMENT, CURBS, GUTTERS, AND SIDEWALKS SHALL BE REMOVED TO THE NEAREST JOINT A MINIMUM OF TWO FEET BEYOND THE EDGE OF ALL EXCAVATIONS. CONTRACTOR SHALL DOCUMENT (OR PHOTO) ALL CRACKED PCC PAVEMENT OR DAMAGED HMA PAVEMENT PRIOR TO CONSTRUCTION. IF NEW CRACKS IN PCC PAVEMENT DEVELOP OR HMA PAVEMENT IS DAMAGED DUE TO THE CONSTRUCTION TRAFFIC (EXTENDS BEYOND CONSTRUCTION LIMITS), CONTRACTOR SHALL REPLACE DAMAGED AREA AT NO ADDITIONAL COST TO OWNER.
- ALL LANDSCAPING INCLUDING TREES, SHRUBS, PERENNIALS NOT CALLED OUT TO BE REMOVED OR APPROVED FOR REMOVAL BY CONSTRUCTION MANAGER SHALL BE PROTECTED AND REPLACED AT NO COST TO THE OWNER IF DAMAGED DURING CONSTRUCTION.
- CONTRACTOR IS RESPONSIBLE FOR ALL TRENCH AND FILL SETTLEMENT FOR THE PROJECT'S ONE YEAR WARRANTY PERIOD. CONTRACTOR SHALL PROVIDE ADDITIONAL FILL MATERIAL AND IS RESPONSIBLE FOR RESEEDING OF ALL SETTLEMENT AREAS AFTER SITE RESTORATION HAS BEEN COMPLETED.
- SCARIFY SUBGRADE TO MINIMUM DEPTH OF 4" WHERE TOPSOIL IS SCHEDULED OR WHERE EQUIPMENT USED FOR HAULING AND SPREADING TOPSOIL HAS CAUSED COMPACTED SUBSOIL.
- COORDINATE ALL REQUIRED STAGING AREAS WITH FACILITY AND OWNER'S REPRESENTATIVE.
- SALVAGE AND REINSTALL TOPSOIL
- TESTING SERVICES WILL BE PAID FOR BY OWNER. CONTRACTOR TO ASSIST WITH SCHEDULING OF TESTING. CONTRACTOR RESPONSIBLE FOR RESCHEDULED OR ADDITIONAL TESTING SERVICES DUE TO FAILED TEST RESULTS.
- PROOF ROLL OF EXISTING SUBGRADE IMMEDIATELY FOLLOWING REMOVAL OF PAVEMENT TO BE SCHEDULED AND COORDINATED WITH ENGINEER. ENGINEER WILL ASSIST IN IDENTIFYING LIMITS OF MATERIAL TO BE REMOVED AND HAULED OFF SITE AS EXCAVATION, CLASS 10, WASTE.

UTILITY COORDINATION NOTES:

- THE OWNER WILL HAVE ALL UTILITY LOCATES MADE PRIOR TO CONSTRUCTION COMMENCEMENT. CONTRACTOR SHALL BE RESPONSIBLE FOR POTHOLING UTILITIES WITHIN PROJECT LIMITS THAT MAY BE IMPACTED BY CONSTRUCTION ACTIVITIES.
- ANTICIPATED UTILITY CONFLICTS HAVE BEEN IDENTIFIED AND EACH RESPECTIVE UTILITY OWNER HAS BEEN INFORMED OF THE POTENTIAL CONFLICTS. THE CONTRACTOR SHALL PROTECT THE EXISTING UTILITIES TO REMAIN WITHIN THE PROJECT SITE.
- THE LOCATION OF ALL AERIAL AND UNDERGROUND UTILITIES MAY NOT BE INDICATED ON THESE PLANS. WORK SHALL BE COMPLETED IN ACCORDANCE WITH SUDAS SECTION 1070, 2.07 'PROTECTION OF ABOVEGROUND AND UNDERGROUND FACILITIES' OF THE STANDARD SPECIFICATIONS. THE CONTRACTOR SHALL NOTIFY THE ENGINEER IMMEDIATELY OF ANY DAMAGE TO EXISTING UTILITIES.
- IF A CONFLICT IS DISCOVERED BY THE CONTRACTOR, NOTIFY THE ENGINEER IMMEDIATELY AND COORDINATE WITH OWNER OF UTILITY TO RESOLVE CONFLICT.
- THE LOCATIONS OF UTILITY MAINS, STRUCTURES, AND SERVICE CONNECTIONS PLOTTED IN THIS DRAWING ARE APPROXIMATE ONLY AND WERE OBTAINED FROM RECORDS MADE AVAILABLE TO BOLTON & MENK. VERIFICATION OF, EXISTENCE OF, AND THE DETERMINATION OF THE EXACT LOCATION OFF SHALL BE THE RESPONSIBILITY OF THE CONSTRUCTION CONTRACTOR(S).
- THE MEANS OF THE WORK AND THE SAFETY OF THE CONTRACTOR'S EMPLOYEES ARE SOLELY THE RESPONSIBILITY OF THE CONTRACTOR.
- PROTECT EXISTING UTILITIES AND STRUCTURES TO REMAIN DURING CONSTRUCTION.

TRAFFIC CONTROL NOTES:

- ALL TRAFFIC CONTROL DEVICES SHALL BE FURNISHED, ERECTED, MAINTAINED, AND REMOVED BY THE CONTRACTOR.
- THE PROPOSED TRAFFIC CONTROL MAY BE MODIFIED TO MEET FIELD CONDITIONS, PREVENT OBSTRUCTIONS AND TO ACCOMMODATE CONSTRUCTION SCHEDULING UPON APPROVAL OF THE PROJECT ENGINEER
- SIGNAGE MAINTENANCE SHALL BE CONSIDERED INCIDENTAL TO TRAFFIC CONTROL AND REQUIRED AS DIRECTED BY THE ENGINEER.
- ALL CONSTRUCTION SIGNS SHALL BE DIAMOND GRADE FLUORESCENT ORANGE OR WHITE V.I.P. SHEETING OR EQUIVALENT. (IOWA DOT TYPE VII SHEETING).
- AT THE TIME OF INITIAL SETUP OR AT THE TIME OF MAJOR STAGE CHANGES, 100 PERCENT OF EACH TYPE OF DEVICE (SIGNS, CONES, TUBULAR MARKERS, DRUMS, BARRICADES, VERTICAL PANELS, CHANGEABLE MESSAGE SIGNS, AND PAVEMENT MARKINGS) SHALL BE CLASSIFIED AS ACCEPTABLE BY THE REQUIREMENT OF THE AMERICAN TRAFFIC SAFETY SERVICES ASSOCIATION (ATSSA), "QUALITY STANDARD FOR WORK ZONE TRAFFIC CONTROL DEVICES 1992." THROUGHOUT THE DURATION OF THE PROJECT, UNACCEPTABLE DEVICES OR SITUATIONS THAT ARE FOUND ON THE JOBSITE AS DETERMINED BY BEFORE MENTIONED PUBLICATION SHALL BE REPLACED OR THE SITUATION CORRECTED WITHIN 12 HOURS OF INITIAL NOTIFICATIONS BY THE ENGINEER.
- THE LOCATION FOR STORAGE OF EQUIPMENT BY THE CONTRACTOR DURING NONWORKING HOURS SHALL BE AS APPROVED BY THE ENGINEER AND OWNER.
- CONTRACTOR SHALL BE RESPONSIBLE FOR PEDESTRIAN TRAFFIC AND PREVENTING TRIP HAZARDS ADJACENT TO CONSTRUCTION SITE RELATED TO CONSTRUCTION ACTIVITIES.
- PROVIDE BARRICADES, FENCING, AND OTHER DEVICES TO KEEP UNAUTHORIZED PERSONNEL FROM PROJECT SITE. PROTECT OR DELINEATE THE WORK AREA AS DIRECTED BY THE OWNER.
- KEEP INTERFERENCE WITH TRAFFIC TO A MINIMUM. DO NOT BLOCK EXISTING SITE ROADWAYS UNLESS APPROVED BY OWNER.

© Bolton & Menk, Inc. 2025. All Rights Reserved
A:\UADADMIN\31-1412041-38674007\CD\13867400.dwg 4/15/2025 1:47:58 PM



430 E GRAND AVENUE, SUITE 101
DES MOINES, IA 50309
Phone: (515) 259-9190
Email: DesMoines@bolton-menk.com
www.bolton-menk.com

DESIGNED	REV	DESCRIPTION	DATE
FAM	0	100% CD - FOR BID	04/15/2025
DRAWN			
TJN			
CHECKED			
FAM			
CLIENT PROJ. NO.			
9450.000			

IOWA DEPARTMENT OF ADMINISTRATIVE SERVICES
MOUNT PLEASANT CORRECTIONAL FACILITY - NORTH PARKING LOT REPLACEMENT
GENERAL NOTES

SHEET
C.02

5" PCC SIDEWALK

6" PCC PAVEMENT

TC	-	TOP OF CURB
FG	-	FORM GRADE
HP	-	HIGH POINT
LP	-	LOW POINT
ME	-	MATCH TO EXISTING
EX	-	EXISTING
CR	-	CRITICAL ELEVATION

EXISTING: 58 PARKING STALLS
PROPOSED: 59 PARKING STALLS. 2 ARE ADA ACCESSIBLE

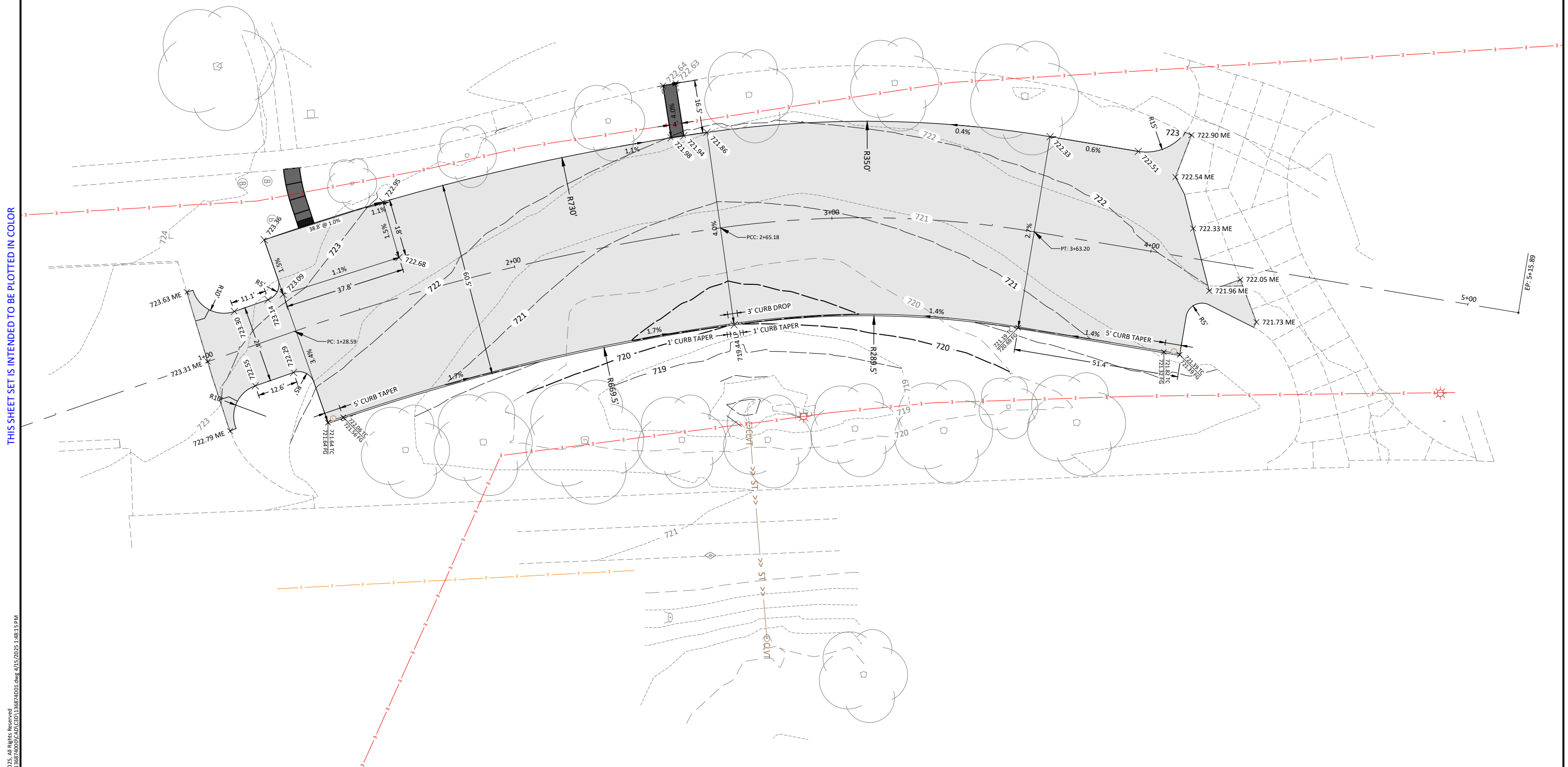

THIS SHEET SET IS INTENDED TO BE PLOTTED IN COLOR

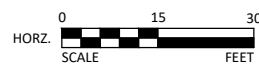

McGough



**Department of
Administrative Services**
*Empowering People
Collaboration
Customer Service*



BOLTON & MENK

430 E GRAND AVENUE, SUITE 101
DES MOINES, IA 50309
Phone: (515) 259-9190
Email: DesMoines@bolton-menk.com
www.bolton-menk.com

DESIGNED: FAM	REV	DESCRIPTION	DATE
DRAWN	0	100% CD - FOR BID	04/15/2025
CHECKED TJN			
FAM			
CLIENT PROJ. NO. 9450.000			

IOWA DEPARTMENT OF ADMINISTRATIVE SERVICES
MOUNT PLEASANT CORRECTIONAL FACILITY - NORTH PARKING LOT REPLACEMENT

PLAN LAYOUT

SHEET

.01

© Bolton & Menk, Inc. 2025, All Rights Reserved
H:\IAADMIN_ST_IA\24X13687400\CAD\C3D\136874D01.dwg 4/15/2025 1:48:15 PM

THIS SHEET SET IS INTENDED TO BE PLOTTED IN COLOR

NOTES:

- BT-5 AND L-1 JOINTS ARE INTERCHANGEABLE SUBJECT TO THE POURING SEQUENCE.
- ALL JOINTS TO BE SEALED AS REQUIRED BY SUDAS FIGURE 7010.101
- TESTING SERVICES WILL BE PAID FOR BY OWNER. CONTRACTOR TO ASSIST WITH SCHEDULING OF TESTING. CONTRACTOR RESPONSIBLE FOR RESCHEDULED OR ADDITIONAL TESTING SERVICES DUE TO FAILED TEST RESULTS.

LEGEND

- 5" PCC SIDEWALK
- 6" PCC PAVEMENT

ABBREVIATIONS

- TC - TOP OF CURB
- FG - FORM GRADE
- HP - HIGH POINT
- LP - LOW POINT
- ME - MATCH TO EXISTING
- EX - EXISTING
- CR - CRITICAL ELEVATION

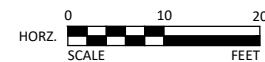

430 E GRAND AVENUE, SUITE 101
DES MOINES, IA 50309
Phone: (515) 259-9190
Email: DesMoines@bolton-menk.com
www.bolton-menk.com

DESIGNED	REV	DESCRIPTION	DATE
FAM	0	100% CD - FOR BID	04/15/2025
DRAWN			
TJN			
CHECKED			
FAM			
CLIENT PROJ. NO.			
9450.000			

IOWA DEPARTMENT OF ADMINISTRATIVE SERVICES
MOUNT PLEASANT CORRECTIONAL FACILITY - NORTH PARKING LOT REPLACEMENT

JOINTING AND ELEVATIONS

SHEET

D.02

- NOTE:
- CONSTRUCTION FOR PAVEMENT SECTION SHALL INCLUDE IN ORDER:
1. PAVEMENT REMOVAL (REFER TO GEOTECHNICAL REPORT FOR EXISTING PAVEMENT THICKNESS.)
 2. PROOF ROLL OF EXISTING SUBGRADE IMMEDIATELY FOLLOWING REMOVAL OF PAVEMENT TO BE SCHEDULED AND COORDINATED WITH ENGINEER. ENGINEER WILL ASSIST IN IDENTIFYING LIMITS OF MATERIAL TO BE REMOVED AND HAULED OFF SITE AS EXCAVATION, CLASS 10, WASTE.
 3. EXCAVATION, CLASS 10, WASTE ITEM SHALL BE USED TO HAUL OFF ANY UNSUITABLE MATERIALS FIRST.
 4. EXCAVATION, CLASS 10 ITEM SHALL BE USED TO GRADE THE SITE.
 5. SUBGRADE PREPERATION SHALL BE FOLLOWED BY A PROOF ROLL FOR FURTHER IDENTIFICATION OF UNSUITABLE MATERIALS
 6. SUBBASE, MODIFIED, 6 INCH ITEM SHALL BE INSTALLED.
 7. PAVEMENT, PCC, 6 INCH, C4 SHALL BE INSTALLED.

ALL ELECTRIC LINES SHOWN ARE APPROXIMATE LOCATIONS BASED ON FIELD LOCATES AND/OR AS-BUILT DRAWINGS. OWNER SHALL HAVE LOCATES AND UTILITIES MARKED PRIOR TO CONSTRUCTION. CONTRACTOR TO POT HOLE UTILITIES WITHIN GRADING/DISTURBANCE LIMITS.



THIS SHEET SET IS INTENDED TO BE PLOTTED IN COLOR

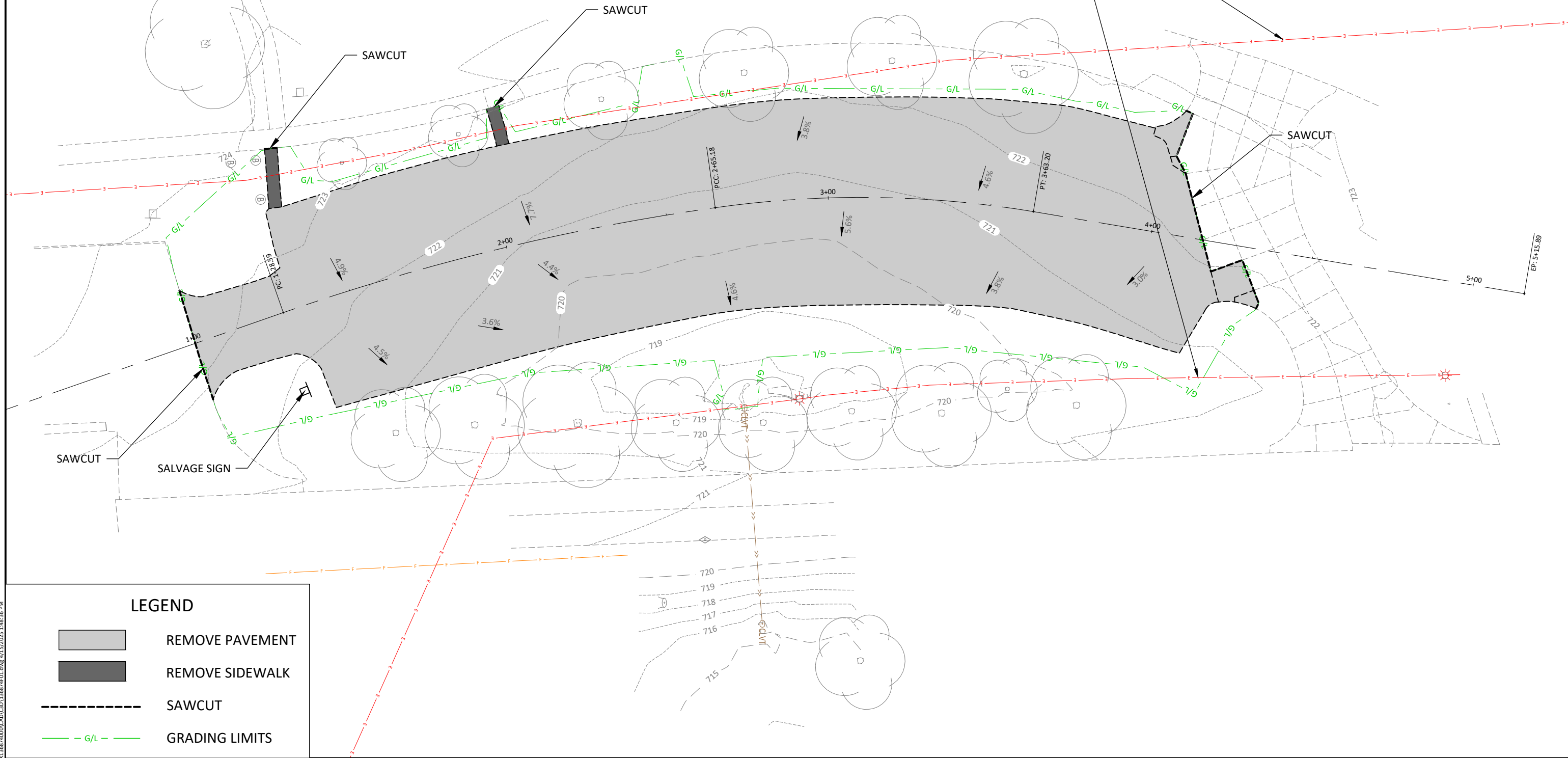

LEGEND

- REMOVE PAVEMENT
- REMOVE SIDEWALK
- SAWCUT
- G/L GRADING LIMITS

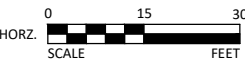

430 E GRAND AVENUE, SUITE 101
DES MOINES, IA 50309
Phone: (515) 259-9190
Email: DesMoines@bolton-menk.com
www.bolton-menk.com

DESIGNED	REV	DESCRIPTION	DATE
FAM	0	100% CD - FOR BID	04/15/2025
DRAWN	TJN		
CHECKED	FAM		
CLIENT PROJ. NO.	9450.000		

IOWA DEPARTMENT OF ADMINISTRATIVE SERVICES
MOUNT PLEASANT CORRECTIONAL FACILITY - NORTH PARKING LOT REPLACEMENT
REMOVALS

SHEET
F.01

© Bolton & Menk, Inc. 2025, All Rights Reserved
H:\JAA\ADMIN ST 1A\24Y1 36874000\CAN\CD\136874G01.dwg 4/15/2025 1:48:43 PM

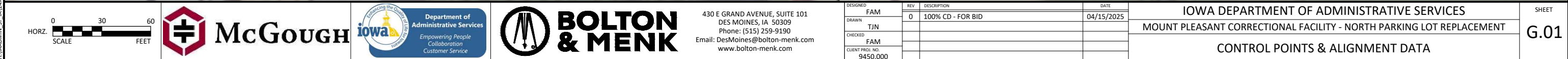

POINT NORTHING-EASTING DATA				
POINT NUMBER	RAW DESCRIPTION	ELEVATION	NORTH	EAST
1	VFCP	724.874	354833.75	2182737.45
2	VFCP	720.694	355055.44	2182850.55
3	VFCP	723.971	355339.83	2182713.46

DESIGNED	REV	DESCRIPTION	DATE
FAM	0	100% CD - FOR BID	04/15/2025
DRAWN			
TJN			
CHECKED			
FAM			
CLIENT PROJ. NO. 9450.000			

IOWA DEPARTMENT OF ADMINISTRATIVE SERVICES	
MOUNT PLEASANT CORRECTIONAL FACILITY - NORTH PARKING LOT REPLACEMENT	
CONTROL POINTS & ALIGNMENT DATA	

THIS SHEET SET IS INTENDED TO BE PLOTTED IN COLOR

- NOTE:
1. CONTRACTOR SHALL BE RESPONSIBLE FOR PEDESTRIAN TRAFFIC AND PREVENTING TRIP HAZARDS ADJACENT TO CONSTRUCTION SITE RELATED TO CONSTRUCTION ACTIVITIES.
 2. ALL ELECTRIC LINES SHOWN ARE APPROXIMATE LOCATIONS BASED ON FIELD LOCATES AND/OR AS-BUILT DRAWINGS. OWNER SHALL HAVE LOCATES AND UTILITIES MARKED PRIOR TO CONSTRUCTION. CONTRACTOR TO POTHOLE UTILITIES WITHIN GRADING/DISTURBANCE LIMITS.

CONTRACTOR TO SECURE CONSTRUCTION SITE WITH BARRICADE AND/OR ORANGE CONSTRUCTION FENCING

STAGING AREA ON PAVEMENT ONLY
NO STAGING ALLOWED ON GRASS

CONSTRUCTION ENTRANCE

CONTRACTOR TO SECURE CONSTRUCTION SITE WITH BARRICADE AND/OR ORANGE CONSTRUCTION FENCING

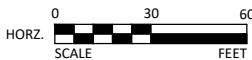

430 E GRAND AVENUE, SUITE 101
DES MOINES, IA 50309
Phone: (515) 259-9190
Email: DesMoines@bolton-menk.com
www.bolton-menk.com

DESIGNED	REV	DESCRIPTION	DATE
FAM	0	100% CD - FOR BID	04/15/2025
DRAWN			
TJN			
CHECKED			
FAM			
CLIENT PROJ. NO.			
9450.000			

IOWA DEPARTMENT OF ADMINISTRATIVE SERVICES
MOUNT PLEASANT CORRECTIONAL FACILITY - NORTH PARKING LOT REPLACEMENT
STAGING

SHEET
J.01

© Bolton & Menk, Inc. 2025, All Rights Reserved
H:\IAADMIN_ST_IA\24X13687400\CAD\C3D\136874M01.dwg 4/15/2025 1:49:03 PM

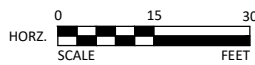

DESIGNED	REV	DESCRIPTION	DATE
FAM	0	100% CD - FOR BID	04/15/2025
DRAWN			
TJN			
CHECKED			
FAM			
CLIENT PROJ. NO.			
9450.000			

SHEET

M.01

© Bolton & Menk, Inc. 2025, All Rights Reserved
H:\ADMIN\ST\1A\24\13687400\NC\N\CD\136874M01.docx 4/15/2025 1:49:03 PM

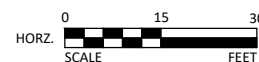

DESIGNED	FAM
DRAWN	TJN
CHECKED	FAM
CLIENT PROJ. NO.	9450.000

IOWA DEPARTMENT OF ADMINISTRATIVE SERVICES

MOUNT PLEASANT CORRECTIONAL FACILITY - NORTH PARKING LOT REPLACEMENT

SUBDRAIN PLAN AND PROFILE

SHEET
M.02



THIS SHEET SET IS INTENDED TO BE PLOTTED IN COLOR

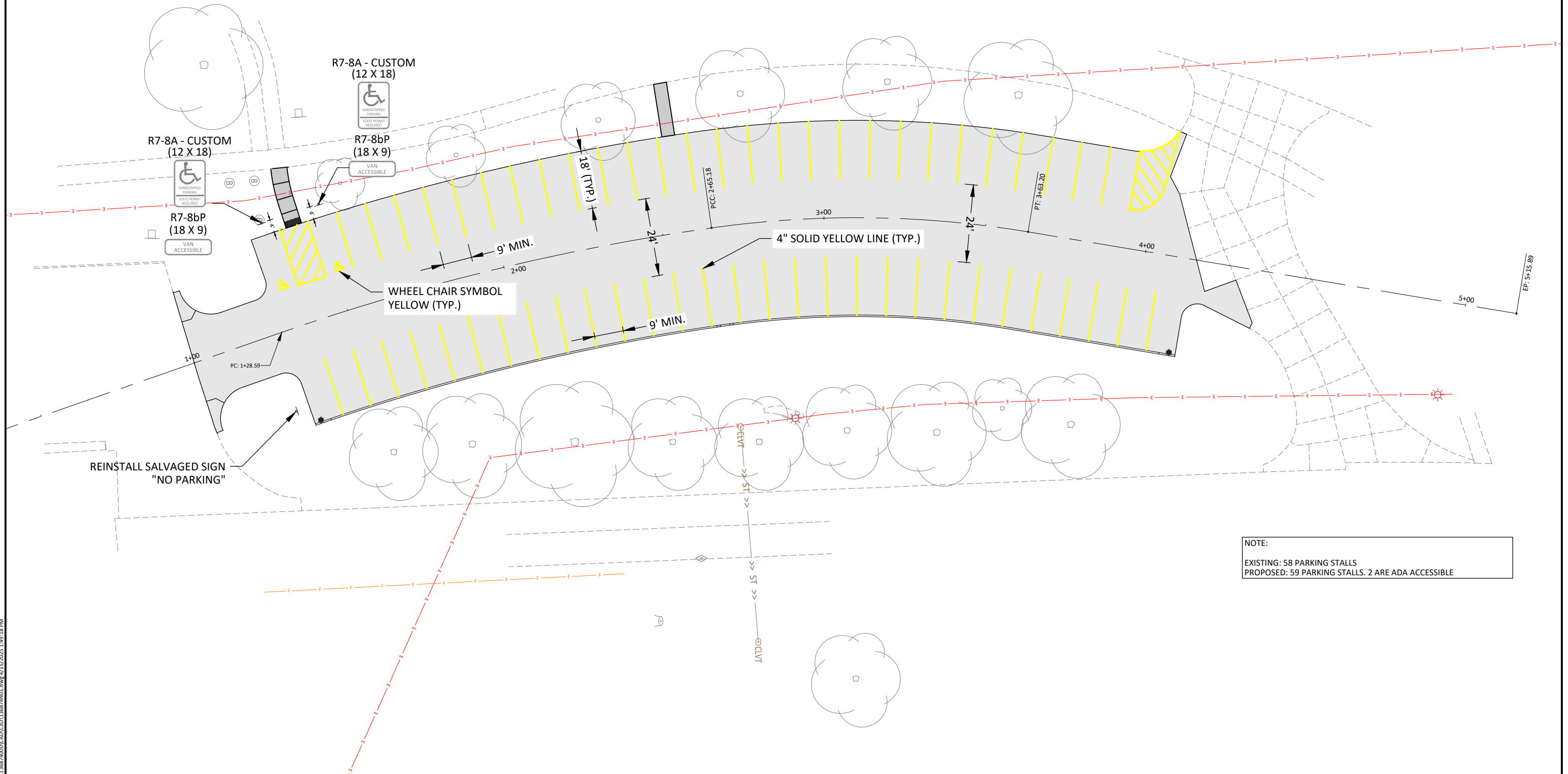

© Bolton & Menk, Inc. 2025. All Rights Reserved. 11/14/2024 3:07:46 PM C:\D\13887\N01.dwg 4/15/2025 1:49:18 PM

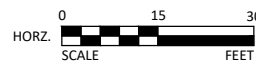

430 E GRAND AVENUE, SUITE 101
DES MOINES, IA 50309
Phone: (515) 259-9190
Email: DesMoines@bolton-menk.com
www.bolton-menk.com

DESIGNED	REV	DESCRIPTION	DATE
FAM	0	100% CD - FOR BID	04/15/2025
DRAWN			
TJN			
CHECKED			
FAM			
CLIENT PROJ. NO.			
9450.000			



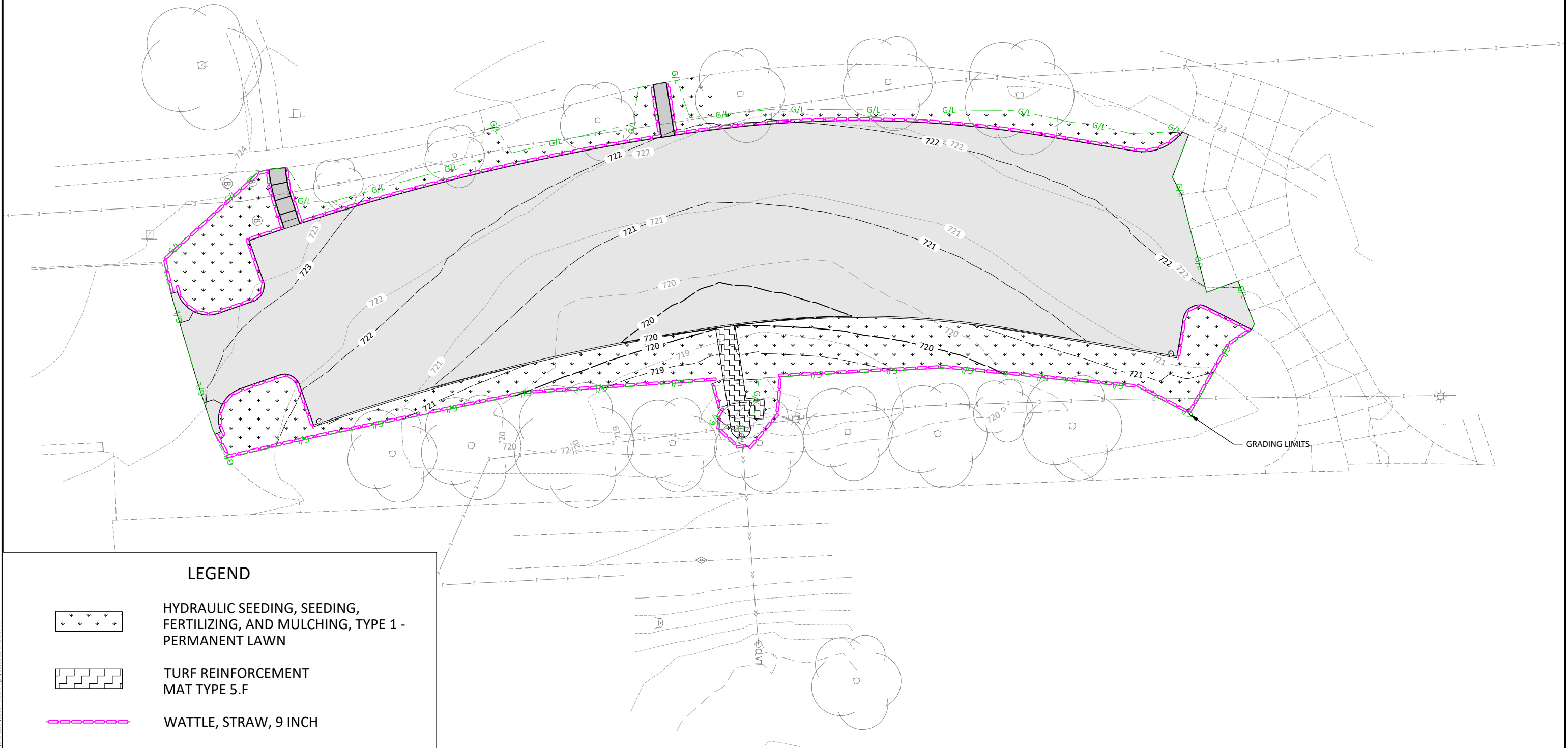

IOWA DEPARTMENT OF ADMINISTRATIVE SERVICES	
MOUNT PLEASANT CORRECTIONAL FACILITY - NORTH PARKING LOT REPLACEMENT	
PAVEMENT MARKINGS & SIGNAGE	

SHEET
N.01

THIS SHEET SET IS INTENDED TO BE PLOTTED IN COLOR

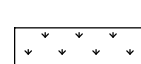

LEGEND

-  HYDRAULIC SEEDING, SEEDING, FERTILIZING, AND MULCHING, TYPE 1 - PERMANENT LAWN
-  TURF REINFORCEMENT MAT TYPE 5.F
-  WATTLE, STRAW, 9 INCH
-  GRADING LIMITS

HORZ. SCALE
0 15 30
FEET



430 E GRAND AVENUE, SUITE 101
DES MOINES, IA 50309
Phone: (515) 259-9190
Email: DesMoines@bolton-menk.com
www.bolton-menk.com

DESIGNED	REV	DESCRIPTION	DATE
FAM	0	100% CD - FOR BID	04/15/2025
DRAWN			
TJN			
CHECKED			
FAM			
CLIENT PROJ. NO.			
9450.000			

IOWA DEPARTMENT OF ADMINISTRATIVE SERVICES
MOUNT PLEASANT CORRECTIONAL FACILITY - NORTH PARKING LOT REPLACEMENT
EROSION CONTROL PLAN

SHEET
R.01

THIS SHEET SET IS INTENDED TO BE PLOTTED IN COLOR

LEGEND

SIDEWALK

DETECTABLE WARNING



© Bolton & Menk, Inc. 2025. All Rights Reserved
A:\UADADMIN\5114\2024\38674060\CD\CD138674061.dwg 4/15/2025 1:49:39 PM



430 E GRAND AVENUE, SUITE 101
DES MOINES, IA 50309
Phone: (515) 259-9190
Email: DesMoines@bolton-menk.com
www.bolton-menk.com

DESIGNED	FAM	REV	DESCRIPTION	DATE
DRAWN	TJN	0	100% CD - FOR BID	04/15/2025
CHECKED	FAM			
CLIENT PROJ. NO.	9450.000			

IOWA DEPARTMENT OF ADMINISTRATIVE SERVICES
MOUNT PLEASANT CORRECTIONAL FACILITY - NORTH PARKING LOT REPLACEMENT
ADA RAMP

SHEET

S.01