

IOWA DEPARTMENT OF ADMINISTRATIVE SERVICES

CONSTRUCTION PLANS FOR

DPS POST 2 - PARKING LOT REPLACEMENT

DAS PROJECT #9526.00

OSCEOLA, IA

JUNE, 2026

GOVERNING SPECIFICATIONS

THE 2026 EDITION OF THE "IOWA STATEWIDE URBAN SPECIFICATIONS FOR PUBLIC IMPROVEMENTS".

MUTCD 2009 AS ADOPTED BY IOWA DEPARTMENT OF TRANSPORTATION.

ALL APPLICABLE FEDERAL, STATE, AND LOCAL LAWS AND ORDINANCES WILL BE COMPLIED WITHIN THE CONSTRUCTION OF THIS PROJECT.



PROJECT LOCATION

1619 TRURO PAVEMENT
OSCEOLA, IOWA

NOTE: EXISTING UTILITY INFORMATION SHOWN ON THIS PLAN HAS BEEN PROVIDED BY THE UTILITY OWNER. THE CONTRACTOR SHALL FIELD VERIFY EXACT LOCATIONS PRIOR TO COMMENCING CONSTRUCTION AS REQUIRED BY STATE LAW. NOTIFY IOWA ONE CALL 1-800-292-8989 OR 811

THE SUBSURFACE UTILITY INFORMATION IN THIS PLAN IS UTILITY QUALITY LEVEL D UNLESS OTHERWISE NOTED. THIS UTILITY LEVEL WAS DETERMINED ACCORDING TO THE GUIDELINES OF CI/ASCE 38-02, ENTITLED "STANDARD GUIDELINES FOR THE COLLECTION AND DEPICTION OF EXISTING SUBSURFACE UTILITY DATA."

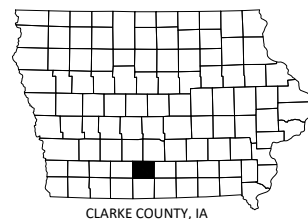

MAP OF THE CITY OF OSCEOLA, IOWA
CLARKE COUNTY, IA

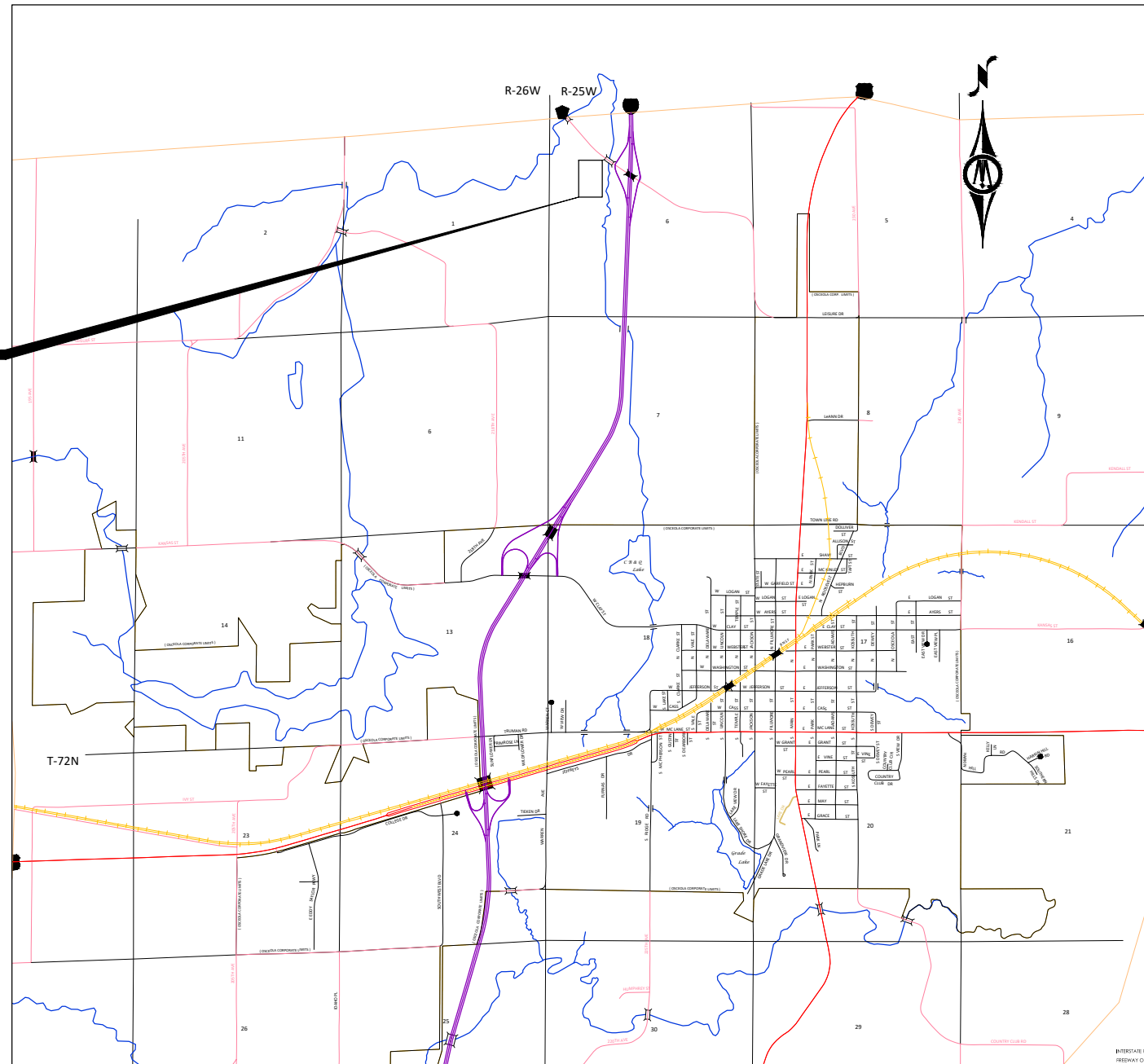

INDEX OF SHEETS			
SHEET NUMBER	SHEET TITLE	REVISION	ISSUE DATE
A.01	TITLE	0	6/22/2026
A.02	LEGEND	0	6/22/2026
B.01	TYPICAL DETAILS	0	6/22/2026
B.02	TYPICAL DETAILS	0	6/22/2026
C.01	ESTIMATED PROJECT QUANTITIES AND NOTES	0	6/22/2026
D.01	PLAN LAYOUT	0	6/22/2026
D.02	GRADING PLAN	0	6/22/2026
D.03	JOINTING PLAN	0	6/22/2026
F.01	EXISTING CONDITIONS AND REMOVALS	0	6/22/2026
G.01	REFERENCE, BENCHMARKS, AND GEOTECHNICAL DATA	0	6/22/2026
J.01	PHASING PLAN	0	6/22/2026
R.01	EROSION CONTROL	0	6/22/2026
S.01	STOOP SLAB REPLACEMENT	0	6/22/2026

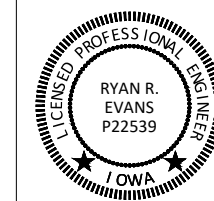

I HEREBY CERTIFY THAT THIS ENGINEERING DOCUMENT WAS PREPARED BY ME OR UNDER MY DIRECT PERSONAL SUPERVISION AND THAT I AM A DULY LICENSED PROFESSIONAL ENGINEER UNDER THE LAWS OF THE STATE OF IOWA.

RYAN R. EVANS
LIC. NO. P22539 DATE: 06/24/2026
MY LICENSE RENEWAL DATE IS 12/31/2027
PAGES OR SHEETS COVERED BY THIS SEAL:
SHEETS S.01

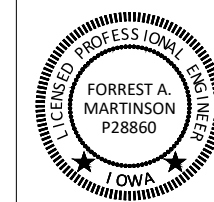

I HEREBY CERTIFY THAT THIS ENGINEERING DOCUMENT WAS PREPARED BY ME OR UNDER MY DIRECT PERSONAL SUPERVISION AND THAT I AM A DULY LICENSED PROFESSIONAL ENGINEER UNDER THE LAWS OF THE STATE OF IOWA.

FORREST A. MARTINSON
LIC. NO. P28860 DATE: 06/24/2026
MY LICENSE RENEWAL DATE IS 12/31/2027
PAGES OR SHEETS COVERED BY THIS SEAL:
SHEETS A.01 - R.01

THIS SHEET SET IS INTENDED TO BE PLOTTED IN COLOR

© Bolton & Menk, Inc. 2026. All Rights Reserved. I:\ADMIN\31_1420314297\BOLMEN\9526\DWG\24\2026_403-01.DWG



430 E GRAND AVENUE, SUITE 101
DES MOINES, IA 50309
Phone: (515) 259-9190
Email: DesMoines@bolton-menk.com
www.bolton-menk.com

DESIGNED	REV	DESCRIPTION	DATE
FAM	0	ISSUED FOR BID	06/22/2026
PL			
CHECKED			
FAM			
CLIENT PROJ. NO.			
9526.00			

IOWA DEPARTMENT OF ADMINISTRATIVE SERVICES
DPS POST 2 - PARKING LOT REPLACEMENT

TITLE

SHEET
A.01

THIS SHEET SET IS INTENDED TO BE PLOTTED IN COLOR

EXISTING TOPOGRAPHIC SYMBOLS

Table listing existing topographic symbols such as Access Grate, Air Condition Unit, Antenna, Auto Sprinkler Connection, Barricade Permanent, Basketball Post, Bench, Bird Feeder, Bollard, Bush, Catch Basin Rectangular Casting, Catch Basin Circular Casting, Curb Stop, Clean Out, Culvert End, Drinking Fountain, Down Spout, Electric Car Charge Station, Fill Pipe, Fire Hydrant, Flag Pole, Flared End / Apron, Fuel Pump, Grill, Guy Wire Anchor, Handhole, Handicap Space, Irrigation Sprinkler Head, Irrigation Valve Box, Lift Station Control Panel, Lift Station, Light Pole, Mailbox, Manhole-Communication, Manhole-Electric, Manhole-Gas, Manhole-Heat, Manhole-Reclaimed Water, Manhole-Sanitary Sewer, Manhole-Storm Sewer, Manhole-Utility, Manhole-Water, Meter, Drive-Thru Microphone, Parking Meter, Pavement Marking, Pedestal-Communication, Pedestal-Electric, Pedestrian Push Button, Picnic Table, Pole-Utility, Post, Railroad Signal Pole, Regulation Station Gas, Satellite Dish, Sign Traffic, Signal Control Cabinet, Soil Boring, Siren, Telephone Booth, Tile Inlet, Tile Outlet, Tile Riser, Transformer-Electric, Tree-Coniferous, Tree-Dead, Tree-Deciduous, Tree Stump, Traffic Arm Barrier, Traffic Signal, Trash Can, Utility Marker, Valve, Valve Post Indicator, Valve Vault, Vault, Vent Pipe, Water Spigot, Well, Wetland Delineated Marker, Wetland, Wet Well, Yard Hydrant.

PROPOSED TOPOGRAPHIC SYMBOLS

Table listing proposed topographic symbols such as Cleanout, Manhole, Lift Station, Storm Sewer Circular Casting, Storm Sewer Rectangular Casting, Storm Sewer Flared End / Apron, Storm Sewer Outlet Structure, Storm Sewer Overflow Structure, Curb Box, Fire Hydrant, Water Valve, Water Reducer, Water Bend, Water Tee, Water Cross, Water Sleeve, Water Cap / Plug, Rip Rap, Drainage Flow, Traffic Signs, Light Pole.

SURVEY SYMBOLS

Table listing survey symbols: Benchmark Location, Control Point, Monument Found, Cast Iron Monument, Stone Monument.

EXISTING TOPOGRAPHIC LINES

Table listing existing topographic lines: Retaining Wall, Fence, Fence-Decorative, Guard Rail, Tree Line, Bush Line.

SURVEY LINES

Table listing survey lines: Controlled Access, Boundary, Centerline, Existing Easement Line, Proposed Easement Line, Existing Lot Line, Proposed Lot Line, Existing Right-of-Way, Proposed Right-of-Way, Setback Line, Section Line, Quarter Line, Sixteenth Line, Temporary Easement.

EXISTING UTILITY LINES

Table listing existing utility lines: Force Main, Sanitary Sewer, Sanitary Service, Storm Sewer, Storm Sewer Drain Tile, Water Main, Water Service, Reclaimed Water.

PROPOSED UTILITY LINES

Table listing proposed utility lines: Force Main, Sanitary Sewer, Sanitary Service, Storm Sewer, Storm Sewer Drain Tile, Water Main, Water Service, Pipe Casing, Trenchless Pipe (Plan View), Trenchless Pipe (Profile View).

GRADING INFORMATION

Table listing grading information: Existing Contour Minor, Existing Contour Major, Proposed Contour Minor, Proposed Contour Major, Proposed Grading Limits / Slope Limits, Project Limits, Proposed Spot Elevation, Rise:Run (Slope).

EXISTING PRIVATE UTILITY LINES

NOTE: EXISTING UTILITY INFORMATION SHOWN ON THIS PLAN HAS BEEN PROVIDED BY THE UTILITY OWNER. THE CONTRACTOR SHALL FIELD VERIFY EXACT LOCATIONS PRIOR TO COMMENCING CONSTRUCTION AS REQUIRED BY STATE LAW. NOTIFY IOWA ONE CALL - 1-800-292-8989

THE SUBSURFACE UTILITY INFORMATION IN THIS PLAN IS UTILITY QUALITY LEVEL D UNLESS OTHERWISE NOTED. THIS UTILITY LEVEL WAS DETERMINED ACCORDING TO THE GUIDELINES OF CI/ASCE 38-02, ENTITLED "STANDARD GUIDELINE FOR INVESTIGATING AND DOCUMENTING EXISTING UTILITIES".

Table listing existing private utility lines: Underground Fiber Optic, Underground Electric, Underground Gas, Underground Communication, Overhead Electric, Overhead Communication, Overhead Utility.

UTILITIES IDENTIFIED WITH A QUALITY LEVEL OTHER THAN D:

LINE TYPES FOLLOW THE FORMAT: UTILITY TYPE - QUALITY LEVEL. EXAMPLE: G-A UNDERGROUND GAS, QUALITY LEVEL A. UTILITY QUALITY LEVEL (A,B,C,D) DEFINITIONS CAN BE FOUND IN CI/ASCE 38-22.

UTILITY QUALITY LEVELS:

LEVEL D - INFORMATION COMES SOLELY FROM EXISTING UTILITY RECORDS.

LEVEL C - SURVEYING ABOVE GROUND UTILITY FACILITIES, SUCH AS MANHOLES, VALVE BOXES, ETC; AND CORRELATING THIS INFORMATION WITH EXISTING UTILITY RECORDS.

LEVEL B - THE USE OF SURFACE GEOPHYSICAL TECHNIQUES TO DETERMINE THE EXISTENCE AND HORIZONTAL POSITION OF UNDERGROUND UTILITIES.

LEVEL A - THE USE OF NONDESTRUCTIVE DIGGING EQUIPMENT AT HORIZONTAL AND VERTICAL POSITION OF UNDERGROUND UTILITIES, AS WELL AS THE TYPE, SIZE, CONDITION, MATERIAL, AND OTHER CHARACTERISTICS.

ABBREVIATIONS

Large table of abbreviations including: A (Algebraic Difference), ADJ (Adjust), ALT (Alternate), B-B (Back to Back), BLDG (Building), BMP (Best Management Practice), BR (Begin Radius), BV (Butterfly Valve), CB (Catch Basin), C&G (Curb and Gutter), CIP (Cast Iron Pipe), CIPP (Cured-in-Place Pipe), CL (Center Line), CL (Class), CMP (Corrugated Metal Pipe), C.O. (Change Order), COMM (Communication), CSP (Corrugated Steel Pipe), CLVT (Culvert), DIA (Diameter), DIP (Ductile Iron Pipe), DWY (Driveway), E (External Curve Distance), ESMT (Easement), ELEC (Electric), ELEV/EL (Elevation), EOF (Emergency Overflow), ER (End Radius), EX (Existing), FES (Flared End Section), F-F (Face to Face), FF (Finished Floor), F&I (Furnish and Install), FM (Force Main), FO (Fiber Optic), F.O. (Field Order), GRAN (Granular), GRAV (Gravel), GU (Gutter), GV (Gate Valve), HDPE (High Density Polyethylene), HH (Handhole), HMA (Hot Mix Asphalt), HP (High Point), HWL (High Water Level), HYD (Hydrant), I (Invert), K (Curve Coefficient), L (Length), LO (Lowest Opening), LP (Low Point), LT (Left), MH (Manhole), MIN (Minimum), MR (Mid Radius), NIC (Not in Contract), NMC (Non-Metallic Conduit), NTS (Not to Scale), NHL (Normal Water Level), OHW (Ordinary High Water Level), PC (Point of Curve), PCC (Portland Cement Concrete), PE (Permanent Easement), PED (Pedestrian, Pedestal), PERF (Perforated Pipe), PERM (Permanent), PI (Point of Intersection), PL (Property Line), PRC (Point of Reverse Curve), PT (Point of Tangent), PVC (Polyvinyl Chloride Pipe), PVMT (Pavement), R (Radius), RCP (Reinforced Concrete Pipe), RET (Retaining), R/W (Right-of-Way), RSC (Rigid Steel Conduit), RT (Right), SAN (Sanitary Sewer), SCH (Schedule), SERV (Service), SHLD (Shoulder), STA (Station), STD (Standard), STM (Storm Sewer), TC (Top of Curb), TE (Temporary Easement), TEMP (Temporary), TNH (Top Nut Hydrant), TP (Top of Pipe), TYP (Typical), VCP (Vitrified Clay Pipe), VERT (Vertical), VPC (Vertical Point of Curve), VPI (Vertical Point of Intersection), VPT (Vertical Point of Tangent), WM (Water Main), WS (Water Service), AC (Acres), CF (Cubic Feet), CV (Compacted Volume), CY (Cubic Yard), EA (Each), EV (Excavated Volume), LB (Pound), LF (Linear Feet), LS (Lump Sum), LV (Loose Volume), SF (Square Feet), SV (Stockpile Volume), SY (Square Yard).

© Bolton & Menk, Inc. 2026. All Rights Reserved. I:\ADMIN\131_142051429797AD1.dwg 6/24/2026 4:03:41 PM



430 E GRAND AVENUE, SUITE 101
DES MOINES, IA 50309
Phone: (515) 259-9190
Email: DesMoines@bolton-menk.com
www.bolton-menk.com

Table with columns: DESIGNED, DRAWN, CHECKED, CLIENT PROJ. NO., REV, DESCRIPTION, DATE. Values include FAM, PL, FAM, 9526.00, 0, ISSUED FOR BID, 06/22/2026.

IOWA DEPARTMENT OF ADMINISTRATIVE SERVICES
DPS POST 2 - PARKING LOT REPLACEMENT

LEGEND

SHEET
A.02

THIS SHEET SET IS INTENDED TO BE PLOTTED IN COLOR



1 EXISTING PAVEMENT
NOT TO SCALE

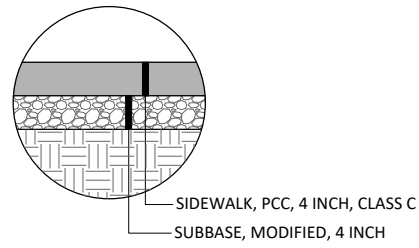

2 SIDEWALK, PCC, 4 INCH, CLASS C
NOT TO SCALE

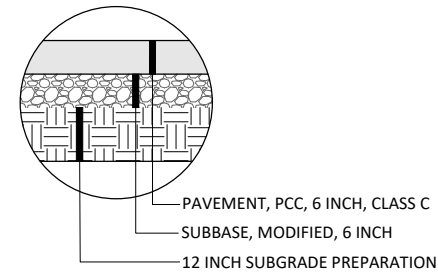

3 PAVEMENT, PCC, 6 INCH, CLASS C
NOT TO SCALE

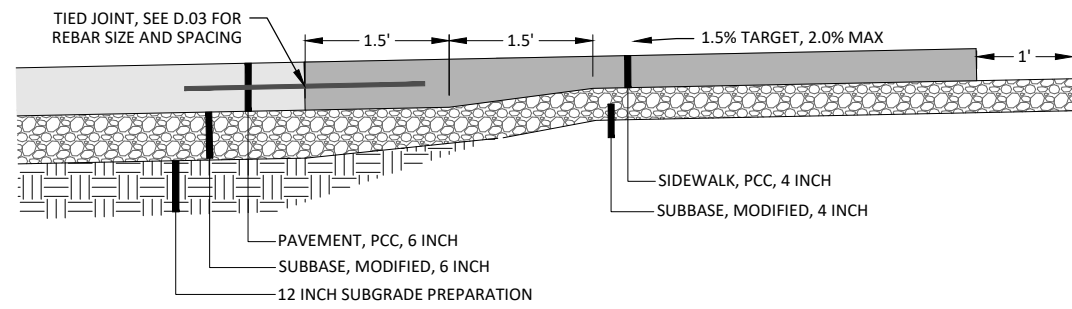

5 CLASS 'A' SIDEWALK
NOT TO SCALE

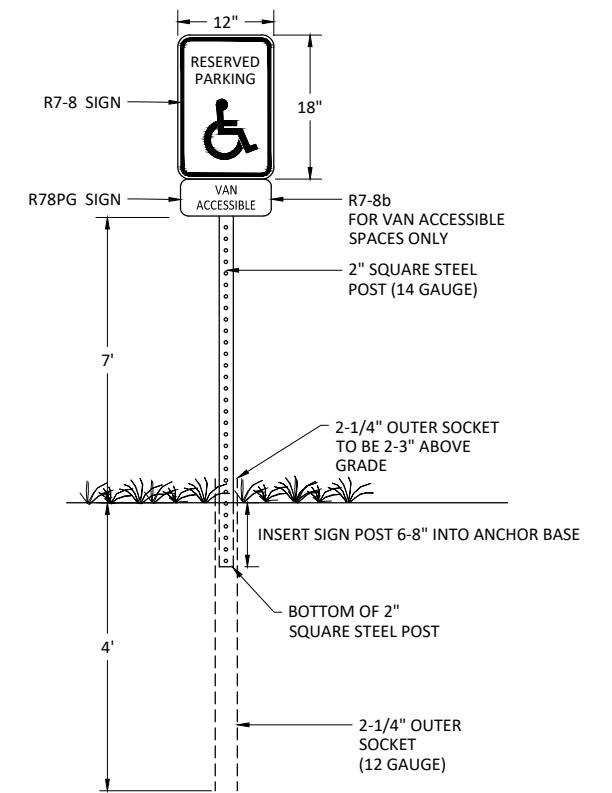

4 SIGN INSTALLATION
NOT TO SCALE

© Bolton & Menk, Inc. 2026. All Rights Reserved. P:\ADMIN\31_1429314293780\CAD\CD\14293780.dwg 6/24/2026 4:03:47 PM



430 E GRAND AVENUE, SUITE 101
DES MOINES, IA 50309
Phone: (515) 259-9190
Email: DesMoines@bolton-menk.com
www.bolton-menk.com

DESIGNED	REV	DESCRIPTION	DATE
FAM	0	ISSUED FOR BID	06/22/2026
DRAWN	PL		
CHECKED	FAM		
CLIENT PROJ. NO.	9526.00		

IOWA DEPARTMENT OF ADMINISTRATIVE SERVICES

DPS POST 2 - PARKING LOT REPLACEMENT

TYPICAL DETAILS

SHEET

B.01

THIS SHEET SET IS INTENDED TO BE PLOTTED IN COLOR

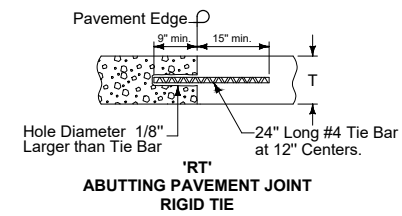
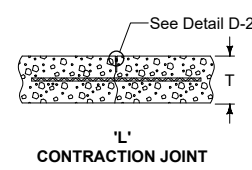
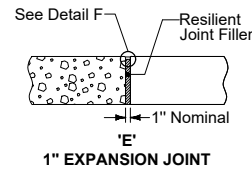
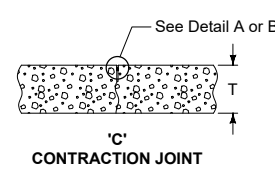
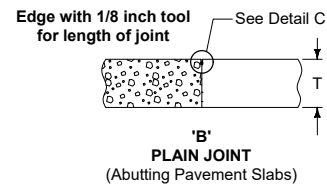

Ⓣ	Joint	Bars	Bar Length and Spacing
< 8"	'L-1'	#4	36" Long at 30" Centers

'L-1' interchangeable with 'BT-1' subject to pouring sequence

- NOTES:
1. JOINT DETAILS SHOWN ARE PROJECT SPECIFIC SUDAS DETAILS AS REFERRED TO ON SHEET D.02
 2. CHANGES IN CONSTRUCTION ACTIVITIES MAY REQUIRE THE IMPLEMENTATION OF OTHER JOINT DETAILS.
 3. REFER TO 7010.101 (PV-101) FOR FULL LIST OF SUDAS JOINT DETAILS
 4. REFER TO 7010.102 (PV-102) FOR FULL LIST OF SUDAS CURB DETAILS

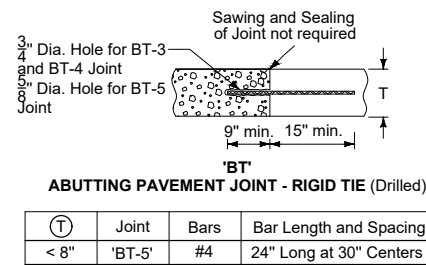

Ⓣ	Joint	Bars	Bar Length and Spacing
< 8"	'BT-5'	#4	24" Long at 30" Centers

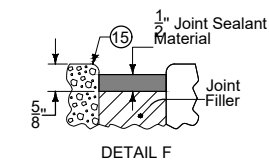
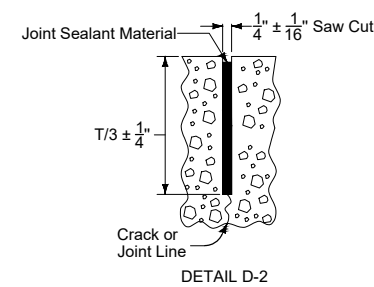
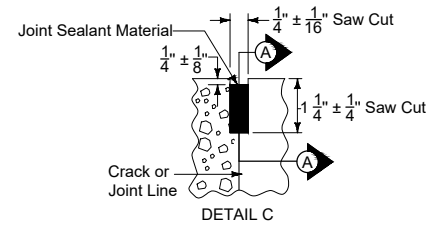
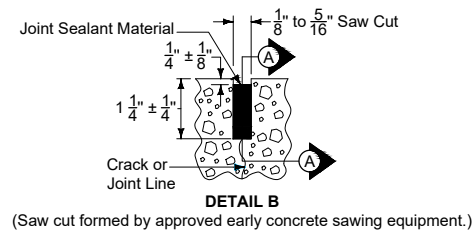
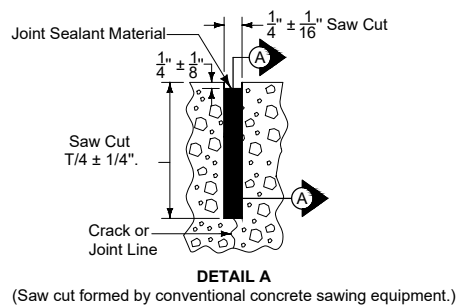
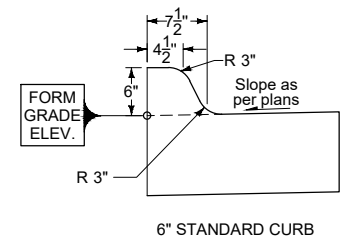
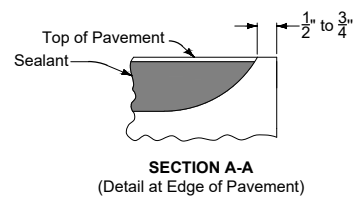
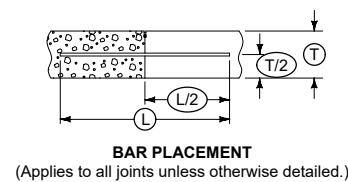
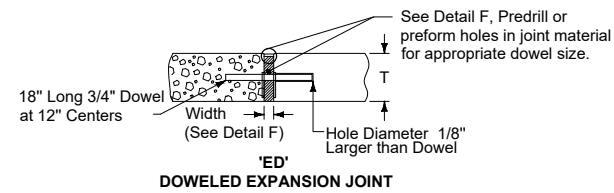
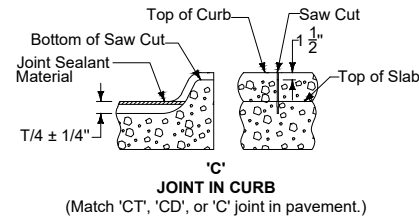

© Bolton & Menk, Inc. 2026. All Rights Reserved. 14104ADMIN_31_141031429297800_CAD1429297800.dwg 6/24/2026 4:03:48 PM



430 E GRAND AVENUE, SUITE 101
DES MOINES, IA 50309
Phone: (515) 259-9190
Email: DesMoines@bolton-menk.com
www.bolton-menk.com

DESIGNED	REV	DESCRIPTION	DATE
FAM	0	ISSUED FOR BID	06/22/2026
DRAWN			
CHECKED			
FAM			
CLIENT PROJ. NO.			

IOWA DEPARTMENT OF ADMINISTRATIVE SERVICES
DPS POST 2 - PARKING LOT REPLACEMENT

TYPICAL DETAILS

SHEET
B.02

THIS SHEET SET IS INTENDED TO BE PLOTTED IN COLOR

ESTIMATED PROJECT QUANTITIES - BASE BID					
ITEM NO.	ITEM CODE	ITEM	UNIT	QUANTITY	AS-BUILT QTY.
1	0000-A	ALLOWANCE FOR MASONARY REPAIR	ALW	1	
2	2010-D-1	TOPSOIL, ON-SITE	CY	46	
3	2010-E	EXCAVATION, CLASS 10	CY	234	
4	2010-G	SUBGRADE PREPARATION	SY	1400	
5	2010-J	SUBBASE, MODIFIED, 6 INCHES	SY	1400	
6	2010-J	SUBBASE, MODIFIED, 4 INCHES	SY	150	
7	7010-A	PAVEMENT, PCC, 6 INCH, C4-WR-C20	SY	1290	
8	7030-E	SIDEWALK, CLASS 'A', PCC, 4 INCH	SY	150	
9	7030-E	SIDEWALK, TEMPORARY, PCC, 4 INCH	SY	6	
10	7030-999-A	REMOVE AND REPLACE STOOP SLAB ON EXISTING STOOP FOUNDATION	LS	1	
11	7040-H	PAVEMENT REMOVAL	SY	1396	
12	8020-B	PAINTED PAVEMENT MARKINGS, SOLVENT/WATERBORNE	STA	2	
13	8020-G	PAINTED SYMBOLS AND LEGENDS, WATERBORNE OR SOLVENT	EA	1	
14	8040-A	TRAFFIC SIGNS, ADA	EA	3	
15	8040-D	PERFORATED SQUARE STEEL TUBE POSTS	LF	30	
16	8040-G	PERFORATED SQUARE STEEL TUBE POSTS ANCHORS, BREAKAWAY, 2 INCH	EA	3	
17	8040-I	REMOVE SIGNS	EA	1	
18	9010-B	HYDRAULIC SEEDING, SEEDING, FERTILIZING, AND MULCHING, TYPE 1 - PERMANENT LAWN	AC	0.1	
19	9020-A	SOD	SY	49	
20	9040-F-1	WATTLE, COMPOST/MULCH SOCK	LF	200	
21	9040-F-2	WATTLE, REMOVAL	LF	200	
22	11010-A	CONSTRUCTION SURVEY	LS	1	
23	11020-A	MOBILIZATION	LS	1	

6	2010-J	SUBBASE, MODIFIED, 4 INCHES THIS ITEM INCLUDES, BUT IS NOT LIMITED TO, COMPACTION OF SUBGRADE, FURNISHING, PLACING, COMPACTING, AND TRIMMING TO THE PROPER GRADE.
7	7010-A	PAVEMENT, PCC, 6 INCH, C4-WR-C20 CONCRETE SHALL BE A C-4 MIX WITH A MINIMUM COMPRESSIVE STRENGTH OF 4,000 PSI AT 28 DAYS. SLAG IS NOT ALLOWED. CURB AND GUTTER SECTION IS INCLUDE IN THE AREA OF THIS ITEM AND SHALL BE INCIDENTAL TO PAVEMENT CONSTRUCTION. REINFORCEMENT SHALL BE EPOXY COATED. 6 INCH MODIFIED SUBBASE SHALL BE PLACED UNDER THE PAVEMENT AND IS PAID FOR UNDER A SEPARATE BID ITEM. NO ADDITIONAL PAYMENT FOR COLD WEATHER PAVING OPERATIONS. FINAL TRIMMING OF SUBGRADE OR SUBBASE, INTEGRAL CURB, BARS AND REINFORCEMENT, JOINTS AND SEALING, SURFACE CURING AND PAVEMENT PROTECTION, SAFETY FENCING, CONCRETE FOR RIGID HEADERS, AND BOXOUTS FOR FIXTURES SHALL BE INCIDENTAL TO THIS ITEM.
8	7030-E	SIDEWALK, CLASS 'A', PCC, 4 INCH CONCRETE WILL BE C OR M MIX WITH A MINIMUM COMPRESSIVE STRENGTH OF 4,000 PSI AT 28 DAYS. SLAG IS NOT ALLOWED. COMPACTION OF SUBGRADE IS INCIDENTAL TO THIS ITEM. CONCRETE TESTING WILL BE PROVIDED BY THE OWNER. NO EXTRA PAYMENT FOR COLD WEATHER PAVING.
9	7030-E	SIDEWALK, TEMPORARY, PCC, 4 INCH REFER TO BID ITEM #8. NO SUBBASE WILL BE PLACED UNDER TEMPORARY SIDEWALK.
10	7030-999-A	REMOVE AND REPLACE STOOP SLAB ON EXISTING STOOP FOUNDATION CONTRACTOR SHALL DRILL AND EPOXY INDICATED BENT DOWELS INTO EXISTING STOOP FOUNDATION WALLS AND REPLACE STOOP SLAB.
11	7040-H	PAVEMENT REMOVAL CONTRACTOR SHALL PROTECT EXISTING PAVEMENT TO REMAIN. CONTRACTOR SHALL REPLACE PAVEMENT DAMAGED DURING CONSTRUCTION AT NO ADDITIONAL COST. THIS BID ITEM IS FOR REMOVAL OF PARKING LOT PAVEMENT, SIDEWALK, AND TEMPORARY SIDEWALK.
12	8020-B	PAINTED PAVEMENT MARKINGS, SOLVENT/WATERBORNE CONTRACTOR SHALL REMOVE SURFACE CURE PRIOR TO INSTALLING PAVEMENT MARKINGS. REFLECTORIZING GLASS SPHERES SHALL BE INSTALLED WITH ALL PAVEMENT MARKINGS.
13	8020-G	PAINTED SYMBOLS AND LEGENDS, WATERBORNE OR SOLVENT CONTRACTOR SHALL REMOVE SURFACE CURE PRIOR TO INSTALLING PAVEMENT MARKINGS. REFLECTORIZING GLASS SPHERES SHALL BE INSTALLED WITH ALL PAVEMENT MARKINGS.
14	8040-A	TRAFFIC SIGNS, ADA SEE DETAIL 4/B.01. THIS ITEM SHALL BE FOR SIGN R7-8 AND PLAQUE R78PG AS REQUIRE FOR VAN ACCESSIBLE STALL. THIS ITEM IS SHALL BE PAID AS EACH SIGN POST.
15	8040-D	PERFORATED SQUARE STEEL TUBE POSTS SEE DETAIL 4/B.01.
16	8040-G	PERFORATED SQUARE STEEL TUBE POSTS ANCHORS, BREAKAWAY, 2 INCH SEE DETAIL 4/B.01.
17	8040-I	REMOVE SIGNS
18	9010-B	HYDRAULIC SEEDING, SEEDING, FERTILIZING, AND MULCHING, TYPE 1 - PERMANENT LAWN SEED ALL AREAS DISTURBED BY CONSTRUCTION AS INDICATED ON PLANS. THE COST FOR WATERING UNTIL SEED ESTABLISHMENT IS ACCEPTED SHALL BE CONSIDERED INCIDENTAL TO THIS ITEM. ROCK PICKING, FINISH GRADING, SEED BED PREP AND RESEEDING ARE CONSIDERED INCIDENTAL TO THIS ITEM. SEED AND FERTILIZER SHALL BE APPLIED PRIOR TO MULCHING. THE CONTRACTOR IS RESPONSIBLE FOR MOWING AND MAINTAINING SEEDED AREAS UNTIL THE PROJECT IS ACCEPTED BY THE OWNER. SEEDING OF AREAS DISTURBED OUTSIDE OF THE CONSTRUCTION LIMITS SHALL BE THE RESPONSIBILITY OF THE CONTRACTOR AT NO ADDITIONAL COST TO OWNER. THE SEEDING RATE SHALL BE AT LEAST 260 LBS/ACRE. APPLY A 6-24-24, NITROGEN, PHOSPHATE, POTASH, COMMERCIAL FERTILIZER OR EQUIVALENT AT THE RATE OF 300 LBS PER ACRE. APPLY MULCHING PER MANUFACTURERS RECOMMENDATIONS. SEEDING AREAS ASSUMED FOR TWO APPLICATIONS OVER THE AREAS DISTURBED.
19	9020-A	SOD A. SOD ALL AREAS DISTURBED BY CONSTRUCTION UNLESS INDICATED ON PLANS. COST FOR WATERING SHALL BE CONSIDERED INCIDENTAL TO THIS ITEM. ROCK PICKING, FINISH GRADING, AND REWORK, INCLUDING REGRADING AND ADJUSTING GRADING, ARE CONSIDERED INCIDENTAL TO THIS ITEM. CONTRACTOR RESPONSIBLE FOR PROTECTING ALL SODDED AREAS THRU ESTABLISHMENT AND ACCEPTANCE. CONTRACTOR RESPONSIBLE FOR MOWING AND MAINTAINING SODDED AREAS UNTIL PROJECT IS ACCEPTED BY OWNER. SODDING OF AREAS OUTSIDE OF CONSTRUCTION LIMITS SHALL BE RESPONSIBILITY OF CONTRACTOR AT NO ADDITIONAL COST TO OWNER.
20	9040-F-1	WATTLE, COMPOST/MULCH SOCK
21	9040-F-2	WATTLE, REMOVAL
22	11010-A	CONSTRUCTION SURVEY CONTRACTOR TO PROVIDE CONSTRUCTION STAKING AS NECESSARY FOR CONSTRUCTION. MONUMENTS WITHIN CONSTRUCTION LIMITS TO BE PROTECTED AND RESETTING OF DISTURBED MONUMENTS SHALL BE INCIDENTAL TO THIS ITEM. CONTROL POINTS AND ALIGNMENT DATA ARE SHOWN ON G.01. BOLTON & MENK TO PROVIDE THE FOLLOWING SUPPLEMENTAL DIGITAL DESIGN FILES: - ALIGNMENT AND PROPOSED SURFACE DATA AS .XML - CONTROL POINTS AS .CSV - PROPOSED BASE LINE WORK AS .DWG
23	11020-A	MOBILIZATION

ESTIMATE REFERENCE INFORMATION		
ITEM NO.	ITEM CODE	DESCRIPTION
1	0000-A	<p><u>ALLOWANCE FOR MASONARY REPAIR</u></p> <p>THIS ITEM IS AN ALLOWANCE FOR TIME AND MATERIAL FOR THE REPAIR AND RESTORATION OF EXISTING MASONRY ELEMENTS ABUTTING THE PAVEMENT. ACTUAL COST WILL BE PAID FOR WORK PERFORMED. ANY UNDER/OVER RUN WILL BE ADDRESSED IN A CHANGE ORDER. WORK UNDER THIS ALLOWANCE SHALL BE PERFORMED ONLY UPON DIRECTION OF THE ENGINEER AND CONSTRUCTION MANAGER. BID ITEM SHALL INCLUDE, REMOVAL AND REPLACEMENT OF DETERIORATED OR EXISTING DAMAGED BRICK, REPOINTING OF MORTAR JOINTS, CLEANING AND PREPARATION OF EXISTING SURFACES NECESSARY FOR REPAIR.</p>
2	2010-D-1	<p><u>TOPSOIL, ON-SITE</u></p> <p>TOPSOIL WITHIN THE GRADING LIMITS OF THE PROJECT SHALL BE STRIPPED AT A MINIMUM OF 8", SALVAGED, AND RESPREAD AT A MINIMUM DEPTH OF 6". ITEM INCLUDES HAULING OFF-SITE TO STORE AND HAULING BACK IN IF NEEDED. SALVAGED TOPSOIL SHALL REMAIN ON-SITE UNLESS AGREEMENTS MADE WITH THE PROPERTY OWNER. CONTRACTOR IS RESPONSIBLE FOR RESTORATION COST IF OUTSIDE OF GRADING LIMITS. QUANTITY IS CALCULATED BASED ON AREA OF DISTURBANCE 1860 SF, AT A DEPTH OF 8" OF TOPSOIL TO BE SALVAGED. THIS ITEM SHALL BE PAID ON A PERCENT COMPLETE BASIS, AND NO MEASUREMENT WILL BE MADE.</p>
3	2010-E	<p><u>EXCAVATION, CLASS 10</u></p> <p>THIS ITEM SHALL INCLUDE THE REMOVAL OF EXISTING SOIL, HAULING, DISPOSAL/EXPORT AND RE-GRADING AS NEEDED PER PLAN TO FACILITATE ALL PROPOSED SECTIONS. ALL BORROW SHALL BE PROVIDED BY THE CONTRACTOR. EXCESS OR UNSUITABLE EXCAVATED MATERIAL WILL BECOME PROPERTY OF THE CONTRACTOR AND WILL BE HAULED OFF-SITE INCIDENTAL TO THE ITEM. NO ADDITIONAL PAYMENT WILL BE ALLOWED FOR OVERHAUL OF WASTE. TOPSOIL SHALL BE PLACED AND SPREAD TO A MINIMUM THICKNESS OF 6" IN ALL DISTURBED TURF AREAS AND PAID FOR AS TOPSOIL, ON-SITE. RAW CUT = 234 CY, RAW FILL = 0 CY, ADJUSTED FILL (1.35 FACTOR) = 0 CY NET EARTHWORK = 234 CY CUT RAW EARTHWORK QUANTITIES ARE FOR INFORMATIONAL PURPOSES ONLY ARE A COMPARISON OF EXISTING CONDITIONS AND PROPOSED CONDITIONS AND MAY INCLUDE MATERIALS AND OPERATIONS PAID FOR UNDER OTHER BID ITEMS E.G. PAVEMENT REMOVAL, STORM SEWER TRENCHED, PCC PAVEMENT, SUBBASE, TOPSOIL, COMPOST AMENDMENT, ETC. MEASUREMENT WILL NOT BE MADE AND QUANTITY PAID WILL BE ON A PERCENT OF ITEM COMPLETE.</p>
4	2010-G	<p><u>SUBGRADE PREPARATION</u></p> <p>CONTRACTOR SHALL PROOF ROLL THE EXISTING SUBGRADE IMMEDIATELY FOLLOWING REMOVAL OF PAVEMENT TO IDENTIFY YIELDING SOILS PER THE GEOTECHNICAL REPORT'S RECOMMENDATION. UNSUITABLE SOILS SHALL BE REMOVED AND HAULED OFF SITE AND REPLACED WITH SUITABLE SOILS FROM ON-SITE. FOLLOWING PROOFROLLING SUBGRADE SHALL BE SCARIFIED, MOISTURE CONDITIONED, GRADED, AND COMPACTED. CONTRACTOR SHALL POTHOLE ALL UTILITIES PRIOR TO SUBGRADE PREPARATION. COORDINATE WITH ENGINEER FOR ANY UTILITIES IN CONFLICT</p>
5	2010-J	<p><u>SUBBASE, MODIFIED, 6 INCHES</u></p> <p>THIS ITEM INCLUDES, BUT IS NOT LIMITED TO, COMPACTION OF SUBGRADE, FURNISHING, PLACING, COMPACTING, AND TRIMMING TO THE PROPER GRADE.</p>

© Bolton & Menk, Inc. 2025. All Rights Reserved. 4/16/2025 11:31 AM 4/29/2025 14:29:37 C:\Users\jmc\OneDrive\Documents\42925-40354-PM



430 E GRAND AVENUE, SUITE 101
DES MOINES, IA 50309
Phone: (515) 259-9190
Email: DesMoines@bolton-menk.com
www.bolton-menk.com

DESIGNED	REV	DESCRIPTION	DATE
FAM	0	ISSUED FOR BID	06/22/2026
DRAWN			
CHECKED			
FAM			
CLIENT PROJ. NO.	9526.00		

IOWA DEPARTMENT OF ADMINISTRATIVE SERVICES
DPS POST 2 - PARKING LOT REPLACEMENT
ESTIMATED PROJECT QUANTITIES AND NOTES

SHEET
C.01

LEGEND

- 6" PCC PAVEMENT
- 4" PCC SIDEWALK
- TURNING SPACE (6" PCC)

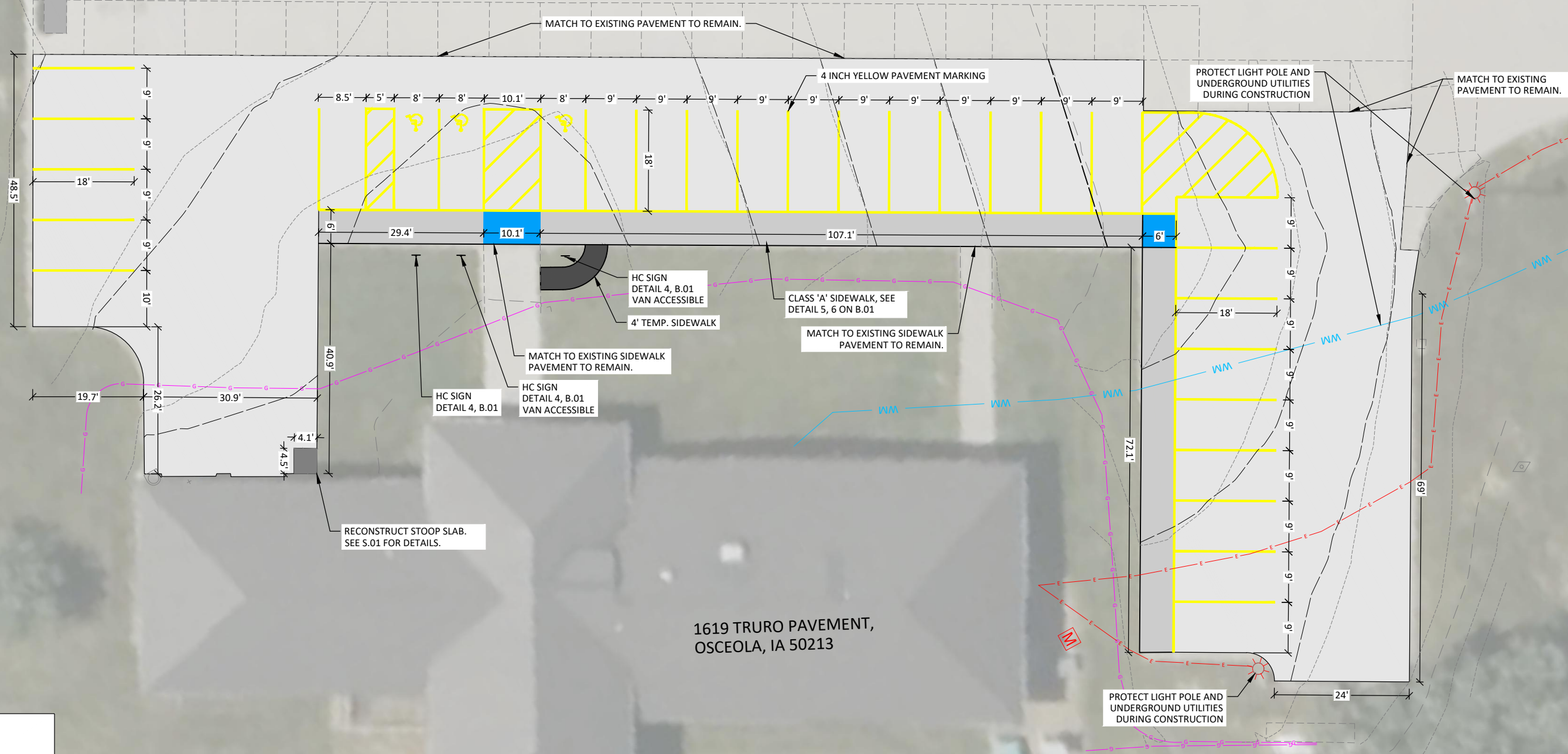

1619 TRURO PAVEMENT,
OSCEOLA, IA 50213

THIS SHEET SET IS INTENDED TO BE PLOTTED IN COLOR

EXISTING PARKING:
47 STANDARD PARKING STALLS 3 ADA ACCESSIBLE PARKING STALLS
PROPOSED PARKING COUNT:
EXISTING STANDARD PARKING STALLS 49 STANDARD PARKING STALLS 3 ADA ACCESSIBLE PARKING STALLS

© Bolton & Menk, Inc. 2026. All Rights Reserved. 11/14/2025 11:23:42 AM 429797001.CAD/1429797001.dwg 6/24/2026 4:04:09 PM



430 E GRAND AVENUE, SUITE 101
DES MOINES, IA 50309
Phone: (515) 259-9190
Email: DesMoines@bolton-menk.com
www.bolton-menk.com

DESIGNED	REV	DESCRIPTION	DATE
FAM	0	ISSUED FOR BID	06/22/2026
DRAWN	PL		
CHECKED	FAM		
CLIENT PROJ. NO.	9526.00		

IOWA DEPARTMENT OF ADMINISTRATIVE SERVICES
DPS POST 2 - PARKING LOT REPLACEMENT
PLAN LAYOUT

SHEET
D.01

LEGEND

	6" PCC PAVEMENT
	4" PCC SIDEWALK
	TURNING SPACE (6" PCC)

NOTE:
JOINT LAYOUT MATCHES EXISTING JOINT SPACING.
SEE D.02 FOR GRADING AND ELEVATION INFORMATION.

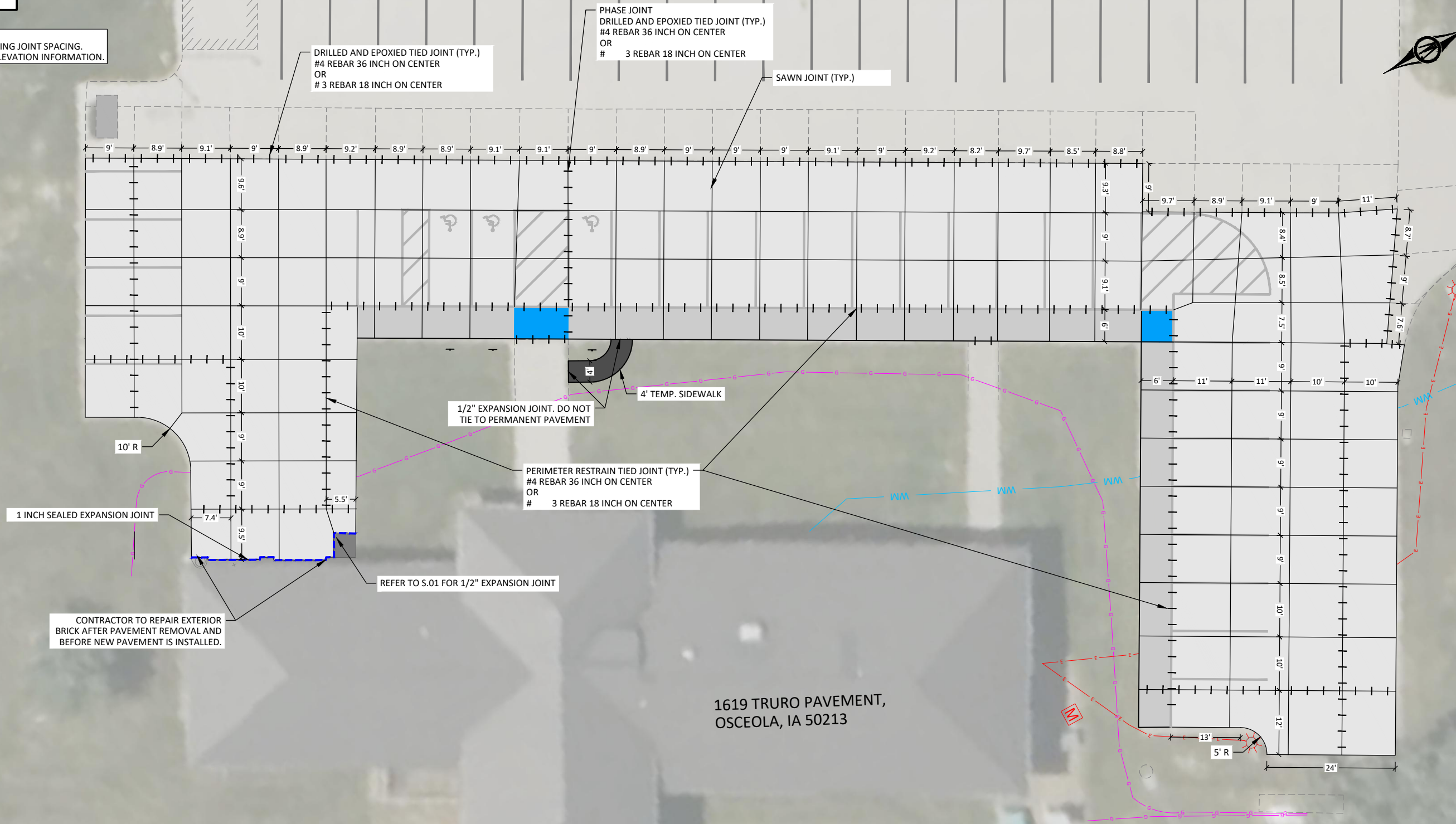

THIS SHEET SET IS INTENDED TO BE PLOTTED IN COLOR

1619 TRURO PAVEMENT,
OSCEOLA, IA 50213

© Bolton & Menk, Inc. 2026. All Rights Reserved. 142997D02.dwg 6/24/2026 4:04:27 PM

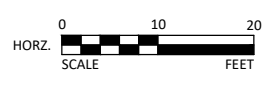

430 E GRAND AVENUE, SUITE 101
DES MOINES, IA 50309
Phone: (515) 259-9190
Email: DesMoines@bolton-menk.com
www.bolton-menk.com

DESIGNED	REV	DESCRIPTION	DATE
FAM	0	ISSUED FOR BID	06/22/2026
DRAWN			
CHECKED			
FAM			
CLIENT PROJ. NO.			
9526.00			

IOWA DEPARTMENT OF ADMINISTRATIVE SERVICES		SHEET
DPS POST 2 - PARKING LOT REPLACEMENT		D.03
JOINTING PLAN		

THIS SHEET SET IS INTENDED TO BE PLOTTED IN COLOR

EXISTING INCINERATOR
EXISTING DUMPSTER

FULL DEPTH SAW CUT AT REMOVAL LIMITS. DOUBLE SAW CUT AS NECESSARY TO PROTECT EXISTING PAVEMENT TO REMAIN AND MAINTAIN CLEAN JOINT TO MATCH TO. DAMAGED PAVEMENT MAY REQUIRE FULL PANEL REPLACEMENT. NO ADDITIONAL PAYMENT WILL BE MADE FOR ADDITIONAL SAW CUTS, REMOVALS OR PCC PAVEMENT NECESSARY TO REMEDY DAMAGED EDGE DURING CONSTRUCTION.

REMOVE 1388 SY PAVEMENT

REMOVE EXISTING ADA STALL SIGN

REMOVE TOP SLAB OF STOOP.

CONTRACTOR TO PROTECT EXISTING BUILDING EXTERIOR FROM DAMAGE AT ALL TIMES. PROTECTION SHALL BE SELF SUPPORTED AND NOT AFFIXED TO THE BUILDING.

1619 TRURO PAVEMENT,
OSCEOLA, IA 50213



© Bolton & Menk, Inc. 2026. All Rights Reserved
PL\ADMIN\31_142934\259760\CAD\3D\142937701.dwg 6/24/2026 4:04:35 PM

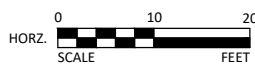

430 E GRAND AVENUE, SUITE 101
DES MOINES, IA 50309
Phone: (515) 259-9190
Email: DesMoines@bolton-menk.com
www.bolton-menk.com

DESIGNED	REV	DESCRIPTION	DATE
FAM	0	ISSUED FOR BID	06/22/2026
DRAWN			
CHECKED			
FAM			
CLIENT PROJ. NO.			
9526.00			

IOWA DEPARTMENT OF ADMINISTRATIVE SERVICES
DPS POST 2 - PARKING LOT REPLACEMENT
EXISTING CONDITIONS AND REMOVALS

SHEET
F.01

THIS SHEET SET IS INTENDED TO BE PLOTTED IN COLOR

© Bolton & Menk, Inc. 2026. All Rights Reserved. 11/14/2025 11:42:59 AM. 6/24/2026 4:04:43 PM



POINT NORTHING-EASTING DATA

POINT NUMBER	RAW DESCRIPTION	ELEVATION	NORTH	EAST
50	VFCP / CUT X CORNER PAVEMENT	1020.723	390249.63	1561909.53
51	VFCP / 1/2" REBAR PINK CAP	1019.405	390213.89	1562011.30
53	VFCP / CUT X CORNER PAVEMENT	1027.251	390048.94	1561798.60
152	VFCP / 1/2" REBAR PINK CAP	1022.098	389914.99	1561884.25



430 E GRAND AVENUE, SUITE 101
DES MOINES, IA 50309
Phone: (515) 259-9190
Email: DesMoines@bolton-menk.com
www.bolton-menk.com

DESIGNED	REV	DESCRIPTION	DATE
FAM	0	ISSUED FOR BID	06/22/2026
DRAWN	PL		
CHECKED	FAM		
CLIENT PROJ. NO.	9526.00		

IOWA DEPARTMENT OF ADMINISTRATIVE SERVICES
DPS POST 2 - PARKING LOT REPLACEMENT
REFERENCE, BENCHMARKS, AND GEOTECHNICAL DATA

SHEET
G.01

THIS SHEET SET IS INTENDED TO BE PLOTTED IN COLOR

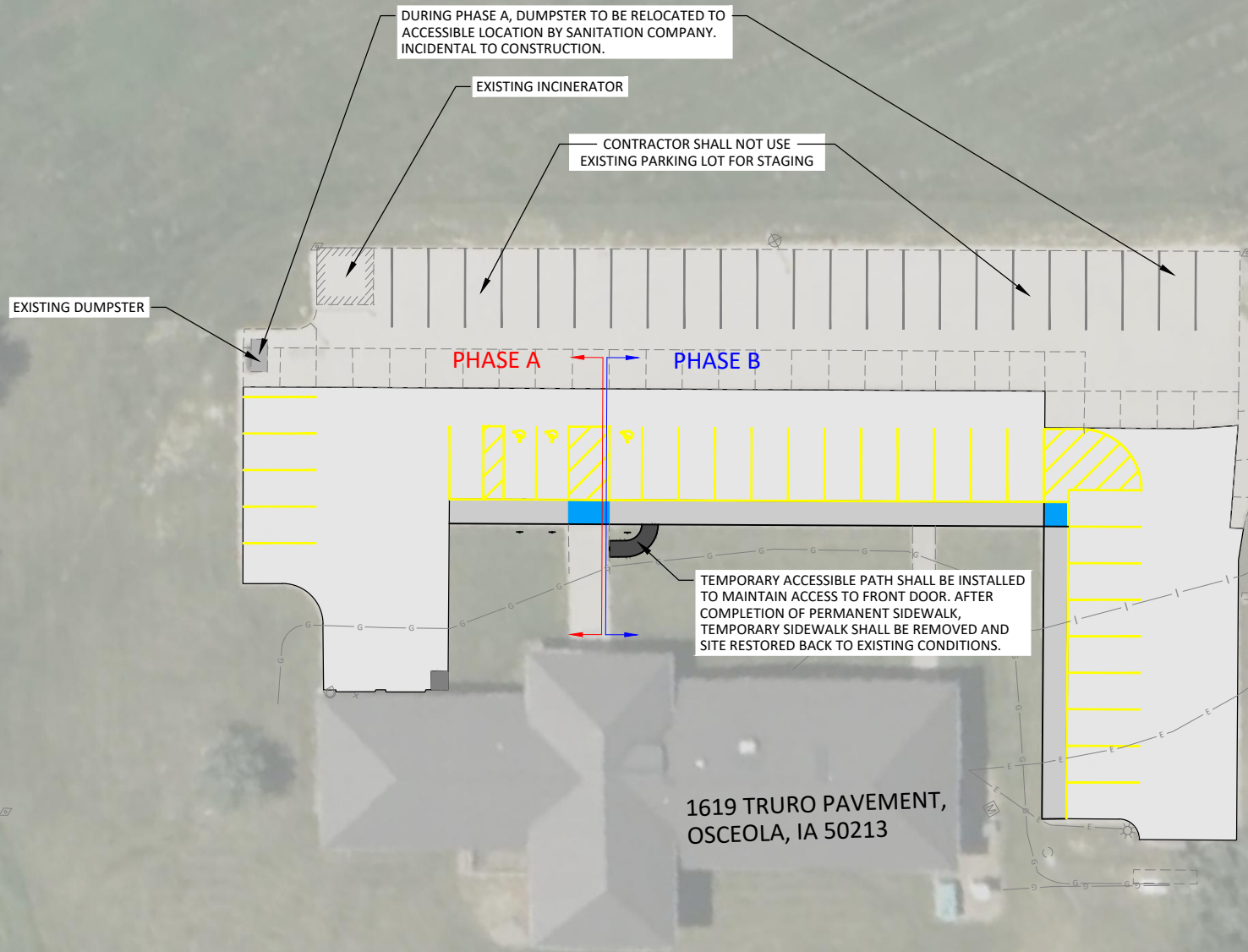

NOTES:

1. ONLY ONE PHASE SHALL BE UNDER CONSTRUCTION AT A TIME.
2. CONTRACTOR SHALL ENSURE PARKING STALLS IN **PHASE B** AND PARKING STALL IN EXISTING PARKING LOT PAVEMENT TO REMAIN, ARE OPEN ON TUESDAY, SEPTEMBER 22, 2026.
3. COORDINATE WITH CONSTRUCTION MANAGER AND OWNER FOR STAGING OF EQUIPMENT AND MATERIAL IN PARKING STALLS OUTSIDE OF CONSTRUCTION LIMITS.

© Bolton & Menk, Inc. 2026. All Rights Reserved. P:\ADMIN\131_142924\259760\CAD\CD\142924.dwg 6/24/2026 4:04:55 PM

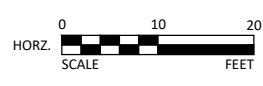

430 E GRAND AVENUE, SUITE 101
DES MOINES, IA 50309
Phone: (515) 259-9190
Email: DesMoines@bolton-menk.com
www.bolton-menk.com

DESIGNED	REV	DESCRIPTION	DATE
FAM	0	ISSUED FOR BID	06/22/2026
DRAWN	PL		
CHECKED	FAM		
CLIENT PROJ. NO.	9526.00		

IOWA DEPARTMENT OF ADMINISTRATIVE SERVICES
DPS POST 2 - PARKING LOT REPLACEMENT
PHASING PLAN

SHEET
J.01

THIS SHEET SET IS INTENDED TO BE PLOTTED IN COLOR

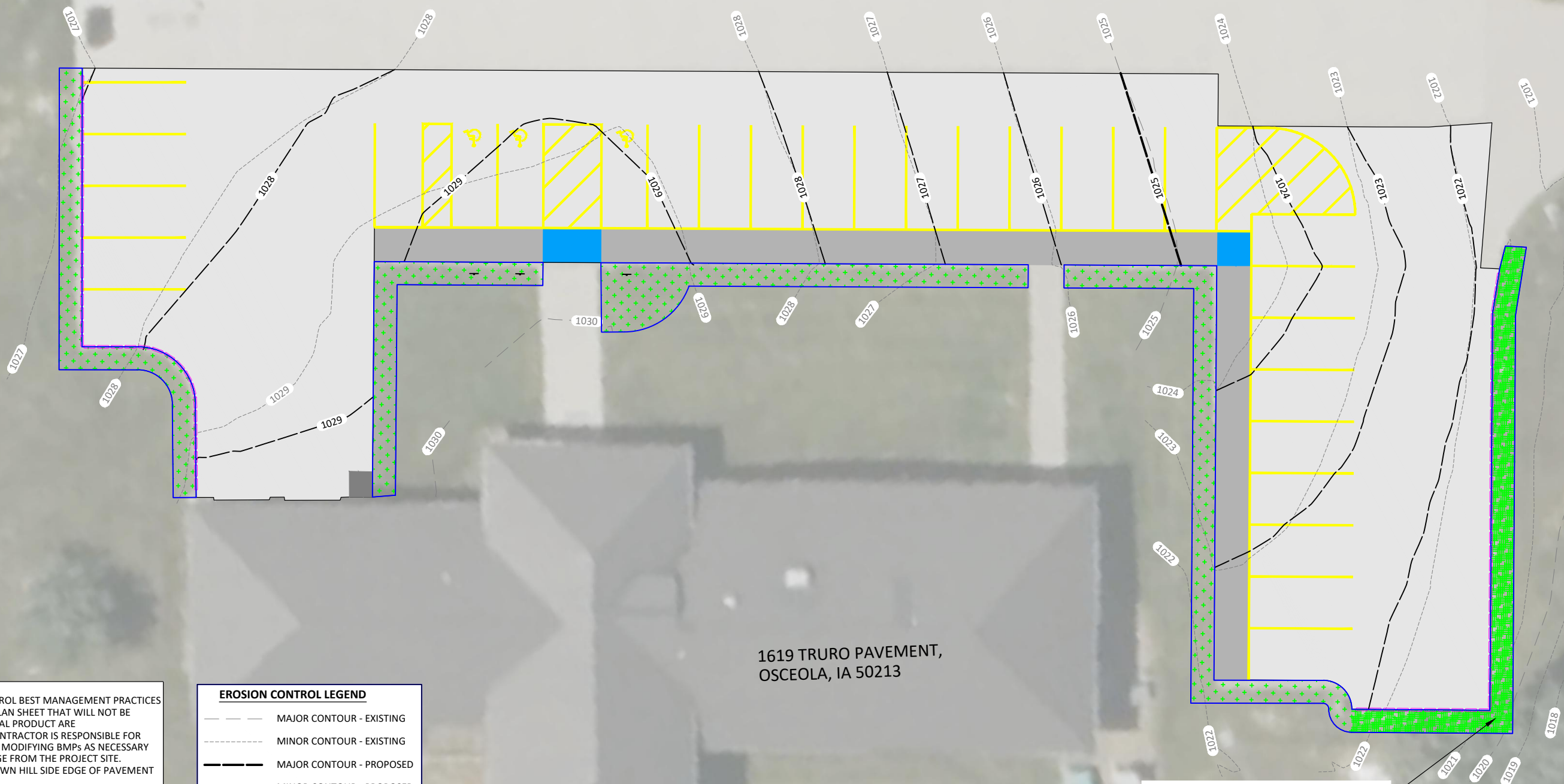

1619 TRURO PAVEMENT,
OSCEOLA, IA 50213

CONTRACTOR TO SECURE SOD TO PREVENT MOVEMENT. SOD THAT IS DISPLACED BY RAIN EVENTS SHALL BE REMOVED, TOP SOIL REGRADED, AND NEW SOD INSTALLED AT NO ADDITIONAL COST TO OWNER.

- NOTE:**
1. TEMPORARY EROSIONS CONTROL BEST MANAGEMENT PRACTICES (BMPs) AS SHOWN ON THIS PLAN SHEET THAT WILL NOT BE INCORPORATED INTO THE FINAL PRODUCT ARE RECOMMENDATIONS. THE CONTRACTOR IS RESPONSIBLE FOR DESIGNING, INSTALLING, AND MODIFYING BMPs AS NECESSARY TO PREVENT ILLICIT DISCHARGE FROM THE PROJECT SITE.
 2. SOD SHALL BE INSTALL ON DOWN HILL SIDE EDGE OF PAVEMENT AS SHOWN.
 3. CONTRACTOR SHALL MINIMIZE DISTURBANCE TO SITE AS SHOW BY LIMITS OF SOD AND SEEDING.
 4. CONTRACTOR IS RESPONSIBLE FOR THEIR CONSTRUCTION OPERATIONS ON SITE AND SHALL RE-ESTABLISH GRADE AND RE-SEED ANY ADDITIONAL DISTURBANCE AT NO ADDITIONAL COST TO THE OWNER.

EROSION CONTROL LEGEND	
	MAJOR CONTOUR - EXISTING
	MINOR CONTOUR - EXISTING
	MAJOR CONTOUR - PROPOSED
	MINOR CONTOUR - PROPOSED
	COMPOST/MULCH SOCK
	SOD
	TYPE 1 LAWN - HYDROSEED

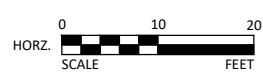

430 E GRAND AVENUE, SUITE 101
DES MOINES, IA 50309
Phone: (515) 259-9190
Email: DesMoines@bolton-menk.com
www.bolton-menk.com

DESIGNED	REV	DESCRIPTION	DATE
FAM	0	ISSUED FOR BID	06/22/2026
DRAWN	PL		
CHECKED	FAM		
CLIENT PROJ. NO.	9526.00		

IOWA DEPARTMENT OF ADMINISTRATIVE SERVICES
DPS POST 2 - PARKING LOT REPLACEMENT
EROSION CONTROL

SHEET
R.01

© Bolton & Menk, Inc. 2026. All Rights Reserved. P:\ADMIN\31_142024\25991800\CAD\CAD14299780.dwg 6/24/2026 4:05:07 PM

GENERAL NOTES

1. CONTRACTOR SHALL FIELD VERIFY ALL EXISTING CONDITIONS. COORDINATE WITH ENGINEER IF ANY DISCREPANCIES ARE DISCOVERED. CONFIRM FIELD CONDITIONS & DIMENSIONS WITH ENGINEER PRIOR TO START OF CONSTRUCTION.
2. THE CONTRACTOR SHALL INFORM THE ENGINEER IMMEDIATELY OF ANY DEVIATION FROM THE CONTRACT DOCUMENTS. THE CONTRACTOR SHALL NOT PROCEED WITH THE RESPONSIBILITY FOR SUCH DEVIATION WITHOUT ENGINEER'S APPROVAL OF SHOP DRAWINGS, PRODUCT DATA, ETC. UNLESS AS SPECIFICALLY INFORMED BY ENGINEER OF SUCH DEVIATION AT THE TIME OF SUBMISSION, AND THE ENGINEER HAS TIME TO PROVIDE REVIEW.
3. CONTRACTOR SHALL BRING TO THE ATTENTION OF THE ENGINEER ALL THINGS WHICH IN THE OPINION OF THE CONTRACTOR APPEAR TO BE DEFICIENCIES, OMISSIONS, CONTRADICTIONS, OR AMBIGUITIES IN THE PLANS AND SPECIFICATIONS. WRITTEN CORRECTIONS OR INTERPRETATION SHALL BE MADE BY THE ENGINEER BEFORE THE AFFECTED WORK PROCEEDS.

CONCRETE

1. CONCRETE SHALL BE A SUDAS 'C4-WR' MIX AND CONSTRUCTED IN ACCORDANCE WITH IBC CHAPTER 19 AND ACI 318.
2. REINFORCING SHALL BE EPOXY COATED AND CONFORM TO ASTM A615, GR. 60, INCLUDING TIES AND STIRRUPS.
3. ALL REINFORCING SHALL BE DETAILED, FABRICATED AND PLACED, IN ACCORDANCE WITH ACI DETAILING MANUAL. NO FIELD BENDING OF REINFORCEMENT SHALL BE PERMITTED EXCEPT WHERE SPECIFICALLY NOTED IN THE DRAWINGS.
4. ALL REINFORCING SHALL BE SUPPORTED IN FORMS, SPACED WITH NECESSARY ACCESSORIES AND SHALL BE SECURELY WIRED TOGETHER, IN ACCORDANCE WITH CRSI "REINFORCING BAR DETAILING". ALL DOWELS, ANCHOR RODS, EMBEDS, SLEEVES AND OTHER EMBEDDED ITEMS SHALL BE SECURELY TIED AND SUPPORTED PRIOR TO POURING CONCRETE. NO WET-SETTING SHALL BE PERMITTED.
5. MINIMUM 2" CONCRETE COVER OVER REINFORCEMENT.
6. LAP SPLICE SHALL HAVE A MINIMUM OF 24"
7. PROVIDE STANDARD HOOKS ON BARS TERMINATING AT A CONCRETE FACE UNLESS NOTED (E.G.: SLAB EDGES, EXPANSION JOINTS, AND AT: TOP, BOTTOM AND ENDS OF WALLS, ETC...).
8. FOLLOW RECOMMENDATIONS OF ACI PRC-305 AND ACI PRC-306 WHEN CONCRETING DURING HOT OR COLD WEATHER, RESPECTIVELY.
9. FORMWORK DESIGN AND CONSTRUCTION SHALL COMPLY WITH GUIDELINES OF ACI PRC-347 TO PROVIDE FORMWORK THAT WILL PRODUCE CONCRETE COMPLYING WITH TOLERANCES OF ACI SPEC-117.
10. CONCRETE SHALL BE CURED AND PROTECTED IN ACCORDANCE WITH ACI PRC-308
11. PROVIDE ISOLATION JOINT FILLER COMPLYING WITH ASTM D1751, CELLULOSE FIBER. JOINT FILLER SHALL BE 1/2" THICK, HEIGHT EQUAL TO SLAB THICKNESS, WITH 1/2" REMOVABLE TOP SECTION CAPABLE OF ACCEPTING JOINT SEALANT.
12. JOINT SEALANT SHALL BE ONE-PART, MOISTURE CURING POLYURETHANE, ASTM C920, TYPE S, GRADE NS, CLASS 35.
13. STOOP SLAB SHALL HAVE A MEDIUM BROOMED FINISH

SUBMITTALS

1. THE FOLLOWING ITEMS AT MINIMUM SHALL BE SUBMITTED FOR REVIEW:
 - CONCRETE MIX DESIGNS, INCLUDING PRODUCT DATA
 - CONCRETE REINFORCING
 - JOINT SEALANT
 - THRESHOLD PLATE
2. CONTRACTOR SHALL REVIEW EACH SUBMITTAL FOR CONFORMANCE WITH CONTRACT DOCUMENTS. SUBMITTALS NOT REVIEWED BY THE CONTRACTOR WILL BE REJECTED. IT IS THE CONTRACTOR'S RESPONSIBILITY TO COORDINATE WORK AFFECTED BY OTHER TRADES.
3. SUBMITTALS SHALL BE REVIEWED BY THE ENGINEER FOR COMPLIANCE WITH THE CONTRACT DOCUMENTS.

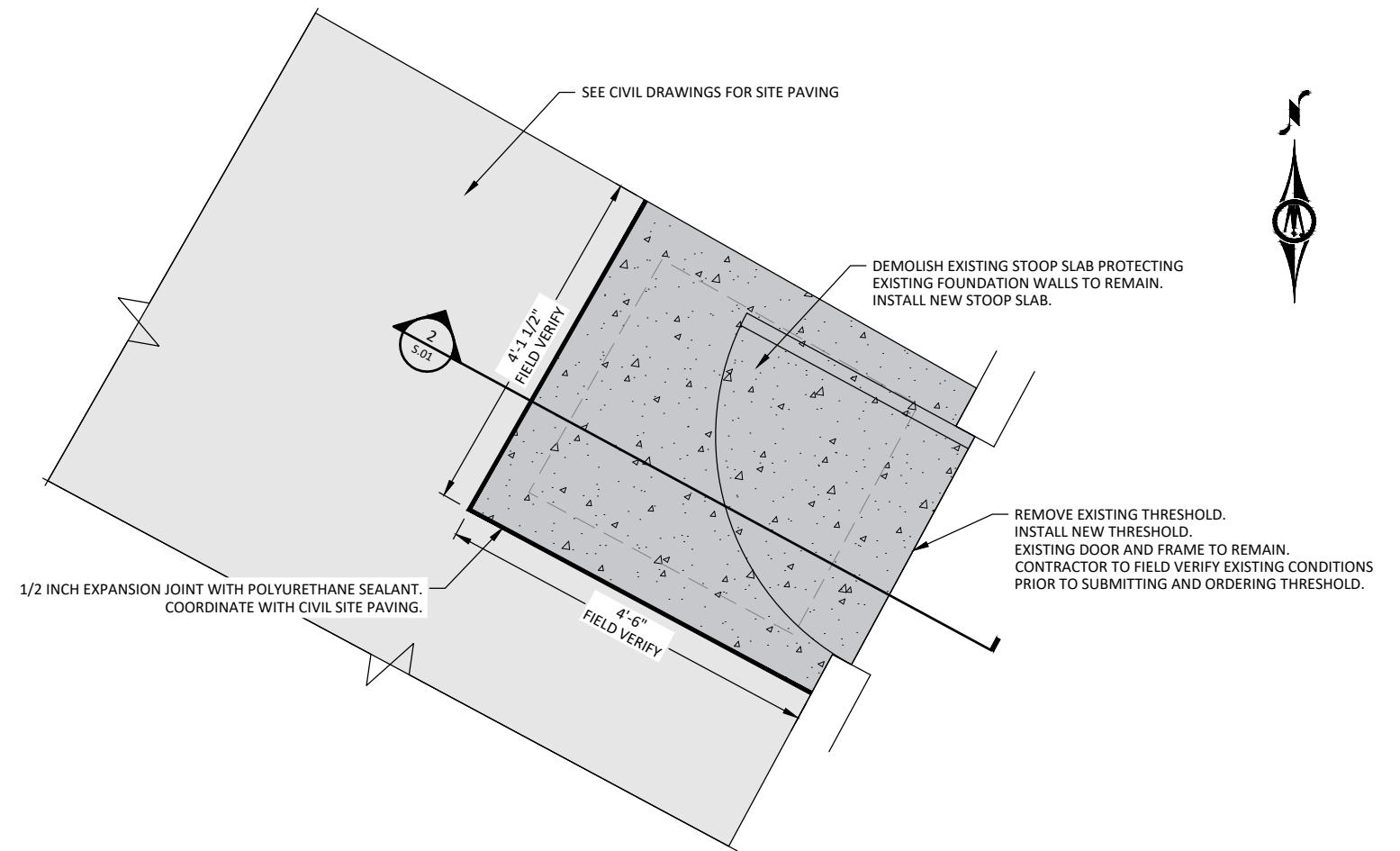

1
S.01
STOOP PLAN
NOT TO SCALE

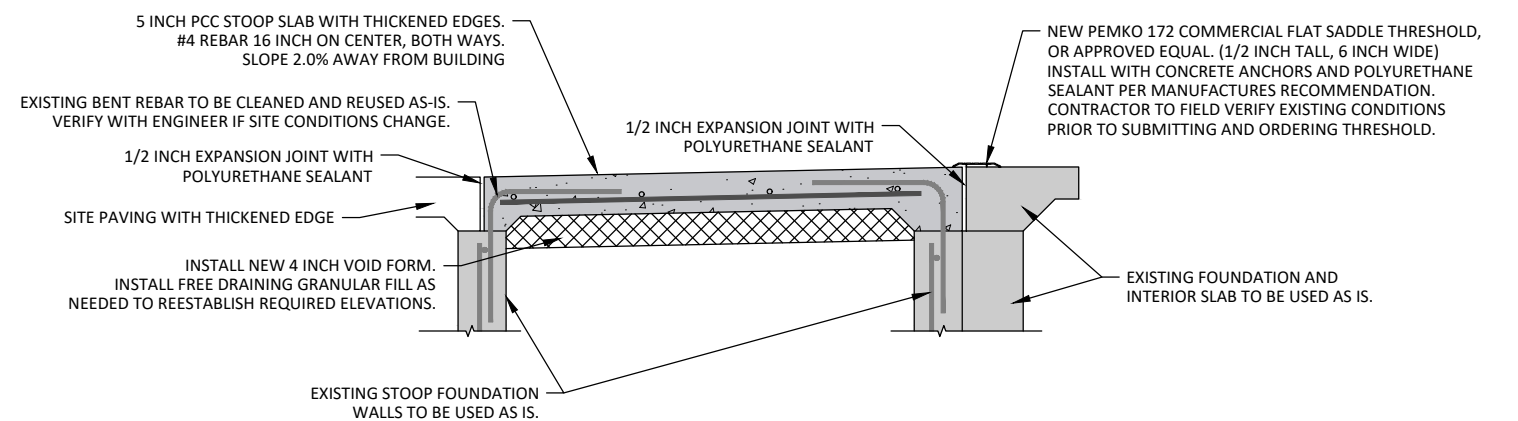

2
S.01
STOOP DETAIL SECTION A
NOT TO SCALE

THIS SHEET SET IS INTENDED TO BE PLOTTED IN COLOR

© Bolton & Menk, Inc. 2026. All Rights Reserved. 11/14/2025 11:42:59 AM C:\Users\jmc\OneDrive\Documents\142997501.dwg 6/24/2026 4:05:15 PM



430 E GRAND AVENUE, SUITE 101
DES MOINES, IA 50309
Phone: (515) 259-9190
Email: DesMoines@bolton-menk.com
www.bolton-menk.com

DESIGNED	REV	DESCRIPTION	DATE
FAM	0	ISSUED FOR BID	06/22/2026
DRAWN	PL		
CHECKED	RRE		
CLIENT PROJ. NO.	9526.00		

IOWA DEPARTMENT OF ADMINISTRATIVE SERVICES
DPS POST 2 - PARKING LOT REPLACEMENT
STOOP SLAB REPLACEMENT

SHEET
S.01