

Plot Date: 5/27/2026 2:10 PM G:\Shared drives\DNR LWB ENG Projects\30_Dickinson\26-01-30-01 Hodge WPA Wetland Restoration\5_Design\C3D\26-01-30-01 Hodge WPA Wetland Resto.dwg



Drawn by: xx	
Revision	Date
90%	2/3/26
Final	5/27/26

Bid Date:
mm/dd/yyyy

Project Number:
26-01-30-01

Hodge WPA Wetland Restoration
T100N, R37N, Sec. 23 Dickson County

Project Vicinity

Sheet No:
2

Plot Date: 5/27/2026 2:11 PM G:\Shared drives\DNR LWB ENG Projects\30_Dickinson\26-01-30-01 Hodge WPA Wetland Restoration\5_Design\C3D\26-01-30-01 Hodge WPA Wetland Resto.dwg

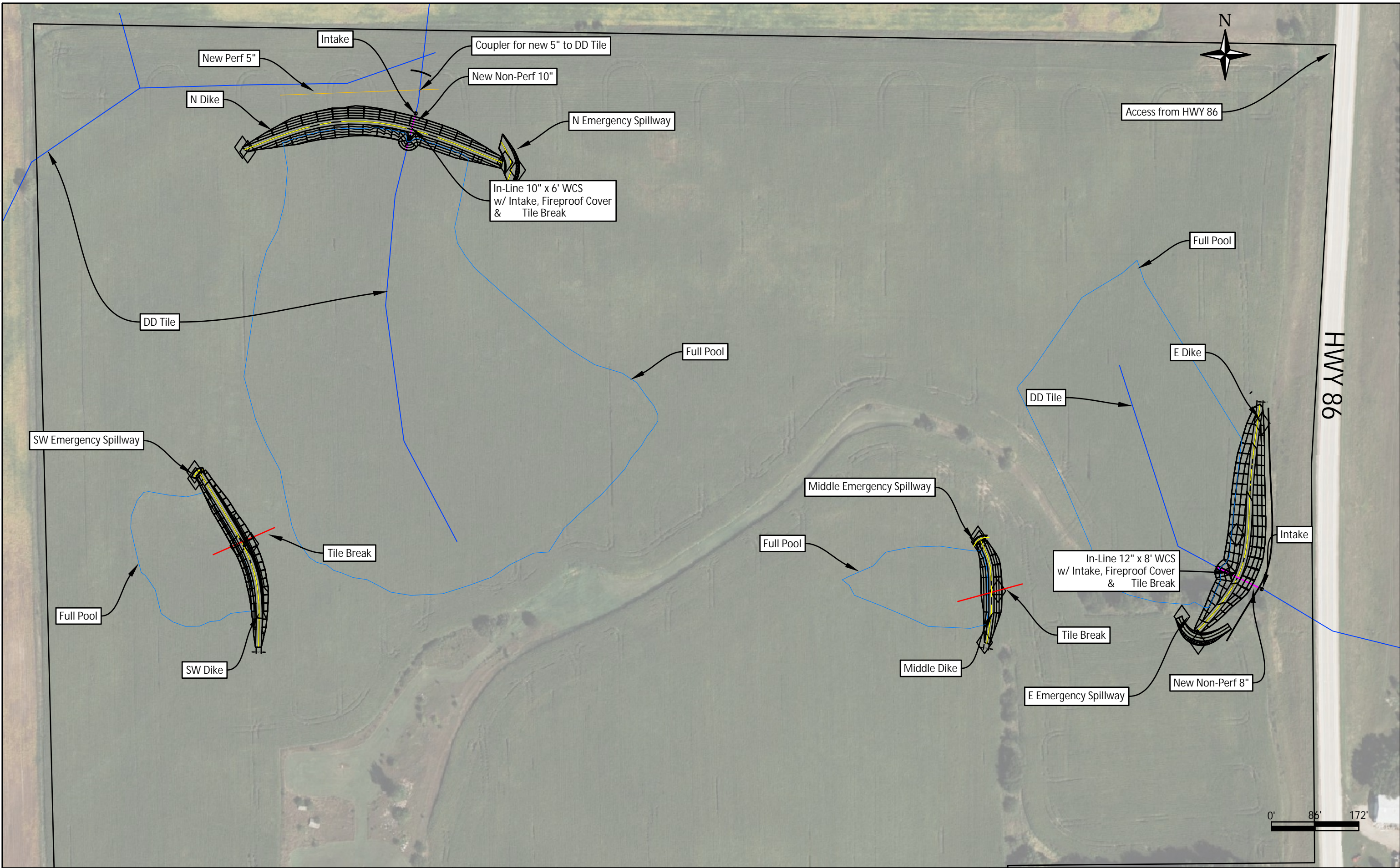

Drawn by: xx	
Revision	Date
90%	2/3/26
Final	5/27/26

G:\Shared drives\DNR LWB ENG Projects\30_Dickinson\26-01-30-01_Hodge_WPA Wetland Restoration\5_Design\C3\26-01-30-01_Hodge_WPA Wetland Rest.to.dwg Plot Date: 5/27/2026 2:11 PM

Estimated Quantities

Item	Description	Quantity	Unit
1	Mobilization	1	LS
2	On-Site Topsoil Stripping and Salvaging	2,500	CY
3	Embankment Construction - Dikes	7,095	CY
4	Class 10 Excavation - Spillways	168	CY
5	Tile Search	1,600	LF
6	Tile Break	5	EA
7	Agri Drain WCS 12"x8' - (10" boots) - Install Only	1	EA
8	Agri Drain WCS 10"x6' - (8" boots) - Install Only	1	EA
9	Fireproof Cover - Install Only	2	EA
10	10" Dual Wall Non-Perf Tile - Install Only	120	LF
11	8" Dual Wall Non-Perf Tile	130	LF
12	6" CMP Intake	2	EA
13	Tile Couplers	5	EA
14	5" Perf-Tile - Install Only	300	LF
15	4'x4' Anti-Seep Collar	2	EA
16	6" Heavy Duty Bar Guard	2	EA
17	8" Heavy Duty Bar Guard	1	EA
18	10" Heavy Duty Bar Guard	1	EA
19	10" Tee	2	EA
20	8" Tee	2	EA
21	Erosion Stone	25	TN
22	1" Clean Stone	5	TN
23	Revetment Stone - Class D	5	TN
24	NPDES Permit & Monitoring	1	LS
25	12" Straw Wattle	540	LF

Estimate Reference Information

1. Site is accessible form Hwy 86
2. Stripped topsoil shall be stockpiled at location identified by DNR Field Engineer.
3. Excavated material must be obtained from within the wetland pool area and originate no closer than 30' to footprint of dike.
6. Tile break shall be preformed with excavator and be a minimum of 100' in length
7. DNR Supplied (Contractor to supply the 1" clean stone under line item #22)
8. DNR Supplied (Contractor to supply the 1" clean stone under line item #22)
9. DNR Supplied
10. DNR Supplied
11. Drainage tile shall meet ASTM F 405-13 and AASHTO M 252-09 specifications.
12. Perforated 4' 18ga galvanized CMP. Contractor to include connection to HDPE tile below grade. HDPE riser to be paid under the 8" dual wall non-perf tile line item. Steel rod stop to be incidental to construction.
13. Tile coupler shall meet ASTM F 405-13 and AASHTO M 252-09 specifications and size shall be determined based on what is encountered during tile search.
14. DNR Supplied
15. Two anti-seep collars are required, one will be DNR supplied
16. Agri Drain HD Bar Guard or DNR Engineer approved equivalent
17. Agri Drain HD Bar Guard or DNR Engineer approved equivalent
18. Agri Drain HD Bar Guard or DNR Engineer approved equivalent
19. Two 10" tees are required, one will be DNR supplied. Tee shall meet ASTM F 405-13 and AASHTO M 252-09 specifications
20. Tee shall meet ASTM F 405-13 and AASHTO M 252-09 specifications
24. The contractor shall obtain an NPDES Permit #2 for stormwater discharge, develop the required SWPPP, and complete the required inspections.

General Information

1. Verify actual locations and elevations with DNR Engineer.
2. All work shall conform to and be performed in accordance with all applicable codes and ordinances.
3. The contractor shall visit the site and inspect the project area and thoroughly familiarize themselves with the actual job conditions prior to bidding and the start of work. Failure to visit the project site shall not relieve the contractor from performing the work in accordance to the plans, specification, special provisions and contract.
4. The contractor shall verify, at the site, all dimensions and conditions shown on the plans and shall notify the DNR Engineer of any discrepancies, omissions, and/or conflicts prior to proceeding with the work.
5. It shall be the contractor's responsibility to provide waste areas or disposal sites for excess material (excavated material or broken concrete) which is not desirable to be incorporated into the work involved on this project. No payment for overhaul will be allowed for material hauled to these sites. No material shall be placed within the right-of-way, unless specifically stated in the plans or approved by the DNR Engineer.
6. The contractor shall not disturb desirable grass areas and desirable trees outside the construction limits. The contractor will not be permitted to park or service vehicles and equipment or use these areas for storage of materials. Storage, parking and service areas will be subject to the approval of the DNR Engineer.
7. Where utilities and fixtures are shown as Existing on the plans or encountered within the construction area, it shall be the responsibility of the contractor to notify the DNR Engineer of those utilities prior to the beginning of any construction. The contractor shall be afforded access to these facilities for necessary modification of services. Underground facilities, structures and utilities have been plotted from available surveys and records and therefore their locations must be considered approximate only. It is possible there may be others, the existence of which is presently not known or shown. It is the contractor's responsibility to determine their existence and exact location and to avoid damage thereto. No claims for additional compensation will be allowed to the contractor for any interference or delay caused by such work.
8. The contractor shall shape graded area to maintain surface drainage. All elevations are to finish grade.
9. The contractor is expected to have materials, equipment, and labor available on a daily basis to install and maintain erosion control features on the project. This may involve seeding, silt fence, rock ditch checks, silt basins or silt dikes.



Drawn by: xx	
Revision	Date
90%	2/3/26
Final	5/27/26

Plot Date: 5/27/2026 2:11 PM G:\Shared drives\DNR LWB ENG Projects\30_Dickinson\26-01-30-01 Hodge WPA Wetland Restoration\5_Design\C3D\26-01-30-01 Hodge WPA Wetland Resto.dwg

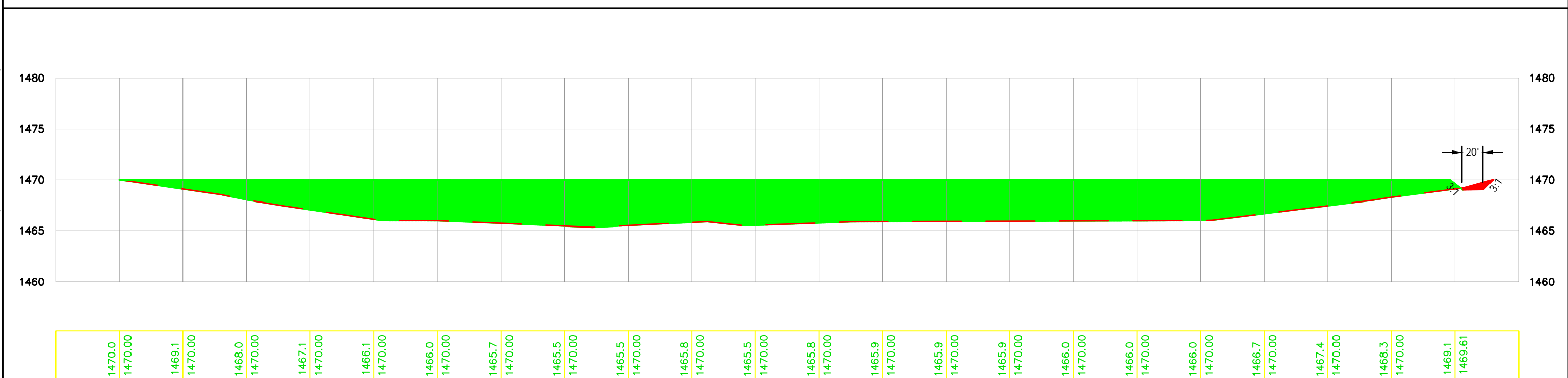
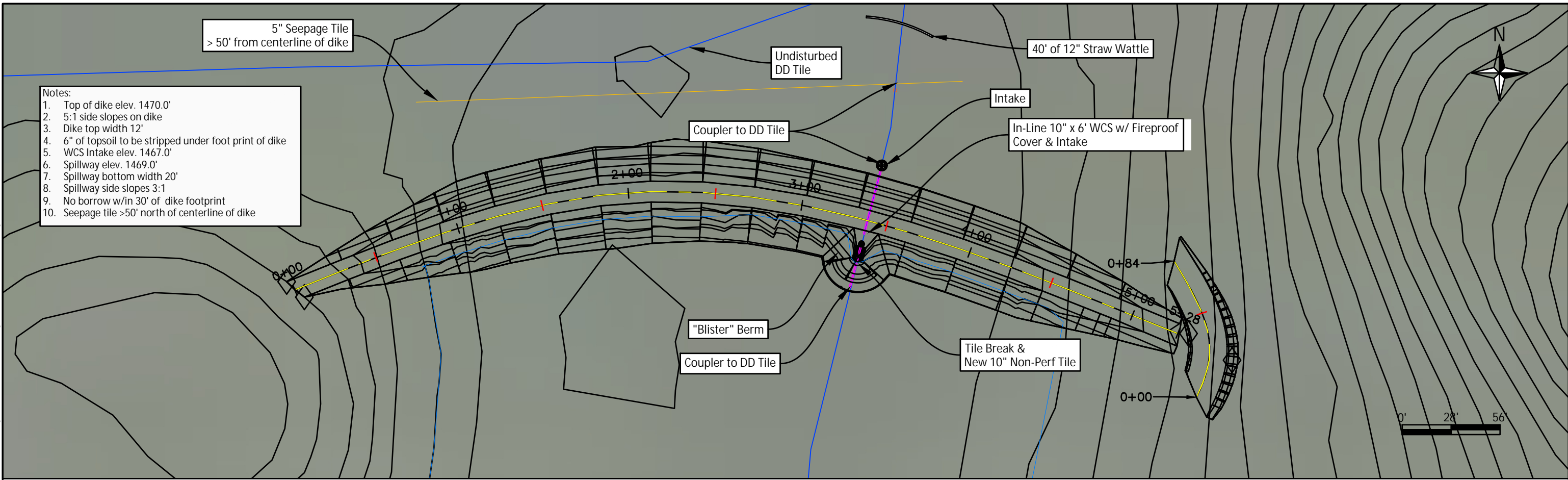

Station	Elevation (ft)
-0+25	1470.00
0+00	1470.00
0+25	1469.10
0+50	1468.00
0+75	1467.10
1+00	1466.10
1+25	1466.00
1+50	1465.70
1+75	1465.50
2+00	1465.50
2+25	1465.80
2+50	1465.50
2+75	1465.80
3+00	1465.90
3+25	1465.90
3+50	1465.90
3+75	1466.00
4+00	1466.00
4+25	1466.00
4+50	1466.70
4+75	1467.40
5+00	1468.30
5+25	1469.10
5+50	1469.61

- Notes:
1. Top of dike elev. 1472.8'
 2. 5:1 side slopes on dike
 3. Dike top width 12'
 4. 6" of topsoil to be stripped under foot print of dike
 5. Spillway elev. 1471.8'
 6. Spillway bottom width 8'
 7. Spillway side slopes 3:1
 8. No borrow w/in 30' of dike footprint

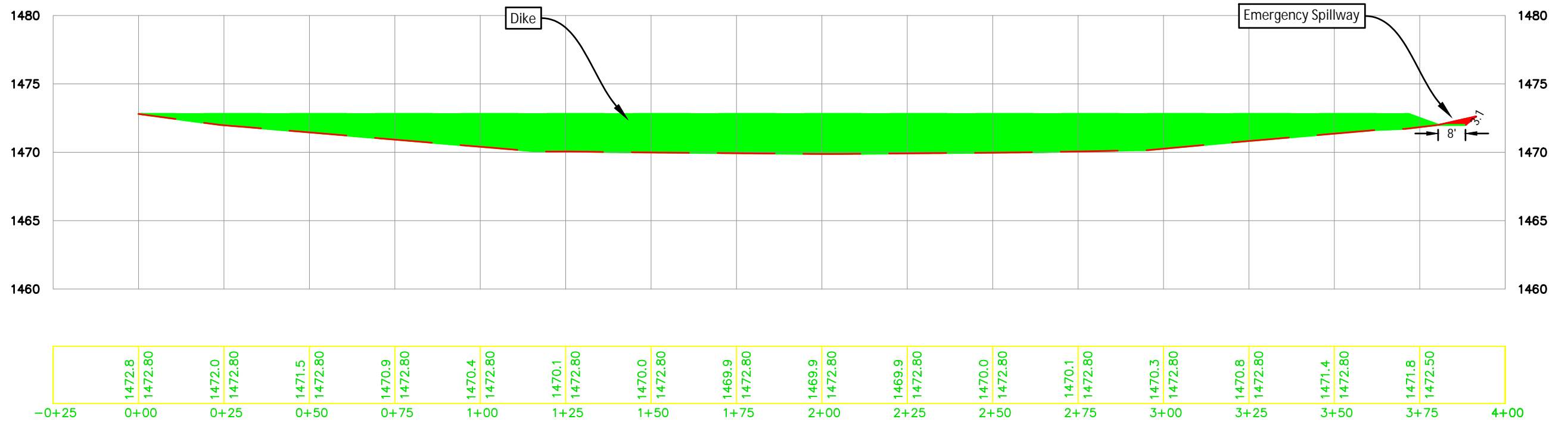
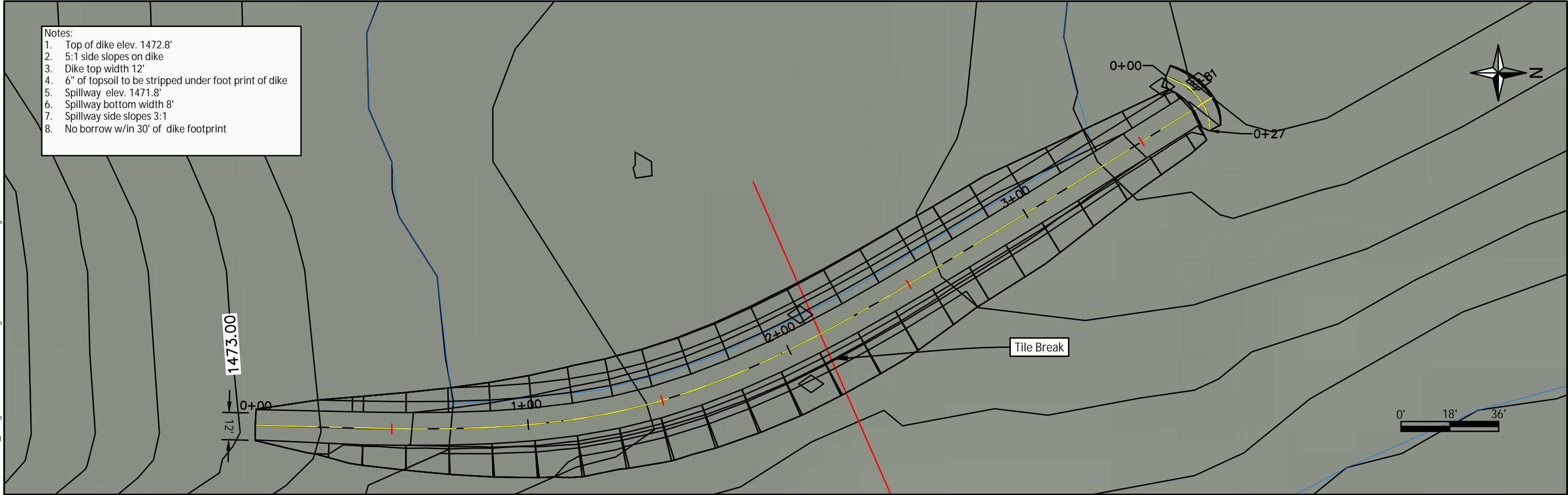

Plot Date: 5/27/2026 2:11 PM G:\Shared drives\DNR LWB ENG Projects\30_Dickinson\26-01-30-01 Hodge WPA Wetland Restoration\5_Design\C3D\26-01-30-01 Hodge WPA Wetland Resto.dwg



Drawn by: xx	
Revision	Date
90%	2/3/26
Final	5/27/26

- Notes:
1. Top of dike elev. 1485.0'
 2. 5:1 side slopes on dike
 3. Dike top width 12'
 4. 6" of topsoil to be stripped under foot print of dike
 5. Spillway elev. 1484.0'
 6. Spillway bottom width 8'
 7. Spillway side slopes 3:1
 8. No borrow w/in 30' of dike footprint

G:\Shared drives\DNR LWB ENG Projects\30_Dickinson\26-01-30-01 Hodge WPA Wetland Restoration\5_Design\C3D\26-01-30-01 Hodge WPA Wetland Resto.dwg

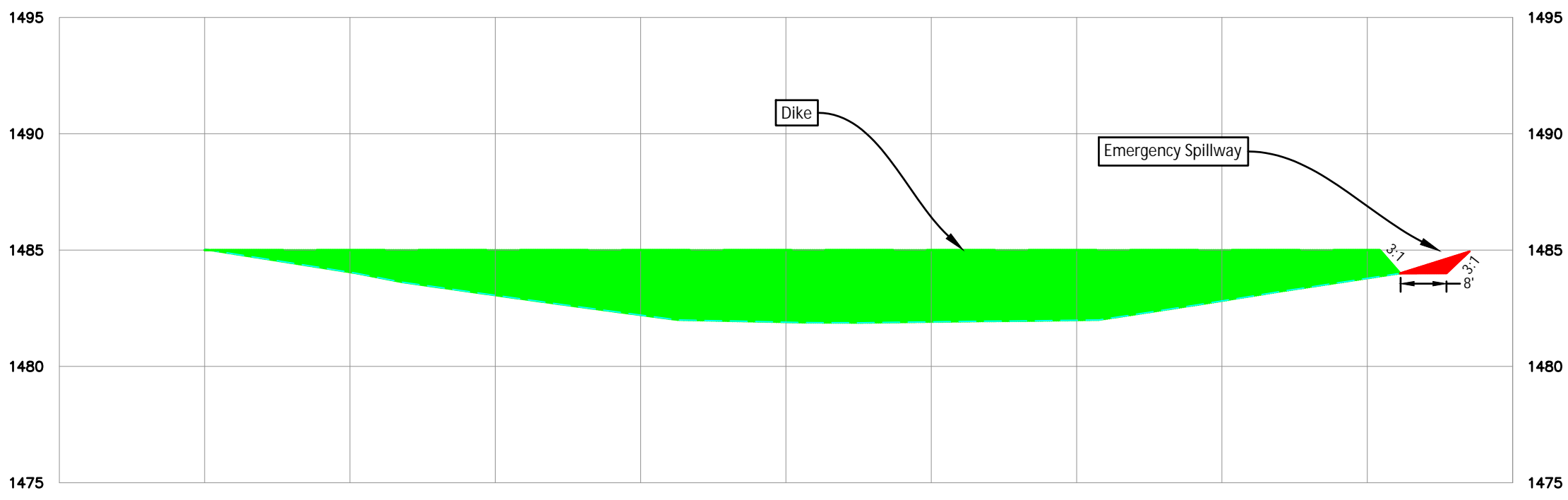
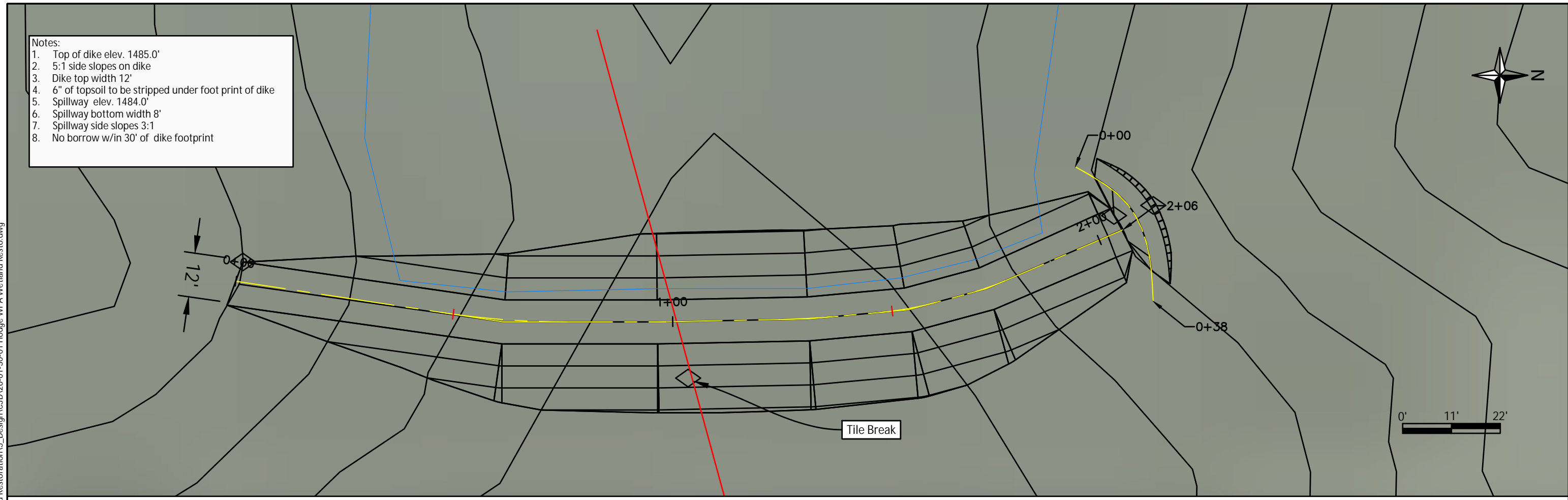

1485.0	1485.00	1484.0	1485.00	1483.1	1485.00	1482.2	1485.00	1481.9	1485.00	1481.9	1485.00	1482.0	1485.00	1482.8	1485.00	1483.8	1485.00
--------	---------	--------	---------	--------	---------	--------	---------	--------	---------	--------	---------	--------	---------	--------	---------	--------	---------

G:\Shared drives\DNR LWB ENG Projects\30_Dickinson\26-01-30-01 Hodge WPA Wetland Restoration\5_Design\C3D\26-01-30-01 Hodge WPA Wetland Resto.dwg Plot Date: 5/27/2026 2:11 PM

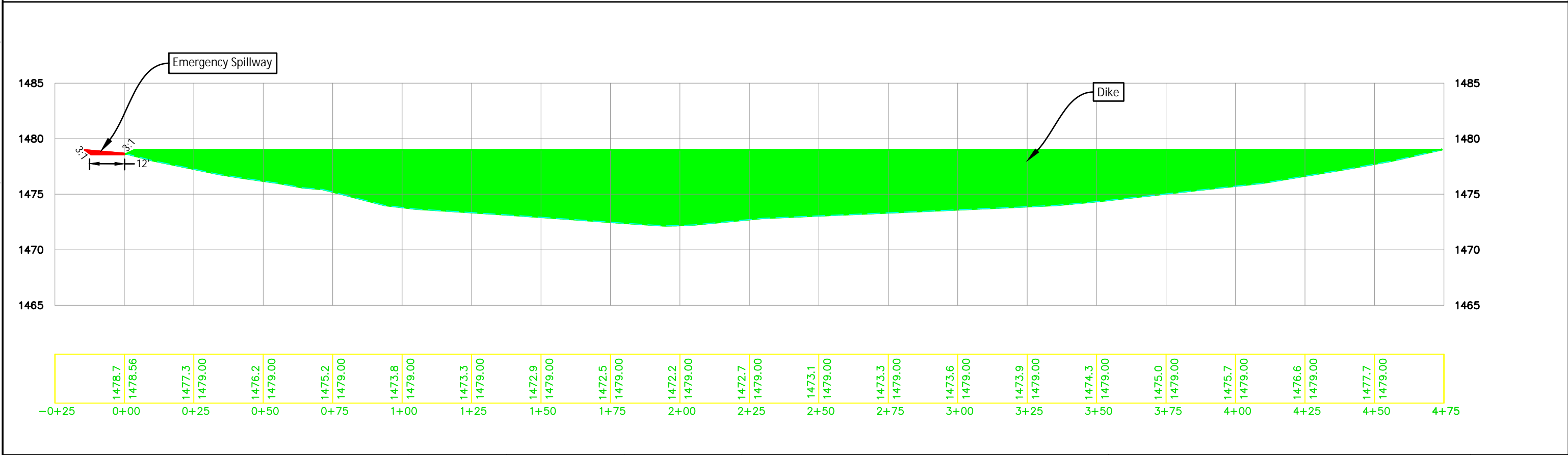
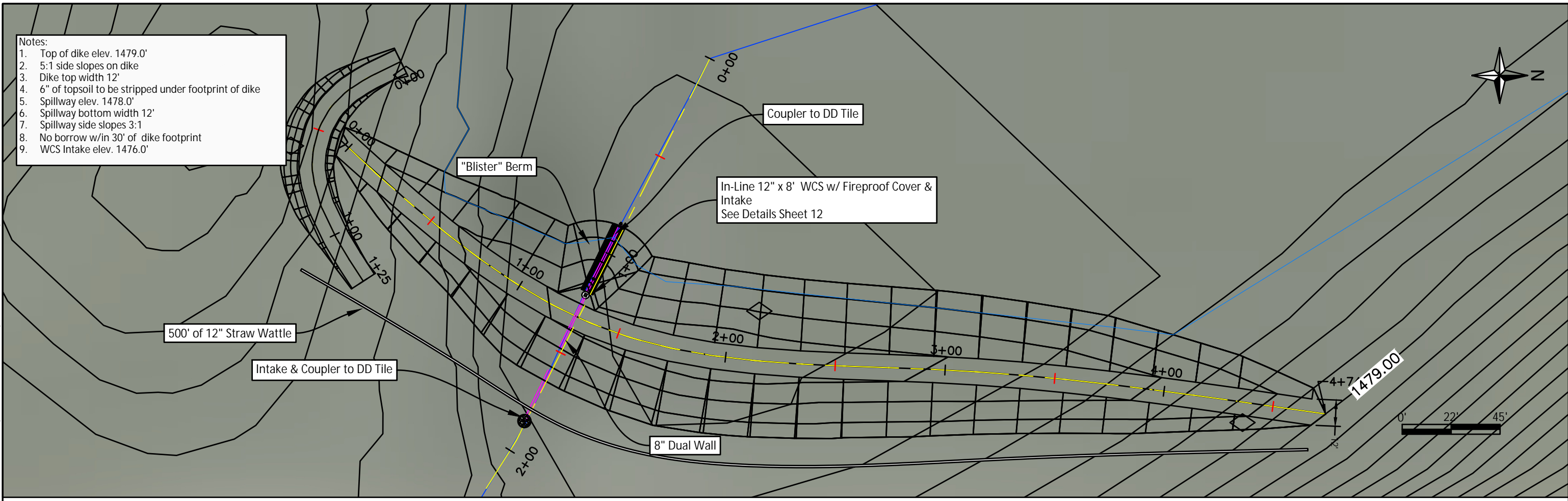

G:\Shared drives\DNR LWB ENG Projects\30_Dickinson\26-01-30-01 Hodge WPA Wetland Restoration\5_Design\C3\26-01-30-01 Hodge WPA Wetland Resto.dwg Plot Date: 5/27/2026 2:11 PM

- Notes:
1. Tile search shall be performed along entire length of dike
 2. Tile search depth to a minimum of 5'
 3. Tile search shall be conducted with an excavator.
 4. Tile search will be located along wetland side of dike at location approved by DNR Field Engineer

Typ. Dike Section

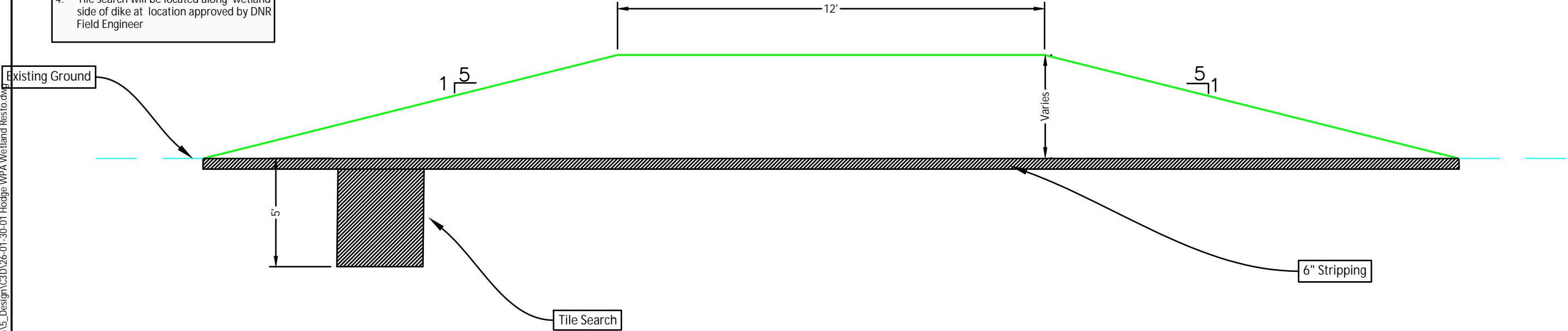

Typ. Spillway Section

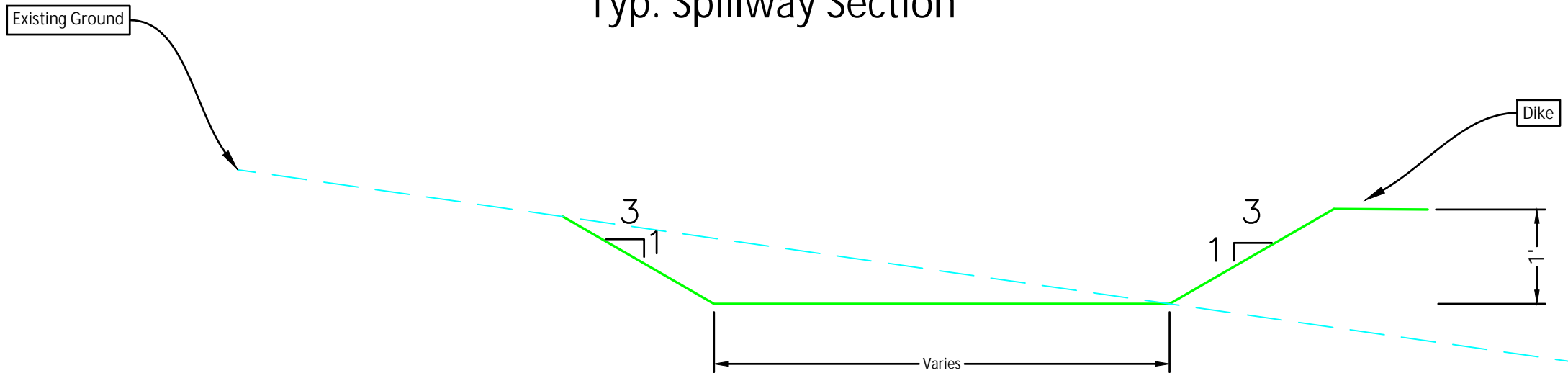

Drawn by: xx	
Revision	Date
90%	2/3/26
Final	5/27/26

Plot Date: 5/27/2026 2:12 PM G:\Shared drives\DNR LWB ENG Projects\30_Dickinson\26-01-30-01 Hodge WPA Wetland Restoration\5_Design\C3D\26-01-30-01 Hodge WPA Wetland Resto.dwg

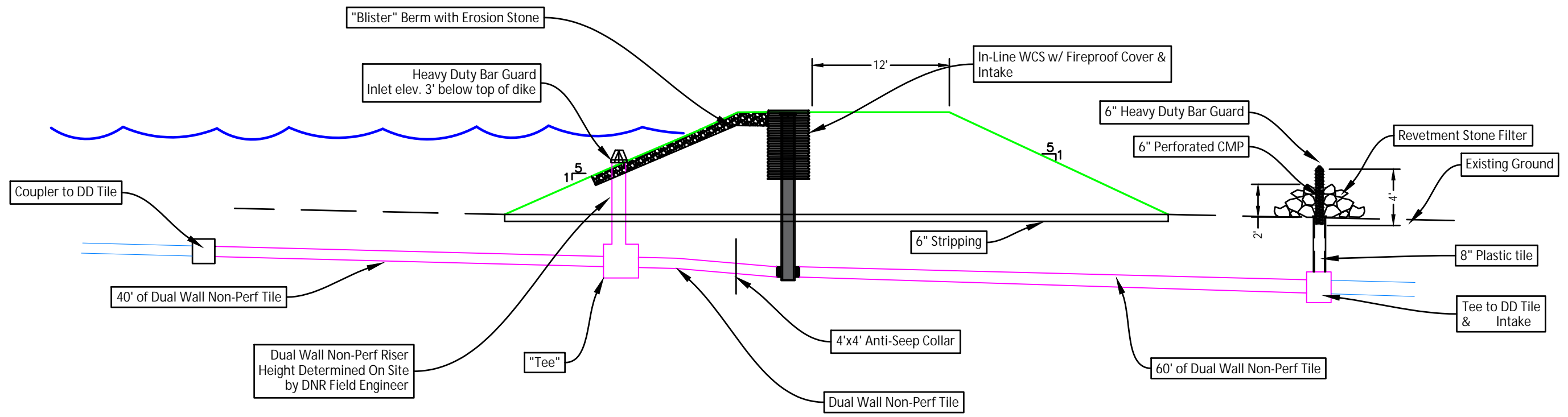

WCS Plan View

Intake Connection Detail

WCS Plan View

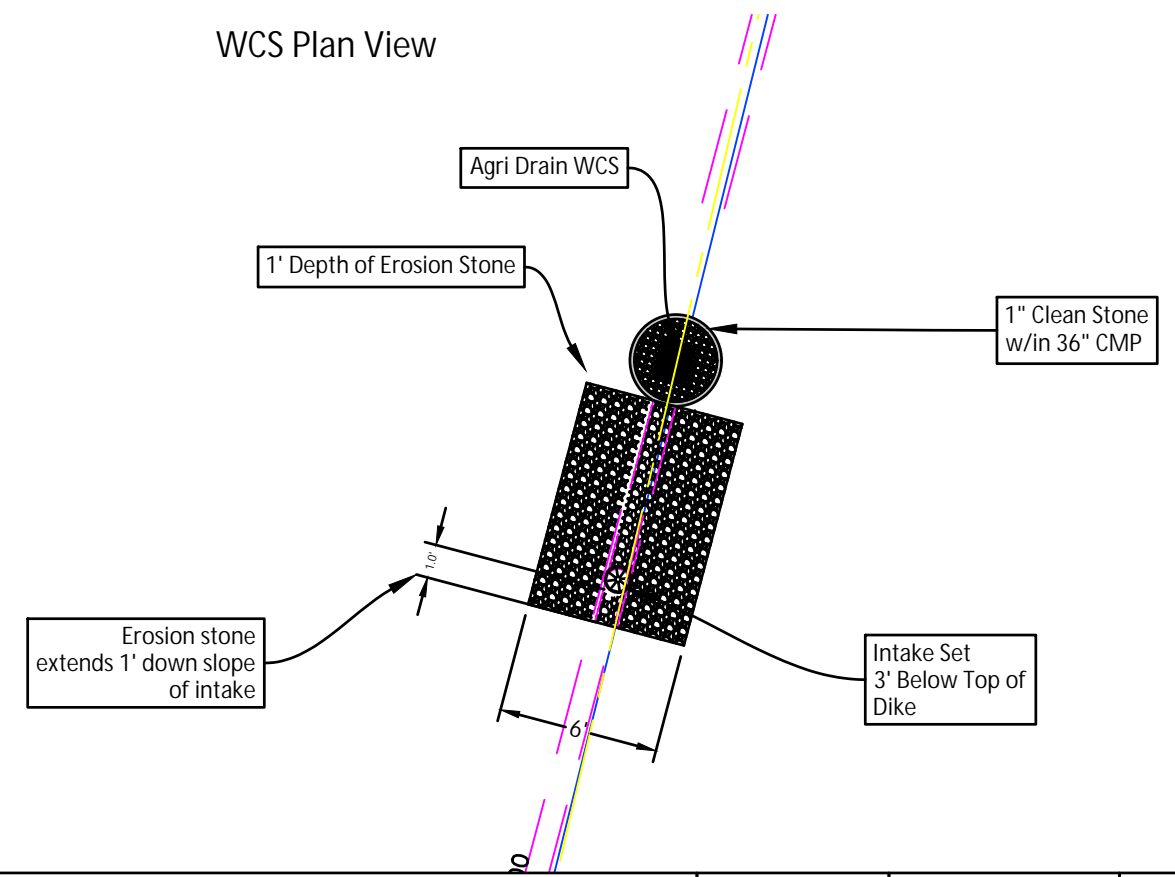

8" Heavy Duty Bar Guard

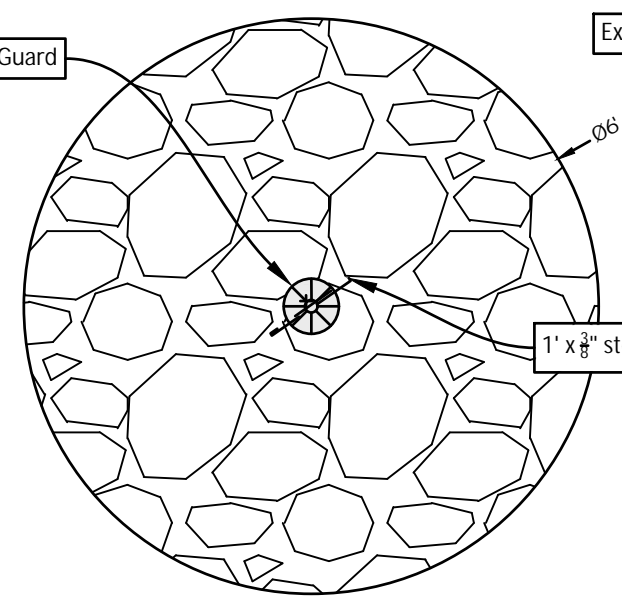

Intake Plan View

