





**EXISTING CONDITIONS**

**NOTES**

- UTILITIES SHOWN ARE BASED ON TOPOGRAPHICAL SURVEY COMPLETED JULY 2025 BY SHIVE-HATTERY. SURVEY UTILITY INFORMATION IS PROVIDED BY THE OPERATING AUTHORITY OF EACH UTILITY. SURFACE FEATURES, AND AVAILABLE RECORD DRAWINGS. NO SUBSURFACE INVESTIGATION HAS BEEN MADE TO DETERMINE ACCURACY OF THE INFORMATION. IT IS THE CONTRACTOR'S RESPONSIBILITY TO DETERMINE THE EXACT LOCATION OF UNDERGROUND UTILITIES. CALL IOWA ONE-CALL (1-800-292-8989) FOR UTILITY LOCATES PRIOR TO CONSTRUCTION. UTILITY LOCATES SHALL BE KEPT CURRENT PER STATE REQUIREMENTS.
- ALL NEW CONSTRUCTION THAT IS WITHIN CLOSE PROXIMITY TO EXISTING OR NEW UTILITIES SHALL BE PLANNED AND EXECUTED CAREFULLY SO THAT UTILITIES ARE NOT DAMAGED. CONTRACTOR SHALL PHYSICALLY VERIFY THE LOCATION OF ALL UTILITIES PRIOR TO COMMENCING WORK. CONTRACTOR WILL BE RESPONSIBLE FOR THE REPAIR OF ANY DAMAGES TO EXISTING OR NEW UTILITIES.

**STAKING/LAYOUT NOTES**

- ALL STAKING CONTROL POINTS SHALL BE PROTECTED THROUGHOUT THE PROJECT.
- STAKING AND LAYOUT FOR THIS PROJECT IS THE RESPONSIBILITY OF THE CONTRACTOR.
- NO STAKING COORDINATES WILL BE PROVIDED FOR THE WORK SHOWN ON THE C-SERIES SHEETS. ELECTRONIC AUTOCAD FILES WILL BE PROVIDED AND IT IS THE CONTRACTOR'S RESPONSIBILITY TO PROVIDE STAKING AND LAYOUT BASED ON ELECTRONIC DRAWING DATA.
- UNLESS OTHERWISE APPROVED, IT IS EXPECTED THAT UTILITY ELEVATIONS ARE CAREFULLY OBTAINED FROM THE PLANS, AND THAT UTILITIES WILL BE INSTALLED AS CLOSE TO PRECISE PROFILE ELEVATIONS AS CONSTRUCTION METHODS WILL REASONABLY ALLOW.

**BENCHMARKS**

CONSTANT VERTICAL ADJUSTMENT OF 773.936

**ABBREVIATIONS**

ACC ASPHALT	PCC PORTLAND CEMENT CONCRETE
15KV 15 KILOVOLT ELECTRIC	PL PROPERTY LINE
ABAN ABANDONED	PVC POLYVINYL CHLORIDE PIPE
COND CONDENSATE	RCP REINFORCED CONCRETE PIPE
CWR CHILLED WATER RETURN	RE'D/REQ'D REQUIRED
CWS CHILLED WATER SUPPLY	RGS RIGID STEEL
DIA DIAMETER	RJ RESTRAINED JOINT
DIP DUCTILE IRON PIPE	DIP DUCTILE IRON PIPE
DW DOMESTIC WATER	ROW RIGHT-OF-WAY
FO FIBER OPTIC	SAN SANITARY SEWER
FW FIRE WATER	SMH SANITARY MANHOLE
HPS HIGH PRESSURE STEAM	STM STEAM
IE INVERT ELEVATION	STRM STORM SEWER
LF LINEAR FEET	TELU TELECOMMUNICATIONS
LPS LOW PRESSURE STEAM	TEMP TEMPORARY
MH MANHOLE	UE UNDERGROUND ELECTRIC
MJ MECHANICAL JOINT	WAT/W WATER MAIN
OE OVERHEAD ELECTRIC	

**LEGEND**

UTILITY LINES	
LINE TYPE	DESCRIPTION
—OE—	OVERHEAD ELEC.
---	UNDERGROUND ELEC.
—G—	GAS MAIN
—W—	WATER MAIN
—S—	SANITARY SEWER
—ST—	STORM SEWER
—T—	UNDERGROUND TELE.
—FO—	UNDERGROUND FIBER OPTICS
—S—	STEAM
—DB—	DUCTBANK
—SL—	SITE LIGHTING

**LEGEND**

GENERAL SITE	
PLAN MARK	DESCRIPTION
[Hatched Box]	EXISTING STRUCTURE
●	GUARD POST/ BOLLARD
○	UTILITY POLE
⊕	FIRE HYDRANT
⊙	LIGHT POST
[ ]	UTILITY END CAP
✱	SHRUB
○	DECIDUOUS TREE
⊙	CONIFEROUS TREE
⊥	SINGLE POLE SIGN
⊗	VALVE
⊙	CLEANOUT
—	CHAIN LINK FENCE
---	MINOR CONTOUR
---	MAJOR CONTOUR
⊙	DRAINAGE MANHOLE
⊙	ELECTRICAL MANHOLE
⊙	SANITARY MANHOLE
⊙	TELEPHONE MANHOLE
⊙	TELEPHONE PEDESTAL
⊙	ELECTRIC OUTLET JUNCTION BOX
⊙	INTAKE - CIRCLE
⊙	INTAKE - RECTANGLE
⊙ <sub>RD</sub>	BUILDING ROOF DRAIN
⊙	HANDHOLE
⊙	SURVEY CONTROL POINT
⊙	BUSH LIMITS

**CONTROL POINT TABLE**

POINT #	NORTHING	EASTING	ELEVATION	DESCRIPTION
1	579015.809	1611060.642	37.413	CP1 CUT X
2	578971.169	1610904.878	33.847	CP2 CUT X
3	579298.596	1610798.546	37.748	CP3 CUT X
4	579423.777	1610977.266	50.677	CP4 MAG

TPS	ETW	BID	10/16/2025	2250010450	I
DRAWN BY	APPROVED BY	ISSUED FOR	ISSUE DATE	PROJECT NUMBER	FIELD BOOK

C:\Users\Bhatter\OneDrive\Documents\Shive-Hattery\161225010450\BID\161225010450\BID\161225010450\1\_C001\_PlanC001.dwg  
Printed: 10/16/2025 4:12:13 PM











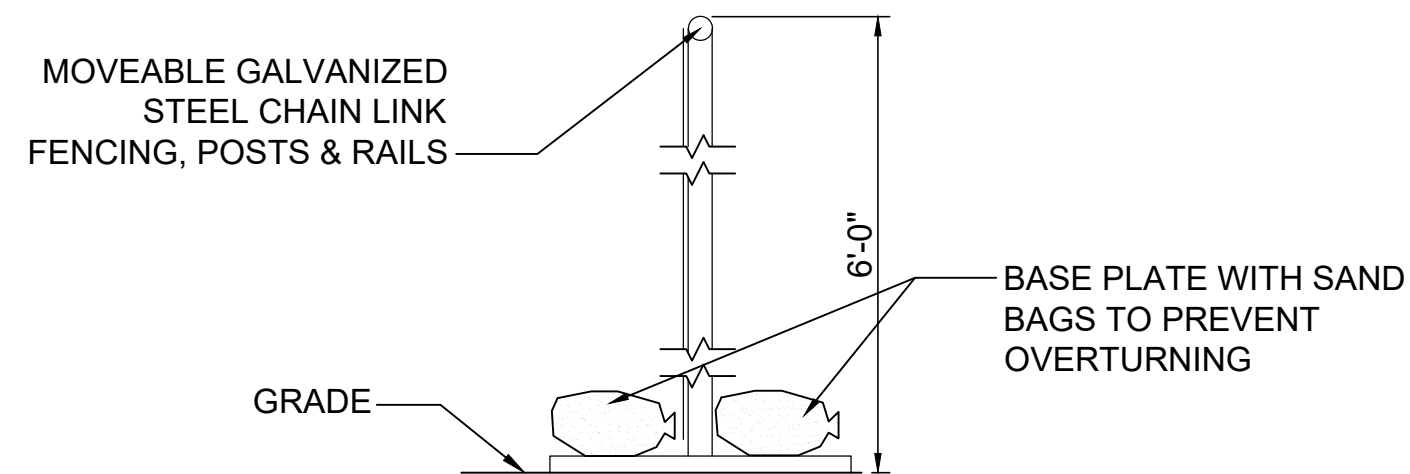

- NOTES:
1. MOVEABLE CHAINLINK FENCE SHALL BE INSTALLED AROUND CONSTRUCTION SITE PERIMETER.
  2. MOVEABLE PANELS SHALL BE SECURELY FASTENED DOWN TO PREVENT MOVEMENT, OVERTURNING, OR WIND PROBLEMS.
  3. ALL CHAINLINK PERIMETER FENCE SHALL HAVE GREEN OR BLACK PRIVACY FABRIC OR PVC PRIVACY SLAT, COLOR GREEN OR BLACK. FABRIC OR SLATS SHALL BE FULL HEIGHT OF FENCE.

**1** TEMPORARY CHAIN LINK CONSTRUCTION FENCE  
NOT TO SCALE

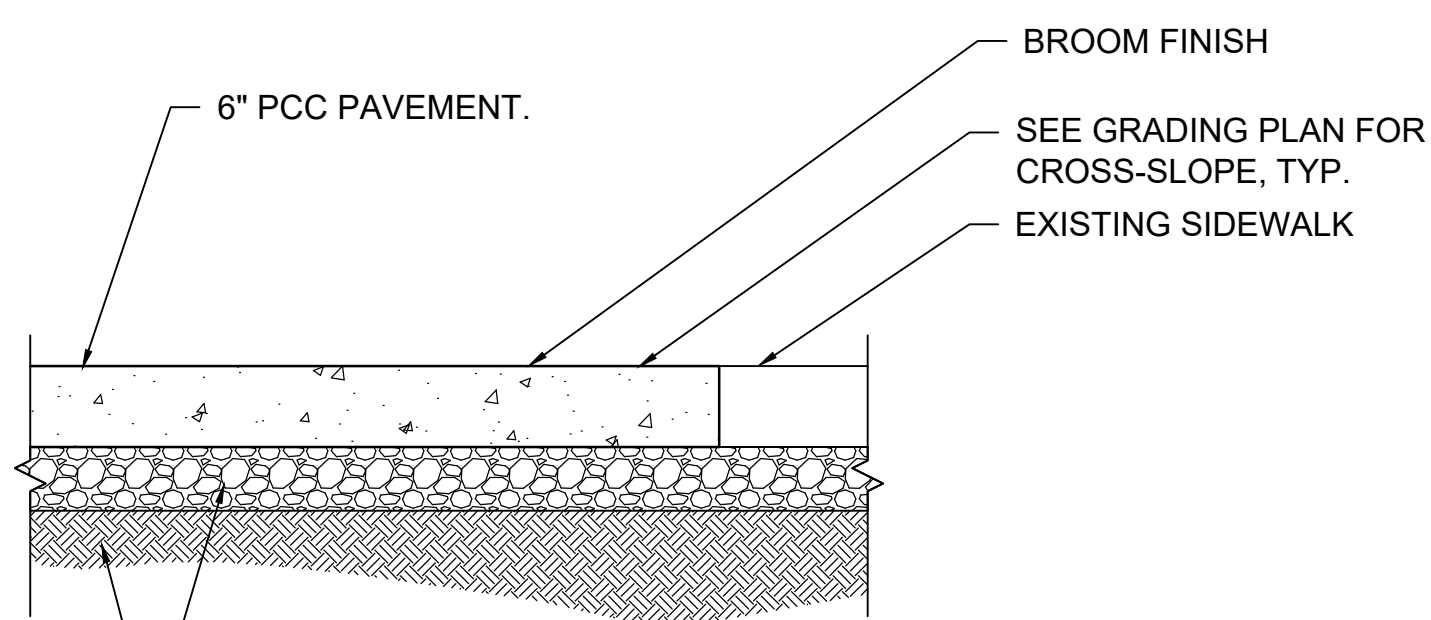

PROVIDE 4" OF IDOT GRADATION 14 SUBBASE. SEE SPECIFICATION FOR COMPACTION REQUIREMENTS.

SUBGRADE TO BE SCARIFIED TO A DEPTH OF 12" AND RECOMPACTED TO 98% STANDARD PROCTOR DENSITY

- NOTES:
1. SPACE 1/2" EXPANSION JOINTS AT MAX 100' INTERVALS.
  2. PROVIDE MEDIUM BROOM FINISH PERPENDICULAR TO THE DIRECTION OF TRAVEL.

**2** PCC SIDEWALK  
NOT TO SCALE

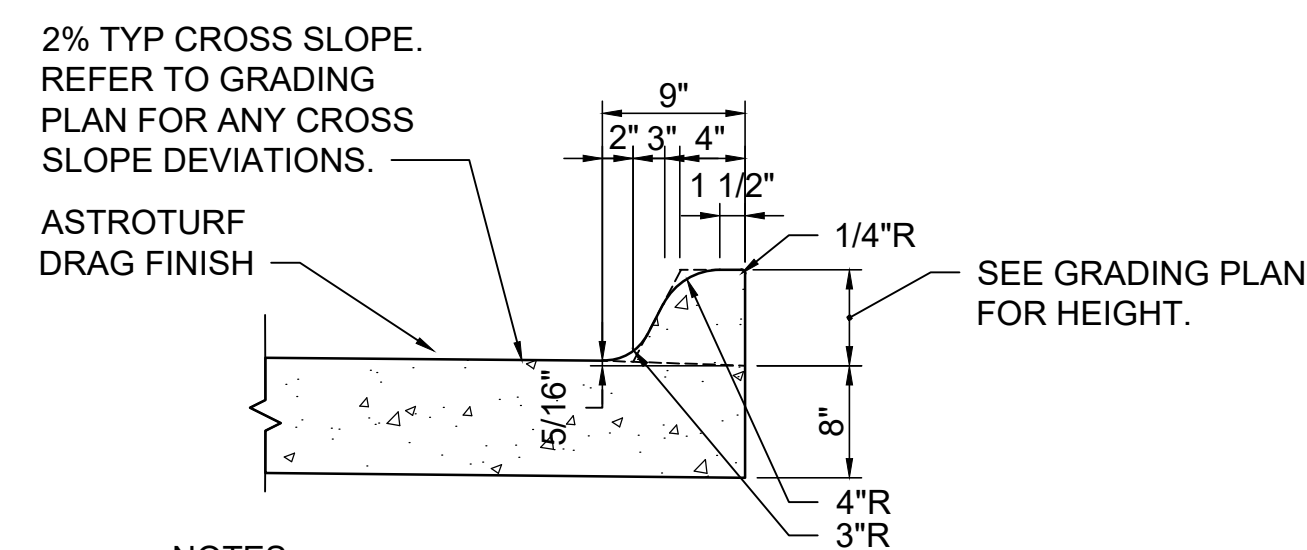

- NOTES:
1. ALL CURBS SHALL BE INTEGRAL TO ADJOINING PCC PAVEMENT

**3** STANDARD BARRIER CURB  
NOT TO SCALE

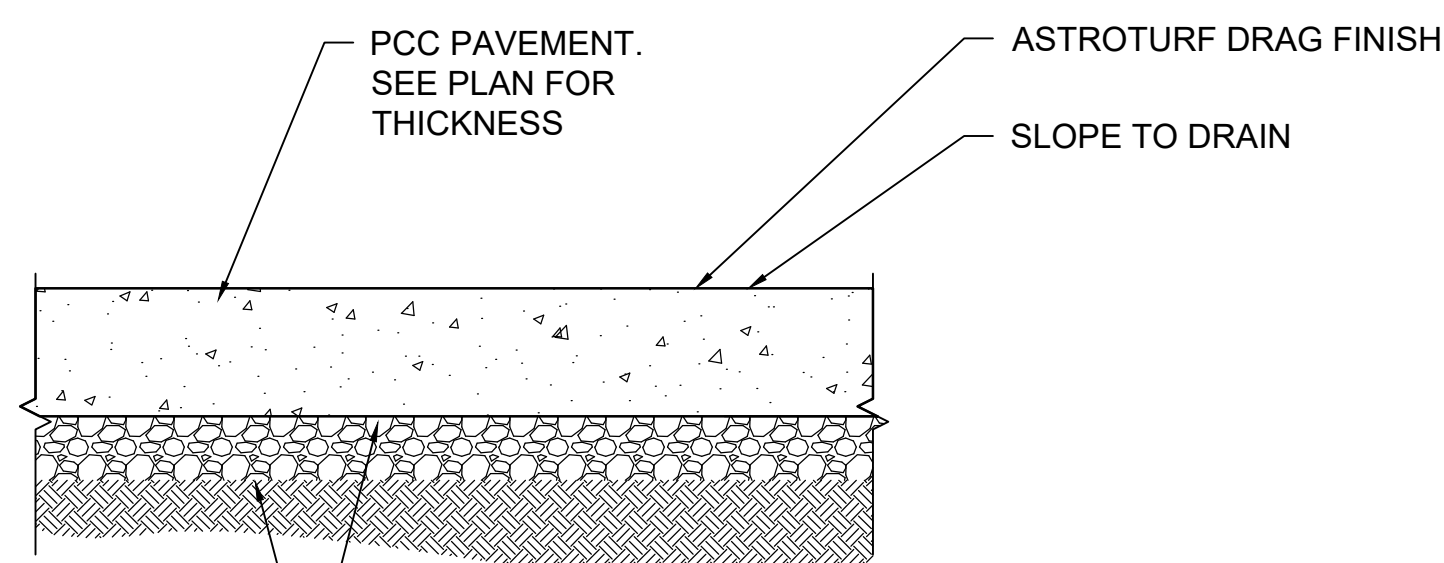

PROVIDE 6" OF IDOT GRADATION 14 SUBBASE. SEE SPECIFICATION FOR COMPACTION REQUIREMENTS

SUBGRADE TO BE SCARIFIED TO A DEPTH OF 12" AND RECOMPACTED TO 98% STANDARD PROCTOR DENSITY

- NOTES:
1. ALL NEW PAVEMENT SHALL BE DOWELED INTO EXISTING.
  2. ALL PAVEMENT SHALL BE JOINTED TO MEET IDOT STANDARD ROAD PLAN PV-101 AND ACCORDING TO SUDAS SECTION 5G
  3. REFER TO ADDITIONAL DETAIL FOR INTEGRAL STANDARD BARRIER CURB.

**4** PCC PAVEMENT  
NOT TO SCALE

--	--	--	--	--	--	--	--	--	--

DRAWN BY	TPS
APPROVED BY	ETW
ISSUED FOR	BID
ISSUE DATE	10/16/2025
PROJECT NUMBER	2250010450
FIELD BOOK	1











C:\Users\Bhaskar\OneDrive\Documents\Projects\Iowa\Bldg Demol\Project\Fleet\ShiveHattery\1\_Cat2\_Floor0101.dwg  
Printed: 10/16/2025 4:15:59 PM

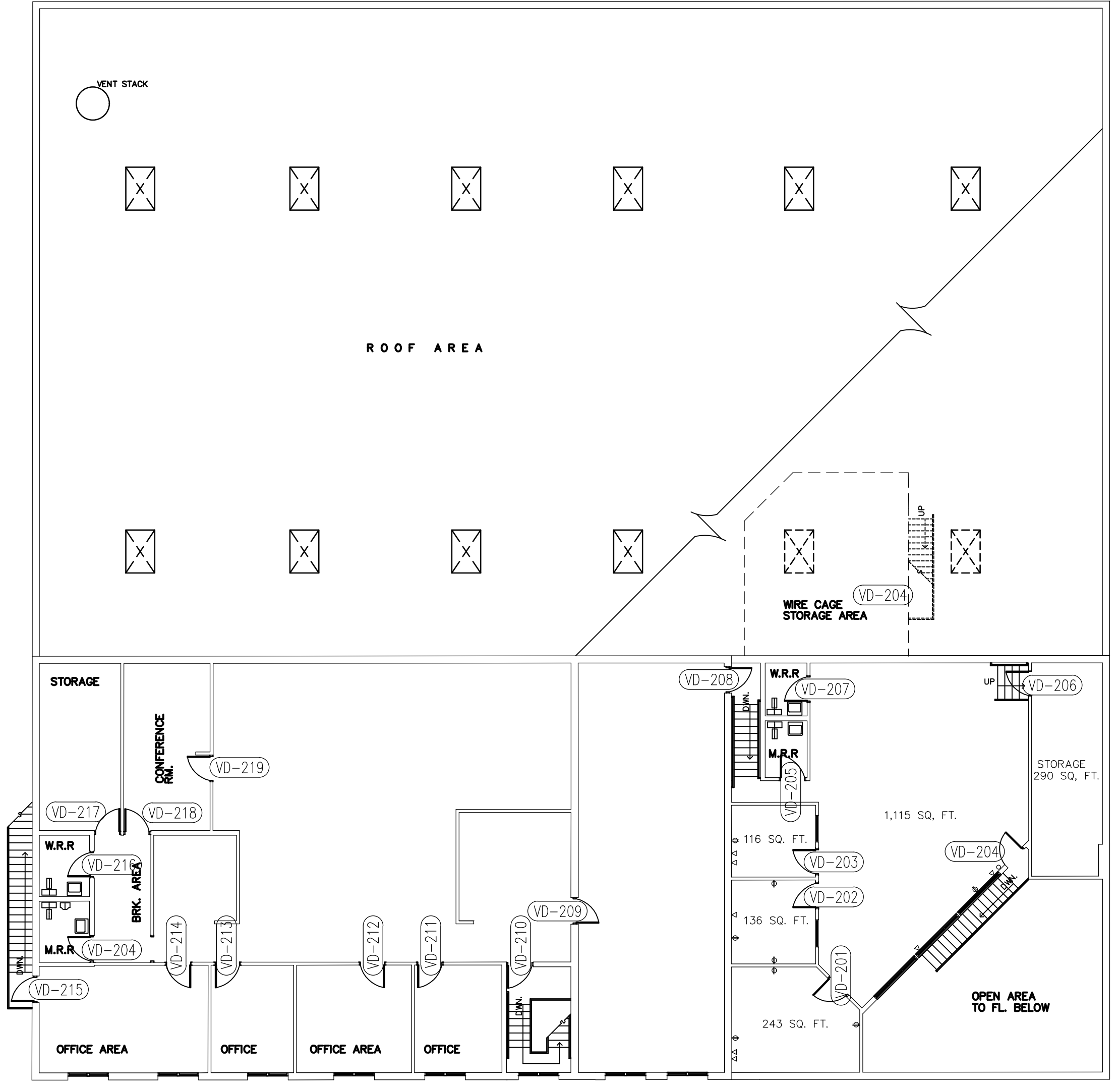

**VEHICLE DISPATCH BUILDING – SECOND FLOOR**  
DOOR NUMBER PLAN

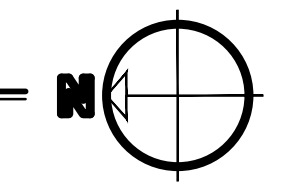

DRAWN BY	TPS
APPROVED BY	ETW
ISSUED FOR	BID
ISSUE DATE	10/16/2025
PROJECT NUMBER	2250010450
FIELD BOOK	1

**FLEET FLOOR  
PLAN - SECOND  
FLOOR**

**R102**