

WCS PROFILE

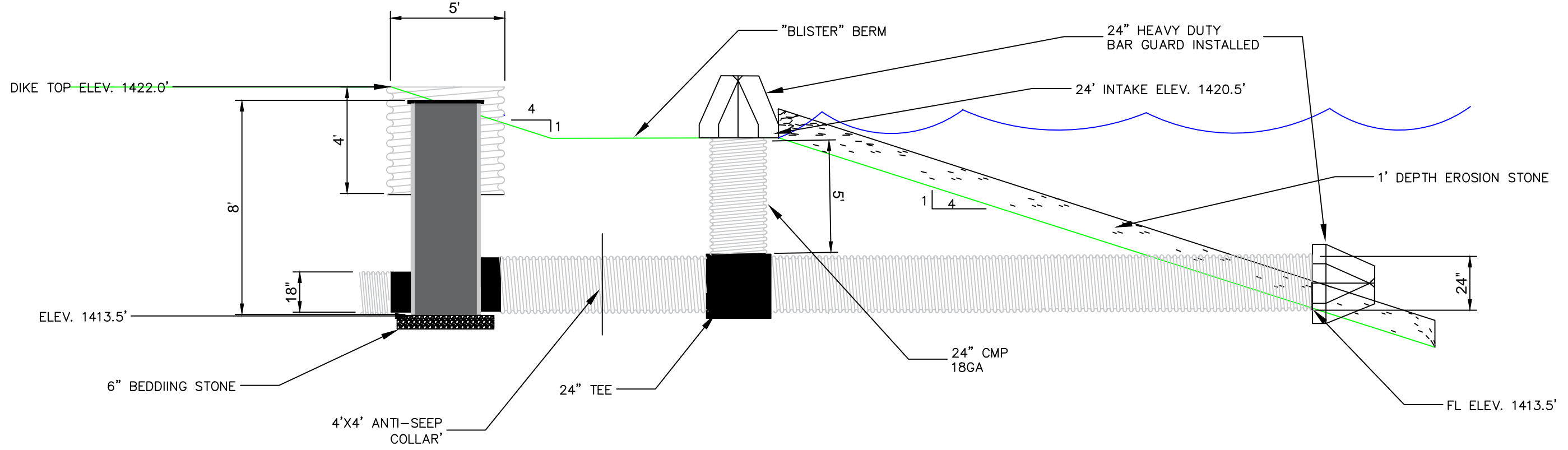
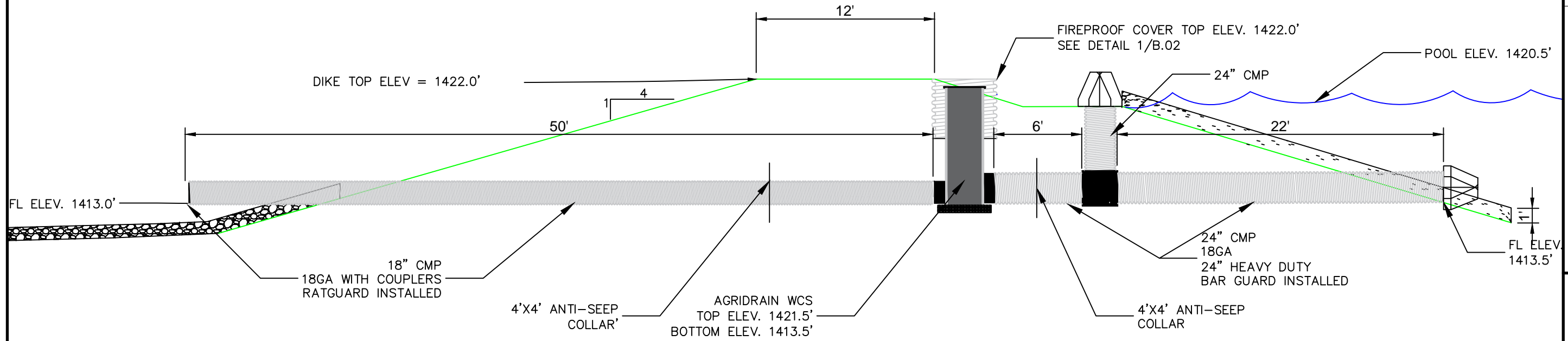

24" SECONDARY INTAKE

CONSULTANT:
NONE

IOWA DEPARTMENT OF
NATURAL RESOURCES

ENGINEERING SERVICES -
6200 PARK AVE, DES MOINES, IA 50321



EROSION CONTROL PLAN

PROJECT DESCRIPTION FOR:

NEPPLE WMA WETLAND RT

DICKINSON COUNTY

NO.	BY DATE	REVISION
1	2/9/23	90%

DRAWN BY: TWH
PROJECT NUMBER: 23-01-30-04
CHK'D BY: " " DATE: "

SHEET No: B.01

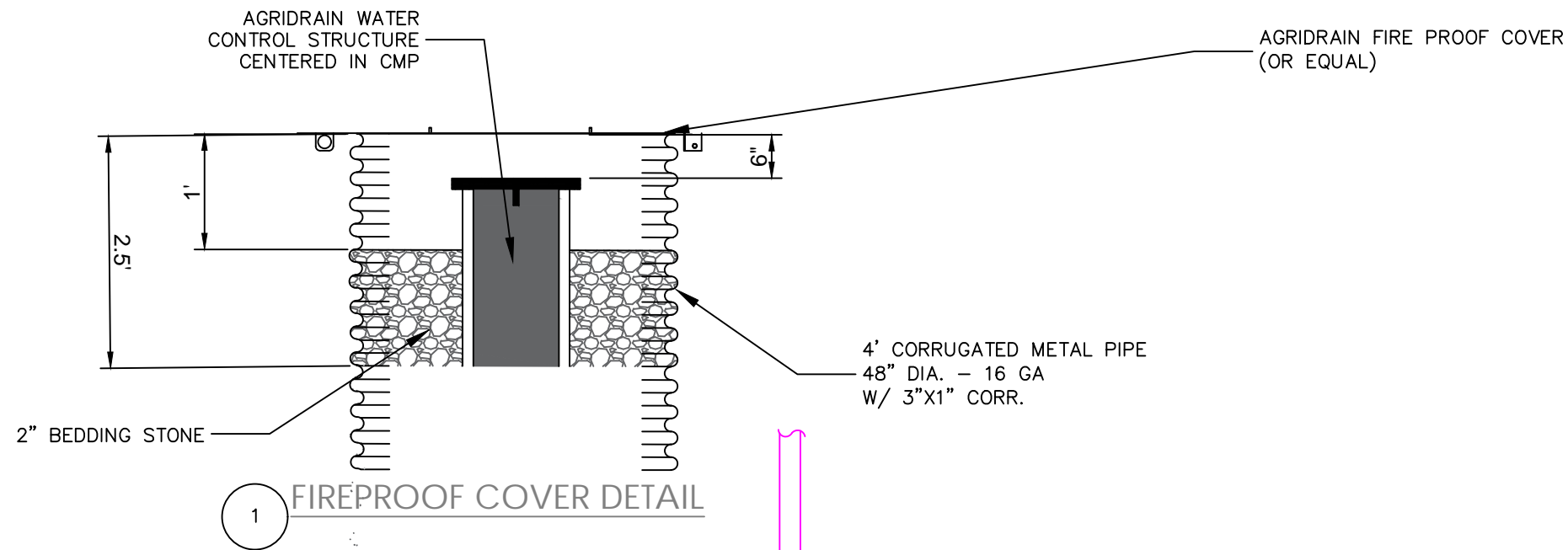

1 FIREPROOF COVER DETAIL

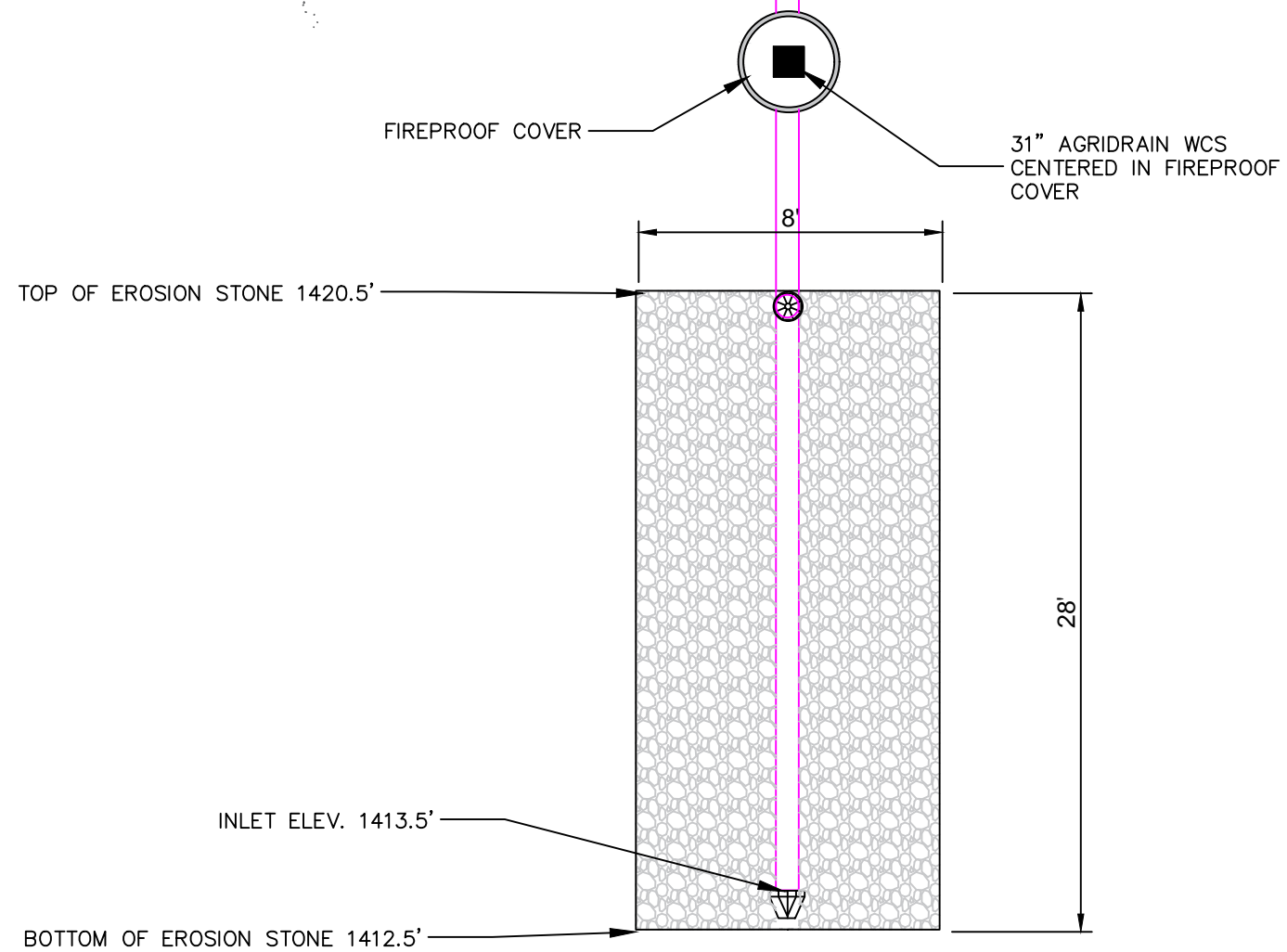

2 INLET WITH EROSION STONE

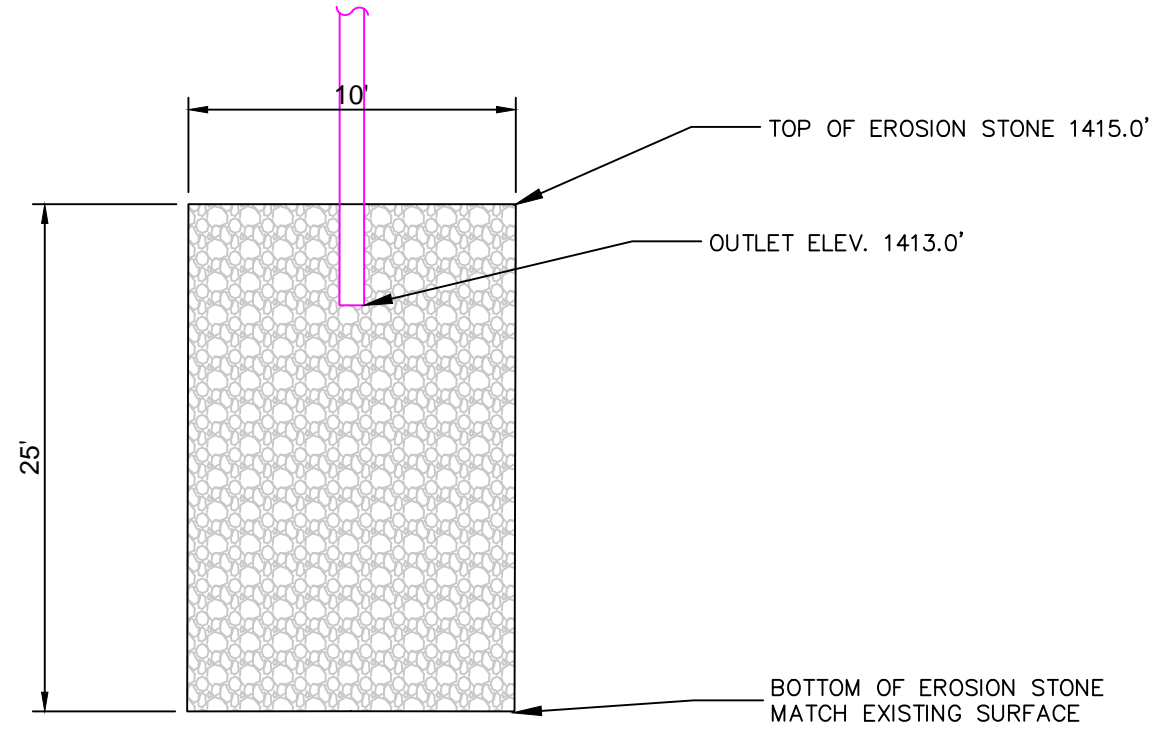

3 OUTLET WITH EROSION STONE

CONSULTANT:
NONE

IOWA DEPARTMENT OF
NATURAL RESOURCES

ENGINEERING SERVICES -
6200 PARK AVE, DES MOINES, IA 50321



WATER CONTROL STRUCTURE DETAIL

PROJECT DESCRIPTION FOR:
NEPPEL WMA WETLAND RT

DICKINSON COUNTY

NO.	BY	DATE	REVISION
1		2/8/23	90%

DRAWN BY:	PROJECT NUMBER:
CHK'D BY:	DATE:
SHEET No:	BID DATE:

B.02

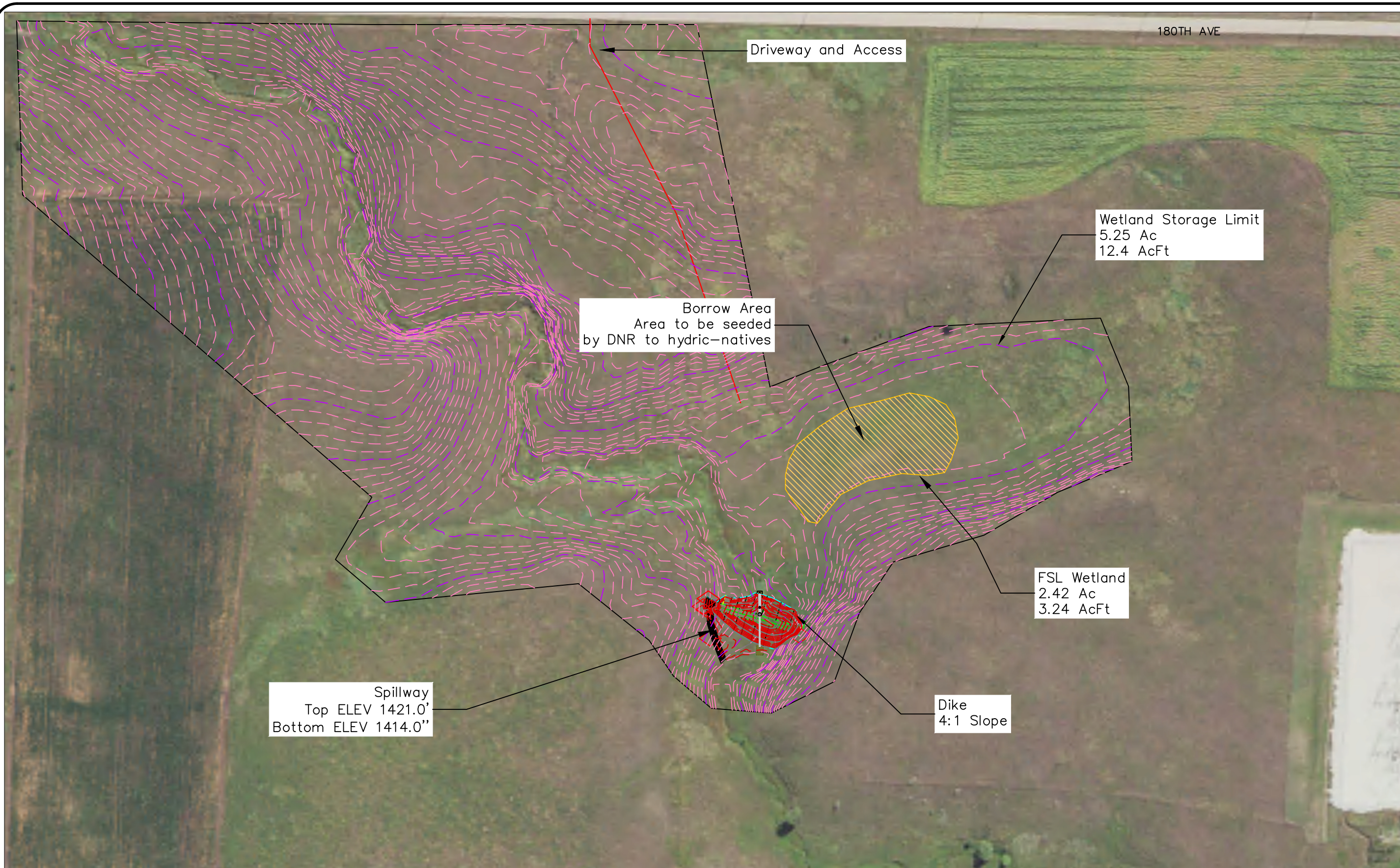

CONSULTANT:
NONE

IOWA DEPARTMENT OF
NATURAL RESOURCES
ENGINEERING SERVICES -
6200 PARK AVE, DES MOINES, IA 50321



OVERALL PROJECT MAP
PROJECT DESCRIPTION FOR:
NEPPEL WMA WETLAND RT
DICKINSON COUNTY

NO.	BY DATE	REVISION
1	2/23/24	90%

DRAWN BY	PROJECT NUMBER:
TJH	23-01-30-04
CHK'D BY:	DATE:
"	FEBRUARY 22, 2024

SHEET No:
D.01



OVERALL PROJECT MAP



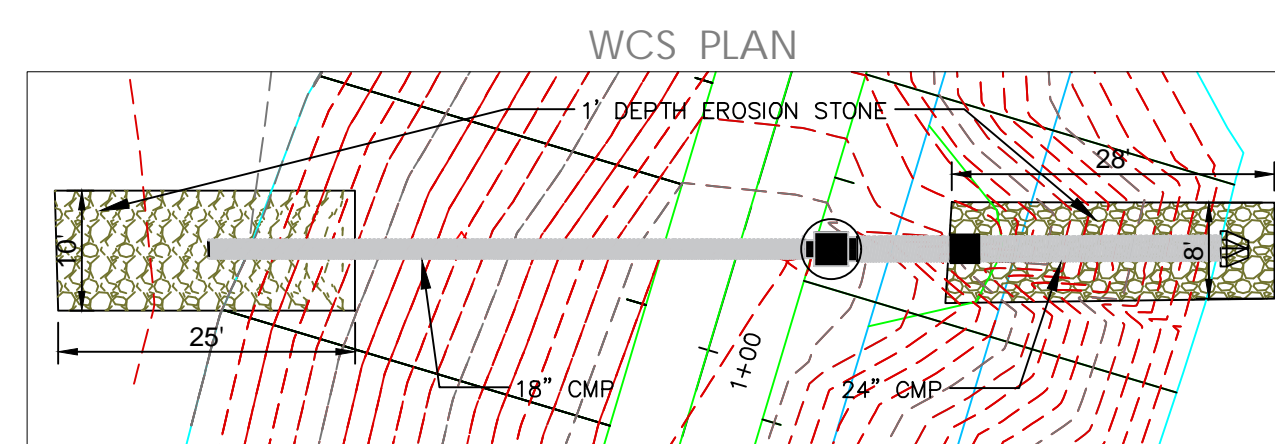
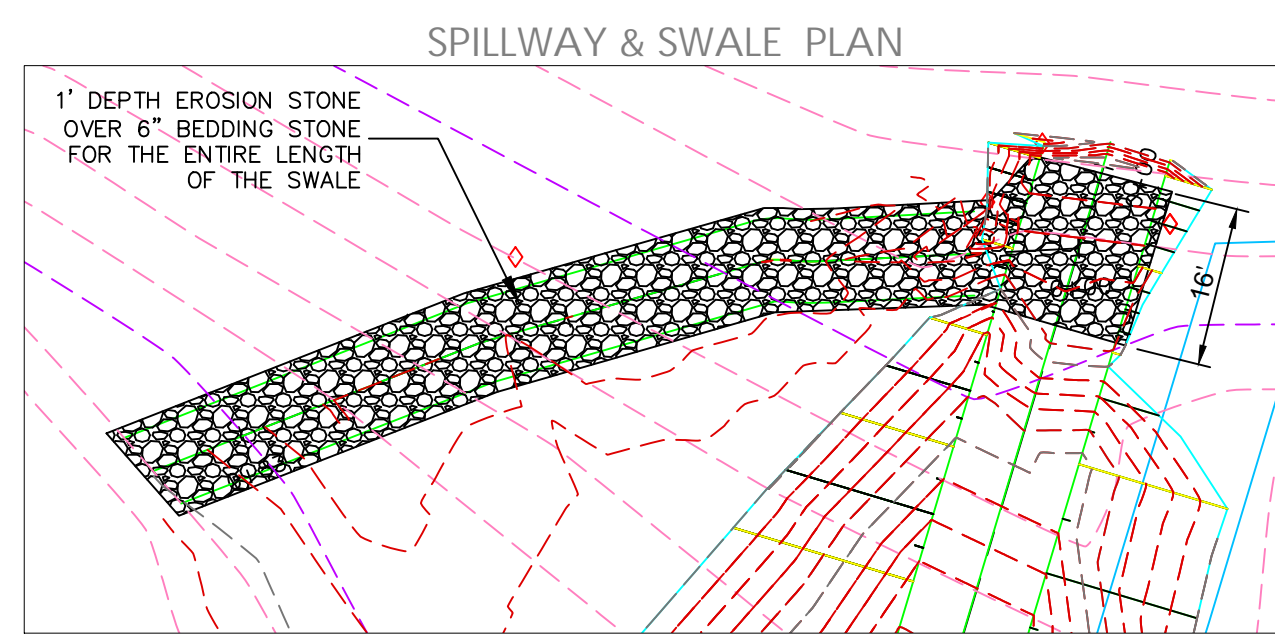
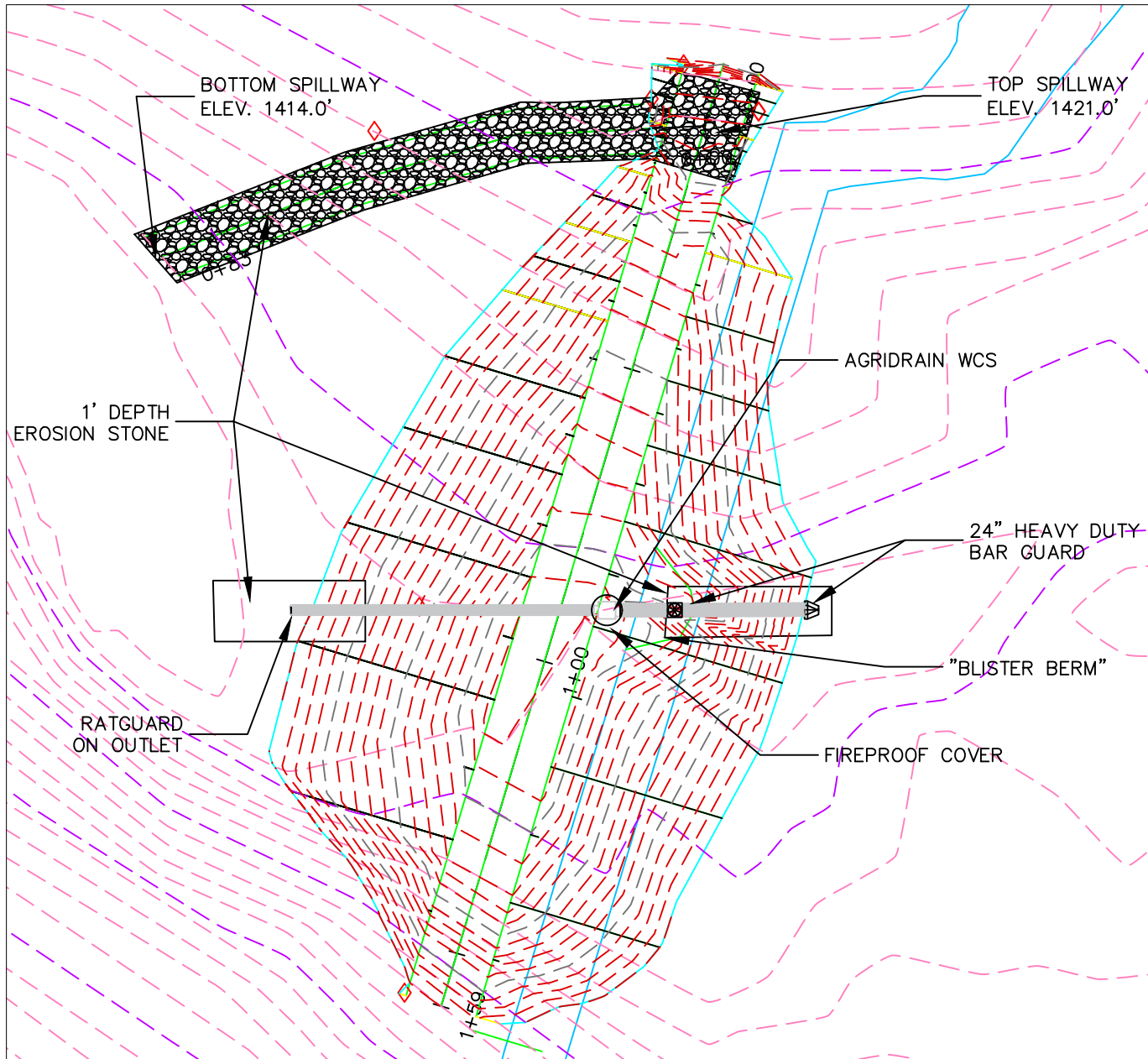
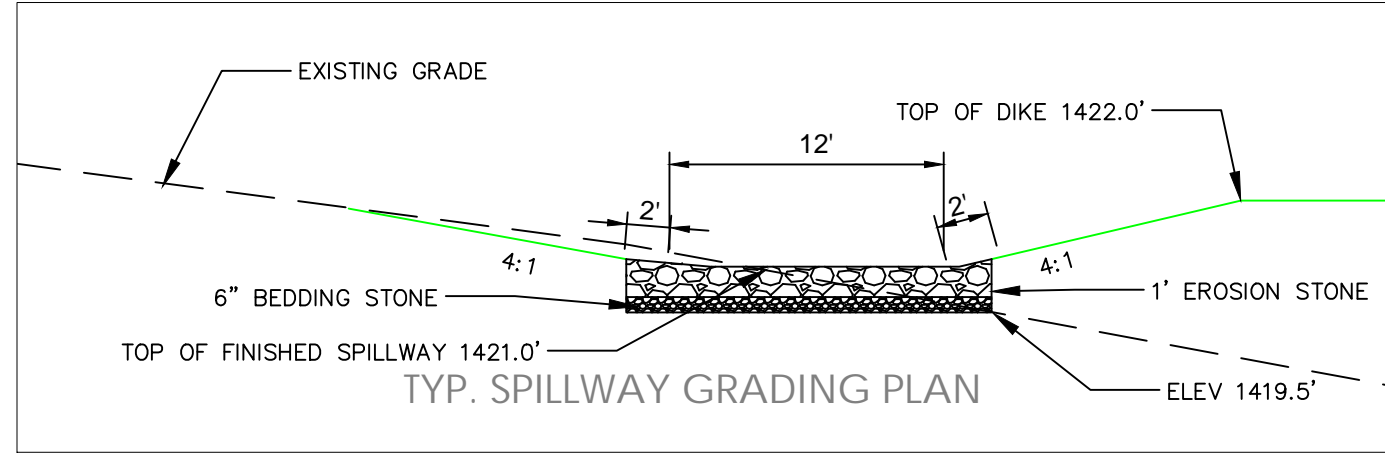
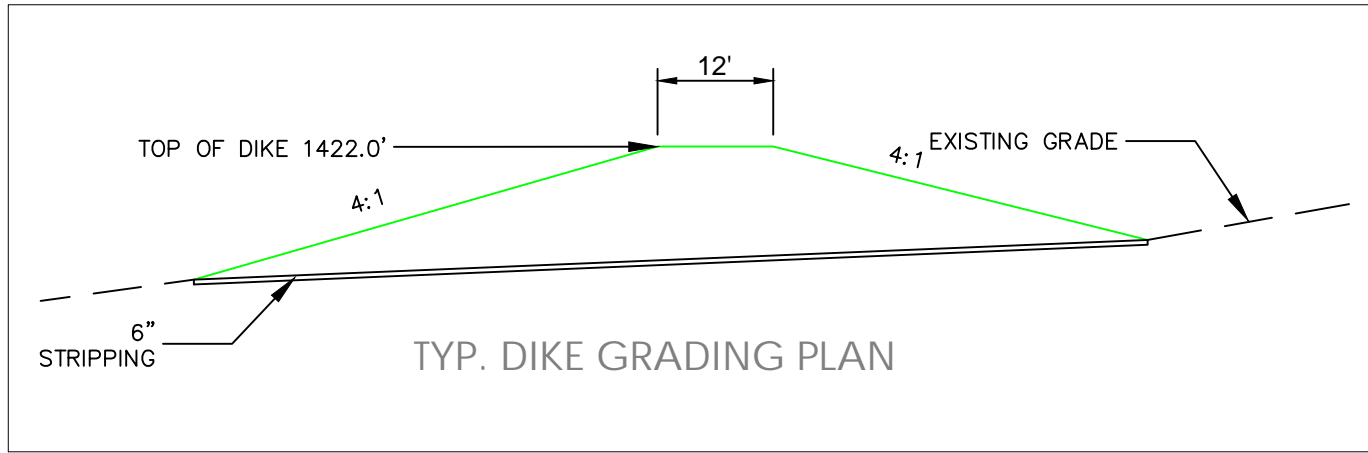

- Notes:
1. TYP. spillway bottom width 12'
 2. TYP. swale bottom width 8'
 3. Centerline of spillway 0.5' lower than sides to form a "swale" channel water
 4. Slope from edges of spillway 3 to 1 to match EG
 5. Erosion stone shall extend 2' up the slopes of spillway and swale

NOT TO SCALE

CONSULTANT:
NONE

IOWA DEPARTMENT OF
NATURAL RESOURCES

ENGINEERING SERVICES -
6200 PARK AVE, DES MOINES, IA 50321



GRADING PLAN

PROJECT DESCRIPTION FOR:
NEPPEL WMA WETLAND RT

DICKINSON COUNTY

NO.	BY	DATE	REVISION
1		2/26/28	90%

DRAWN BY: PROJECT NUMBER:
TJM 23-01-30-04

CHK'D BY: DATE:
" " BID DATE

SHEET No:

D.02