

ADW No. 9224W16C001

AGRICULTURAL DRAINAGE WELL DATA

ADW OWNER:

Name: Donald Tice
Street, Box or RR: 1891 Page Ave
City, State & Zip: Clarion PA 15025
Phone Number: (515) 532-3874

AGENT:

Name: _____
Street, Box or RR: _____
City, State & Zip: _____
Phone Number: (____) _____

ADW LOCATION:

SE 1/4, of the SW 1/4, Section 16, T 92 N, R 24 W

Well Head

Location: 2100' W of the SW corner of section 16 and 850' N

Coordinates: _____

General Condition: Good shape.
Cement cistern covered with wood planks

Cistern Dimensions: 5' x 5' Cistern Depth: 10'

Well Diameter: 7" Well Depth: 244

Cistern cover (padlock no) Yes ☒ or No ☐

Side walls above high pond Yes ☒ or No ☐

Side walls sealed Yes ☐ or No ☒

Mounded/graded to drain away Yes ☐ or No ☒

Surface Intakes

Yes ☒ or No ☐ Number of Intakes 11

**Drains Land of
Others**

Yes ☐ or No ☐ surface intakes

**Other Contaminant
Sources**

Septic Discharge: no Manure Runoff: no Other: _____

Comments

ADW No. 9224W/62001

Well #2 SW

WELL HEAD SKETCH

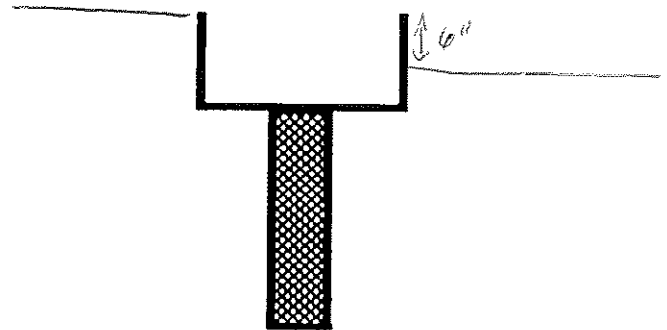
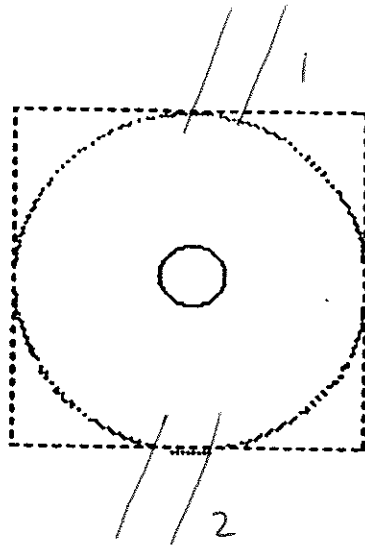

no surface with
Cement cistern w/wood planks

TILE DATA

Line #	Diameter	Entry Depth
1.	12"	8'
2.	10"	9'
3.		
4.		

CISTERN

Shape Square
 Dimensions 5' x 5'
 Depth 10'

WELL BORE

Diameter 7"
 Depth 244'

DRAINAGE SKETCH

		B	A
B		A	
		C	D
C		D	

EXAMPLE
QQ Section Coding

Well ⊗

Surface Intake ○

Drainage - - - - -

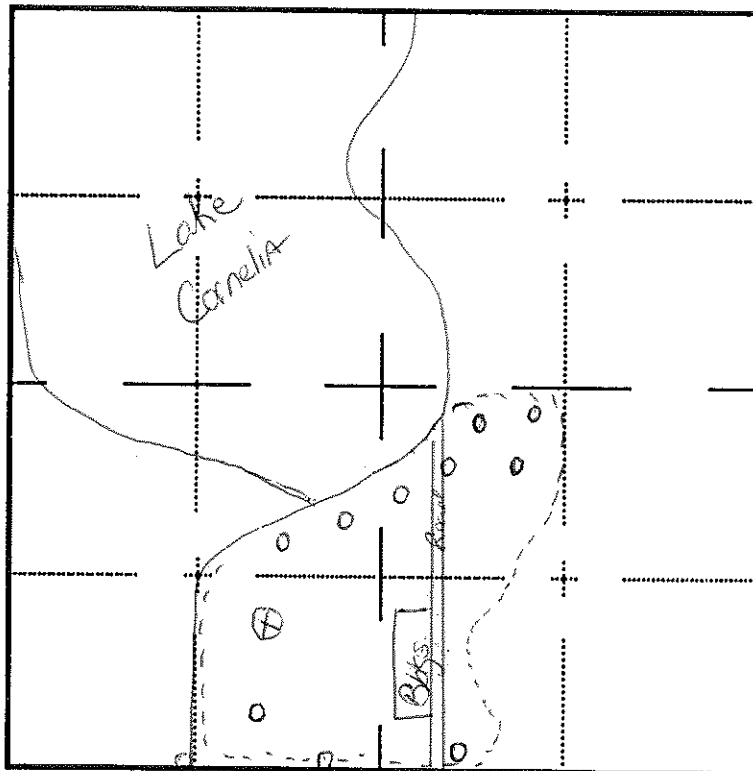

Agricultural Drainage Well Registration Form
(Please print in ink or type)

92 24W 16DD 01

EE Ack 2/2

- 1) LOCATION OF DRAINAGE WELL (Attach aerial photo if necessary-see instructions)

no, 1 ~~SE~~ SW 16 92N 24 W right
no, 2 SE 1/4 of the SE 1/4, Section 16, T92N, R24, Wright County

- 2) NAME AND ADDRESS OF DRAINAGE WELL OWNER

Name Donald Tice
Street, RR or Box RR 2
City and State Clarion, Iowa
Zip Code 50525
Phone (515) 532-3874

- 3) NAME AND ADDRESS OF AUTHORIZED AGENT
(leave blank if not appropriate)

Name _____
Street, RR or Box _____
City and State _____
Zip Code _____
Phone () _____

- 4) INDICATE BELOW THE AMOUNT OF LAND DRAINED BY THE DRAINAGE WELL

LAND OWNED BY THE WELL OWNER 165 ACRES
LAND NOT OWNED BY THE WELL OWNER 110 ACRES
TOTAL AMOUNT OF LAND DRAINED 275 ACRES) these are
Purely Grasses

- 5) OF THE LAND DRAINED BY THE DRAINAGE WELL, GENERALLY WHAT PERCENTAGE IS IN CONTINUOUS ROW CROP (Include any set-aside acres that normally would be in row crop production) 99 % ?

- 6) WHAT TYPE OF DRAINAGE WATER ENTERS THE DRAINAGE WELL? CHECK ONE



TILE DRAINAGE
ONLY



SURFACE WATER
ONLY



BOTH TILE AND
SURFACE WATER

7) TO YOUR KNOWLEDGE, HOW CLOSE IS THE NEAREST WATER SUPPLY WELL FOR HUMAN CONSUMPTION TO THE DRAINAGE WELL? CHECK ONE.

☐

1/8 mile
or less

☐

1/8 to
1/4 mile

☒

1/4 to
1/2 mile

☐

1/2 to
1 mile

☐

1 mile
or more

8) HOW DEEP IS THE DRAINAGE WELL? no. 1 244 ft.

no. 2 254

COMMENTS:

Donald C. Fine
Signature of ☒ owner ☐ agent
(check one)

Dec 10, 1987
Date

DEPARTMENT OF
NATURAL RESOURCES

DEC 28 AM 10 04

EPA Region VII - Injection Well Tracking System

Facility I.D. Number: IAS197500014

SITE INFORMATION

Facility Name:

Contact Name: DONALD TICE

Address:

P.O. Box: RR. 2

City: CLARION

State: IA

Zip: 50525

Phone: (515)532-3874

County FIPS Code: 197 County: WRIGHT

OWNER INFORMATION

Company Name:

Owner Name: DONALD TICE

Address:

P.O. Box: RR. 2

City: CLARION

State: IA

Zip: 50525

Phone: (515)532-3874

Ownership: Private

INJECTION WELL INFORMATION AS OF 02/18/91

WELL NUMBER	TYPE	OPERATING STATUS	LOCATION	SURFACE INLETS	TILE SYSTEM	TOTAL DEPTH	CASING DIAMETER	CASING LENGTH	AREA DRAINED	PRIMARY QUADRANGLE
001	01	AC	T92N, R24W, Section 16, SE	N	Y	254	6	0	0	HUMBOLDT, IOWA 1:100,000
002	01	AC	T92N, R24W, Section 16, SE	N	Y	254	7	0	0	HUMBOLDT, IOWA 1:100,000

KEY: TYPE - 01 = Agricultural Drainage Well

11 = Septic Tank

28 = Automotive Service Waste Disposal Well

OPERATING STATUS - AC = Active

TA = Temporarily Abandoned

PA = Permanently Abandoned

