



C:\Users\Zach Gunsolley\Desktop\25-04-15-03 Anita Playground Accessibility Improvements\25-04-15-03 Plans.dwg

Plot Date: 5/1/2026 10:58 AM



Project Location

Playground

Campground

Park Office



Drawn by: ZG	
Revision	Date

Plot Date: 5/1/2026 10:58 AM C:\Users\Zach\_Gunsolley\Desktop\25-04-15-03 Anita Playground Accessibility Improvements\25-04-15-03 Plans.dwg

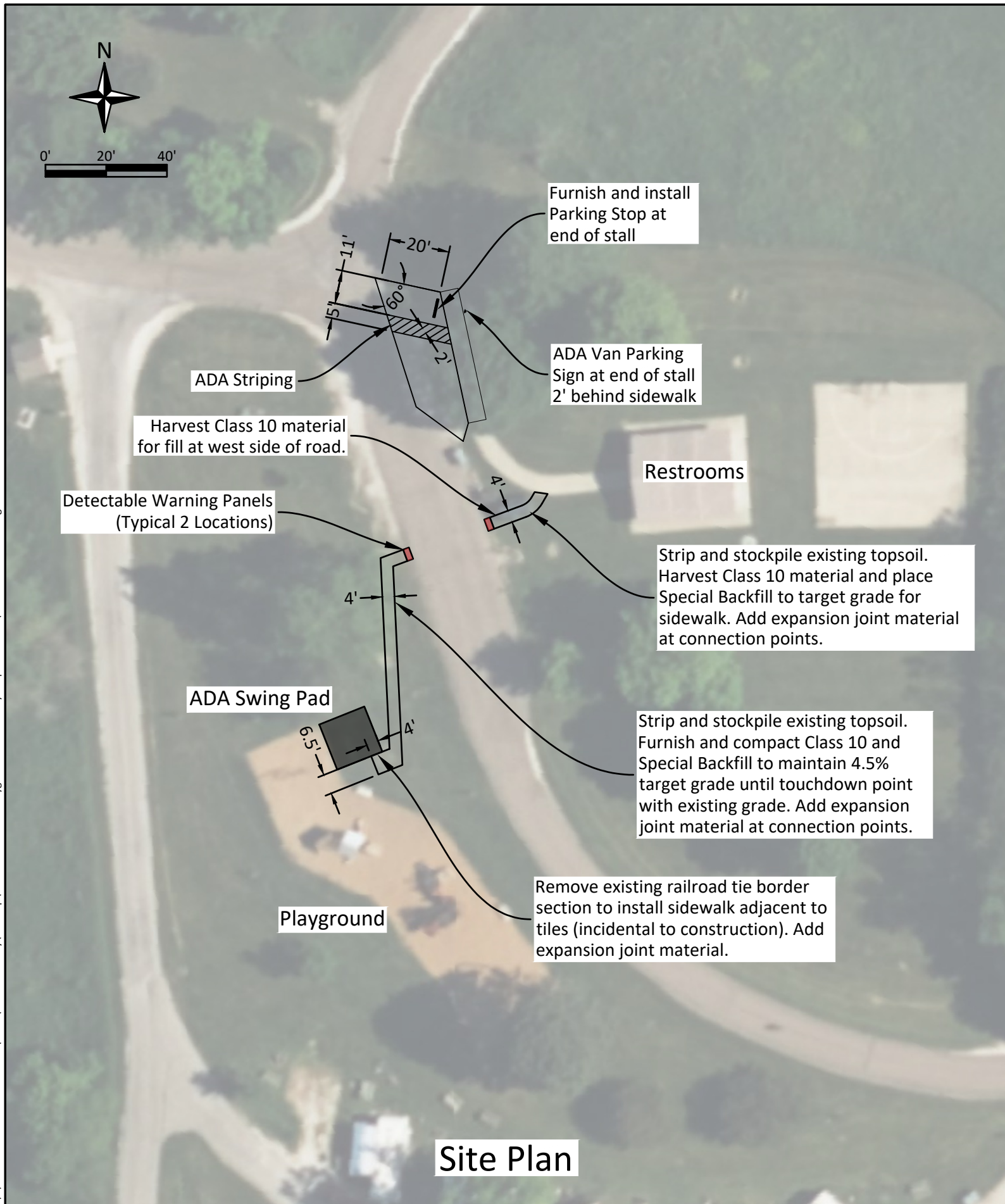

**Site Plan**



Drawn by: ZG	
Revision	Date

Bid Date:  
05/28/2026

Project Number:  
25-04-15-03

Accessibility Improvements  
Lake Anita State Park, Cass County

Project Overview

Sheet No:  
**A.03**

C:\Users\Zach.Gunsolley\Desktop\25-04-15-03 Anita Playground Accessibility Improvements\25-04-15-03 Plans.dwg  
Plot Date: 5/1/2026 10:58 AM

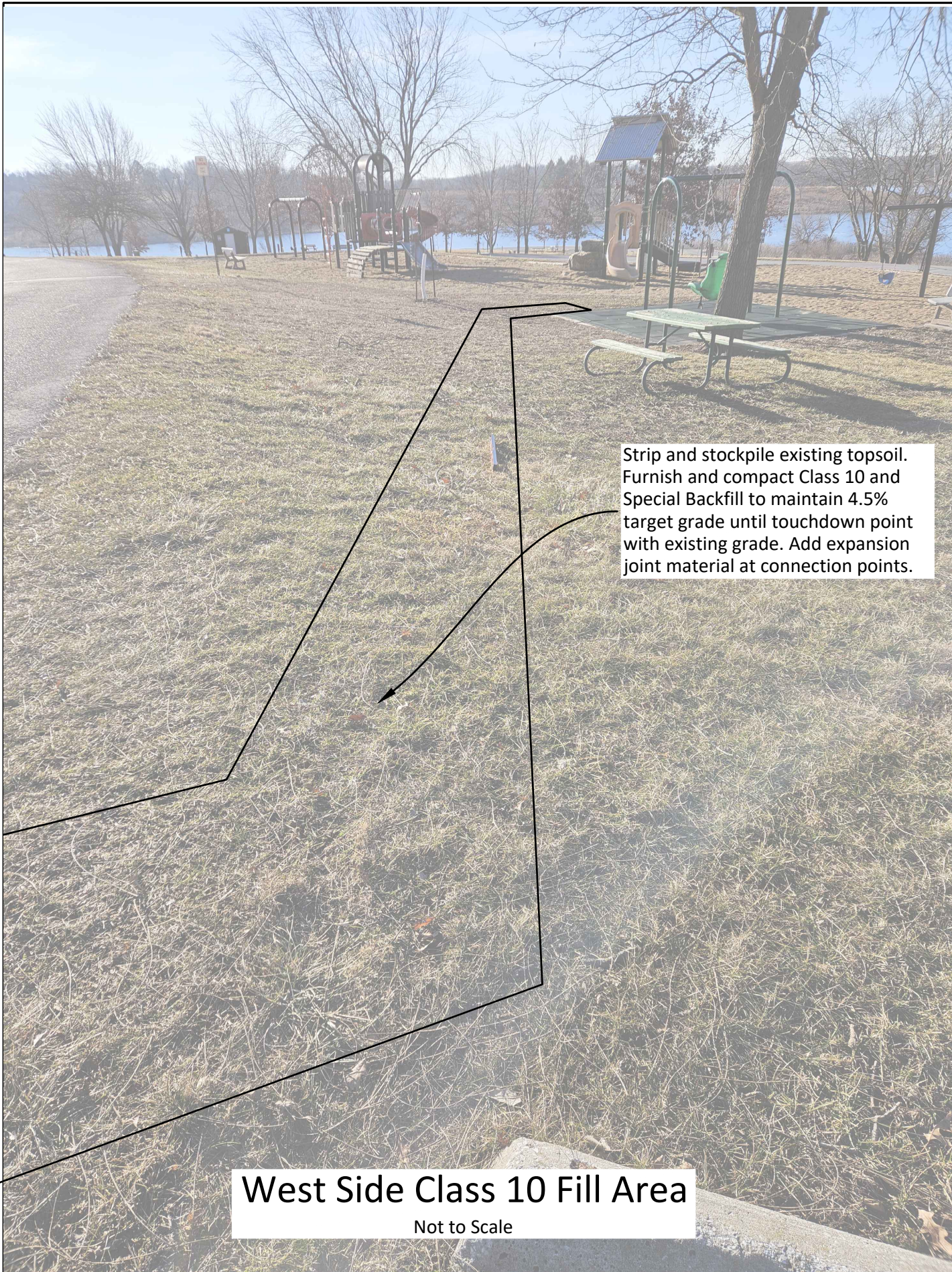

Strip and stockpile existing topsoil. Furnish and compact Class 10 and Special Backfill to maintain 4.5% target grade until touchdown point with existing grade. Add expansion joint material at connection points.

### West Side Class 10 Fill Area

Not to Scale



Remove existing railroad tie border section to install sidewalk adjacent to tiles (incidental to construction). Add expansion joint material.

### ADA Swing Pad Connection

Not to Scale

C:\Users\Zach Gunsolley\Desktop\25-04-15-03 Anita Playground Accessibility Improvements\25-04-15-03 Plans.dwg  
Plot Date: 5/1/2026 10:58 AM

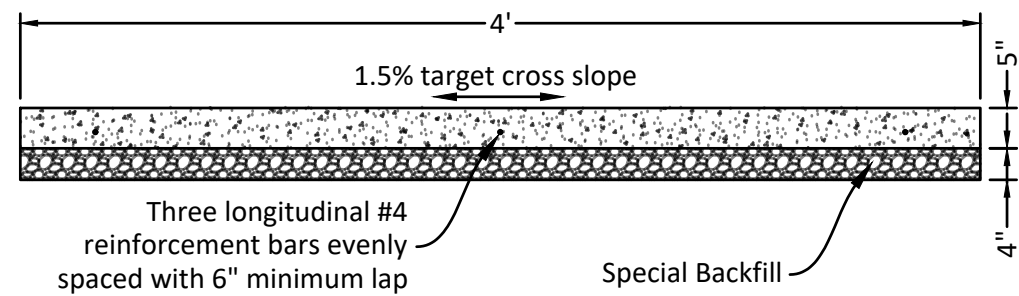

**Sidewalk Detail**  
Not to Scale

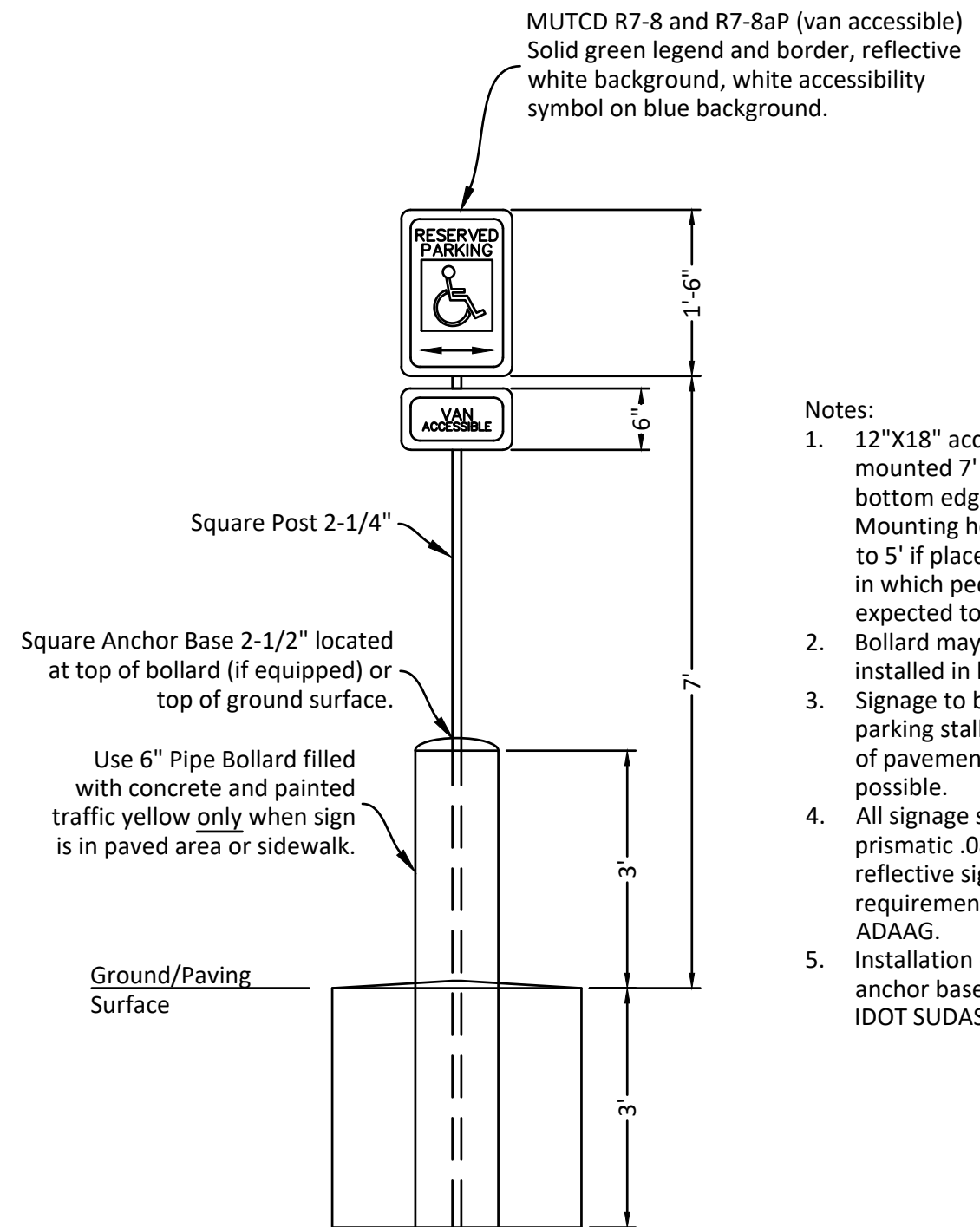

**ADA Accessible Parking Signs Detail**  
Not To Scale

**Notes:**

1. 12"X18" accessibility sign shall be mounted 7' from finish grade to bottom edge of sign face. Mounting height may be reduced to 5' if placed in a landscape area in which pedestrians are not expected to use.
2. Bollard may be omitted if installed in landscape areas.
3. Signage to be located at end of parking stall, 2' back from edge of pavement, centered on stall if possible.
4. All signage shall be high-intensity prismatic .080 aluminum reflective sign meeting the requirements of the MUTCD and ADAAG.
5. Installation of square post and anchor base in accordance with IDOT SUDAS Section 8040.

Plot Date: 5/1/2026 10:58 AM C:\Users\Zach Gunsoley\Desktop\25-04-15-03 Anita Playground Accessibility Improvements\25-04-15-03 Plans.dwg

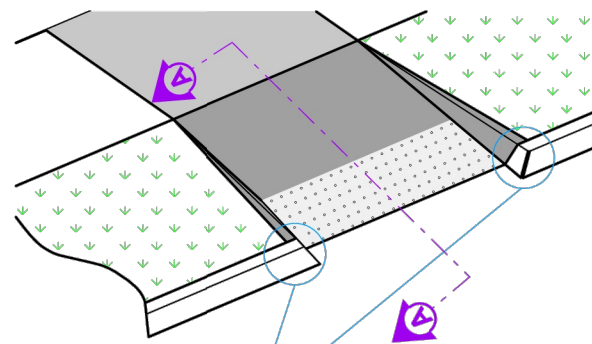

See Detail 'A'

**CURB RAMP PERPENDICULAR TO CURB**

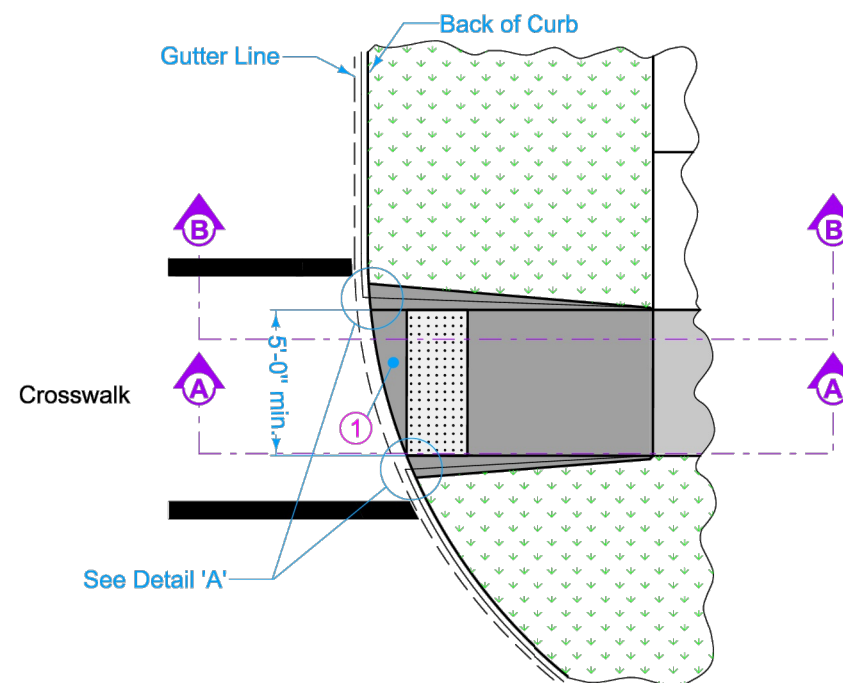

See Detail 'A'

**CURB RAMP NOT PERPENDICULAR TO CURB**

- ① Unless curb ramp is aligned perpendicular to the street radius, provide an area of special shaping at the bottom of the ramp. This area allows the grade break at the bottom of the ramp to be perpendicular to the ramp and provides a smooth transition to gutterline for wheelchair access.
- ② Use vertical curb adjacent to ramp unless flares are specified in the project plans. Install Detectable Warnings so that no gap is left between warning panel and base of curb.

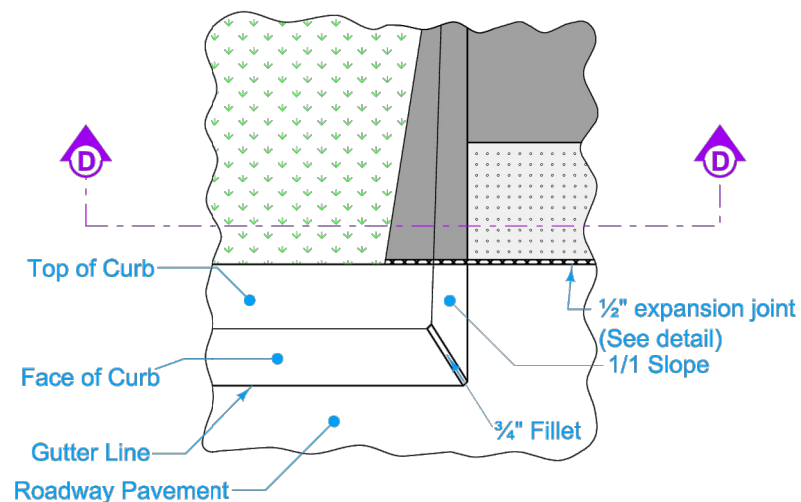

**DETAIL 'A'**

LEGEND	
	Ramp
	Landing
	Detectable Warnings
	Vegetation

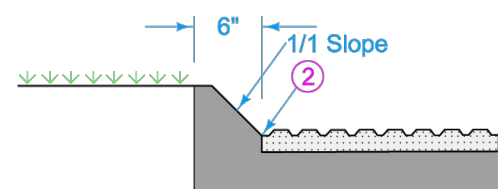

**SECTION D-D**

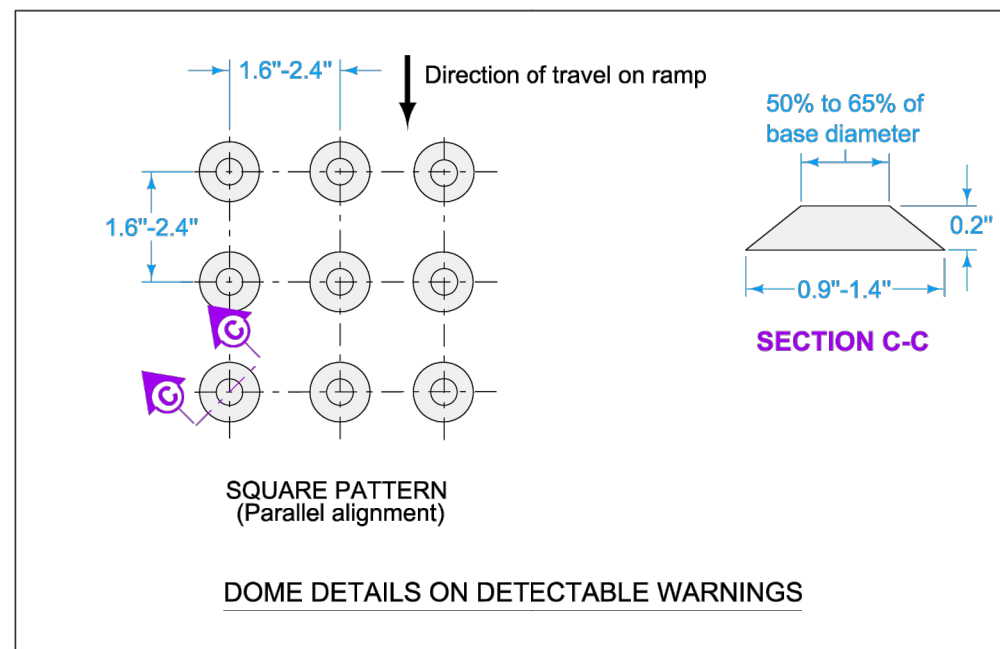

Possible Contract Items:  
 Detectable Warnings  
 Sidewalk, P.C. Concrete, 6 in.  
 Sidewalk, P.C. Concrete, 4 in.  
 Removal of Sidewalk

Possible Tabulation:  
 113-1

<b>IOWA DOT</b>	REVISION	
	7	04-15-25
<b>STANDARD ROAD PLAN</b>		<b>MI-220</b>
		SHEET 1 of 3
REVISIONS: Changed 'E' joint to 1/2" expansion joint, added expansion joint detail Changed curb end to 1/1 slope.		
 APPROVED BY DESIGN METHODS ENGINEER		
<b>DETECTABLE WARNINGS AND PEDESTRIAN RAMP</b>		



Drawn by: ZG
Revision
Date

Plot Date: 5/1/2026 10:58 AM C:\Users\Zach Gunsolley\Desktop\25-04-15-03 Anita Playground Accessibility Improvements\25-04-15-03 Plans.dwg

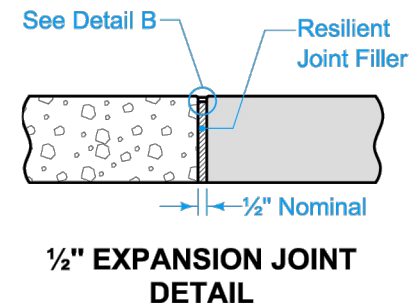
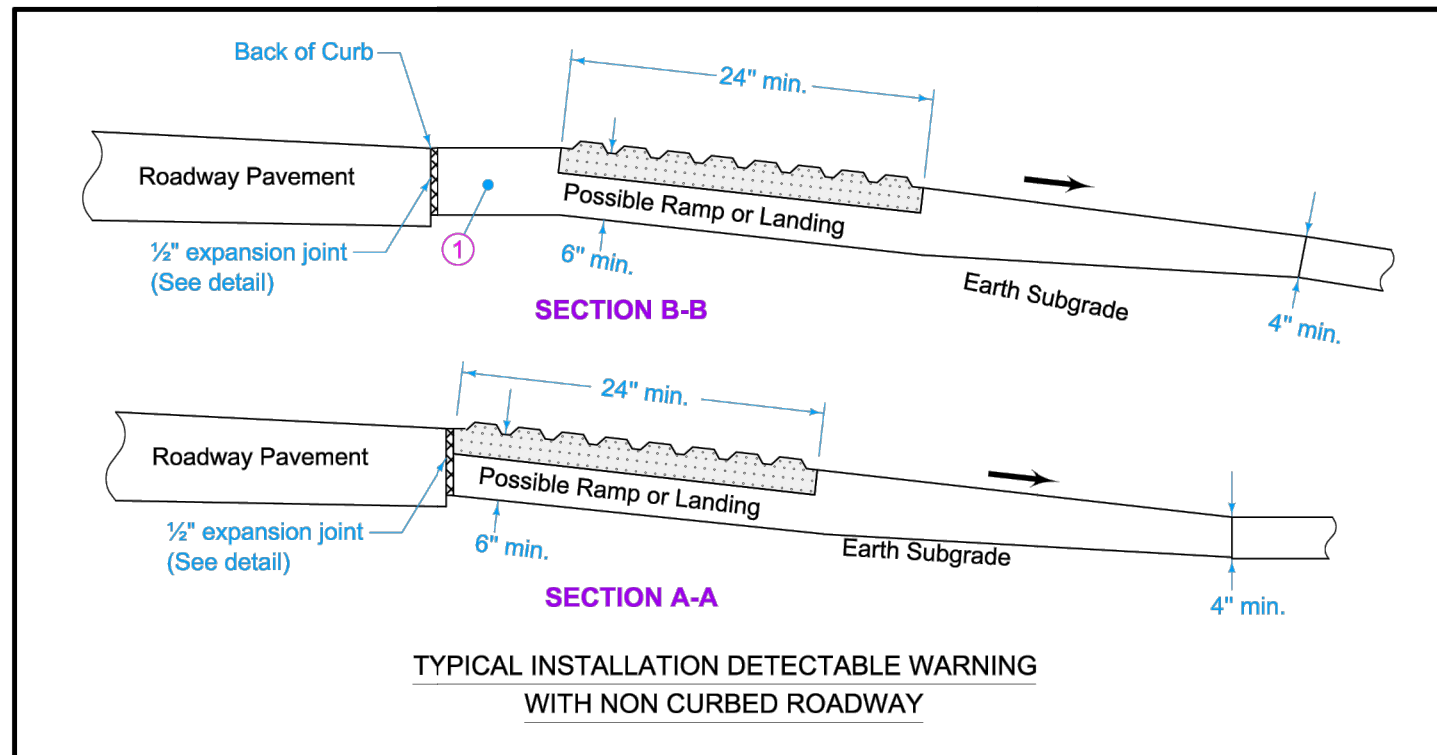

- ① Unless curb ramp is aligned perpendicular to the street radius, provide an area of special shaping at the bottom of the ramp. This area allows the grade break at the bottom of the ramp to be perpendicular to the ramp and provides a smooth transition to gutterline for wheelchair access.
- ④ Edge with 1/4 inch tool for length of joint indicated if formed; edging not required when cut with diamond blade saw.

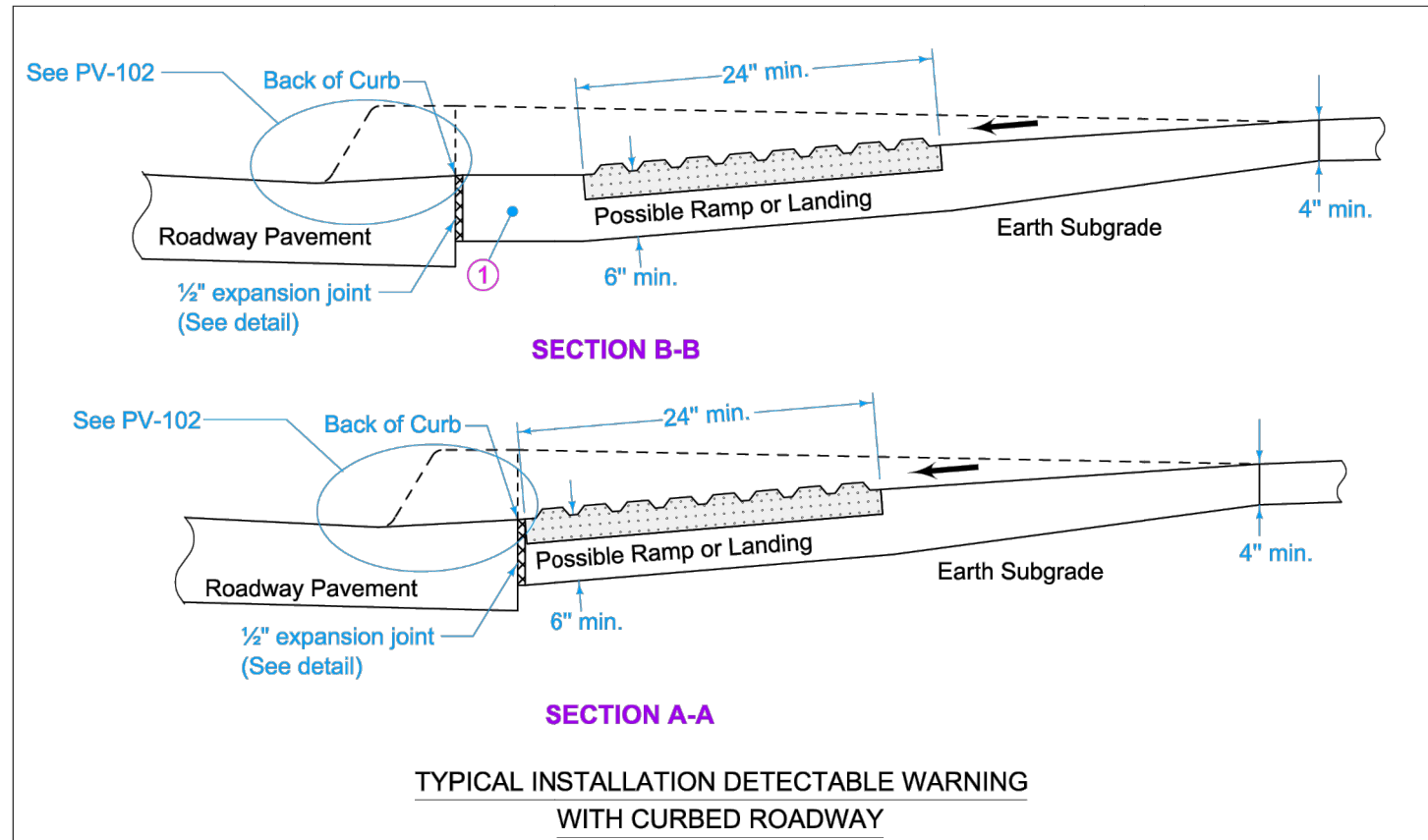
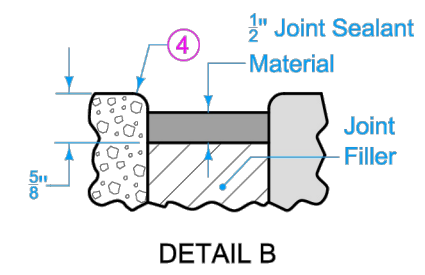

**LEGEND**

	Ramp
	Landing
	Detectable Warnings
	Vegetation

<b>IOWA DOT</b>	REVISION	
	7	04-15-25
<b>STANDARD ROAD PLAN</b>		<b>MI-220</b>
		SHEET 2 of 3
REVISIONS: Changed 'E' joint to 1/2" expansion joint, added expansion joint detail Changed curb end to 1/1 slope.		
 APPROVED BY DESIGN METHODS ENGINEER		
<b>DETECTABLE WARNINGS AND PEDESTRIAN RAMP</b>		



Drawn by: ZG
Revision
Date

Bid Date: 05/28/2026

Project Number: 25-04-15-03

Accessibility Improvements  
Lake Anita State Park, Cass County

Project Details - Detectable Warnings

Plot Date: 5/1/2026 10:58 AM C:\Users\Zach.Gunsolley\Desktop\25-04-15-03 Anita Playground Accessibility Improvements\25-04-15-03 Plans.dwg

Estimated Quantities			
Item	Description	Quantity	Unit
<b>Site 1</b>			
1	2102-0425070 Special Backfill	10	Tons
2	2102-2710070 Excavation, Cl 10, Roadway and Borrow	4	CY
3	2105-8425015 Topsoil, Strip, Salvage and Spread	8	CY
4	2511-7526005 Sidewalk, Reinforced PCC, 5 In.	48	SY
5	2511-7528101 Detectable Warnings	16	SF
6	2515-9999999 Parking Stop	1	EA
7	2526-8285000 Construction Survey	1	LS
8	2527-9263209 ADA Striping and Van Parking Sign	1	LS
9	2533-4980005 Mobilization	1	LS
10	2601-2634105 Mulching, Bonded Fiber Matrix	0.05	Acre
11	2601-2636044 Seeding and Fertilizing (Urban)	0.05	Acre

Estimate Reference Information	
1.	See referenced IDOT specification and Sheet B.01. In fill areas, place and compact after Class 10 placement. Estimated quantities include 4" under sidewalks.
2.	See referenced IDOT specification. Place and compact in fill areas below special backfill and topsoil.
3.	See referenced IDOT specification. Place in areas after Class 10 placement.
4.	See referenced IDOT specification and Sheets A.03, A.04 and B.01. Class C mix, Class 2 durability coarse aggregate.
5.	See referenced IDOT specification, Sheet A.03, B.02 and B.03.
6.	See referenced IDOT specification and Sheet A.03. ULINE H-4608B/Y 6' black/yellow striped or approved equivalent. Include all labor, equipment, and materials necessary to install per manufacturer's recommendations.
7.	See referenced IDOT specification. This item includes all necessary survey and staking to complete work in accordance with the Contract Documents and 2010 ADA Standards. Non-compliant work shall be removed and replaced at the sole expense of the contractor. Noteworthy ADA requirements: A. 2% maximum cross slope on sidewalks. B. 5% maximum running slope on sidewalks. C. 2% maximum slope in any direction on parking stalls, access aisles.
8.	See referenced IDOT specification and Sheets A.03 and B.01.
9-11.	See referenced IDOT specification.

General Information	
1.	Verify actual locations and elevations with DNR Engineer.
2.	All work shall conform to and be performed in accordance with all applicable codes and ordinances.
3.	The contractor shall visit the site and inspect the project area and thoroughly familiarize themselves with the actual job conditions prior to bidding and the start of work. Failure to visit the project site shall not relieve the contractor from performing the work in accordance to the plans, specification, special provisions and contract.
4.	The contractor shall verify, at the site, all dimensions and conditions shown on the plans and shall notify the DNR Engineer of any discrepancies, omissions, and/or conflicts prior to proceeding with the work.
5.	It shall be the contractor's responsibility to provide waste areas or disposal sites for excess material (excavated material or broken concrete) which is not desirable to be incorporated into the work involved on this project. No payment for overhaul will be allowed for material hauled to these sites. No material shall be placed within the right-of-way, unless specifically stated in the plans or approved by the DNR Engineer.
6.	The contractor shall not disturb desirable grass areas and desirable trees outside the construction limits. The contractor will not be permitted to park or service vehicles and equipment or use these areas for storage of materials. Storage, parking and service areas will be subject to the approval of the DNR Engineer.
7.	Where utilities and fixtures are shown as Existing on the plans or encountered within the construction area, it shall be the responsibility of the contractor to notify the DNR Engineer of those utilities prior to the beginning of any construction. The contractor shall be afforded access to these facilities for necessary modification of services. Underground facilities, structures and utilities have been plotted from available surveys and records and therefore their locations must be considered approximate only. It is possible there may be others, the existence of which is presently not known or shown. It is the contractor's responsibility to determine their existence and exact location and to avoid damage thereto. No claims for additional compensation will be allowed to the contractor for any interference or delay caused by such work.
8.	The contractor shall shape graded area to maintain surface drainage. All elevations are to finish grade.
9.	The contractor is expected to have materials, equipment, and labor available on a daily basis to install and maintain erosion control features on the project. This may involve seeding, silt fence, rock ditch checks, silt basins or silt dikes.
10.	The Iowa DOT Standard Specifications for Highway and Bridge Construction, Series 2023, plus General Supplemental Specifications and Supplemental Specifications effective at the time of letting, shall apply to this project. The item's description includes applicable IDOT specification sections.
11.	Work Restrictions: Work cannot begin until September 8, 2026. This includes mobilization. No work from noon on Friday to sunrise on Monday to avoid peak camping. If campers are present, working hours shall be from 8 am to 5 pm.



Drawn by: ZG	
Revision	Date