

TERRACE HILL (DES MOINES)

Summary of Facility Elevators:

Terrace Hill – Terrace Hill Mansion								
Elev. Name	State Elev. No.	Manf.	Type of Elevator	Install Year	Function	Floors Served	Stops / Openings	
Terrace Hill Mansion	5421	Montgomery	Hydraulic	1975	Passenger	4	4 2F/2R	

Building Location: 2300 Grand Ave., Des Moines, Iowa 50301

Building Contact: Diane Becker, (515) 242-5841 ext. 2536, diane.becker@iowa.gov

Summary of Facility Elevators Scope of Work:

Scope of Work Items (Terrace Hill, No. 5421):				
Item No.	Description (per IA DOL)	Code Ref. (A17.3)	Scope of work: <u>Section 14 00 00</u>	Bid Pkg
1.	Install car door restrictor	2.7.5	See item 2.05 / B.	1
2.	Install pit stop switch adjacent to pit ladder	2.3.3	See item 2.04 / D.	1
3.	Install car top emergency exit	3.4.4.1 (a)	See item 2.06 / C.	1
4.	Provide hoistway door key and all keys to operate elevator, tagged in machine room.	IA. CH 73 Rule 73.2(10)	See item 2.03 / D.	1
5.	Install all code data plates	ASME A17.1-8.9	See item 2.03 / C.	1
			Scope of work: Section as noted below:	
6.	Multiple pipes and electrical to guard in Machine Room.	2.2.5	See drawings E1.1 and E1.2 for corrective work.	2,3, 4
7.	Provide separation of M.R. with self-locking/closing door.	2.2.2	Replace existing door lockset with Storeroom function lockset: AU4705LN 626 Yale Provide hardware compatible with removable core consistent with Owner's existing system. Provide new surface mounted closer with adjustable 90 degree stop at existing door: 4111 EDA 689 LCN	2

Key Notes:

- See general drawings for abbreviations and typical product installation requirements.
- See general drawings for typical sheet metal enclosure details.

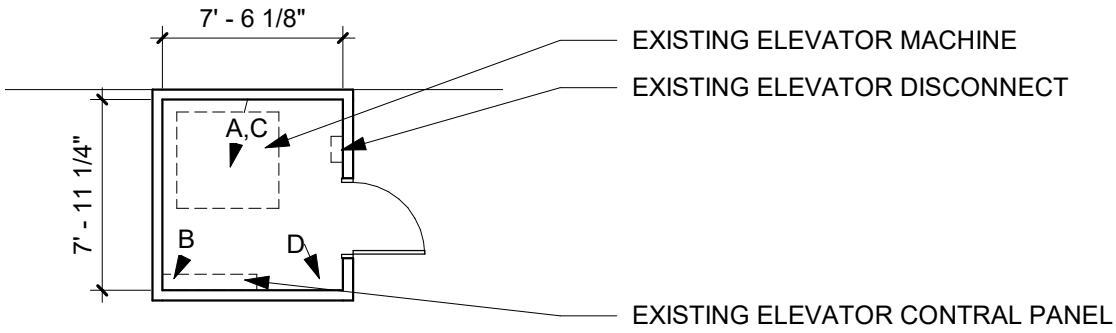

1 TERRACE HILL PLAN
1/8" = 1'-0"



2 TERRACE HILL - PHOTO 'A' SOUTH & EAST WALL

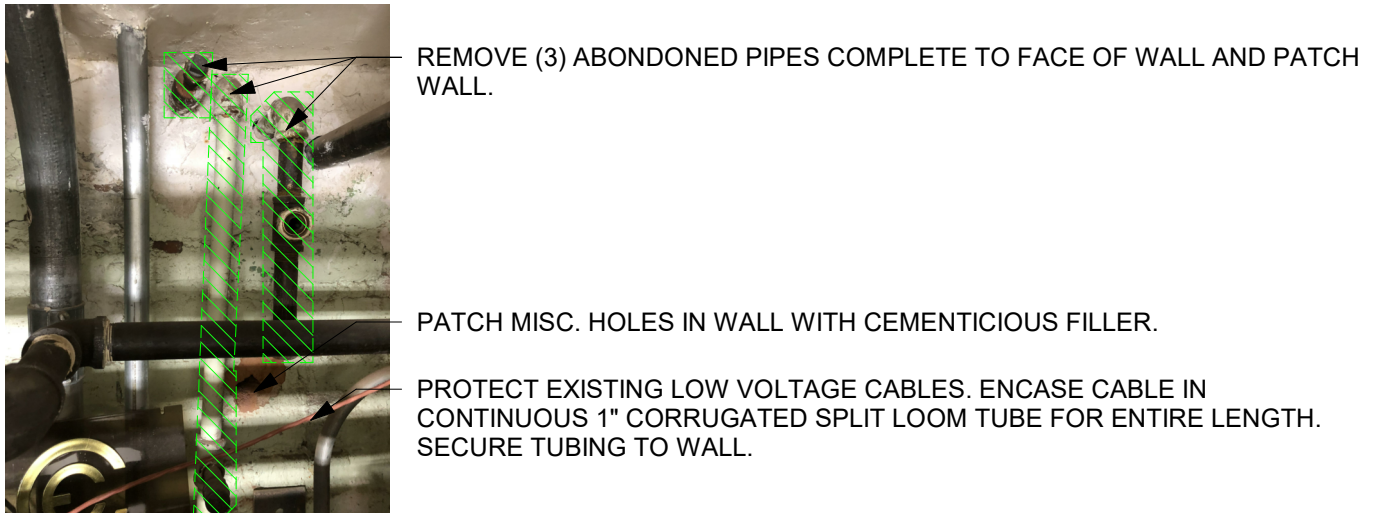

3 TERRACE HILL - PHOTO 'B' SE CORNER

COORDINATE DRIP PAN AT SANITARY TO MAINTAIN DOOR OPERATION.

PROTECT EXISTING LOW VOLTAGE CABLES. REMOVE EXISTING CABLE SUPPORTS TO ADJACENT CONDUIT. ENCASE CABLE IN CONTINUOUS 1" CORRUGATED SPLIT LOOM TUBE FOR ENTIRE LENGTH. SECURE TUBING TO CEILING.



PROVIDE PVC PIPE JACKETING AT THESE PIPES. COORDINATE INSTALLATION TO PREVENT SEAMS OVER ELECTRICAL PANEL.

SECURE WIRING TO CEILING.

PROVIDE DRIP PANS BELOW SANITARY AND SPRINKLER PIPING AS SHOWN. PROVIDE OUTLETS AS INDICATED.

ROUTE DRAIN FROM UPPER DRIP PAN TO LOWER DRIP PAN.

PROVIDE DRIP PAN OUTLET TO PIPE THROUGH EXISTING OPENING AND DOWN WALL TO DRAIN IN OPPOSITE ROOM.

4

TERRACE HILL - PHOTO 'C' SOUTH & WEST WALL



REMOVE VALVE AND CAP LINE. SEE PHOTO 'A'.

PATCH MISC. HOLES IN WALL WITH CEMENTICIOUS FILLER. COORDINATE DRIP PAN AT SANITARY TO MAINTAIN DOOR OPERATION.

PROVIDE PVC PIPE JACKETING AT THESE PIPES. COORDINATE INSTALLATION TO PREVENT SEAMS OVER ELECTRICAL PANEL.

PROVIDE DRIP PANS BELOW SANITARY AND SPRINKLER PIPING AS SHOWN. PROVIDE OUTLETS AS INDICATED.

PROVIDE FIRE RATING SAFING TO CLOSE OF OPENINGS TO ADJACENT ROOM.

5

TERRACE HILL - PHOTO 'D'

