

Addendum 1 for RFB911700-01

Project Name: IVH-Courtyard

DAS RFB #: 911700-01 DAS

Project #: 9117.00 Date:

3/9/2020

Addendum 1

- Cover Page – Table of Contents and Clarifications (3 pages)
- Prebid Meeting Minutes (3 pages)
- Bid Form (7 pages)
- L803 SECURITY FENCING DETAILS (1 page)
 - The Ring adornment feature has been removed from the Cantilevered Gate only.
 - All fencing details have been updated to reflect the “Montage Plus” specifications.
- L808 PUTTING GREEN DETAILS (1 page)
 - Update Plan to include a 2’ wide Fringe material around the entire perimeter of the putting green.
 - Update all details to consistently label the ‘free draining finishing stone’ layer.

Clarifications:

1. This project will utilize Procore, in lieu of EADOC, as the project management software. The use of Procore will remain free to the selected contractor.
 - a) All references to EADOC shall be replaced with Procore.
2. **Section 10 7300 Protective Covers**
 - a. Paragraph 1.01.A: Revise to read as follows:
 - i. “Shelter Types:
 1. 20’ Square style shelter with Multi-Rib roof panels.
 2. 16’ Square style shelter with Multi-Rib roof panels.
 3. 30’ x 44’ Stretched Hexagon Style Shelter with Standing Seam Roofing and Tongue and Groove Wood Decking.”
 - b. Paragraph 2.01.C.7a: Revise to read as follows:
 - i. “PRIMARY ROOF DECK – MULTI-RIB METAL ROOFING (16’ and 20’ Square Shelters)
 1. Roofing shall be a minimum of 24 gauge Galvalume steel sheet with ribs that are 1 3/16” tall and 12” on center. Ribs shall run with the slope of the roof for proper drainage.
 2. Roof outside surface shall be a baked on Kynar 500 paint finish and shall be supplied in one of the manufacturer’s standard color: Mansard brown. Ceiling color to be a “wash coat” primer.

3. Roof panels shall have the roof angles factory pre-cut to size to provide ease of installation.
 4. Metal roofing trim shall match the color of the roof and shall be factory made from 26 gauge Kynar 500 painted Galvalume sheet steel.
 5. Trim includes panel ridge caps, hip caps, eave "J" trim, splice channels, rake trim, roof peak cap and corner trim as applicable for the model selected. Trim may need to be field cut to length. Please refer to the installation drawings for additional information and detail.
 6. Ridge, hip and valley caps shall be pre-formed with a single central bend to match the roof slope and shall be hemmed on both edges.
 7. Roof peak caps shall be pre-fabricated with no field assembly required.
 8. Manufacturer shall supply roof screws painted to match the roof."
 - c. Paragraph 2.01.C.7b: Revise subparagraph to read as follows:
 - i. "PRIMARY ROOF DECK – STANDING SEAM ROOFING (Stretched Hex Shelter)"
 - d. Paragraph 2.01.C.7c: Revise subparagraph to read as follows:
 - i. "SECONDARY ROOF DECK – TONGUE & GROOVE WOOD DECKING (Stretched Hex Shelter)"
 - e. Paragraph 2.01.C.7d: Remove entirely.
 - f. Paragraph 2.01.C.7e: Remove entirely.
3. **Section 32 1813 Synthetic Turf Putting Green**
- a) Add Paragraph 1.5.A.7:
 - Provide free draining finishing stone layer project documentation outlining permeability testing and particle size analysis.
 - b) Paragraph 2.1.G: Revise to read as follows:
 - "Acceptable providers and products of the synthetic turf putting green and the associated fringe system are:
 - SynLawn "Precision Putt" (Putting Green) and "Syntipede 243" (Fringe)
 - c) Add Paragraph 2.5.A:
 - FREE DRAINING FINISHING STONE LAYER
 - The free draining finishing stone later shall be a 3/8" minus with fines or a crushes aggregate that is permeable and shall be capable of being laser-graded to a smooth surface.
4. **S100 OVERALL SITE STAGING PLAN**
- a. Remove all references to Spec. Section 015400
 5. Do you want tongue and groove roof decking on all 3 shelters or just the main shelter?
 - a) It is our intent to have only the 30 x 44 Tiara include the T & G Decking.
 6. Are background checks required for this project?
 - a) Background checks are not required.
 7. The base specifications are a little strange for how to build the green. It calls for 3/8" finish drainage stone.. This would make for a very bumpy putting surface. We use AB3 (aggregate with a layer of dust fines on top) to create the purest roll possible. This is not a permeable option either. All of our putting turf sheet drains anyways. How would you like me to proceed?
 - a) The actual specifications (32 1813) do not specify the stone material, the details on sheet L808 do. There is a discrepancy between details 2, 3, and 4 on sheet L808. Detail 4 correctly calls out the stone base as 3/8" minus, which includes fines. The AB3 aggregate

appears to have stone larger than 3/8" which may be concerning. Permeability is desired in some regard otherwise water will pool in subtle depressions and along the edges of the perimeter concrete.

8. Sheet S100 refers to "temporary low-impact access matting" it refers to spec section 015400. There is no spec section 015400 in the spec book.
 - a) Eliminate reference to spec section 01-5400. Refer to demo spec for requirements for expected subgrade protection.
9. Is OCP liability insurances required if GL insurance is provided? The way I read the sample COI is that the contractor needs to provide either GL or OCP.
 - a) OCP is not required if GL insurance is provided. Contractors can provide one or the other, but don't need to provide both.
10. Where is the fencing located on the site plan?
 - a) Refer to sheets L100 & L102.
11. Would you guys approve using tree straps with grommets and tie up with 16 gauge wire with 900lb break strength?
 - a) There are concerns with the grommets as they often 'pop off' through winter snow/ice stress and the wire will just slices through the nylon strap. We would prefer that the guys be made entirely of the nylon strap as specified.
12. Detail 1/L803 should the fencing product be Montage or Montage Plus? This will have an impact on pricing because of picket size. Also, the cantilever gate unable to have the double ring adornment.
 - a) The Montage Plus product is to be specified. All references to "Montage" on Sheet L803 need to be revised to say "Montage Plus". The specification is correct and doesn't need to be updated
13. Can you confirm if there's an existing irrigation system that we'll be tying into when we retrofit it over into the new landscaping?
 - a) There is no existing irrigation and build back will not include irrigation.
14. I don't see a manufacturer/model no. listed in the specs. Please have the landscape architect clarify the vendor so we can accurately price it.
 - a) This was in reference to the irrigation which is not included in the project scope. The contractor is responsible for sod maintenance (grow-in) until substantial completion (grass rooted to a depth of 3")

March 2nd, 2020 at 1:00 PM

Owner/DAS/CM Team Introductions:

Iowa Department of Administrative Services (DAS) – Brad Tonyan
Iowa Veterans Home (IVH) – David Haines
Designer – Jeffery L. Bruce & Company – Eric Doll
Construction Manager – DCI Group – Michael Martin

General Project Description/Overview:

Demolition of existing site paving, landscaping, water features, and Shelters. New construction consists of (3) shelters, water features, site lighting, paving, landscaping, rec area, and storm drainage throughout the entire site.

Bid Package Process:

This RFB will result in one successful proposal per bid package.

- 1) BP #1 – Civil & General Construction
 - a. Alt. #1 Splash pad – Contractor to provide and install splash pad. Base bid shall include sod of this area.
 - b. Alt. #2 Sport Court – Contractor shall provide and install sport court system per details on sheet L807.
 - c. Alt. #3 Planter boxes – Contractor to provide planter boxes per sheet L200. Base bid shall include install and soil.
 - d. Alt. #4 Site Furniture – Contractor to provide site furniture per furniture legend on sheets L100, L101, and L102. Base bid shall include install.
- 2) BP #2 – Electrical
 - a. Alt. #1 Splash pad – Contractor shall provide electrical connections for splash pad.
- 3) BP #3 – Landscaping

BIDS DUE: March 12, 2020 at 2:00 PM

MAKE SURE IT IS SUBMITTED TO DAS AS THE REQUEST FOR PROPOSALS READS

2. Proposal Process
 - a. Sealed bids delivered to Hoover Building Level 3
 - i. Modification to bid form is available upon request
 - ii. Ensure to read through the instruction to bidders section 00-2113
3. Bidding Schedule
 - a. All questions after this meeting and prior to **March 5, 2020** by 2:00 PM CST, to be submitted to Construction Procurement at construction.procurement@iowa.gov. Do not contact DAS, IVH, Jeffery L. Bruce & Company, or DCI Group directly for questions or clarifications.
 - b. An addendum will be issued to incorporate minutes from this Pre-Bid Meeting.
 - c. Final addendum will be issued no later than **March 10, 2020** by 2:00 PM CST or no later than 48 hours prior to proposals being due.
 - d. Bids due **March 12, 2020** at 2:00 PM CST
 - e. Tentatively an NOI will be issued by March 13, 2020

Scope of Work Overview:

1. Administrative

- a. Agreement between the Owner and Contractor will be a modified ConsensusDocs 802
- b. Procure – State of Iowa project management software
 - i. No cost to the contractor
- c. DocuSign – Contract and change orders will be issued through DocuSign.

- i. No cost to the contractor
- d. Bid documents - <https://www.beelineplanroom.com/jobs/121/details/state-of-ia-das-veterans-home-courtyard-design>
- e. Project is tax exempt.
- f. Pre-construction meetings and submittals.
 - i. Kickoff meeting will be established after contracts are executed
 - ii. Master submittal list will be issued to contractors

2. Construction

a. **Site Logistics and Building Access**

- i. Staging area will be provided within the construction area as shown on sheet S100 Overall Site Staging Plan.
- ii. Parking onsite will be provided in the North gravel lot.
- iii. Bid Package #1 to provide dumpster for use by all Contractors.
- iv. Bid Package #1 to provide temporary restrooms for use by all Contractors.
- v. Work hours will be 7:00 AM to 5:00 PM Monday-Friday. – Contractors will need to provide 48hrs notice for any work outside of these hours, including weekend work.
- vi. Secure all tools and equipment at the end of each day.

b. **Construction Schedule**

- i. Anticipated construction work to take place April 3, 2020 through September 15, 2020.
 - 1. Contractors shall adhere to initial schedule.
 - 2. A pull-plan session will be held with the successful bid package contractors to confirm durations and finalize sequence to meet end date outlined in initial schedule.
 - 3. Substantial completion is September 15th, 2020.

c. **Onsite Coordination**

- i. Onsite supervision by Prime Contractor is required at all times when work by that contractor or their subcontractors/suppliers is taking place.
- ii. Daily logs/Weekly Report/Safety Meetings and meeting requirements.
- iii. All areas shall be cleaned and put back to existing conditions prior to substantial completion.
- iv. Contractor shall maintain accurate as-built construction records throughout the project.

3. Close out

- a. Electronic and hard copies of all O&M's and as-built drawings to be submitted. Refer to spec. section 01 7700 – Closeout Procedures for more details.

4. Site Tour

State Rules

1. Clean all debris, materials, and bring all finishes back to existing conditions in the area they were working in prior to moving to the next area.
2. No smoking or smokeless tobacco use onsite.
3. The staff of the State of Iowa has a responsibility to protect the public by providing a secure
4. environment. All work site rules must be followed to the letter, at all times.
5. Hot Work Permit Processes and Fire Watch, when necessary, will be adhered to for this project.
6. You are permitted access only to the work site and no other area of the facility.
7. No drugs, alcohol, or firearms are allowed on the work site.
8. Do not leave money, drugs, alcohol, or firearms in your personal vehicle.

9. Company and personal vehicles are to be parked and locked in designated or authorized area of the work.
10. Maintain control of all tools, supplies, and debris at all times during the work.
11. Never leave keys in any vehicle. If a security officer finds keys in a vehicle, they are under orders to turn them in to a security supervisor.
12. Do not give anything to residents or take anything from residents; if they offer, inform your supervisor.
13. Secure all tools at the end of each day. Never leave tools unattended. All tools shall be checked in at the beginning of the day and checked out at the end of the day. If security officers find loose tools, they are under orders to turn them in to their supervisor.
14. All delivery vehicles must go directly to the job site.
15. During an emergency, follow the instructions of the security staff.

Open Discussion

SECTION 00 4116

BID FORM

RFB #911700-01

BID FORM for CONSTRUCTION CONTRACT

for

Iowa Veterans Home
1301 Summit Street,
Marshalltown, Iowa 50158
Project 9117.00

Iowa Department of Administrative Services
GSE-Central Procurement Bureau
Hoover State Office Building, Level 3
1305 East Walnut Street
Des Moines, Iowa 50319-0105

The following documents are to be completed and submitted with your bid.

1. Bid Proposal Form (Required)
2. Non Discrimination Clause Form
3. Contractor Targeted Small Business Enterprise Pre-Bid Contract Information Form
4. Bid Security – 5% of total Bid amount (Is to be submit in separate envelope) (Required)

Authorized Representative:

The undersigned Bidder, in response to your Request for Bid for construction of the above project, having examined the Drawings, Specifications, and other Bidding Documents dated February 3rd, 2020, and Addenda issued and acknowledged below as received and being familiar with all the conditions surrounding the construction of the proposed project including the availability of materials and labor, hereby proposes to furnish all labor, materials, equipment and supplies to perform all work to construct the project in strict accordance with the proposed Contract Documents, within the time and at the prices stated below. Prices are to cover all expenses incurred in performing the work required under the proposed Contract Documents, of which this bid is a part.

Bidder acknowledges receipt of the following Addenda which are a part of the Bidding Documents and for which any effect on cost of the Work is included in the bid amounts indicated:

Number _____ _____ _____ _____ _____

Dated _____ _____ _____ _____ _____

Note that the State of Iowa is exempt from State and Local sales and use taxes (including local option and school option) for this project. Taxes on construction materials shall NOT be included in the bid amounts.

Amounts shall be indicated in both words and figures. In case of discrepancy, the amount indicated in words shall govern.

BID PACKAGES:

BP 01

Description: Civil and General Construction

Bidder proposes and agrees to perform all work as described in the Construction Documents for the sum of:

_____ Dollars

(\$_____).

BP 02

Description: Electrical

Bidder proposes and agrees to perform all work as described in the Construction Documents for the sum of:

_____ Dollars

(\$_____).

BP 03

Description: Landscaping

Bidder proposes and agrees to perform all work as described in the Construction Documents for the sum of:

_____ Dollars

(\$_____).

ALTERNATES:

ALT 01 Splash Pad

Description: Includes the procurement, delivery, and installation of a +/- 435 ft² splashpad with 5' wide perimeter sidewalk as shown in the construction documents. Work shall include two sets of site furnishings, all splashpad mechanical and electrical equipment, and a manhole structure for winterization of the splashpad.

The Bidder agrees to furnish all labor, materials, supplies and services required to complete the Work, for the above referenced Project, as described in the Specifications and Contract Documents and shown on the Drawings enumerated below and as modified by the Addenda listed above.

Bidder proposes and agrees to perform all work as described in the Construction Documents for the sum of:

_____ Dollars

(\$_____).

ALT 02 Sport Court

Description: Includes the procurement, delivery, and installation of a +/- 1,200 ft² custom colored plastic sport court surfacing tile for the shuffleboard and basketball court areas. The plastic tiling shall be colored and lined as marked per the construction documents.

The Bidder agrees to furnish all labor, materials, supplies and services required to complete the Work, for the above referenced Project, as described in the Specifications and Contract Documents and shown on the Drawings enumerated below and as modified by the Addenda listed above.

Bidder proposes and agrees to perform all work as described in the Construction Documents for the sum of:

_____ Dollars

(\$_____).

ALT 03 Planter Boxes

Description: Includes the procurement, delivery, and installation of Sixty-Five (65), 6-foot long custom wood raised planter boxes as detailed per the construction documents.

The Bidder agrees to furnish all labor, materials, supplies and services required to complete the Work, for the above referenced Project, as described in the Specifications and Contract Documents and shown on the Drawings enumerated below and as modified by the Addenda listed above.

Bidder proposes and agrees to perform all work as described in the Construction Documents for the sum of:

_____ Dollars

(\$_____).

ALT 04 Site Furniture

Description: Includes the procurement, delivery, and installation of **various site furnishings which include, nine (9) 5-seated tables, six (6) with umbrellas, Twelve (12) Free Standing Tables, and Thirty (30) Free-Standing chairs** as located and detailed per the construction documents. The owner reserves the right to include up to **six (6) 5-foot long plastic benches** as specified in the drawings at unit bid price.

The Bidder agrees to furnish all labor, materials, supplies and services required to complete the Work, for the above referenced Project, as described in the Specifications and Contract Documents and shown on the Drawings enumerated below and as modified by the Addenda listed above.

Bidder proposes and agrees to perform all work as described in the Construction Documents for the sum of:

_____ Dollars

(\$_____).

UNIT PRICES:

UNIT 1 - 6" PCC Walkway w/ 6" Prep.

Description: Square foot of additional 6"PCC and 6" prep.

Bidder proposes and agrees to perform all work as described in the Construction Documents for the sum of:

_____ Dollars

(\$_____) per SF.

UNIT 2 - Sod

Description: Square foot of additional sod.

Bidder proposes and agrees to perform all work as described in the Construction Documents for the sum of:

_____ Dollars

(\$_____) per SF.

UNIT 3 – Rock mulch with weed barrier.

Description: Cubic yard of additional rock mulch with weed barrier.

Bidder proposes and agrees to perform all work as described in the Construction Documents for the sum of:

(\$ _____) per CY.

Bidder hereby certifies that:

1. This bid is genuine and is not made in the interest of or on behalf of any undisclosed person, firm or corporation;
2. Bidder has not directly or indirectly induced or solicited any other bidder to put in a false or sham bid; Bidder has not solicited or induced any person, firm or corporation to refrain from bidding; and Bidder has not sought by collusion to obtain any advantage over any other bidder or over the Owner.
3. Bidder hereby certifies that the Bidder is registered with the Iowa Labor Commissioner as a Contractor as required by Chapter 91C, Code of Iowa.
4. Bidder agrees to comply with all Federal and State Affirmative Action/Equal Employment Opportunity requirements concerning fair employment and will not discriminate between or among them by reason of race, color, religion, sex, national origin or physical handicap.
5. All construction under this Contract shall conform to the requirements of the *Iowa State Building Code*.
6. Bidder agrees that this bid shall remain valid and shall not be withdrawn for a period of thirty (30) calendar days after the date for receipt of bids.
7. Bidder agrees that if written notice of acceptance of this bid is mailed, emailed, or delivered to the undersigned within thirty (30) days after the date in which bids are due, or at any time thereafter before it is withdrawn, the undersigned will sign and return the Contract Agreement, prepared in accord with the Bidding Documents and this bid as accepted; and will also provide proof of insurance coverage and required surety bonds.
8. Bidder understands that the Owner reserves the right to reject any and all bids, and to waive irregularities or informalities and enter into a contract for the work, as the Owner deems to be in the best interest of the State.
9. Bidder understands that the Owner reserves the right to accept any, or no, Alternate Bid, if requested, and that the Alternate Bids may be considered in any order or combination, and the low Bidder shall be determined on the basis of the sum of the base bid and any Alternate(s) accepted.

Subcontractors:

The Trade Contractor must identify all Subcontractors and Suppliers within 48 hours of the published date and time for which bids must be submitted, in accordance with Iowa Code Section 8A311, as amended by House File 646 in 2011. Subcontractors and suppliers may not be changed without the approval of the Owner. Requests for changing a Subcontractor or supplier must identify the reason for the proposed change, the name of the new Subcontractor or supplier, and the change in the subcontractor or supplier price as a result of the change. Any reduction in subcontractor or supplier price as a result of the change, if the change is approved by the Owner, shall be deducted from the Trade Contract Price via a deductive Change Order. Any such changes, if approved by the Owner, which result in an increase in the Trade Contract Price shall be borne by the Trade Contractor.

Enforcement of Reciprocal Resident Bidder Preference, per Iowa Code 73A.21.

All bidders shall either check the box next to "Resident Bidder" or check the box next to "Nonresident Bidder" and by doing so and signing thereafter certifies and attests to the same. All information requested must be provided. Seek out the advice of an attorney if you have questions.

"Resident Bidder" means a person or entity authorized to transact business in of the State of Iowa and having a place of business for transacting business within the State of Iowa at which it is conducting and has conducted business for at least three years prior to the date of the first advertisement for the public improvement. Note, however, that if a nonresident bidder's state or foreign country has a more

stringent definition of a resident bidder, the more stringent definition is applicable as to bidders from that state or foreign country.

Resident Bidder

Name of Resident Bidder: _____

By: _____
Authorized Agent and Signatory of Resident Bidder

OR:

Nonresident Bidder

Name of Nonresident Bidder: _____

Name of State or Foreign Country of Nonresident Bidder: _____

Particularly identify and describe any preference, labor preference, or any other type of preferential treatment, in effect in the nonresident bidder's state or foreign country at the time of this bid:

NOTICE: Nonresident Bidders domiciled in a state or country with a resident labor force preference shall make and keep, for a period of not less than three years, accurate records of all workers employed on the public improvement. The records shall include each worker's name, address, telephone number when available, social security number, trade classification, and the starting ending time of employment.

By: _____
Authorized Agent and Signatory of Nonresident Bidder

Bid Form shall be signed by an officer of the company with authority to bind in a contract. Notice of acceptance of this bid, or request for additional information by the Department of Administrative Services, may be addressed to the undersigned at the address set forth below:

Legal Name of Firm: _____

Date: _____

Signature of Bidder: _____

Title: _____

Typed Name of Signatory: _____

Email: _____

Business Address:

Telephone Number: _____ Fax Number: _____

Federal Tax Identification Number: _____

Iowa Contractor Registration Number: _____

Bidder Safety Manager Name: _____

For an out-of-state Bidder, Bidder certifies that the Resident Preference given by the State or Foreign Country of Bidder's residence, _____, is _____ %.

END OF SECTION

LANDSCAPE ARCHITECTURE: ALL WORK IS THE PROPERTY OF JEFFREY L. BRUCE & COMPANY, L.L.C. AND MUST BE CREDITED, EVALUATED, AND DEVELOPED FOR USE AND IN CONNECTION WITH THE SPECIFIED PROJECT. NONE OF THESE DECISIONS, ARRANGEMENTS, OR PLANS SHALL BE REPRODUCED, COPIED, REPRODUCED, OR PUBLISHED BY ANY METHOD, IN WHOLE OR IN PART, OR DISCLOSED TO ANY PERSON, FIRM, OR CORPORATION FOR ANY PURPOSE WITHOUT THE WRITTEN PERMISSION OF JEFFREY L. BRUCE & COMPANY, L.L.C.

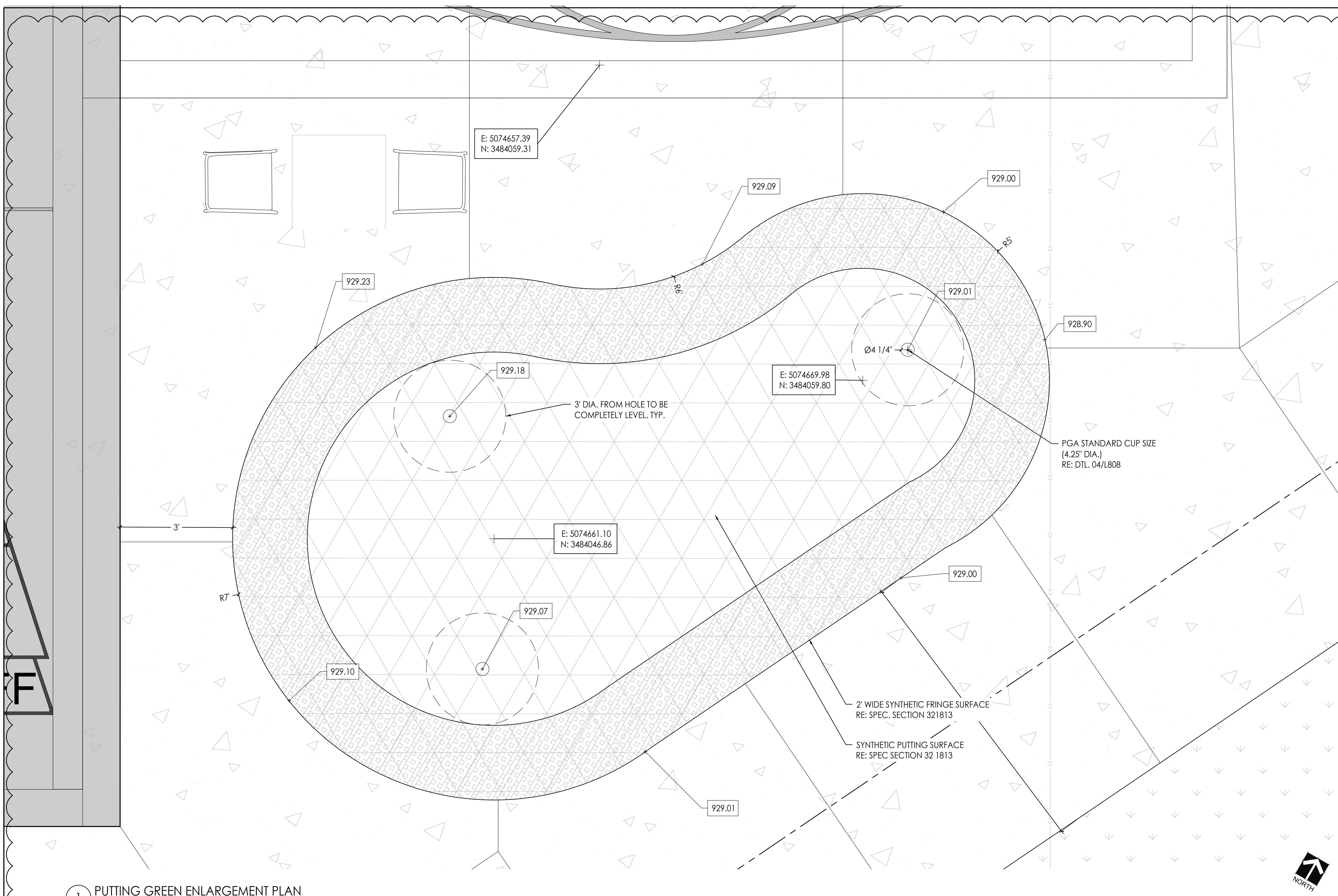

1 PUTTING GREEN ENLARGEMENT PLAN
3/4" = 1'-0"

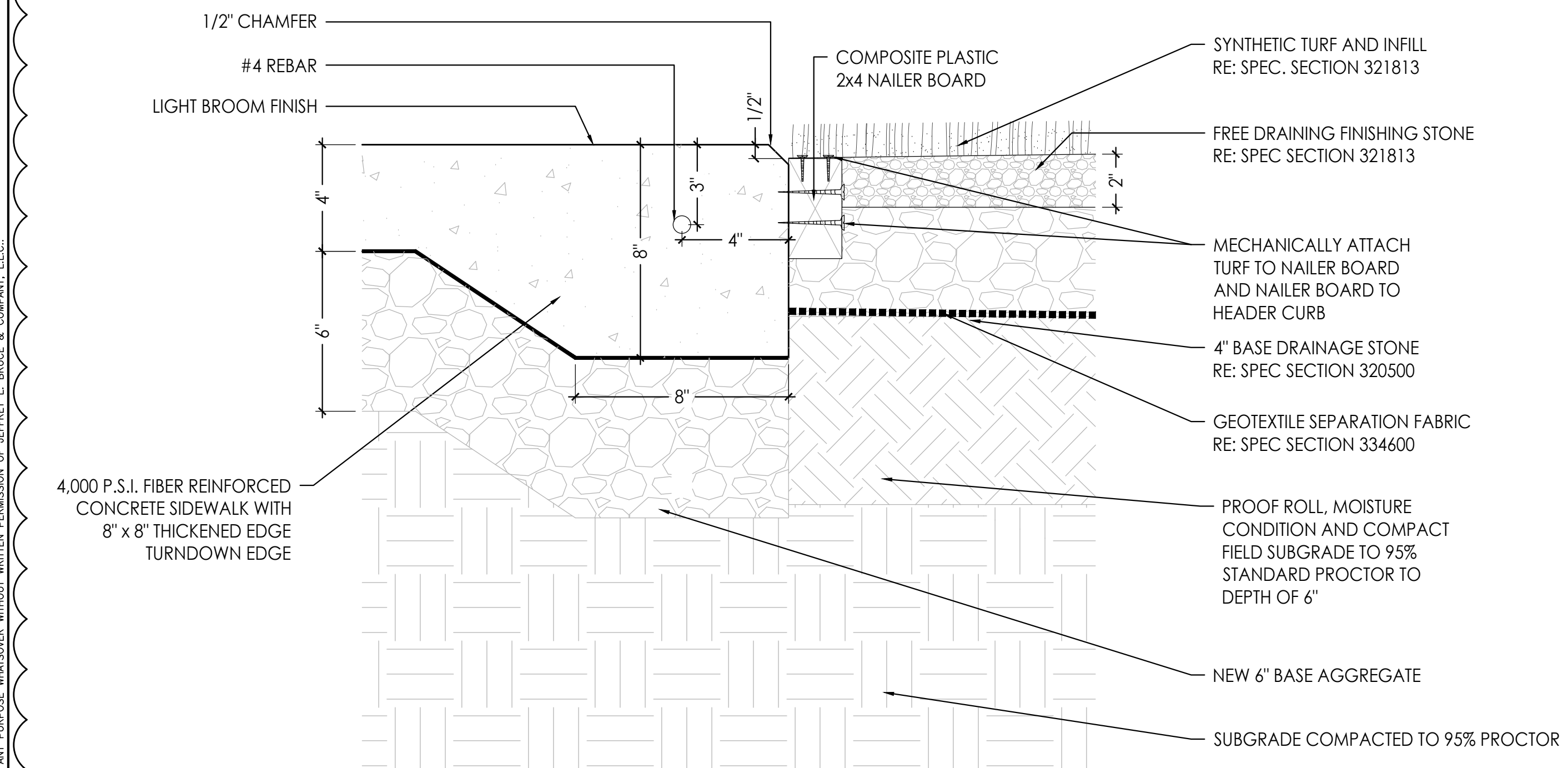

2 PUTTING GREEN CONCRETE EDGE AND NAILER
3" = 1'-0"

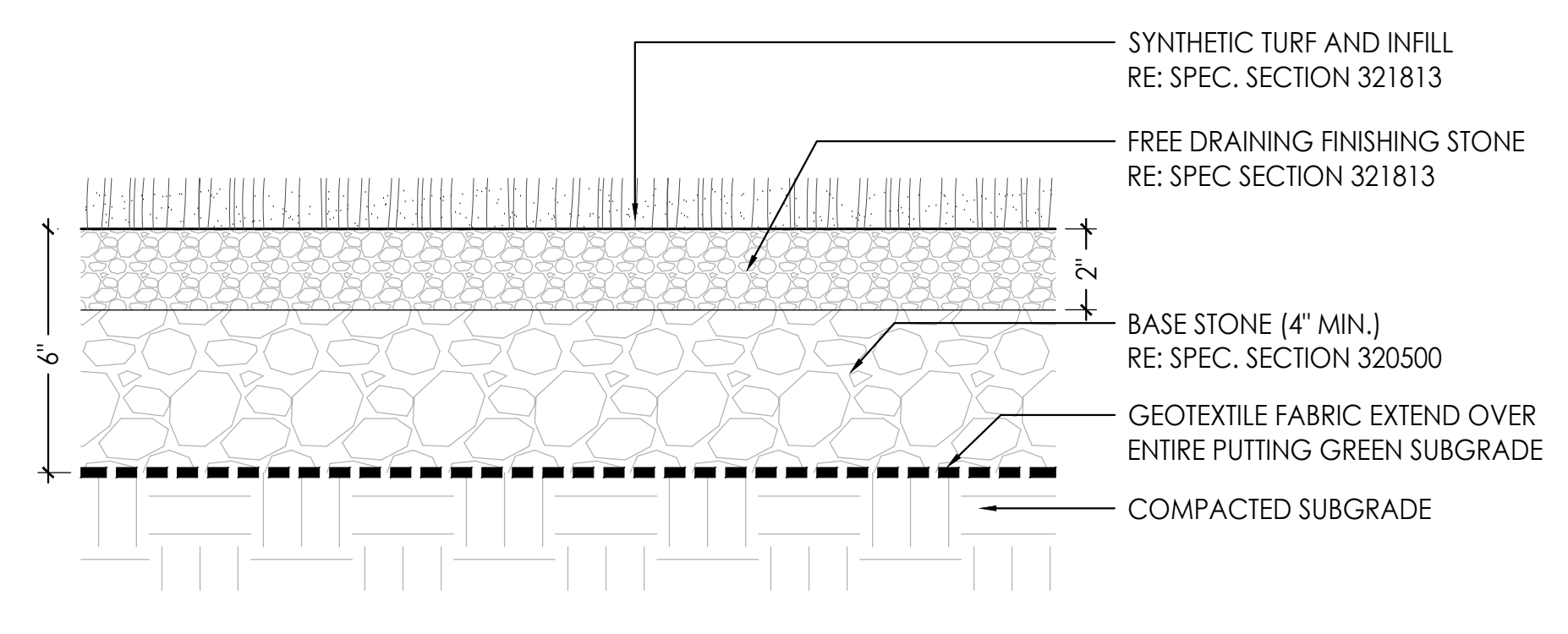

3 PUTTING GREEN SECTION DETAIL
3" = 1'-0"

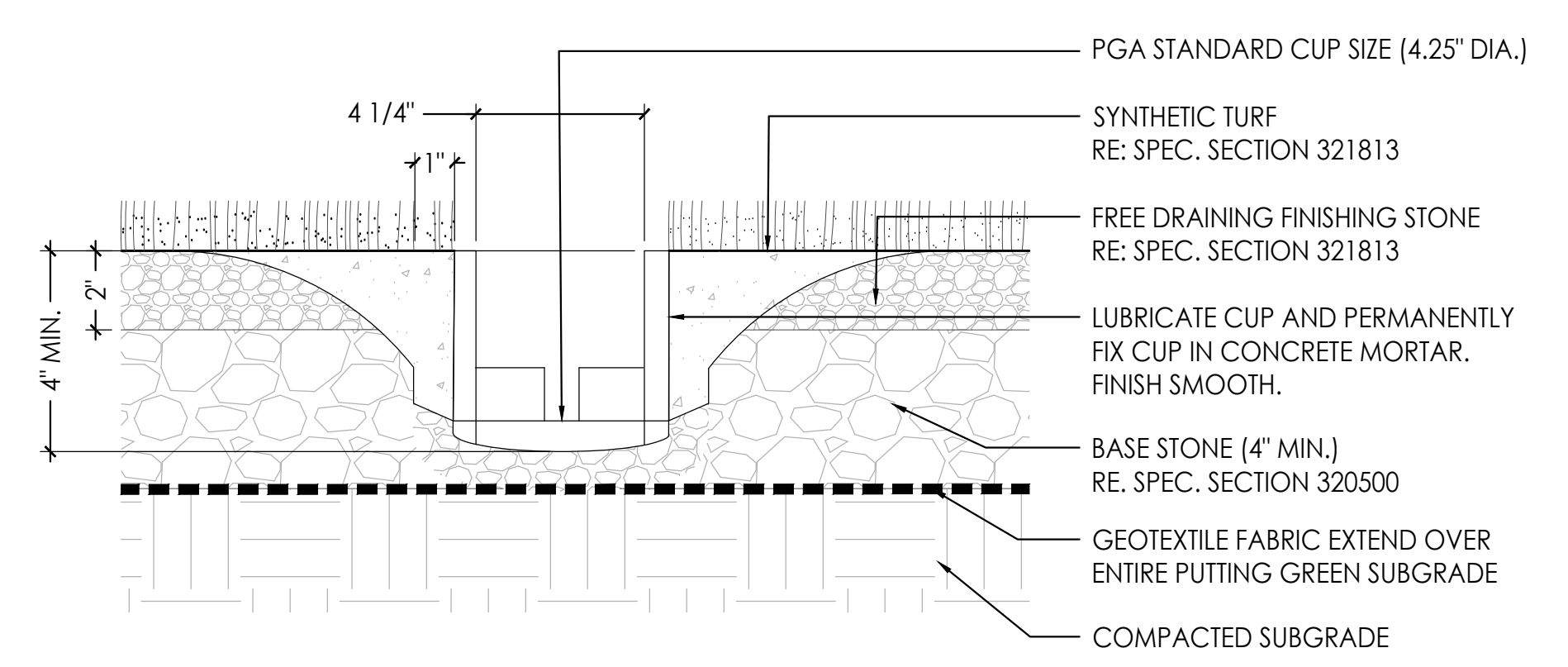

4 GOLF BALL HOLE SECTION DETAIL
3" = 1'-0"

JBC
 JEFFREY L. BRUCE & COMPANY
 landscape architecture | planning | urban design
 300 4th Street
 West Des Moines, IA 50265
 P: 515.778.8397
 www.jlbruce.com

Larson Engineering, Inc.
 1001 Office Park Road, Ste 120
 West Des Moines, IA 50265
 515.225.4377
 www.larsonengr.com

KCL
 ENGINEERING

DCI GROUP
 DESIGN + CONSTRUCTION INFORMATION

PROJECT:
 9117.00
 IOWA VETERANS HOME
 COURTYARD DESIGN
 1301 SUMMIT STREET
 MARSHALLTOWN, IOWA 50158

ISSUE:
 100% CONSTRUCTION DOCUMENTATION
 ADDENDUM 01 03/05/2020

PROFESSIONAL SEAL:

DRAWING TITLE:
 PUTTING GREEN DETAILS

JOB NO: 1739 SCALE:
 DATE: 02/03/20 DRAWN BY: EAD
 SHEET NO:

L808